

ELEVATION REFERENCE MONUMENT

ERM: 1

Panel: 1340

Elevation (NAVD88): 4555.14

Elevation (NGVD29): 4552.49

Latitude: 34°48'17" N

Longitude: 112°28'23" W

Description: Aerial Mapping Company 1/2-inch rebar with aluminum cap, approximately 31 feet north of West Postle Road centerline, approximately 15 feet north of a barbed wire fence, approximately 315 feet east of wash flowline, on a small hill, approximately 900 feet east of and approximately 50 feet north of the southwest corner of Section 33, T17N, R2W.

1340 F

NATIONAL FLOOD INSURANCE PROGRAM

**FIRM
FLOOD INSURANCE RATE MAP**

**YAVAPAI COUNTY,
ARIZONA AND
INCORPORATED AREAS**

PANEL 1340 OF 3925
(SEE MAP INDEX FOR PANELS NOT PRINTED)

<u>CONTAINS COMMUNITY</u>	<u>NUMBER</u>	<u>PANEL</u>	<u>SUFFIX</u>
CHINO VALLEY TOWN OF YAVAPAI COUNTY	040094	1340	F
UNINCORPORATED AREAS	040093	1340	F

**MAP NUMBER
04025C1340 F**

**EFFECTIVE DATE:
JUNE 6, 2001**



Federal Emergency Management Agency

112°30'00"
34°48'45"

ELEVATION REFERENCE MARKS
REFERENCE ELEVATION
MARK (FEET NGVD) DESCRIPTION OF LOCATION

601 RM1	4552.49	Aerial Mapping Company 1/2-inch rebar with aluminum cap, approximately 31 feet north of West Postle Road centerline, approximately 15 feet north of a barbed wire fence, approximately 315 feet east of wash flowline, on a small hill, approximately 900 feet east of and approximately 50 feet north of the southwest corner of Section 33, T17N, R2W.
Says to 600 RM3	4701.28	Aerial Mapping Company 1/2-inch rebar with aluminum cap, approximately 41 feet southwest of the west end of the first dike south of road 3N, approximately 2,200 feet north of and approximately 2,000 feet east of the southwest corner of Section 17, T16N, R2W.
RM29	4489.7	3-inch BCSM in concrete west of Highway 89 on north side of cattleguard to Hidden Valley Lane.
RM88	5416.99	3-inch BCSM in cattleguard concrete at Highway 89 and Road 5 North (west side of Highway 89).
RM238	4505.41	Standard Yavapai County Flood Control District 2 aluminum cap marked RLS 13941 #6. Located 1,528 feet west centerline of Santa Cruz Wash, 20 feet south of centerline of Road 5 north; 1.55 feet west side of a power pole, 25.46 feet north side of the south down guide of same power pole, 14.28 feet west side of the east down guide of power pole 4, 138.73 feet, N89-05-03E of northeast Section 2; 5,010.05 feet, S56-07-50E of east 1/4 of Section 2.

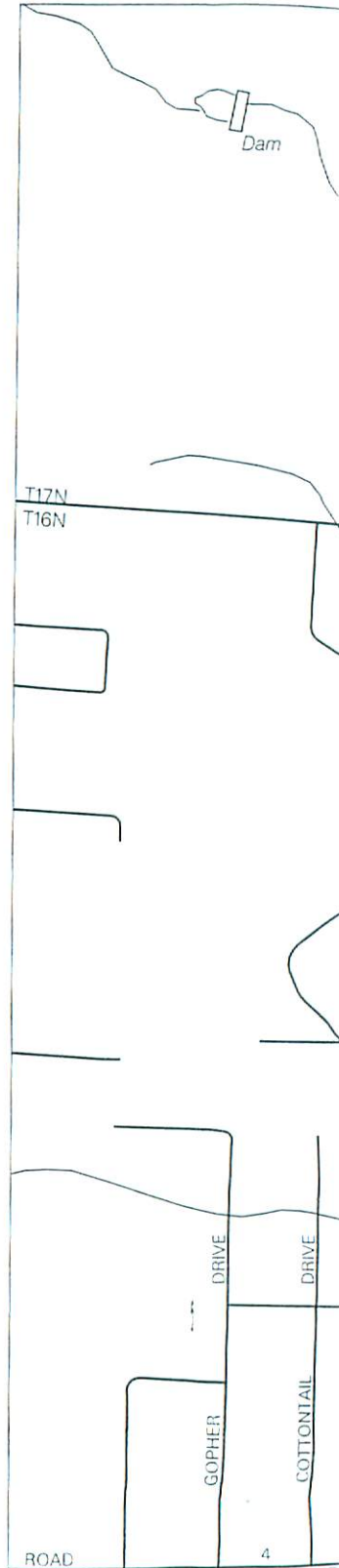

ZONE X

1

2

3

C

D

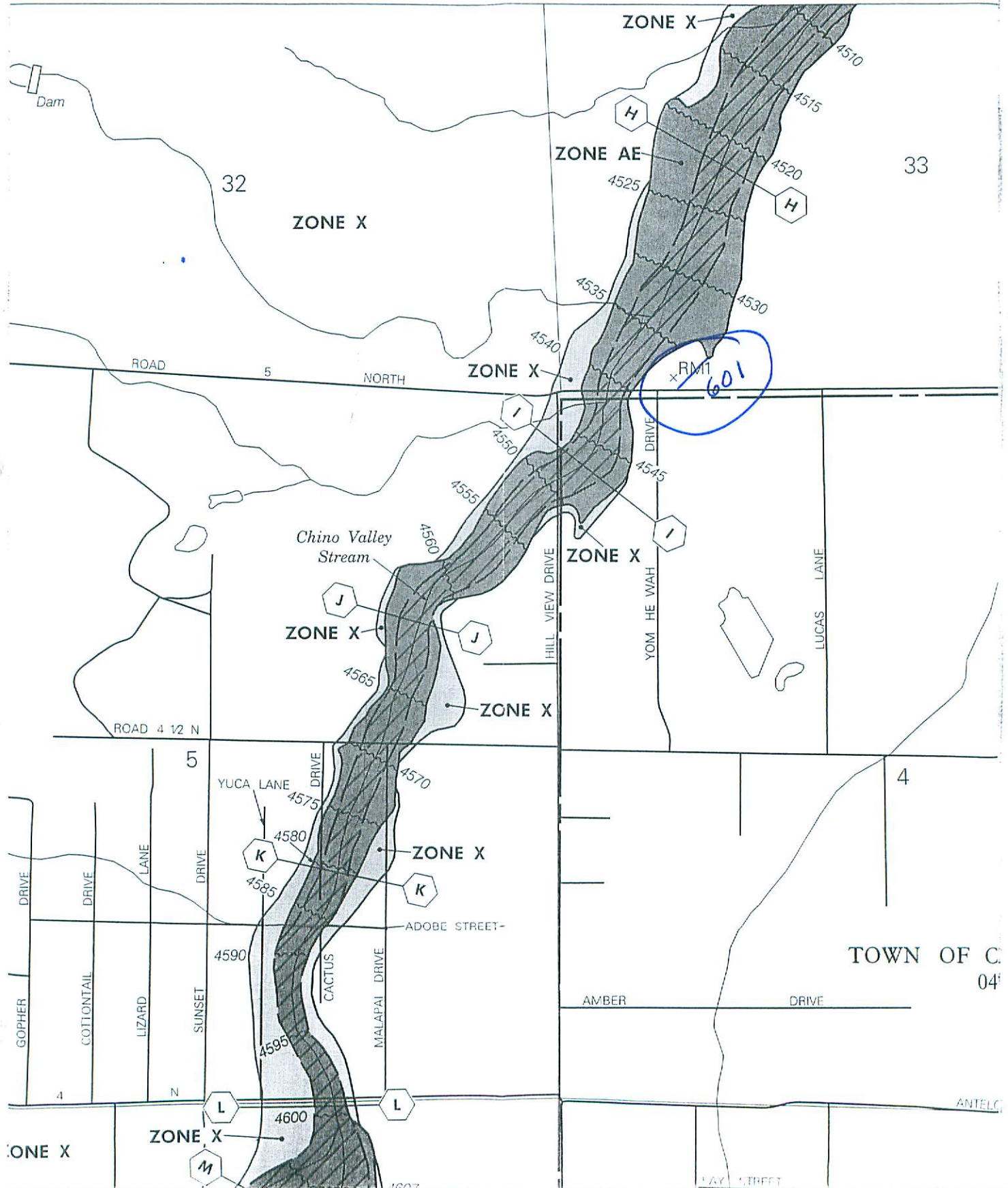

TOWN OF C 04

RMI

306-40-028N

34.8046
112.473

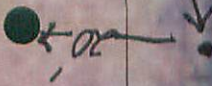

SIGN Do NOT CROSS when FLOODED

800-13-074V

ROAD 5 NORTH

306-05-083

YO HE WAH DR

800-13-074W

306-05-045

306-05-046B



1 in. = 50 ft.

September 8, 2008

RM601 - RMI