

## ELEVATION REFERENCE MONUMENT

**ERM:** 236

**Panel:** 1345

**Elevation (NAVD88):** 4585.58

**Elevation (NGVD29):** 4582.92

**Latitude:** 34°46'16" N

**Longitude:** 112°25'56" W

**Description:** Standard Yavapai County Flood Control District 2 aluminum cap marked RLS 13941 #4. Located 490 feet east of intersection of Perkinsville Road, and Anthony Lane, 18 feet north of Perkinsville Road, 2.18 feet north side of power pole, 2.62 feet north of a telephone riser, 18.76 feet from a down guide located on east side of a power pole, 3,646.40 feet, N69-10-38 east of N 1/4 Section 13; 4,063.90 feet, S11-03-23E of southeast Section 14.

1345

**NATIONAL FLOOD INSURANCE PROGRAM**

**FIRM**

ORIGINAL

**FLOOD INSURANCE RATE MAP**

**YAVAPAI COUNTY,  
ARIZONA AND  
INCORPORATED AREAS**

**PANEL 1345 OF 3925**

(SEE MAP INDEX FOR PANELS NOT PRINTED)

CONTAINS  
COMMUNITY

NUMBER PANEL SUFFIX

CHINO VALLEY TOWN OF  
YAVAPAI COUNTY  
UNINCORPORATED AREAS

040094 1345 F  
040093 1345 F

**MAP NUMBER  
04025C1345 F**

**EFFECTIVE DATE:  
JUNE 6, 2001**



Federal Emergency Management Agency

10/17N 1/2W A

B

ELEVATION REFERENCE MARKS  
 REFERENCE ELEVATION  
 MARK (FEET NGVD) DESCRIPTION OF LOCATION

RM235 4620.55 Standard Yavapai County Flood Control District 2 aluminum cap marked RLS 13941 #3. Located 60 feet east of intersection of Road 2 north and Liberty Lane, and 21 feet north of Road 2 north 1.61 feet north side of a power pole on Road 2 North, 45.69 feet east side of a telephone riser, 77.62 feet south side of a power pole on Liberty Street, 4,665.58 feet, S89-57-02W of northwest Section 23; 613.15 feet N89 42-38E of northeast Section 23.

RM236 4582.92 Standard Yavapai County Flood Control District 2 aluminum cap marked RLS 13941 #4. Located 490 feet east of intersection of Perkinsville Road, and Anthony Lane, 18 feet north of Perkinsville Road, 2.18 feet north side of power pole, 2.62 feet north of a telephone riser, 18.76 feet from a down guide located on east side of a power pole, 3,646.40 feet, N69-10-38 east of N1/4 Section 13; 4,063.90 feet, S11-03-23E of southeast Section 14.

RM237 4571.81 Standard Yavapai County Flood Control District 2 aluminum cap marked RLS 13941 #5. Located 208 feet west of intersection of Granite Creek Lane and Misty Lane, 15 feet north Granite Creek Lane, 2.6 feet on north side of a power pole, 25.28 feet from a guide located on east side of down guide located on east side of same power pole, 3.53 feet north side of a telephone riser, 2,550.65 feet, NE43-40-57E of northeast Section 11; 5,597.54 feet, S52-00-44E of S1/4 of Section 12.

RM239 4505.41 U.S. Coastal and Geodetic Survey brass cap stamped Z-27, located just southeast of the intersection of Road 2 north and the Atchison, Topeka and Santa Fe Railway, in Yavapai County.

112°26'15"  
 34°48'45"

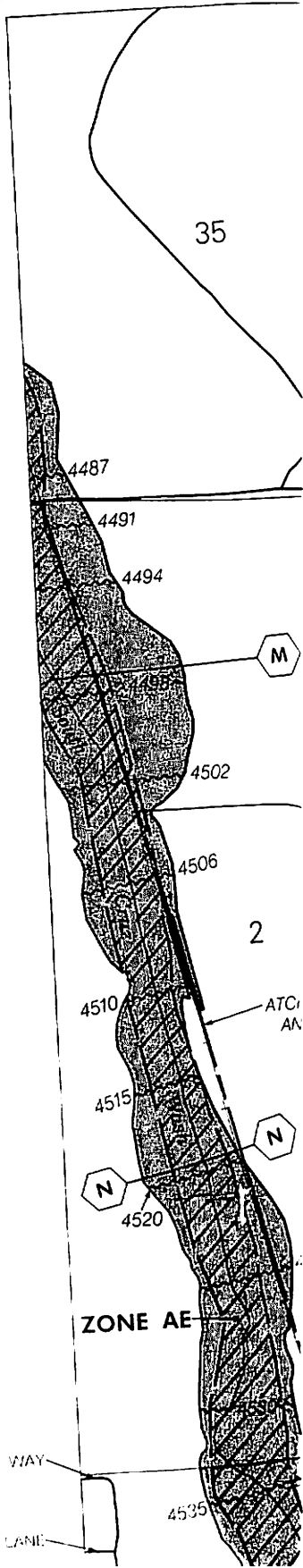

1

2

2

ZONE AE

COLORADO WAY

FLORIDA LANE

35

M

N

N

ATC/AN

4535

4520

4510

4506

4502

4494

4491

4487

END

ation in areas where Base Flood elevations have been determined, users are advised to consult the Flood Profiles and Floodway Data tables in the Study (FIS) report that were developed. Users should be aware that BFEs shown on this map are based on spot elevation data and therefore may not be accurate. For intended for flood insurance rating purposes, users should use the flood elevation data presented in the FIS report in conjunction with the FIRM for floodplain management.

up were obtained and/or developed for the purpose of determining the termination of flood elevations and floodway data on this map. Users should be aware that spot elevations may have changed since the publication of this map. For more elevation information on National Flood Insurance Program towns on this map, please contact the National Geodetic Survey at (301) 713-3242, [www.ngs.noaa.gov](http://www.ngs.noaa.gov). Map users should consult the FIRM for RM monument elevations when used for floodplain management purposes.

may apply only landward of 0.0' elevation. Users should be aware that coastal flood elevations are based on the Summary of Stillwater Elevations and Floodway Data table in the Study report for this community. For more elevation information on National Flood Insurance Program towns on this map, please contact the National Geodetic Survey at (301) 713-3242, [www.ngs.noaa.gov](http://www.ngs.noaa.gov). Map users should consult the FIRM for RM monument elevations when used for floodplain management purposes.

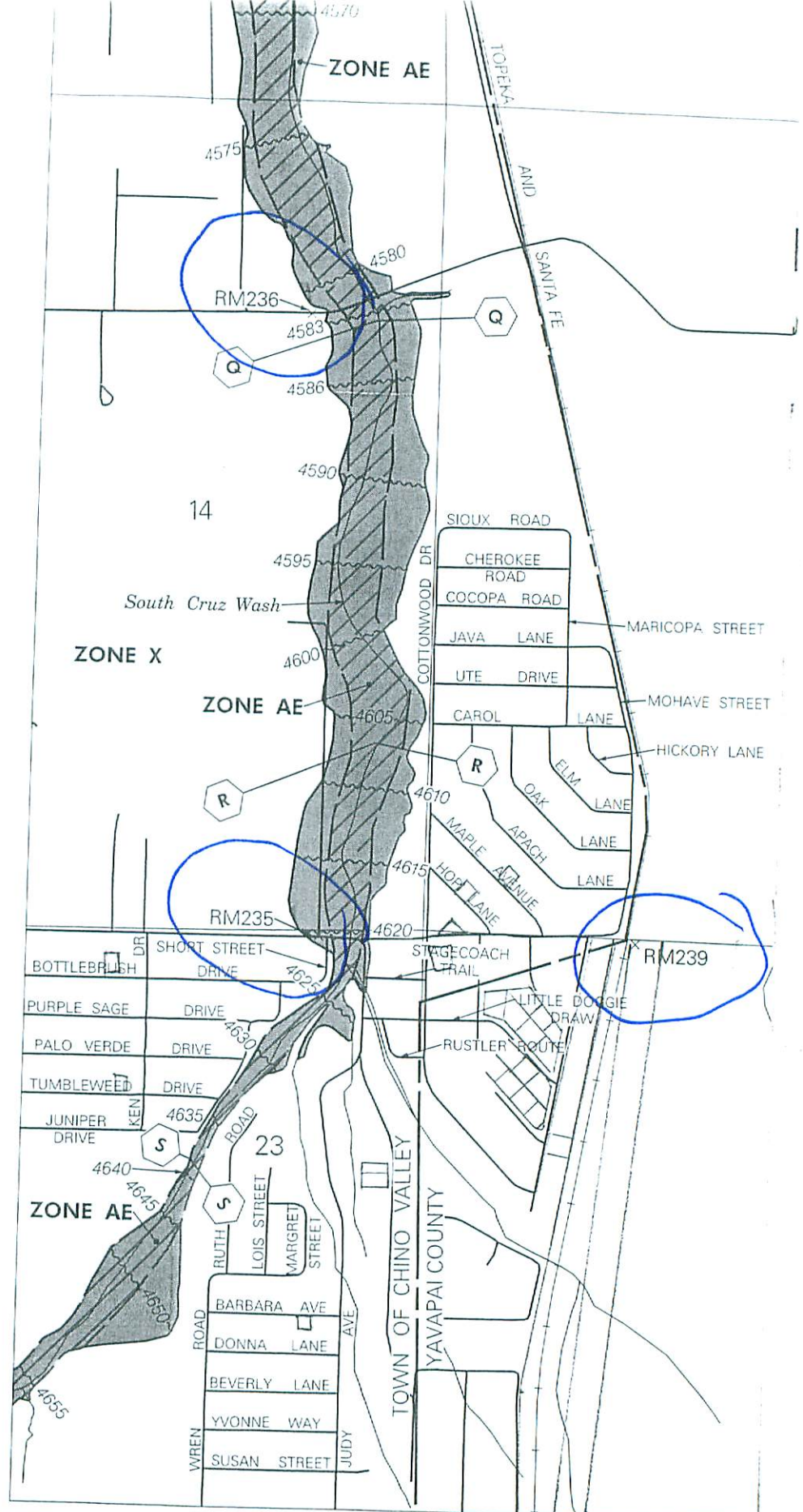

*Please see us at*