

ELEVATION REFERENCE MONUMENT

ERM: 243

Panel: 1418

Elevation (NAVD88): 3365.28

Elevation (NGVD29): 3362.79

Latitude: 34°46'03" N

Longitude: 112°02'24" W

Description: Standard tablet stamped 43-EMH 1973 3363, located on Tuzigoot National Monument Road at concrete Bridge over Verde River, 15 feet north of and approximately 2 feet higher than the centerline of bridge, 2 feet from east end of north abutment. Established by U.S. Geological Survey.



APPROXIMATE SCALE IN FEET

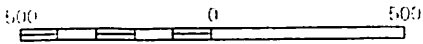

1418

NATIONAL FLOOD INSURANCE PROGRAM

FIRM *OF ORIGINAL*
FLOOD INSURANCE RATE MAP

**YAVAPAI COUNTY,
ARIZONA AND
INCORPORATED AREAS**

PANEL 1418 OF 3925

(SEE MAP INDEX FOR PANELS NOT PRINTED)

| <u>CONTAINS</u> <u>COMMUNITY</u> | <u>NUMBER</u> | <u>PANEL</u> | <u>SUFFIX</u> |
|--|---------------|--------------|---------------|
| CLARKDALE, TOWN OF | 040095 | 1418 | F |
| COTTONWOOD, CITY OF | 040096 | 1418 | F |
| YAVAPAI COUNTY UNINCORPORATED AREAS | 040092 | 1418 | F |

**MAP NUMBER
04025C1418 F**

**EFFECTIVE DATE:
JUNE 6, 2001**



Federal Emergency Management Agency

A

B

112°03'45"
34°46'52"

ELEVATION REFERENCE MARKS
REFERENCE ELEVATION MARK (FEET NGVD) DESCRIPTION OF LOCATION

| | |
|---|--|
| RM241 3674.87 New RM 241 A 3574.12 (See RM Book) | A 3-inch brass cap stamped VROFE, located in middle of intersection of 11th Street and First South Street. Established by U.S. Army Corps of Engineers. |
| RM242 3453.93 New RM 242 A 3454.29 (See RM Book) | A 3-inch brass cap stamped VROFE, located in center of Broadway, approximately 950 feet from end of Bitter Creek Bridge. Established by U.S. Army Corps of Engineers. |
| RM243 3362.79 | Standard tablet stamped 43-EMH 1973 3363, located on Tuzigoot National Monument Road at concrete Bridge over Verde River, 15 feet north of and approximately 2 feet higher than the centerline of bridge, 2 feet from east end of north abutment. Established by U.S. Geological Survey. |

1

2

3

18

ZONE X
ZONE X

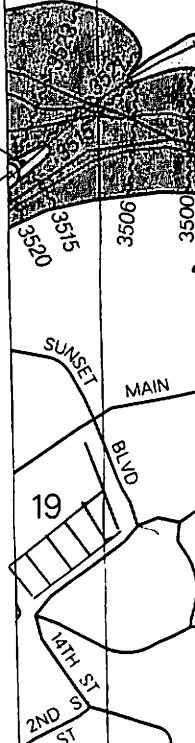

NOTE: MAP AREA SHOWN ON THIS PANEL IS LOCATED WITHIN TOWNSHIP 16 NORTH, RANGE 3 EAST.

JOINS PANEL 1419

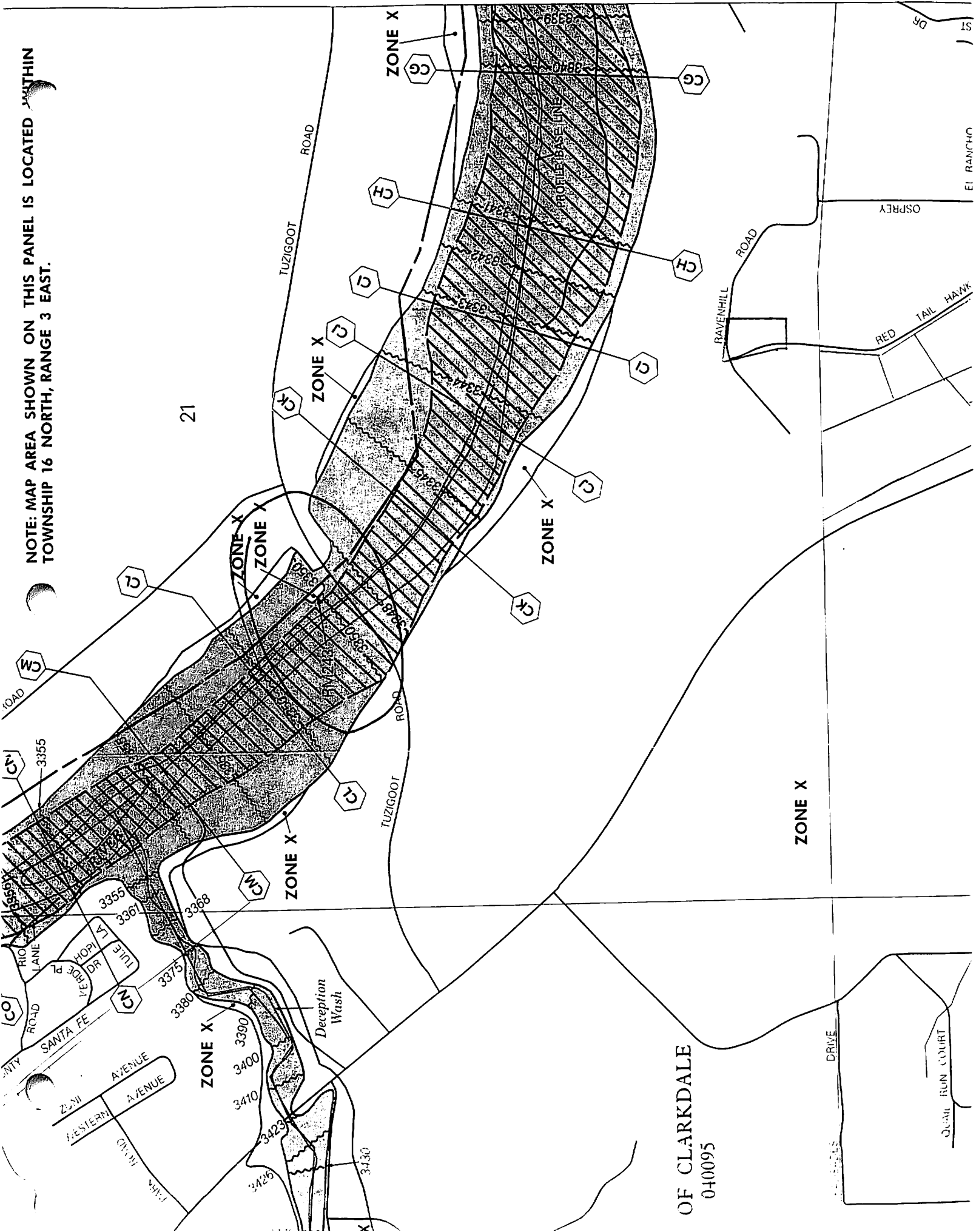

OF CLARKDALE
040095

DRIVE

QUAIL RUN COURT

ZONE X

ZONE X

ZONE X

ZONE X

OSPREY

RED TAIL HAWK

EL RANCHO

ST

DR