

ELEVATION REFERENCE MONUMENT

ERM: 286

Panel: 1695

Elevation (NAVD88): 5070.04

Elevation (NGVD29): 5067.10

Latitude: 34°40'04" N

Longitude: 112°31'57" W

Description: Aerial Mapping Company 1/2-inch rebar with aluminum cap, approximately 27 feet east of Buchanan Drive centerline at the middle of a curve, approximately 321 feet southeast of the intersection of wash flowline and Buchanan Drive which has six 24 inch diameter steel corrugate pipes, approximately 110 feet southeast of the intersection of Buchanan Drive and a dead end dirt road centerlines, approximately 1,000 feet east and approximately 2,200 feet south of the northwest corner of Section 24, T15N, R3W.

1695

NATIONAL FLOOD INSURANCE PROGRAM

FIRM

ORIGINAL

FLOOD INSURANCE RATE MAP

YAVAPAI COUNTY,
ARIZONA AND
INCORPORATED AREAS

PANEL 1695 OF 3925

(SEE MAP INDEX FOR PANELS NOT PRINTED)

CONTAINS:

COMMUNITY

NUMBER

PANEL

SUFFIX

YAVAPAI COUNTY,
UNINCORPORATED AREAS

040093

1695

F

MAP NUMBER
04025C1695 F

EFFECTIVE DATE:
JUNE 6, 2001



Federal Emergency Management As

Attention Danin

ELEVATION REFERENCE MARKS

REFERENCE MARK	ELEVATION (FEET NGVD)	DESCRIPTION OF LOCATION
----------------	-----------------------	-------------------------

RM286	5067.10	Aerial Mapping Company 1/2-inch rebar with aluminum cap, approximately 27 feet east of Buchanan Drive centerline at the middle of a curve, approximately 321 feet southeast of the intersection of wash flowline and Buchanan Drive which has six 24-inch diameter steel corrugate pipes, approximately 110 feet southeast of the intersection of Buchanan Drive and a dead end dirt road centerlines, approximately 1,000 feet east and approximately 2,200 feet south of the northwest corner of Section 24, T154N, R3W.
-------	---------	--

RM287	5257.77	U.S. General Land Survey brass cap 3-inch diameter in a soil pipe being the southeast corner of Section 25, T15N, R3W, approximately 275 feet north-northwest of a house with a peaked brown shingled roof and chimney, approximately 21 feet south of a forked trunked Juniper tree with each trunk being 8-inches in diameter, approximately 24 feet southwest of a forked trunked Juniper tree with the diameter being 5-inches and 8-inches.
-------	---------	--

112°33'45"
34°41'15"

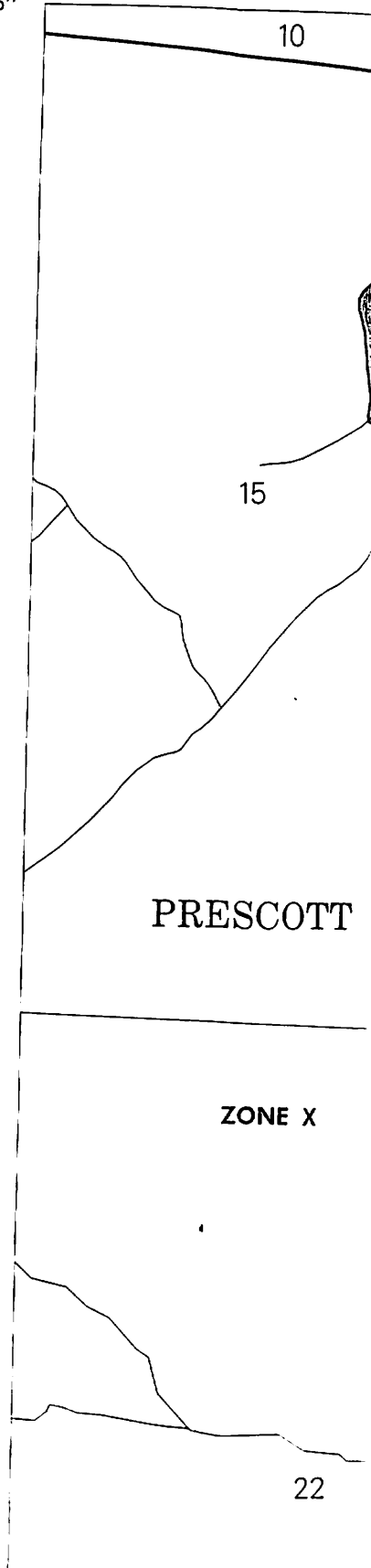

1

2

10

15

PRESCOTT

ZONE X

22

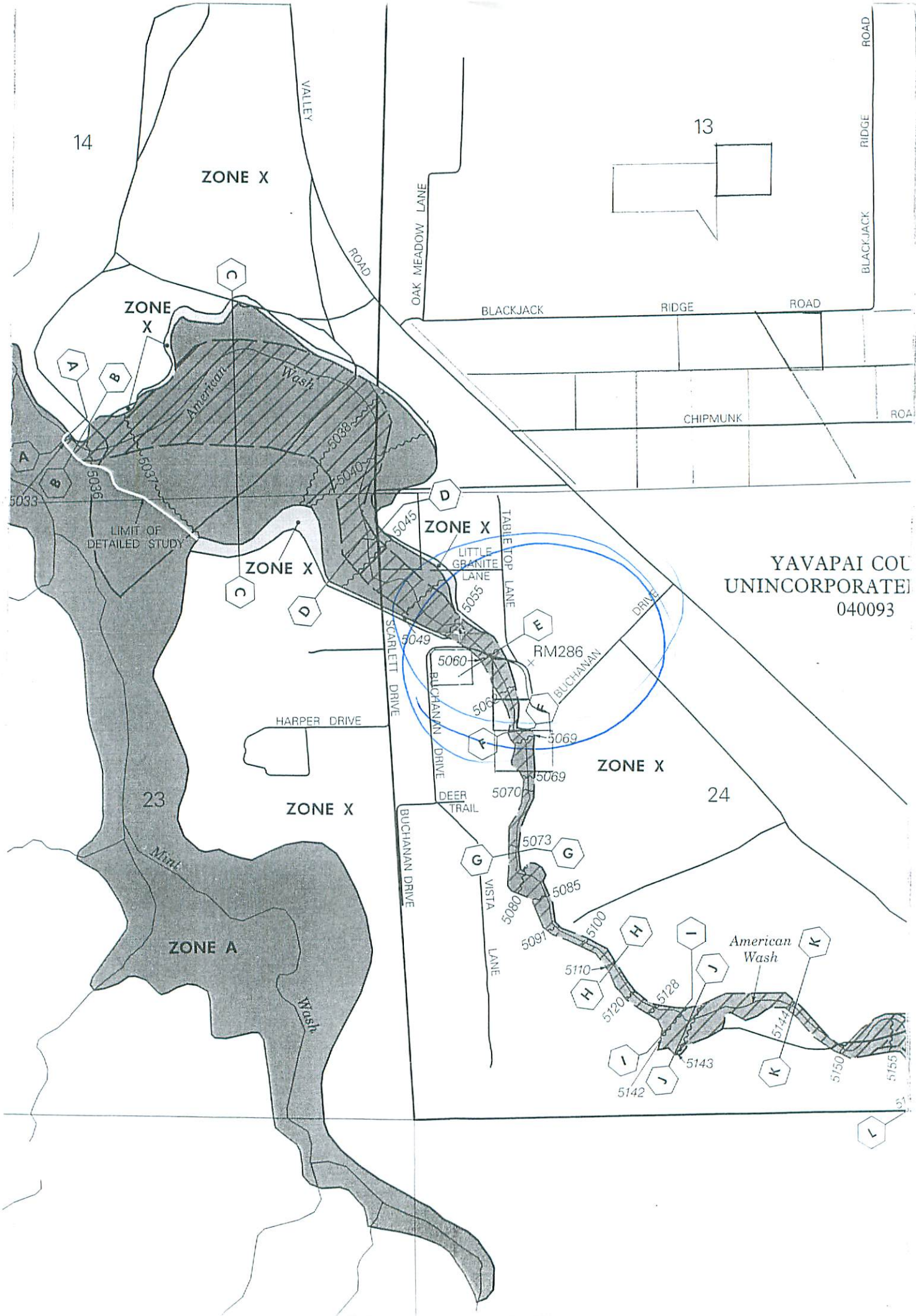

YAVAPAI COUNTY
 UNINCORPORATED
 040093

ZONE X

ZONE X

ZONE X

ZONE X

ZONE X

ZONE X

ZONE A

14

13

23

24

25

American Wash
 5038
 5040

RM286
 5060
 5069

American Wash
 5128
 5143
 5144

LIMIT OF DETAILED STUDY

OAK MEADOW LANE

BLACKJACK

RIDGE

ROAD

CHIPMUNK

ROAD

HARPER DRIVE

SCARLETT DRIVE

TABLE TOP LANE

LITTLE GRANITE LANE

BUCHANAN DRIVE

BUCHANAN DRIVE

DEER TRAIL

VISTA LANE

VALLEY

ROAD

BLACKJACK

RIDGE

ROAD

A

B

C

D

E

F

G

H

I

J

K

L

5033

5036

5037

5038

5040

5045

5049

5060

5069

5070

5073

5085

5091

5100

5110

5120

5128

5142

5143

5144

5150

5155