

# YAVAPAI COUNTY FLOOD CONTROL DISTRICT REFERENCE MONUMENT RECORD

SITUATED IN SECTION 33, TOWNSHIP 14 NORTH, RANGE 1 WEST  
GILA AND SALT RIVER MERIDIAN, YAVAPAI COUNTY, ARIZONA

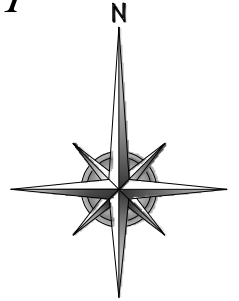

## RM 90A



SCALE: 1" = 800'

DESCRIPTION: THE POINT IS A YAVAPAI COUNTY ALUMINUM CAP ON THE SOUTHWEST PARAPET WALL OF THE BRIDGE ALONG OLD BLACK CANYON HIGHWAY WHERE IT CROSSES LYNX CREEK MARKED RM 90A 2005.

### WGS84 POSITION

LATITUDE: 34°33'07.17066"N  
LONGITUDE: 112°22'24.50080"W  
HEIGHT: 5174.649 ift

### NAD83/NAVD88 AZ SP POSITION

NORTHING: 1292564.0527 ift  
EASTING: 562457.5501 ift  
ELEVATION: 5260.846 ift

## RM 90B

DESCRIPTION: THE POINT IS A 3" BRASS CAP ON PIPE AT THE SOUTHEAST CORNER OF THE INTERSECTION OF OLD BLACK CANYON HIGHWAY AND LYNX CREEK ROAD MARKED RM 90B 2014 RLS 33861.

### WGS84 POSITION

LATITUDE: 34°33'03.67958"N  
LONGITUDE: 112°22'30.58063"W  
HEIGHT: 5207.949 ift

### NAD83/NAVD88 AZ SP POSITION

NORTHING: 1292213.448 ift  
EASTING: 561947.440 ift  
ELEVATION: 5294.000 ift



### REFERENCE MARK NOTE

THE FINISHED FLOOR ELEVATIONS FOR STRUCTURES IN THIS AREA AS STATED ON THE PLAT OF LYNX CREEK ESTATES UNIT V ARE BASED ON A POINT CALLED RM 90 WITH THE ELEVATION OF 5295.90 AND THAT POINT APPEARS TO NOW BE DESTROYED. THAT PLAT WAS RECORDED IN 1993 AND AN ASSUMPTION CAN BE MADE THAT THE ELEVATION WAS ESTIMATED USING THE NGVD 29 DATUM. FEMA REPORTED THE NGVD 29 ELEVATION OF RM 90 AS 5295.00 AND THE NAVD 88 ELEVATION AS 5297.94. THE 2.94' DELTA BETWEEN THE NGVD 29 DATUM AND THE NAVD 88 DATUM AGREES WITH THE NGS REPORTING FOR OTHER BENCHMARKS IN THIS AREA.

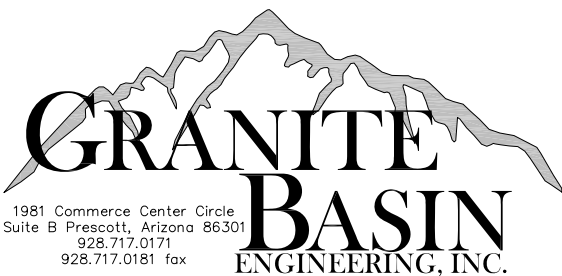
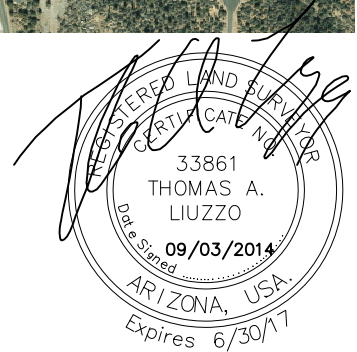

## YAVAPAI COUNTY FLOOD CONTROL DISTRICT REFERENCE MONUMENT RECORD RM #90A & 90B

PREPARED FOR:  
YAVAPAI COUNTY FLOOD CONTROL DISTRICT  
1120 COMMERCE DRIVE  
PRESCOTT, AZ 86305

GBE JOB #: 14096

DRAWN BY: TL

DATE: SEPT 2014

SCALE 1"=800'