

ELEVATION REFERENCE MONUMENT

ERM: 83B

Panel: 2140

Elevation (NAVD88): 4572.35

Elevation (NGVD29): 4569.72

Latitude: 34°31'47" N

Longitude: 112°14'32" W

Description: 2" diameter Yavapai County Flood Control District aluminum capped 5/8" rebar in concrete located at the southwest corner of the intersection of Highway 69 & Highway 169. Station is approximately 32.5 feet northwest from a traffic signal at said southwest corner.

YAVAPAI COUNTY FLOOD CONTROL DISTRICT

MONUMENT RECORD FORM

CORNER LOCATION INFORMATION

SECTION 2 CORNER INDEX CODE _____
 TOWNSHIP 13 NORTH RANGE 1 EAST
GRM MERIDIAN YAVAPAI COUNTY

CORNER TYPE:

ALIQUOT GOV'T COR. NON-ALIQUOT GOV'T COR. OTHER

FORMAL CORNER NAME: RM 83B

COUNTY FILING INFORMATION

APPLY COUNTY STICKER HERE IF APPLICABLE

BOOK _____ PAGE _____
 COUNTY, ARIZONA _____

DATE _____ HOUR _____
 FEE: _____ PAGES _____

REQUEST OF: _____

TITLE: _____

SUBMITTED TO BE CHECKED FOR COMPLETENESS

FILED AT REQUEST OF COUNTY REVIEWER _____

NOTES FOR USING TOWNSHIP INDEX TO DETERMINE INDEX CODE

FOR ALIQUOT SECTION, QUARTER, AND SIXTEENTH CORNERS, PUT A CIRCLE AT THE CORNER LOCATION, THEN READ GRID DESIGNATION (A-1 THRU Z-25). A CORNER THAT APPLIES TO TWO OR MORE TOWNSHIPS SHOULD BE INDEXED UNDER THE TOWNSHIP NORTH OR WEST OF THE CORNER LOCATION AS INDICATED BY THE HEAVY LINE ON THE INDEX (GENERALLY THE SOUTH AND EAST LINES EXCEPT THE N.E. AND S.W. CORNERS). CLOSING CORNERS WILL BE INDEXED UNDER THE TOWNSHIP TO WHICH THEY APPLY. FOR 1/64 CORNERS AND FURTHER DIVISIONS, AND FOR NON-ALIQUOT CORNERS LYING BETWEEN GRID DESIGNATIONS OR WITHIN A GRID SQUARE ON THE INDEX, DRAW AN APPROPRIATE REFERENCE LINE OR SHAPE ON THE INDEX, THEN CIRCLE THE CORNER LOCATION AND SPECIFY THE NEAREST INDEX CODE TO THE NORTH OR WEST (IF ON A GRID LINE), OR AT THE NORTHWEST CORNER OF THE GRID BLOCK.

MONUMENT FIELD VISIT INFORMATION

DATE OF FIELD VISIT: DEC 11, 2001

MONUMENT:

LEFT AS FOUND FOUND & TAGGED FOUND & RESULT

RESTORED LOST CORNER ESTABLISHED NEW ACCESSORIES

STATE PLANE COORDINATES: ESTABLISHED TO _____ ORDER

ZONE: WEST CENTRAL EAST NOT ESTABLISHED

DATA: N.A.D. 1927 (FEET) N.A.V.D. 1929 (FEET)

Y= _____ X= _____ Z= _____

N.A.D. 1983 (METERS) N.A.V.D. 1988 (METERS)

N= _____ E= _____ Z= _____

LAT. _____ NORTH. LONG. _____ WEST

SEGD HEIGHT _____ SCALE FACTOR _____

CONTROL STATIONS USED: RM 83A ELEV = 4527.205

TOWNSHIP INDEX

SCALE: 1" = 16,000'

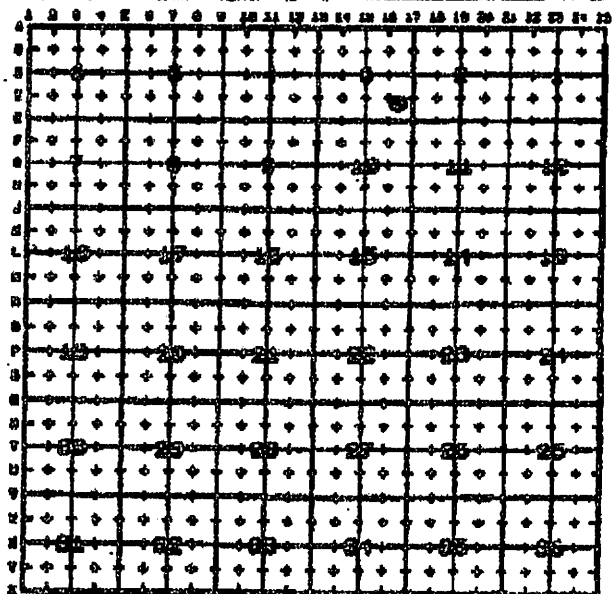

DESCRIBE RECORD EVIDENCE FOUND, INCLUDING TIES AND ACCESSORIES, OR IF A MONUMENT NOT OF RECORD, TELL WHY YOU ACCEPTED IT AS VALID. DESCRIBE ANY ACTIONS TAKEN BY YOU TO REHABILITATE OR PERPETUATE THIS MONUMENT IF FOUND IN PERISHABLE OR DETERIORATED CONDITION. IF NO EVIDENCE OF THE ORIGINAL MONUMENT OR ITS LOCATION CAN BE FOUND, DESCRIBE THE PROCEDURE FOLLOWED IN THE RESTORATION OF THE MONUMENT AND THE CONTROLLING CORNERS USED, INCLUDING ALL RECORD OF SURVEY REFERENCES. DESCRIBE ANY NEW MONUMENT SET (INCLUDING ACCESSORY MONUMENTS) AS TO MATERIAL, SHAPE, MARKING, PROJECTION OR BURIAL, AND DISPOSITION OF OLD MONUMENT. DESCRIBE NEW TIES AND ACCESSORIES IN COORDINATION WITH THE SKETCH ON THE REVERSE. DESCRIBE ANY COMPLICATING MONUMENTS OR EVIDENCE AND YOUR CONCLUSIONS.

RM 83B

SET 2" DIA. YCFGR ALUM. CAPPED 5/8" REBAR
IN CONCRETE @ SW CORNER INTERSECTION
OF HWY 69 & HWY 169

ELEVATION = 4569.715

CORNER MONUMENT CAP STAMPING

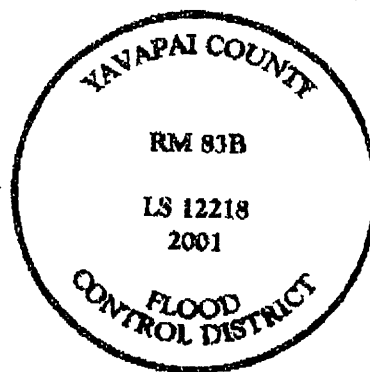

FILED RECORD OF SURVEY IN COUNTY RECORDS AT _____ BOOK _____ PAGE(S) _____
 ATTACHED SHEETS: WRITTEN TESTIMONY FIELD NOTE PAGE(S) OTHER _____

(OVER)

691
M

AZ STATE HWY 69
ASPHALT PAVEMENT 2
(TYPICAL)

APPROX
INTERSECTION

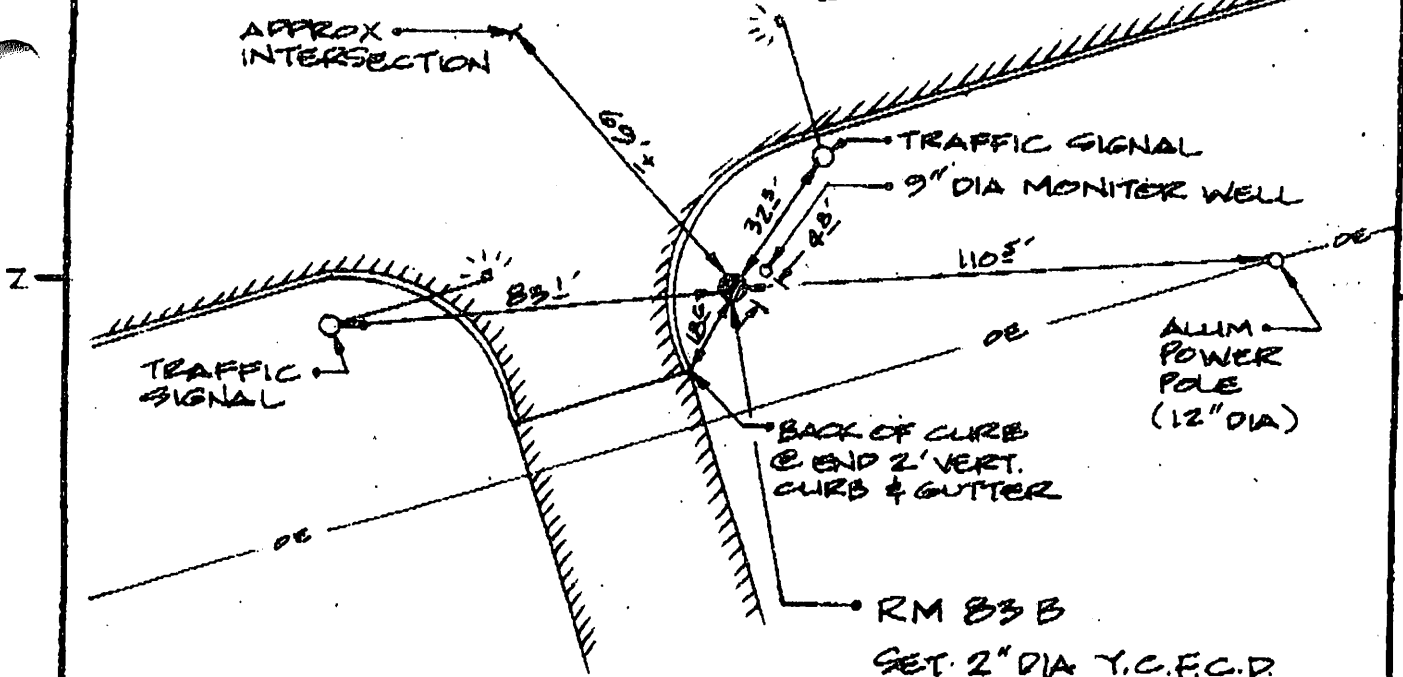

TRAFFIC
SIGNAL

TRAFFIC SIGNAL

9" DIA MONITOR WELL

ALUM
POWER
POLE
(12" DIA)

BACK OF CURB
@ END 2' VERT.
CURB & GUTTER

RM 83 B

SET 2" DIA Y.C.F.C.D.
ALUM CAPPED 5/8" REBAR
IN CONCRETE
ELEV = 4569.715

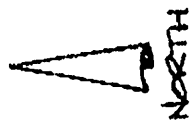

LAND SURVEYOR IDENTIFICATION AND CERTIFICATION

I, DALE W. STONE, ARIZONA R.L.S.
NUMBER 17218, HEREBY CERTIFY THAT THIS CORNER RECORD
WAS PREPARED UNDER MY DIRECTION, THAT ALL MONUMENTATION
ACTUALLY EXISTS AS SHOWN HEREON.

COMPANY NAME JDS ASSOCIATES LLC
 STREET ADDRESS _____
 MAILING ADDRESS PO BOX 3240
 CITY, STATE, ZIP CAMP VERDE, AZ 86317
 TELEPHONE NUMBER (928) 967-8543

