

## ELEVATION REFERENCE MONUMENT

**ERM:** 187  
**Panel:** 990

**Elevation (NAVD88):** 4408.69  
**Elevation (NGVD29):** 4505.98

**Latitude:** 34°55'55" N  
**Longitude:** 112°29'42" W

**Description:** From Paulden, Arizona, go north on Highway 89 approximately 0.6 miles to Big Chino Road, then west (left) on Big Chino Road approximately 1.3 miles to Patricia Road, Then north (right) on Patricia Road approximately 02.2 miles to Gina Marie Boulevard west (left) on Gina Marie Boulevard approximately 0.4 miles to monument.

990

NATIONAL FLOOD INSURANCE PROGRAM

**FIRM**  **ORIGINAL**  
**FLOOD INSURANCE RATE MAP**

YAVAPAI COUNTY,  
ARIZONA AND  
INCORPORATED AREAS

**PANEL 990 OF 3925**  
(SEE MAP INDEX FOR PANELS NOT PRINTED)

<u>CONTAINS:</u> <u>COMMUNITY</u>	<u>NUMBER</u>	<u>PANEL</u>	<u>SUFFIX</u>
YAVAPAI COUNTY, UNINCORPORATED AREAS	040093	0990	F

**MAP NUMBER**  
**04025C0990 F**

**EFFECTIVE DATE:**  
**JUNE 6, 2001**



Federal Emergency Management Agency

0"

...Naples Street, then approximately 0.9 mile to Bayberry Drive, then east (right) on Bayberry Drive approximately 0.6 mile to monument.

RM187 4505.98 From Paulden, Arizona, north on Highway 89 approximately 0.6 mile to Big Chino Road, then west (left) on Big Chino Road approximately 1.3 miles to Patricia Road, north (right) on Patricia Road approximately 2.2 miles to Gina Marie Boulevard west (left) on Gina Marie Boulevard approximately 0.4 mile to monument.

RM189 4451.43 From Paulden, Arizona, go north on Highway 89 approximately 0.6 mile to Big Chino Road, west (left) on Big Chino Road approximately 1.3 miles to Patricia Road, North (right) on Patricia Road approximately 1.3 mile to Ahonen Road, then west (left) on Ahonen Road approximately 0.7 mile to monument.

YFC 1426  
RM190 4474.88 From Paulden, Arizona, north on Highway 89 approximately 0.6 mile to Big Chino road, west on Big Chino Road approximately 1.3 miles to Patricia Road, North (right) on Patricia Road approximately 1.8 miles to monument near the intersection of Patricia Road and Ahonen Road.

Do not use until Resert  
RM191 4405.68 From Paulden, Arizona, north on Highway 89 approximately 0.6 mile to Big Chino Road, west (left) on Big Chino Road approximately 1.3 miles to Patricia Road, then north (right) on Patricia Road approximately .2 miles to monument.

RM307 4371.38 Top of 2 aluminum cap in 8 inch diameter concrete, 0.1 foot above natural ground. From Paulden, Arizona, north on U.S. Highway 89 approximately 0.6 mile to Big Chino Road, west or left on Big Chino Road approximately 0.6 mile to a fork in the road, take the south fork east approximately 2.1 miles to monument. Monument is 24 feet north of dirt road.

RM308 4365.07 Top of 2 inch aluminum cap in 8 inch diameter concrete, 0.1 foot above natural ground. From Paulden, Arizona, north on U.S. Highway 89 approximately 0.6 mile to Big Chino road, west or left on Big Chino road approximately 0.6 mile to a fork in the road. Take south fork east approximately 1.3 miles to monument. Monument is 30 feet north of dirt road.

RM309 4354.68 Top of 2-inch aluminum cap in 8-inch diameter concrete, 0.1 foot above natural ground. From Paulden, Arizona, south on U.S. Highway 89 approximately 0.4 mile to Sweet Valley Road, west or right on Sweet Valley Road approximately 0.5 mile to monument. Monument is 38 feet south of Sweet Valley Road.

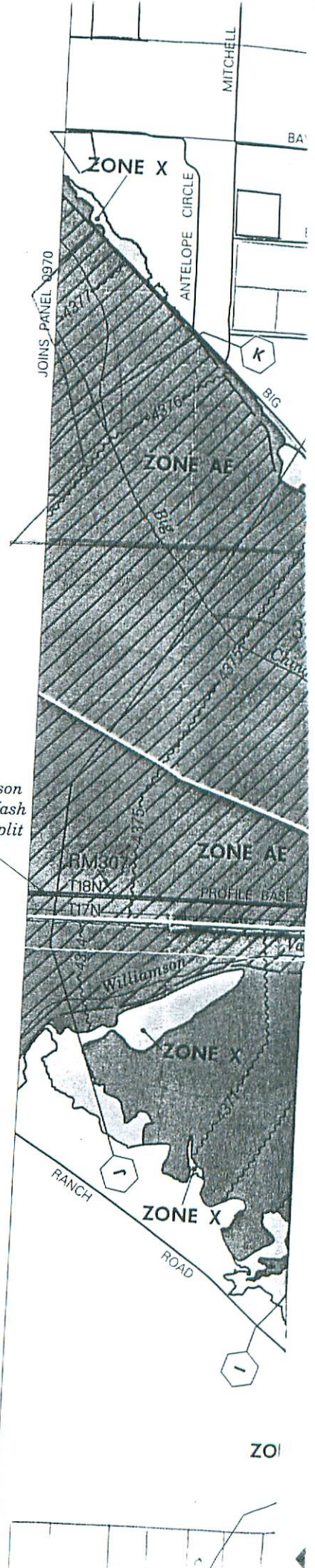

### LEGEND

To obtain more detailed information in areas where Base Flood Elevations (BFEs) and/or floodways have been determined, users are encouraged to consult the Flood Profiles and Floodway Data tables contained within the Flood Insurance Study (FIS) report that accompanies this FIRM. Users should be aware that BFEs shown on the FIRM represent rounded whole-foot elevations and therefore may not exactly reflect the flood elevation data presented in the FIS. BFEs shown on the FIRM are intended for flood insurance rating purposes only and should not be used as the sole source of flood elevation information. Accordingly, flood elevation data presented in the FIS should be utilized in conjunction with other available data.

4

5

ZOI

112°30'00"  
34°56'15"

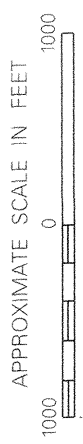
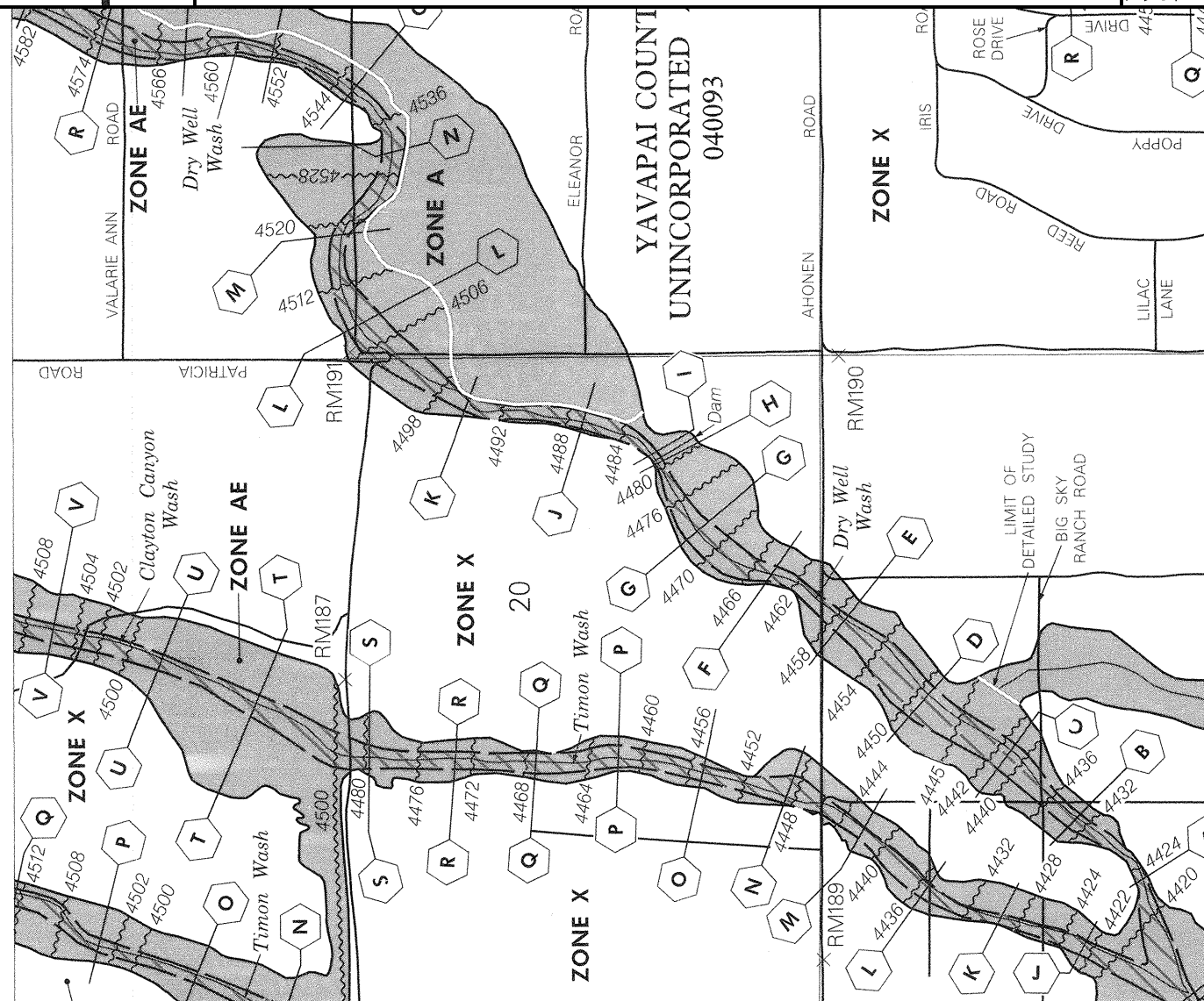

**NATIONAL FLOOD INSURANCE PROGRAM**

**FIRM**  
FLOOD INSURANCE RATE MAP  
YAVAPAI COUNTY,  
ARIZONA AND  
INCORPORATED AREAS

PANEL 990 OF 3925  
(SEE MAP INDEX FOR PANELS NOT PRINTED)

CONTAINS:	COMMUNITY	NUMBER	PANEL	SUFFIX
YAVAPAI COUNTY UNINCORPORATED AREAS		040093	0990	F

**FEDERAL EMERGENCY MANAGEMENT AGENCY**

MAP NUMBER 04025C0990 F  
EFFECTIVE DATE: JUNE 6, 2001

This is an official copy of a portion of the above referenced flood map. It was extracted using F-MIT On-Line. This map does not reflect changes or amendments which may have been made subsequent to the date on the title block. For the latest product information about National Flood Insurance Program flood maps, check the FEMA Flood Map Store at [www.msc.fema.gov](http://www.msc.fema.gov)