

## ELEVATION REFERENCE MONUMENT

**ERM:** 29

**Panel:** 1340

**Elevation (NAVD88):** 4492.33

**Elevation (NGVD29):** 4489.72

**Latitude:** 34°48'44" N

**Longitude:** 112°27'10" W

**Description:** 3-inch BCSM in concrete west of Highway 89 on north side of cattleguard to Hidden Valley Lane.

1340 F

**NATIONAL FLOOD INSURANCE PROGRAM**

**FIRM  
FLOOD INSURANCE RATE MAP**

**YAVAPAI COUNTY,  
ARIZONA AND  
INCORPORATED AREAS**

**PANEL 1340 OF 3925**  
(SEE MAP INDEX FOR PANELS NOT PRINTED)

<u>CONTAINS COMMUNITY</u>	<u>NUMBER</u>	<u>PANEL</u>	<u>SUFFIX</u>
CHINO VALLEY TOWN OF YAVAPAI COUNTY	040094	1340	F
UNINCORPORATED AREAS	040093	1340	F

**MAP NUMBER  
04025C1340 F**

**EFFECTIVE DATE:  
JUNE 6, 2001**



Federal Emergency Management Agency

112°30'00"  
34°48'45"

ELEVATION REFERENCE MARKS  
REFERENCE ELEVATION  
MARK (FEET NGVD) DESCRIPTION OF LOCATION

601 RM1	4552.49	Aerial Mapping Company 1/2-inch rebar with aluminum cap, approximately 31 feet north of West Postle Road centerline, approximately 15 feet north of a barbed wire fence, approximately 315 feet east of wash flowline, on a small hill, approximately 900 feet east of and approximately 50 feet north of the southwest corner of Section 33, T17N, R2W.
Says to 600 RM3	4701.28	Aerial Mapping Company 1/2-inch rebar with aluminum cap, approximately 41 feet southwest of the west end of the first dike south of road 3N, approximately 2,200 feet north of and approximately 2,000 feet east of the southwest corner of Section 17, T16N, R2W.
RM29	4489.7	3-inch BCSM in concrete west of Highway 89 on north side of cattleguard to Hidden Valley Lane.
RM88	5416.99	3-inch BCSM in cattleguard concrete at Highway 89 and Road 5 North (west side of Highway 89).
RM238	4505.41	Standard Yavapai County Flood Control District 2 aluminum cap marked RLS 13941 #6. Located 1,528 feet west centerline of Santa Cruz Wash, 20 feet south of centerline of Road 5 north; 1.55 feet west side of a power pole, 25.46 feet north side of the south down guide of same power pole, 14.28 feet west side of the east down guide of power pole 4, 138.73 feet, N89-05-03E of northeast Section 2; 5,010.05 feet, S56-07-50E of east 1/4 of Section 2.

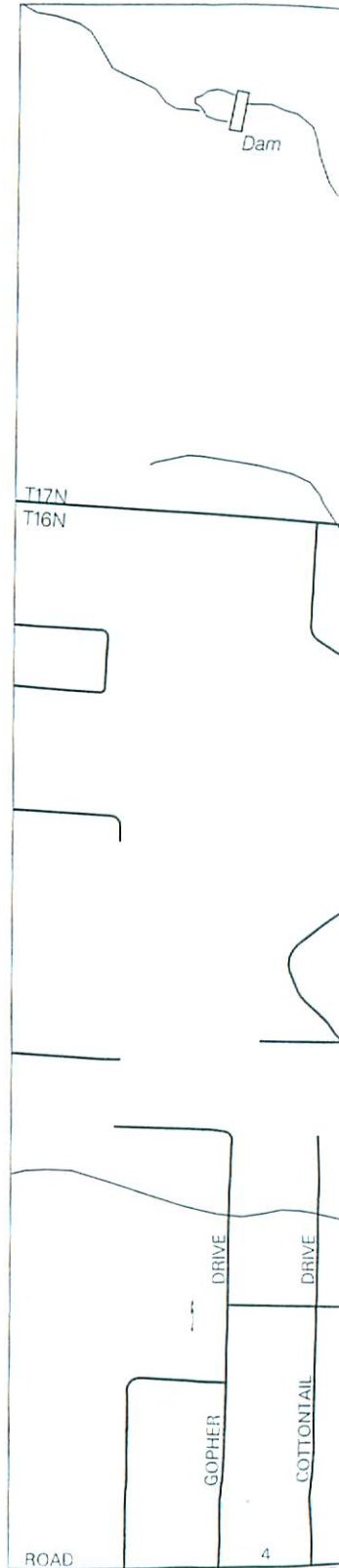

ZONE X

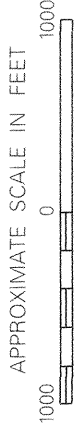

112°26'15"  
34°48'45"

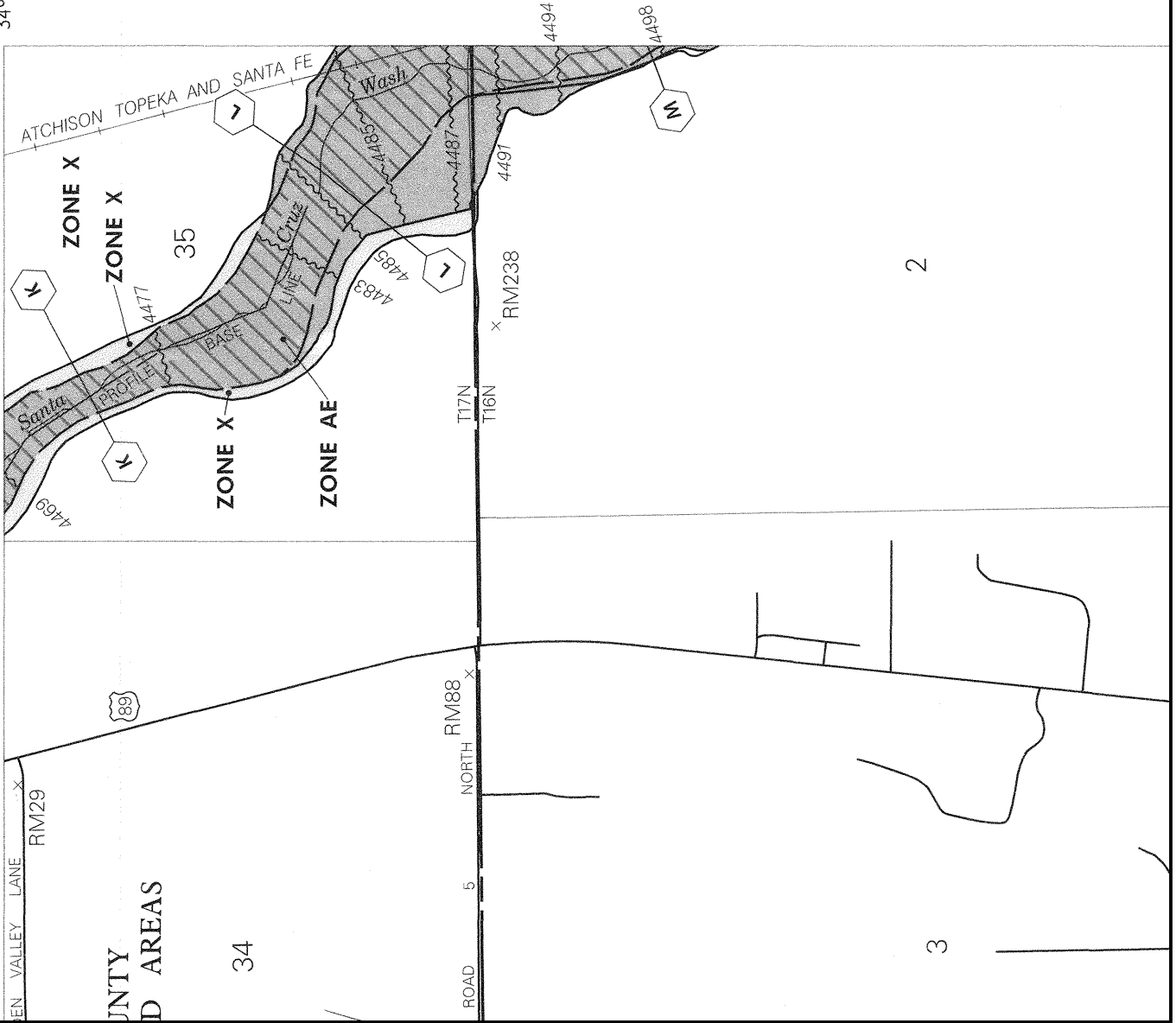

NATIONAL FLOOD INSURANCE PROGRAM

**FIRM**  
FLOOD INSURANCE RATE MAP  
YAVAPAI COUNTY,  
ARIZONA AND  
INCORPORATED AREAS

PANEL 1340 OF 3925  
(SEE MAP INDEX FOR PANELS NOT PRINTED)

CONTAINS:	COMMUNITY	NUMBER	PANEL	SUFFIX
	CHINO VALLEY TOWN OF	040904	1340	F
	YAVAPAI COUNTY	040983	1340	F
	UNINCORPORATED AREAS			

MAP NUMBER  
0402561340 F

EFFECTIVE DATE:  
JUNE 6, 2001



Federal Emergency Management Agency

This is an official copy of a portion of the above referenced flood map. It was extracted using F-MIT On-Line. This map does not reflect changes or amendments which may have been made subsequent to the date on the title block. For the latest product information about National Flood Insurance Program flood maps, check the FEMA Flood Map Store at [www.msc.fema.gov](http://www.msc.fema.gov)

YCFC RM #	FEMA Map #	Suffix	Sec, T, R.	County	Latitude	Longitude	1929 NGVD	1983 NAVD	NOTES
601	04025C1340	F	33 17 2 W	Yavapai	34.80460	112.47300	4,552.490	4,555.137	*Road 5 N, 20 N of fence & "do not enter when flooded" sign
660	04025C1340	F	3 17 2 W	Yavapai	34.76610	112.49470	4,701.280	4,703.964	*aka RM 3, 40 west of old dike & 70' N of Driveway on Neighbor Way
238*	04025C1340	F	2 16 2 W	Yavapai	34.80463	112.44380	4,505.410	4,508.031	*Road 5 N 1' W of telephone pole, 2' S of fence rm#13941
29*	04025C1340	F	34 17 2 W	Yavapai	34.81220	112.45290	4,489.710	4,492.321	*Hwy 89 & 5 1/2 N on N side Cattleguard