

ELEVATION REFERENCE MONUMENT

ERM: 235

Panel: 1345

Elevation (NAVD88): 4623.22

Elevation (NGVD29): 4620.55

Latitude: 34°45'36" N

Longitude: 112°25'54" W

Description: Standard Yavapai County Flood Control District 2 aluminum cap marked RL5 13941 #3. Located 60 feet east of intersection of Road 2 north and Liberty Lane, and 21 feet north of Road 2 north 1.61 feet north side of a power pole on Road 2 North, 45.69 feet east side of a telephone riser, 77.62 feet south side of a power pole on Liberty Street, 4,665.58 feet, S89-57-02W of northwest Section 23; 613.15 feet N89-42-38E of northeast Section 23.

1345

NATIONAL FLOOD INSURANCE PROGRAM

FIRM

ORIGINAL

FLOOD INSURANCE RATE MAP

**YAVAPAI COUNTY,
ARIZONA AND
INCORPORATED AREAS**

PANEL 1345 OF 3925

(SEE MAP INDEX FOR PANELS NOT PRINTED)

CONTAINS
COMMUNITY

NUMBER PANEL SUFFIX

CHINO VALLEY TOWN OF
YAVAPAI COUNTY
UNINCORPORATED AREAS

040094 1345 F
040093 1345 F

**MAP NUMBER
04025C1345 F**

**EFFECTIVE DATE:
JUNE 6, 2001**



Federal Emergency Management Agency

10/17N 1/2W A

B

ELEVATION REFERENCE MARKS
 REFERENCE ELEVATION
 MARK (FEET NGVD) DESCRIPTION OF LOCATION

RM235 4620.55 Standard Yavapai County Flood Control District 2 aluminum cap marked RLS 13941 #3. Located 60 feet east of intersection of Road 2 north and Liberty Lane, and 21 feet north of Road 2 north 1.61 feet north side of a power pole on Road 2 North, 45.69 feet east side of a telephone riser, 77.62 feet south side of a power pole on Liberty Street, 4,665.58 feet, S89-57-02W of northwest Section 23; 613.15 feet N89 42-38E of northeast Section 23.

RM236 4582.92 Standard Yavapai County Flood Control District 2 aluminum cap marked RLS 13941 #4. Located 490 feet east of intersection of Perkinsville Road, and Anthony Lane, 18 feet north of Perkinsville Road, 2.18 feet north side of power pole, 2.62 feet north of a telephone riser, 18.76 feet from a down guide located on east side of a power pole, 3,646.40 feet, N69-10-38 east of N1/4 Section 13; 4,063.90 feet, S11-03-23E of southeast Section 14.

RM237 4571.81 Standard Yavapai County Flood Control District 2 aluminum cap marked RLS 13941 #5. Located 208 feet west of intersection of Granite Creek Lane and Misty Lane, 15 feet north Granite Creek Lane, 2.6 feet on north side of a power pole, 25.28 feet from a guide located on east side of down guide located on east side of same power pole, 3.53 feet north side of a telephone riser, 2,550.65 feet, NE43-40-57E of northeast Section 11; 5,597.54 feet, S52-00-44E of S1/4 of Section 12.

RM239 4505.41 U.S. Coastal and Geodetic Survey brass cap stamped Z-27, located just southeast of the intersection of Road 2 north and the Atchison, Topeka and Santa Fe Railway, in Yavapai County.

112°26'15"
 34°48'45"

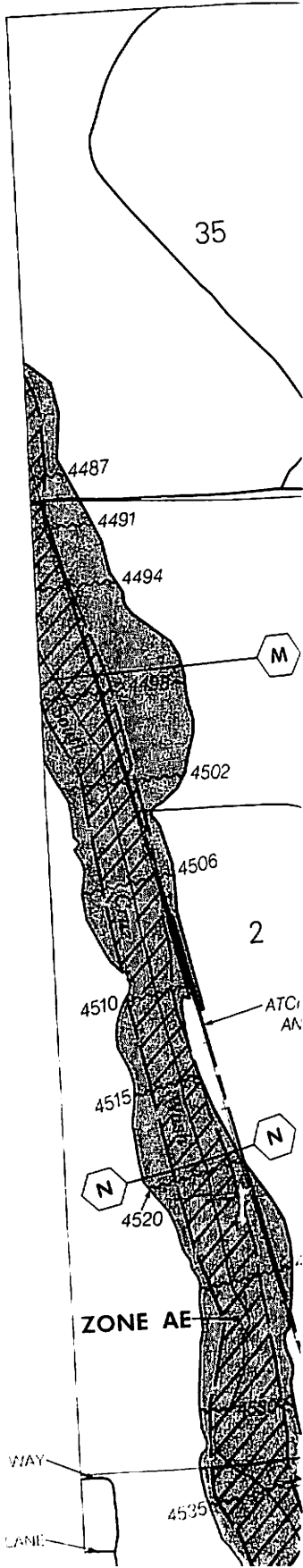

35

2

ZONE AE

COLORADO WAY

FLORIDA LANE

1

2

END

ation in areas where Base Flood
have been determined, users are
Profiles and Floodway Data tables
Study (FIS) report that
aware that BFEs shown on
e-foot elevations and therefore
levation data presented in the FIS
ended for flood insurance rating
used as the sole source of flood
flood elevation data presented
in conjunction with the FIRM for
floodplain management.

up were obtained and/or developed
termination of flood elevations and
this map. Users should be aware
ave changed since the publication
elevation information on National
own on this map, please contact
ch of the NGS at (301) 713-3242,
ngs.noaa.gov. Map users should
RM monument elevations when
action or floodplain management

may apply only landward of 0.0'
uld be aware that coastal flood
e Summary of Stillwater Elevations
study report for this community,
ity of Stillwater Elevations table
y, and /or floodplain management
in the elevations shown on this

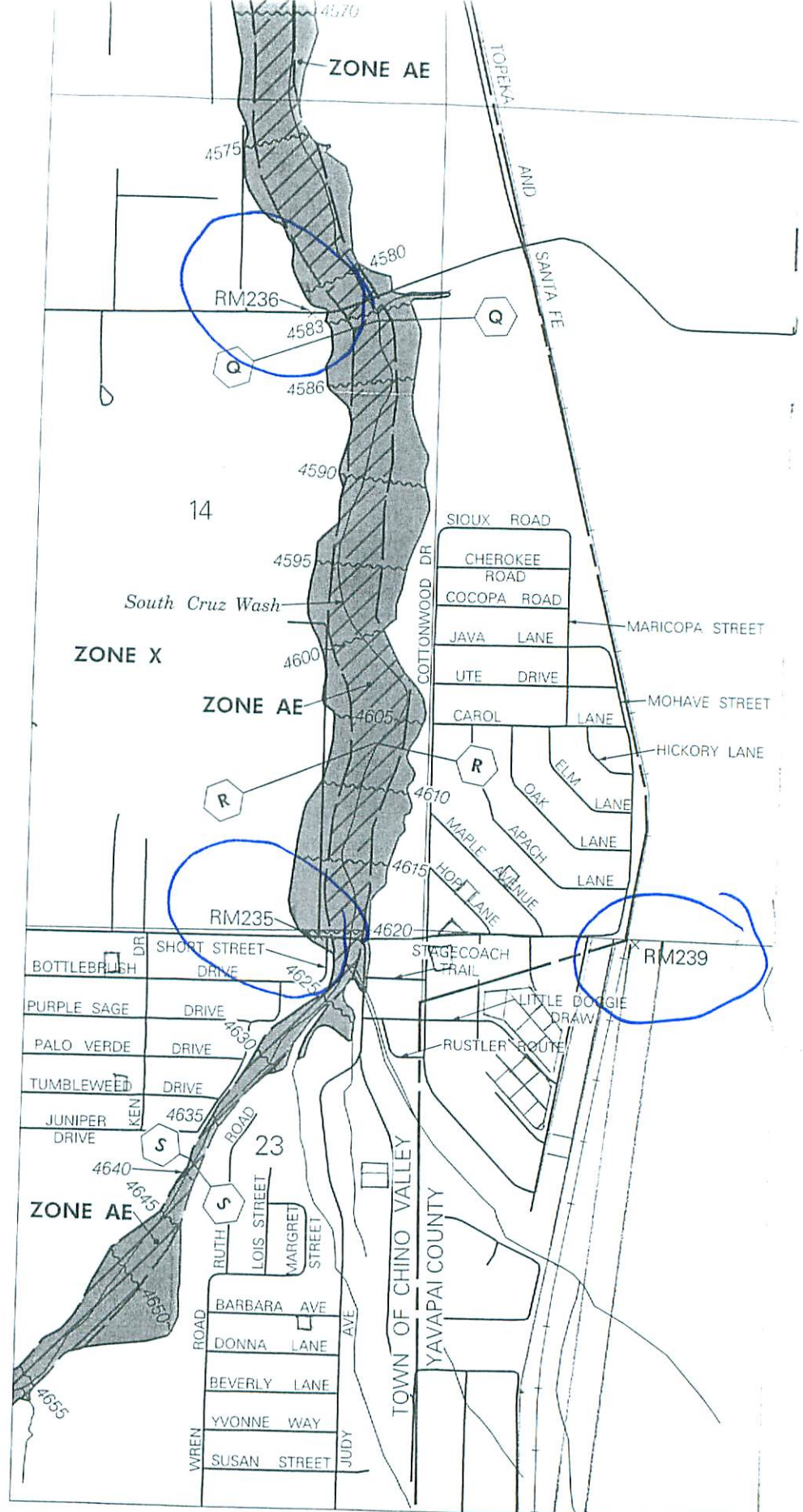

34°45'00"
112°26'15"

*Please see
users quad*