

ELEVATION REFERENCE MONUMENT

ERM: 291

Panel: 2060

Elevation (NAVD88): 5439.77

Elevation (NGVD29): 5436.71

Latitude: 34°34'36" N

Longitude: 112°31'02" W

Description: Aerial Mapping Company chiseled X in southeast side, upstream headwall, approximately 2,200 feet north and approximately 40 feet west of the southeast corner of Section 24, T14N, R2W.

2060

NATIONAL FLOOD INSURANCE PROGRAM

FIRM

OF ORIGINAL

FLOOD INSURANCE RATE MAP

**YAVAPAI COUNTY,
ARIZONA AND
INCORPORATED AREAS**

PANEL 2060 OF 3925

(SEE MAP INDEX FOR PANELS NOT PRINTED)

CONTAINS:

<u>COMMUNITY</u>	<u>NUMBER</u>	<u>PANEL</u>	<u>SUFFIX</u>
PRESOTT CITY OF YAVAPAI COUNTY	040098	2060	F
UNINCORPORATED AREAS	040097	2060	F

**MAP NUMBER
04025C2060 F**

**EFFECTIVE DATE:
JUNE 6, 2001**



Federal Emergency Management Agency

14N 2/3W A

B

1

2

112°33'45"
34°37'30"

ELEVATION REFERENCE MARKS		
REFERENCE ELEVATION MARK	(FEET NGVD)	DESCRIPTION OF LOCATION
RM291	5436.71	Aerial Mapping Company chiseled X in southeast side, upstream headwall, approximately 2,200 feet north and approximately 40 feet west of the southeast corner of Section 24, T14N, R2W.

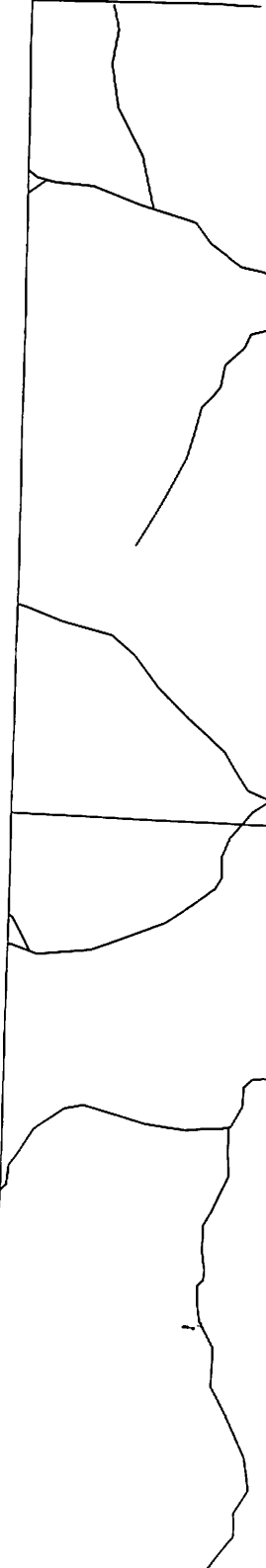

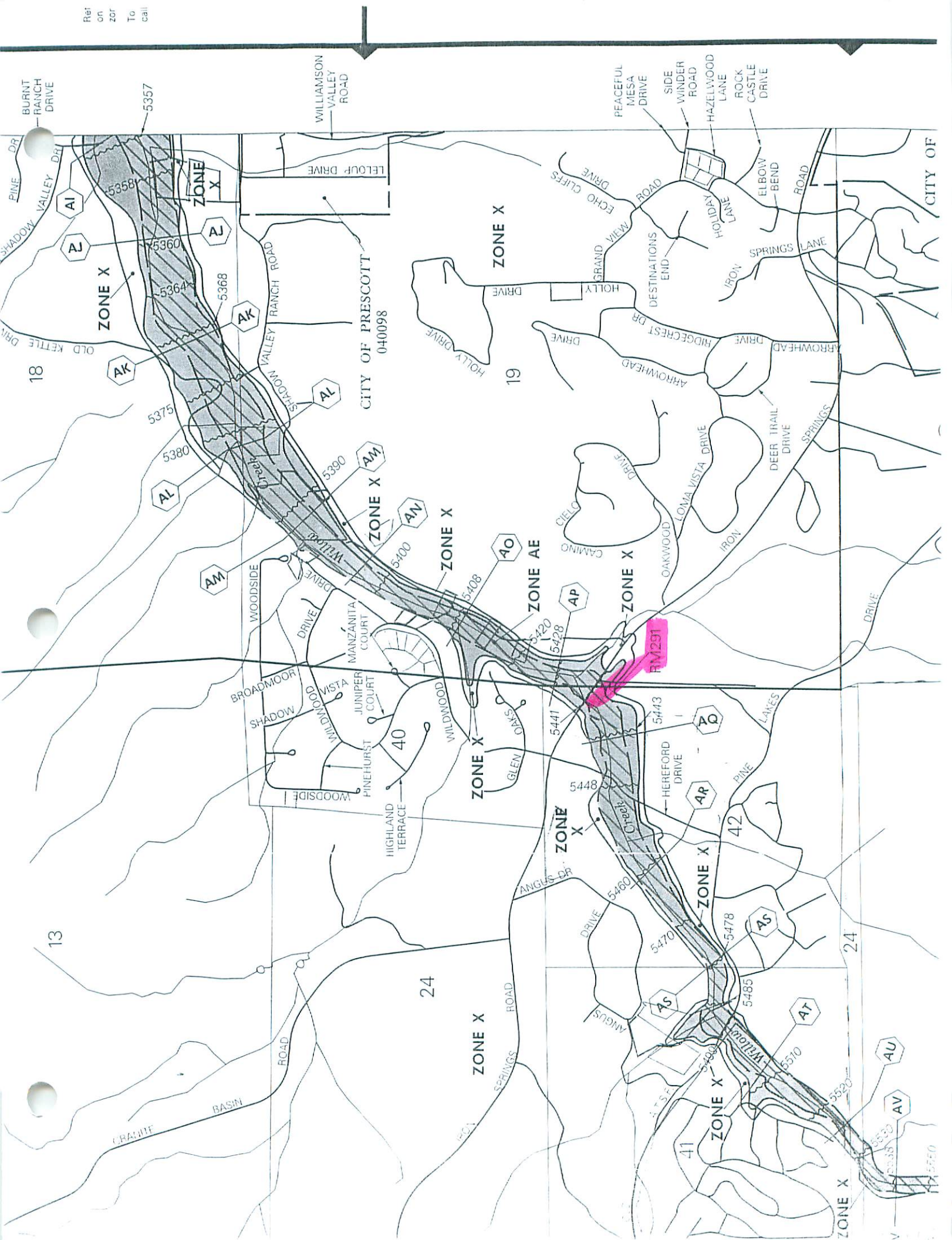



TOLEMAC RD

WILLOW CREEK BRIDGE

RM 291

IRON SPRINGS RD



S42-T14N-R03W

04025C2060F