

ELEVATION REFERENCE MONUMENT

ERM: 159

Panel: 2770

Elevation (NAVD88): 4523.80

Elevation (NGVD29): 4521.03

Latitude: 34°16'30" N

Longitude: 112°45'31" W

Description: Aerial Mapping Company 1/2-inch rebar with aluminum cap, approximately 900 feet north and approximately 250 feet west of southeast corner of Section 22, T11N, R5W, and located approximately 60 feet east southeast of low flow of dry creek bed and approximately 75 feet south-southeast of huge pyramidal rock and approximately 400 feet west-southwest of fence line and located in open area on top of south bank of Model Creek.



APPROXIMATE SCALE IN FEET

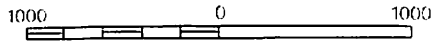

2770

NATIONAL FLOOD INSURANCE PROGRAM

FIRM  **ORIGINAL**
FLOOD INSURANCE RATE MAP

**YAVAPAI COUNTY,
ARIZONA AND
INCORPORATED AREAS**

PANEL 2770 OF 3925

(SEE MAP INDEX FOR PANELS NOT PRINTED)

CONTAINS:

<u>COMMUNITY</u>	<u>NUMBER</u>	<u>PANEL</u>	<u>SUFFIX</u>
YAVAPAI COUNTY UNINCORPORATED AREAS	040093	2770	F

**MAP NUMBER
04025C2770 F**

**EFFECTIVE DATE:
JUNE 6, 2001**



Federal Emergency Management Agency

11N SW

A

B

112°48'45"
34°18'45"

REFERENCE ELEVATION MARK	ELEVATION (FEET NGVD)	DESCRIPTION OF LOCATION
--------------------------	-----------------------	-------------------------

RM159 <i>Verified 3/02 see RM Book</i>	4521.03	Aerial Mapping Company 1/2-inch rebar with aluminum cap, approximately 900 feet north and approximately 250 feet west of southeast corner of Section 22, T11N, R5W, and located approximately 60 feet east-southeast of low flow of dry creek bed and approximately 75 feet south-southeast of huge pyramidal rock and approximately 400 feet west-southwest of fence line and located in open area on top of south bank of Model Creek.
---	---------	--

RM141 <i>Verified 8-26-09 SW</i>	4562.48	1/2-inch iron pin on North line Section 22, T11N, R5W, approximately 700 feet west of northeast corner Section 22, 100 feet west of intersection Trap Road and Pinion Lane, near 4 foot tee post.
-------------------------------------	---------	---



1

2

3

This
it do
local
Spec
cons
flood
cons
Area
A30
Certa
flood
Bound
inter
hydr
Emer
Flood
to F
Corps
shou
limit
This
Resc
unde
For
Sect
For
Map
Ref
on
zon
To
call

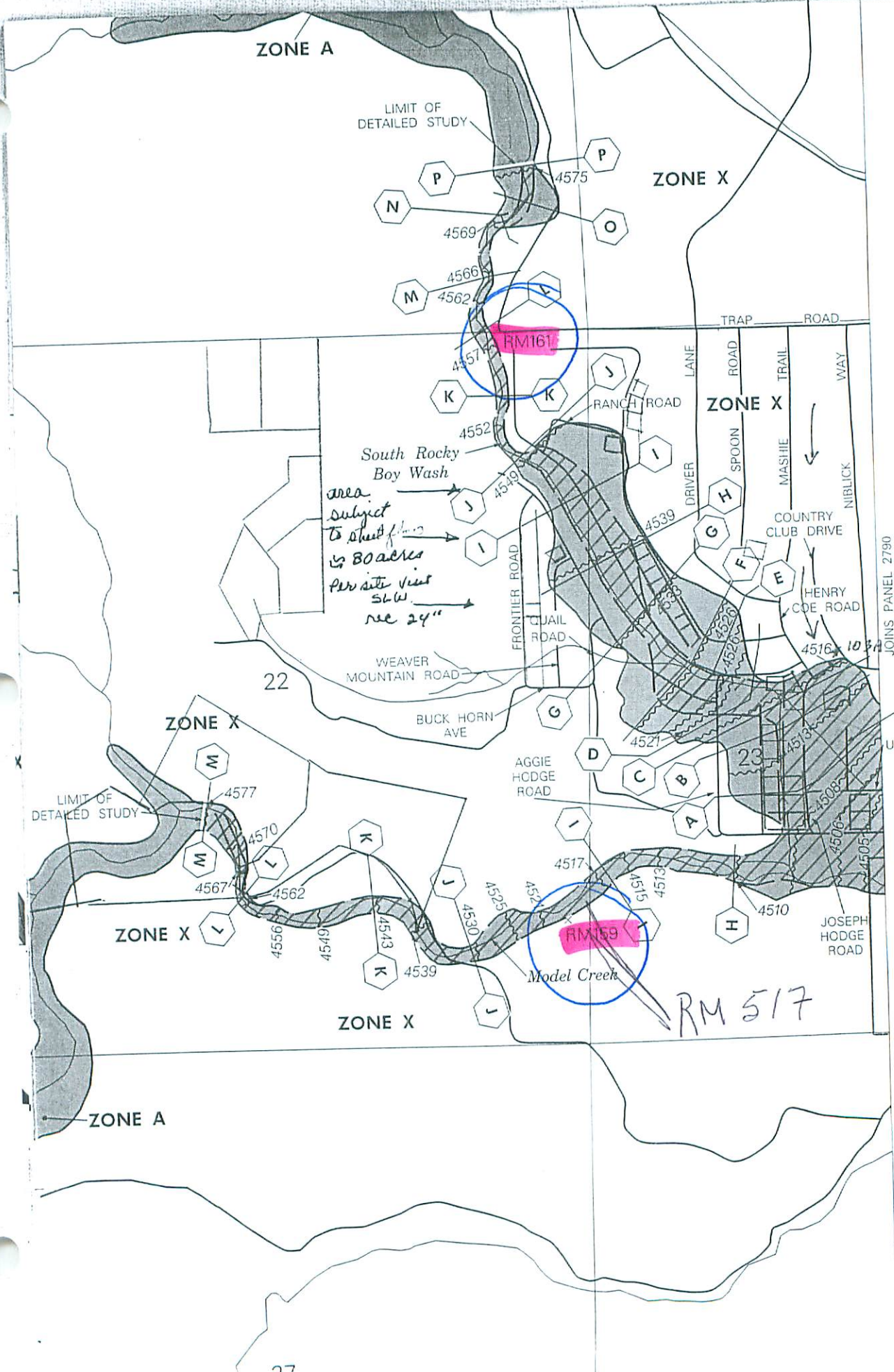

JOINS PANEL 2790

Laughing Water Pass
UNNAMED ROAD

see Peoples Valley final Plat

RM 517

MONUMENT RECORD FORM

CORNER LOCATION INFORMATION

SECTION 22, CORNER INDEX CODE _____
 TOWNSHIP 11 NORTH, RANGE 5 WEST
63R MERIDIAN YAVAPAI COUNTY
 CORNER TYPE:
 ALIQUOT GOV'T COR. NON-ALIQUOT GOV'T COR. OTHER
 FORMAL CORNER NAME: RM 159

NOTES FOR USING TOWNSHIP INDEX TO DETERMINE INDEX CODE
 FOR ALIQUOT SECTION, QUARTER, AND SIXTEENTH CORNERS, PUT
 A CIRCLE AT THE CORNER LOCATION, THEN READ GRID DESIG-
 NATION (A-1 THRU Z-25). A CORNER THAT APPLIES TO TWO
 OR MORE TOWNSHIPS SHOULD BE INDEXED UNDER THE TOWNSHIP
 NORTH OR WEST OF THE CORNER LOCATION AS INDICATED BY
 THE HEAVY LINE ON THE INDEX (GENERALLY THE SOUTH AND
 EAST LINES EXCEPT THE N.E. AND S.W. CORNERS). CLOSING
 CORNERS WILL BE INDEXED UNDER THE TOWNSHIP TO WHICH THEY
 APPLY. FOR 1/64 CORNERS AND FURTHER DIVISIONS, AND
 FOR NON-ALIQUOT CORNERS LYING BETWEEN GRID DESIGNATIONS
 OR WITHIN A GRID SQUARE ON THE INDEX, DRAW AN APPROPRIATE
 REFERENCE LINE OR SHAPE ON THE INDEX, THEN CIRCLE THE
 CORNER LOCATION AND SPECIFY THE NEAREST INDEX CODE TO
 THE NORTH OR WEST (IF ON A GRID LINE), OR AT THE
 NORTHWEST CORNER OF THE GRID BLOCK.

MONUMENT FIELD VISIT INFORMATION

DATE OF FIELD VISIT: MARCH 8, 2002
 MONUMENT:
 LEFT AS FOUND FOUND & TAGGED FOUND & REBUILT
 RESTORED LOST CORNER ESTABLISHED NEW ACCESSORIES
 STATE PLANE COORDINATES: ESTABLISHED TO _____ ORDER
 IE: WEST CENTRAL EAST NOT ESTABLISHED
 A: N.A.D.1927 (FEET) N.A.V.D.1929 (FEET)
 Y= _____ X= _____ EL.= _____
 N.A.D.1983 (METERS) N.A.V.D.1988 (METERS)
 N= _____ E= _____ EL.= _____
 LAT. _____ NORTH. LONG. _____ WEST
 GEOID HEIGHT _____ SCALE FACTOR _____
 CONTROL STATIONS USED: RM 160 PER F.I.R.M.
PANEL 2790

COUNTY FILING INFORMATION

APPLY COUNTY STICKER HERE IF APPLICABLE
 FEE # _____
 DOCKET _____ PAGE _____
 _____ COUNTY, ARIZONA
 DATE _____ HOUR _____
 FEE: _____ PAGES _____
 REQUEST OF: _____

 TITLE: _____
 SUBMITTED TO BE CHECKED FOR COMPLETENESS
 FILED AT REQUEST OF COUNTY REVIEWER

TITLE: _____
 SIGNED: _____ DATE: _____

TOWNSHIP INDEX

SCALE: 1" = 10,000'

A	1	2	3	4	5	6	7	8	9	10	11	12	13	14	15	16	17	18	19	20	21	22	23	24	25
B	+	+	+	+	+	+	+	+	+	+	+	+	+	+	+	+	+	+	+	+	+	+	+	+	+
C	6				5										3					2					
D	+	+	+	+	+	+	+	+	+	+	+	+	+	+	+	+	+	+	+	+	+	+	+	+	+
E																									
F	+	+	+	+	+	+	+	+	+	+	+	+	+	+	+	+	+	+	+	+	+	+	+	+	+
G	7					6																			
H	+	+	+	+	+	+	+	+	+	+	+	+	+	+	+	+	+	+	+	+	+	+	+	+	+
I																									
J																									
K	+	+	+	+	+	+	+	+	+	+	+	+	+	+	+	+	+	+	+	+	+	+	+	+	+
L	10																								
M	+	+	+	+	+	+	+	+	+	+	+	+	+	+	+	+	+	+	+	+	+	+	+	+	+
N																									
O	+	+	+	+	+	+	+	+	+	+	+	+	+	+	+	+	+	+	+	+	+	+	+	+	+
P	13																								
Q	+	+	+	+	+	+	+	+	+	+	+	+	+	+	+	+	+	+	+	+	+	+	+	+	+
R																									
S	+	+	+	+	+	+	+	+	+	+	+	+	+	+	+	+	+	+	+	+	+	+	+	+	+
T	16																								
U	+	+	+	+	+	+	+	+	+	+	+	+	+	+	+	+	+	+	+	+	+	+	+	+	+
V																									
W	+	+	+	+	+	+	+	+	+	+	+	+	+	+	+	+	+	+	+	+	+	+	+	+	+
X	19																								
Y	+	+	+	+	+	+	+	+	+	+	+	+	+	+	+	+	+	+	+	+	+	+	+	+	+
Z																									

DESCRIBE RECORD EVIDENCE FOUND, INCLUDING TIES AND ACCESSORIES, OR IF A
 MONUMENT NOT OF RECORD, TELL WHY YOU ACCEPTED IT AS VALID. DESCRIBE ANY
 ACTIONS TAKEN BY YOU TO REHABILITATE OR PERPETUATE THIS MONUMENT IF
 FOUND IN PERISHABLE OR DETERIORATED CONDITION. IF NO EVIDENCE OF THE
 ORIGINAL MONUMENT OR ITS LOCATION CAN BE FOUND, DESCRIBE THE PROCEDURE
 FOLLOWED IN THE RESTORATION OF THE MONUMENT AND THE CONTROLLING CORNERS
 USED, INCLUDING ALL RECORD OF SURVEY REFERENCES. DESCRIBE ANY NEW MONU-
 MENT SET (INCLUDING ACCESSORY MONUMENTS) AS TO MATERIAL, SHAPE, MARKING,
 PROJECTION OR BURIAL, AND DISPOSITION OF OLD MONUMENT. DESCRIBE NEW
 TIES AND ACCESSORIES IN COORDINATION WITH THE SKETCH ON THE REVERSE.
 DESCRIBE ANY CONFLICTING MONUMENTS OR EVIDENCE AND YOUR CONCLUSIONS.

CORNER MONUMENT CAP STAMPING

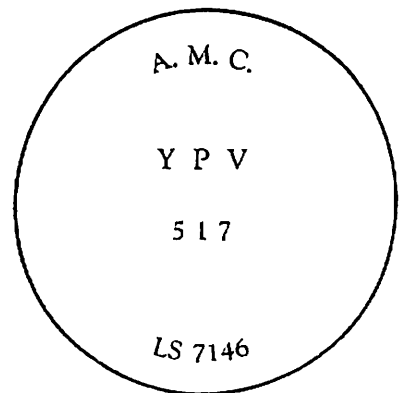

RM 159

FOUND ALUMINUM CAPPED REBAR INTACT
ON SOUTH BANK OF MODEL CREEK

ELEVATION = 4521.03 PER F.I.R.M. PANEL 2770.

FIELD VERIFICATION OF THE ELEVATION WAS FOUND
TO BE 4521.095 FROM RM 160.

FILED RECORD OF SURVEY IN COUNTY RECORDS AT _____ BOOK _____, PAGE(S) _____
 ATTACHED SHEETS: WRITTEN TESTIMONY FIELD NOTE PAGE(S) OTHER _____

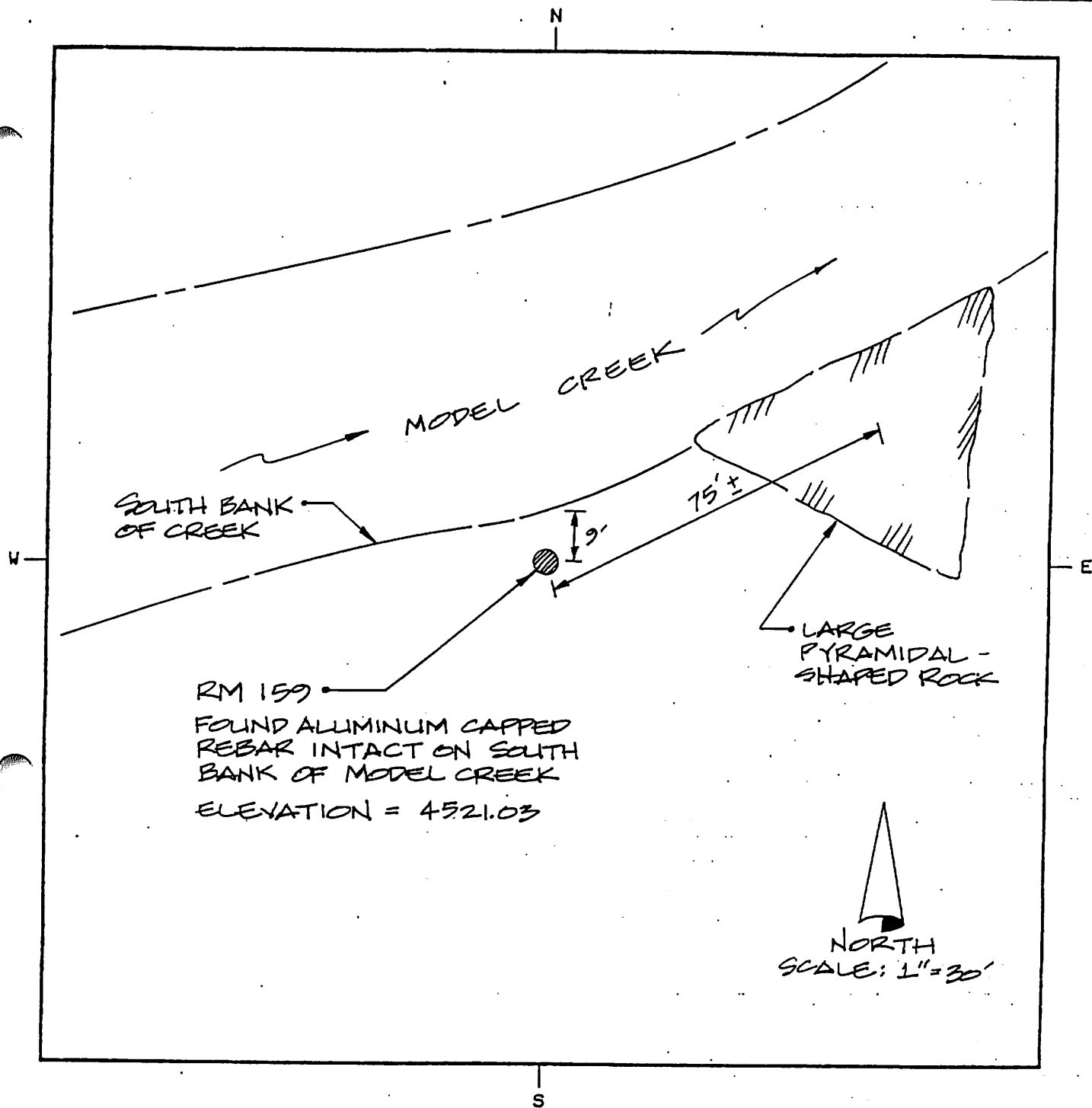

LAND SURVEYOR IDENTIFICATION AND CERTIFICATION

I, JODY A STONE, ARIZONA R.L.S. NUMBER 37401, HEREBY CERTIFY THAT THIS CORNER RECORD WAS PREPARED UNDER MY DIRECTION, THAT ALL MONUMENTATION ACTUALLY EXISTS AS SHOWN HEREON.

COMPANY NAME JDS ASSOCIATED, LLC
 STREET ADDRESS _____
 MAILING ADDRESS PO BOX 3240
 CITY, STATE, ZIP CAMP VERDE, AZ 86322
 TELEPHONE NUMBER (928) 567-8543

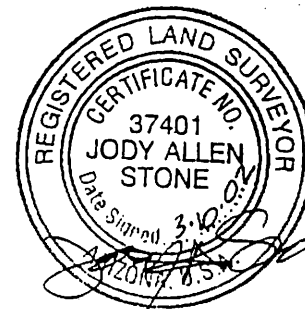

X _____
 SIGNATURE, SEAL AND DATE