

# ELEVATION CERTIFICATE

Important: Read the instructions on pages 1 - 5.

<b>SECTION A - PROPERTY OWNER INFORMATION</b>		For Insurance Company Use:
BUILDING OWNER'S NAME <u>EVELYN M. PARKER</u>		Policy Number
BUILDING STREET ADDRESS (Including Apt., Unit, Suite, and/or Bldg. No.) OR P.O. ROUTE AND BOX NO. <u>1501 W. KELLEY DRIVE</u>		Company NAIC Number
CITY <u>PRESCOTT</u>	STATE <u>AZ.</u>	ZIP CODE <u>86305</u>
PROPERTY DESCRIPTION (Lot and Block Numbers, Tax Parcel Number, Legal Description, etc.) <u>FOR LOT 83 WILLIAMSON VALLEY ESTATES PLAT 4 (102-11-009"D")</u>		
BUILDING USE (e.g., Residential, Non-residential, Addition, Accessory, etc. Use comments section if necessary.) <u>RESIDENTIAL</u>		
LATITUDE/LONGITUDE (OPTIONAL) (##-##-### or ##.#####)	HORIZONTAL DATUM: <input type="checkbox"/> NAD 1927 <input type="checkbox"/> NAD 1983	SOURCE: <input type="checkbox"/> GPS (Type: _____) <input type="checkbox"/> USGS Quad Map <input type="checkbox"/> Other: _____

<b>SECTION B - FLOOD INSURANCE RATE MAP (FIRM) INFORMATION</b>					
B1. NFIP COMMUNITY NAME & COMMUNITY NUMBER <u>YAVAPAI COUNTY 040093</u>		B2. COUNTY NAME <u>YAVAPAI COUNTY</u>		B3. STATE <u>AZ.</u>	
B4. MAP AND PANEL NUMBER <u>64025C1715</u>	B5. SUFFIX <u>F</u>	B6. FIRM INDEX DATE <u>6/6/01</u>	B7. FIRM PANEL EFFECTIVE/REVISED DATE <u>6/6/01</u>	B8. FLOOD ZONE(S) <u>UNSHADED X</u>	B9. BASE FLOOD ELEVATION(S) (Zone AO, use depth of flooding)
B10. Indicate the source of the Base Flood Elevation (BFE) data or base flood depth entered in B9. <input type="checkbox"/> FIS Profile <input type="checkbox"/> FIRM <input type="checkbox"/> Community Determined <input type="checkbox"/> Other (Describe: _____)					
B11. Indicate the elevation datum used for the BFE in B9: <input type="checkbox"/> NGVD 1929 <input type="checkbox"/> NAVD 1988 <input type="checkbox"/> Other (Describe: _____)					
B12. Is the building located in a Coastal Barrier Resources System (CBRS) area or Otherwise Protected Area (OPA)? <input type="checkbox"/> Yes <input checked="" type="checkbox"/> No Designation Date: _____					

<b>SECTION C - BUILDING ELEVATION INFORMATION (SURVEY REQUIRED)</b>	
C1. Building elevations are based on: <input type="checkbox"/> Construction Drawings* <input type="checkbox"/> Building Under Construction* <input checked="" type="checkbox"/> Finished Construction *A new Elevation Certificate will be required when construction of the building is complete.	
C2. Building Diagram Number <u>1</u> (Select the building diagram most similar to the building for which this certificate is being completed - see pages 4 and 5. If no diagram accurately represents the building, provide a sketch or photograph.)	
C3. Elevations - Zones A1-A30, AE, AH, A (with BFE), VE, V1-V30, V (with BFE), AR, AR/A, AR/AE, AR/A1-A30, AR/AH, AR/AO Complete Items C3a-i below according to the building diagram specified in Item C2. State the datum used. If the datum is different from the datum used for the BFE in Section B, convert the datum to that used for the BFE. Show field measurements and datum conversion calculation. Use the space provided or the Comments area of Section D or Section G, as appropriate, to document the datum conversion. Datum _____ Conversion/Comments <u>E.R.M. (SEE ATTACHED)</u>	
Elevation reference mark used <u>5291.36</u> Does the elevation reference mark used appear on the FIRM? <input type="checkbox"/> Yes <input type="checkbox"/> No	
<input checked="" type="checkbox"/> a) Top of bottom floor (including basement or enclosure)	<u>5248</u> . <u>19</u> ft.(m)
<input type="checkbox"/> b) Top of next higher floor	<u>N.A.</u> . _____ ft.(m)
<input type="checkbox"/> c) Bottom of lowest horizontal structural member (V zones only)	<u>N.A.</u> . _____ ft.(m)
<input checked="" type="checkbox"/> d) Attached garage (top of slab)	<u>5247</u> . <u>46</u> ft.(m)
<input type="checkbox"/> e) Lowest elevation of machinery and/or equipment servicing the building	<u>N.A.</u> . _____ ft.(m)
<input checked="" type="checkbox"/> f) Lowest adjacent grade (LAG)	<u>5246</u> . <u>0</u> ft.(m)
<input checked="" type="checkbox"/> g) Highest adjacent grade (HAG)	<u>5247</u> . <u>1</u> ft.(m)
<input type="checkbox"/> h) No. of permanent openings (flood vents) within 1 ft. above adjacent grade	<u>0</u>
<input type="checkbox"/> i) Total area of all permanent openings (flood vents) in C3h	<u>0</u> sq. in. (sq. cm)

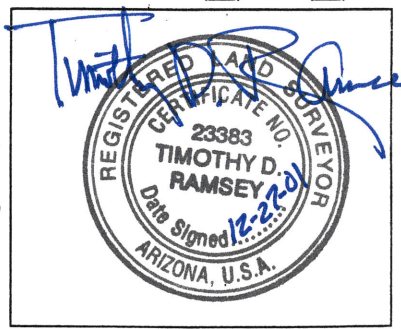

<b>SECTION D - SURVEYOR, ENGINEER, OR ARCHITECT CERTIFICATION</b>			
This certification is to be signed and sealed by a land surveyor, engineer, or architect authorized by law to certify elevation information. I certify that the information in Sections A, B, and C on this certificate represents my best efforts to interpret the data available. I understand that any false statement may be punishable by fine or imprisonment under 18 U.S. Code, Section 1001.			
CERTIFIER'S NAME <u>TIMOTHY D. RAMSEY</u>		LICENSE NUMBER <u>L.S. 23383</u>	
TITLE <u>PRESIDENT</u>	COMPANY NAME <u>RAMSEY SURVEYING, INC.</u>		
ADDRESS <u>2255 W. KRIS COURT</u>	CITY <u>PRESCOTT</u>	STATE <u>AZ.</u>	ZIP CODE <u>86305</u>
SIGNATURE <u>Timothy D. Ramsey</u>	DATE <u>12-27-2001</u>	TELEPHONE <u>928-778-5043</u>	

<b>IMPORTANT: In these spaces, copy t</b>	<b>Corresponding information from Section A.</b>	For Insurance Company Use:
BUILDING STREET ADDRESS (Including Apt., unit, Suite, and/or Bldg. No.) OR P.O. ROUTE AND BOX NO. 1501 W. KELLEY DRIVE		Policy Number
CITY PRESCOTT	STATE AZ	ZIP CODE 86305
		Company NAIC Number

**SECTION D - SURVEYOR, ENGINEER, OR ARCHITECT CERTIFICATION (CONTINUED)**

Copy both sides of this Elevation Certificate for (1) community official, (2) insurance agent/company, and (3) building owner.

COMMENTS SITE BUILT RESIDENTIAL STRUCTURE, ELEV. OF FINISHED FLOOR IS 5248.19, REQUIREMENT FOR FINISHED FLOOR IS 5247.0 PER YAVAPAI COUNTY FLOOD CONTROL DISTRICT. TOP OF GARAGE SLAB IS ELEV. 5247.46

Check here if attachments

**SECTION E - BUILDING ELEVATION INFORMATION (SURVEY NOT REQUIRED) FOR ZONES AO and A (WITHOUT BFE)**

For Zones AO and A (without BFE), complete Items E1 through E3. If the Elevation Certificate is intended for use as supporting information for a LOMA or LOMR-F, Section C must be completed.

- E1. Building Diagram Number \_\_\_\_\_ (Select the building diagram most similar to the building for which this certificate is being completed – see pages 4 and 5. If no diagram accurately represents the building, provide a sketch or photograph.)
- E2. The top of the bottom floor (including basement or enclosure) of the building is \_\_\_\_\_ ft.(m) \_\_\_\_\_ in.(cm) \_\_\_\_\_ above or \_\_\_\_\_ below (check one) the highest adjacent grade.
- E3. For Zone AO only: If no flood depth number is available, is the top of the bottom floor elevated in accordance with the community's floodplain management ordinance?  Yes  No  Unknown. The local official must certify this information in Section G.

**SECTION F - PROPERTY OWNER (OR OWNER'S REPRESENTATIVE) CERTIFICATION**

The property owner or owner's authorized representative who completes Sections A, B, and E for Zone A (without a FEMA-issued or community-issued BFE) or Zone AO must sign here.

PROPERTY OWNER'S OR OWNER'S AUTHORIZED REPRESENTATIVE'S NAME			
ADDRESS	CITY	STATE	ZIP CODE
SIGNATURE	DATE	TELEPHONE	
COMMENTS			

Check here if attachments

**SECTION G - COMMUNITY INFORMATION (OPTIONAL)**

The local official who is authorized by law or ordinance to administer the community's floodplain management ordinance can complete Sections A, B, C (or E), and G of this Elevation Certificate. Check the applicable box(es) and sign below.

- G1.  The information in Section C was taken from other documentation that has been signed and embossed by a licensed surveyor, engineer, or architect who is authorized by state or local law to certify elevation information. (Indicate the source and date of the elevation data in the Comments area below.)
- G2.  A community official completed Section E for a building located in Zone A (without a FEMA-issued or community-issued BFE) or Zone AO.
- G3.  The following information (Items G4-G9) is provided for community floodplain management purposes.

G4. PERMIT NUMBER	G5. DATE PERMIT ISSUED	G6. DATE CERTIFICATE OF COMPLIANCE/OCCUPANCY ISSUED
-------------------	------------------------	---

- G7. This permit has been issued for:  New Construction  Substantial Improvement
- G8. Elevation of as-built lowest floor (including basement) of the building is: \_\_\_\_\_ ft.(m) Datum: \_\_\_\_\_
- G9. BFE or (in Zone AO) depth of flooding at the building site is: \_\_\_\_\_ ft.(m) Datum: \_\_\_\_\_

LOCAL OFFICIAL'S NAME	TITLE
COMMUNITY NAME	TELEPHONE
SIGNATURE	DATE
COMMENTS	

Check here if attachments