

ELEVATION CERTIFICATE

Important: Read the instructions on pages 1-9.

OMB No. 1560-0008
 Expiration Date: July 31, 2015

SECTION A - PROPERTY INFORMATION	FOR INSURANCE COMPANY USE
A1. Building Owner's Name JAMES and DAWN HIXENBAUGH	Policy Number:
A2. Building Street Address (including Apt., Unit, Suite, and/or Bldg. No.) or P.O. Route and Box No. 7435 E. LIGHTHOUSE LANE	Company NAIC Number:
City PRESCOTT VALLEY State AZ ZIP Code 86315	
A3. Property Description (Lot and Block Numbers, Tax Parcel Number, Legal Description, etc.) APN 103-01-195S, A PORTION OF LOT 30 POQUITO VALLEY, SEC 14,T15N, R1W, G&SRB&M	
A4. Building Use (e.g., Residential, Non-Residential, Addition, Accessory, etc.) RESIDENTIAL	
A5. Latitude/Longitude: Lat. 34 41'17.7" Long. 112 20'2.4" Horizontal Datum: <input type="checkbox"/> NAD 1927 <input checked="" type="checkbox"/> NAD 1983	
A6. Attach at least 2 photographs of the building if the Certificate is being used to obtain flood insurance.	
A7. Building Diagram Number 8	
A8. For a building with a crawlspace or enclosure(s):	A9. For a building with an attached garage:
a) Square footage of crawlspace or enclosure(s) 2,016 sq ft	a) Square footage of attached garage 0 sq ft
b) Number of permanent flood openings in the crawlspace or enclosure(s) within 1.0 foot above adjacent grade 12	b) Number of permanent flood openings in the attached garage within 1.0 foot above adjacent grade 0
c) Total net area of flood openings in A8.b 1344 sq in	c) Total net area of flood openings in A9.b 0 sq in
d) Engineered flood openings? <input type="checkbox"/> Yes <input checked="" type="checkbox"/> No	d) Engineered flood openings? <input type="checkbox"/> Yes <input checked="" type="checkbox"/> No

SECTION B - FLOOD INSURANCE RATE MAP (FIRM) INFORMATION

B1. NFIP Community Name & Community Number YAVAPAI 040093		B2. County Name YAVAPAI COUNTY, UNINCORPORATED AREA		B3. State AZ	
B4. Map/Panel Number 04025C1725	B5. Suffix G	B6. FIRM Index Date 9-3-2010	B7. FIRM Panel Effective/Revised Date 9-3-2010/10-8-2013	B8. Flood Zone(s) AE	B9. Base Flood Elevation(s) (Zone AO, use base flood depth) 4851.0'
B10. Indicate the source of the Base Flood Elevation (BFE) data or base flood depth entered in Item B9. <input checked="" type="checkbox"/> FIS Profile <input type="checkbox"/> FIRM <input type="checkbox"/> Community Determined <input type="checkbox"/> Other/Source: _____					
B11. Indicate elevation datum used for BFE in Item B9: <input type="checkbox"/> NGVD 1929 <input checked="" type="checkbox"/> NAVD 1988 <input type="checkbox"/> Other/Source: _____					
B12. Is the building located in a Coastal Barrier Resources System (CBRS) area or Otherwise Protected Area (OPA)? <input type="checkbox"/> Yes <input checked="" type="checkbox"/> No Designation Date: _____ <input type="checkbox"/> CBRS <input type="checkbox"/> OPA					

SECTION C - BUILDING ELEVATION INFORMATION (SURVEY REQUIRED)

C1. Building elevations are based on: Construction Drawings* Building Under Construction* Finished Construction
 *A new Elevation Certificate will be required when construction of the building is complete.

C2. Elevations - Zones A1-A30, AE, AH, A (with BFE), VE, V1-V30, V (with BFE), AR, AR/A, AR/AE, AR/A1-A30, AR/AH, AR/AO. Complete Items C2.a-h below according to the building diagram specified in Item A7. In Puerto Rico only, enter meters.
 Benchmark Utilized: **POQERM1** Vertical Datum: **4906.73' NAVD88**
 Indicate elevation datum used for the elevations in items a) through h) below. NGVD 1929 NAVD 1988 Other/Source: _____
 Datum used for building elevations must be the same as that used for the BFE.

	Check the measurement used.
a) Top of bottom floor (including basement, crawlspace, or enclosure floor) 4846.3	<input checked="" type="checkbox"/> feet <input type="checkbox"/> meters
b) Top of the next higher floor 4849.1	<input checked="" type="checkbox"/> feet <input type="checkbox"/> meters
c) Bottom of the lowest horizontal structural member (V Zones only) NA	<input type="checkbox"/> feet <input type="checkbox"/> meters
d) Attached garage (top of slab) NA	<input type="checkbox"/> feet <input type="checkbox"/> meters
e) Lowest elevation of machinery or equipment servicing the building (Describe type of equipment and location in Comments) 4846.6	<input checked="" type="checkbox"/> feet <input type="checkbox"/> meters
f) Lowest adjacent (finished) grade next to building (LAG) 4846.0	<input checked="" type="checkbox"/> feet <input type="checkbox"/> meters
g) Highest adjacent (finished) grade next to building (HAG) 4846.4	<input checked="" type="checkbox"/> feet <input type="checkbox"/> meters
h) Lowest adjacent grade at lowest elevation of deck or stairs, including structural support 4846.3	<input checked="" type="checkbox"/> feet <input type="checkbox"/> meters

SECTION D - SURVEYOR, ENGINEER, OR ARCHITECT CERTIFICATION

This certification is to be signed and sealed by a land surveyor, engineer, or architect authorized by law to certify elevation information. I certify that the information on this Certificate represents my best efforts to interpret the data available. I understand that any false statement may be punishable by fine or imprisonment under 18 U.S. Code, Section 1001.

Check here if comments are provided on back of form. Were latitude and longitude in Section A provided by a licensed land surveyor? Yes No
 Check here if attachments.

Certifier's Name **DALE FAMAS** License Number **LS 27738**
 Title **LAND SURVEYOR** Company Name **EMPIRE SURVEYING**
 Address **PO BOX 67** City **PAULDEN** State **AZ** ZIP Code **86334**
 Signature *DALE FAMAS* Date **4-15-14** Telephone **(928)-636-6992**

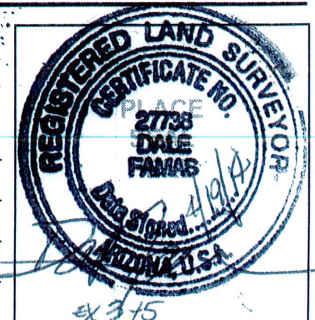

ELEVATION CERTIFICATE, page 2

IMPORTANT: In these spaces, copy the corresponding information from Section A.	FOR INSURANCE COMPANY USE
Building Street Address (including Apt., Unit, Suite, and/or Bldg. No.) or P.O. Route and Box No. 7435 E. LIGHTHOUSE LANE	Policy Number:
City PRESCOTT VALLEY State AZ ZIP Code 86334	Company NAIC Number:

SECTION D – SURVEYOR, ENGINEER, OR ARCHITECT CERTIFICATION (CONTINUED)

Copy both sides of this Elevation Certificate for (1) community official, (2) insurance agent/company, and (3) building owner.

Comments MANUFACTURED HOME ON BLOCK SKIRTING FF ELEV= 4849.1', BOTTOM FRAME EL= 4848.1', AC UNIT ON PAD EL=4846.6', GAS WATER HEATER EL= 4849.1', ELECTRIC METER PEDESTAL EL= 4848.8' DETACHED 1,211 SF GARAGE ON SLAB FF EL= 4846.8', NO FLOOD VENTS 176 SF WOOD FRAME SHED ON SLAB FF EL= 4846.3', NO FLOOD VENTS

Signature *Dale Jarm* Date 4-15-14

SECTION E – BUILDING ELEVATION INFORMATION (SURVEY NOT REQUIRED) FOR ZONE AO AND ZONE A (WITHOUT BFE)

For Zones AO and A (without BFE), complete Items E1–E5. If the Certificate is intended to support a LOMA or LOMR-F request, complete Sections A, B, and C. For Items E1–E4, use natural grade, if available. Check the measurement used. In Puerto Rico only, enter meters.

- E1. Provide elevation information for the following and check the appropriate boxes to show whether the elevation is above or below the highest adjacent grade (HAG) and the lowest adjacent grade (LAG).
 - a) Top of bottom floor (including basement, crawlspace, or enclosure) is _____ feet meters above or below the HAG.
 - b) Top of bottom floor (including basement, crawlspace, or enclosure) is _____ feet meters above or below the LAG.
- E2. For Building Diagrams 6–9 with permanent flood openings provided in Section A Items 8 and/or 9 (see pages 8–9 of Instructions), the next higher floor (elevation C2.b in the diagrams) of the building is _____ feet meters above or below the HAG.
- E3. Attached garage (top of slab) is _____ feet meters above or below the HAG.
- E4. Top of platform of machinery and/or equipment servicing the building is _____ feet meters above or below the HAG.
- E5. Zone AO only: If no flood depth number is available, is the top of the bottom floor elevated in accordance with the community's floodplain management ordinance? Yes No Unknown. The local official must certify this information in Section G.

SECTION F – PROPERTY OWNER (OR OWNER'S REPRESENTATIVE) CERTIFICATION

The property owner or owner's authorized representative who completes Sections A, B, and E for Zone A (without a FEMA-issued or community-issued BFE) or Zone AO must sign here. The statements in Sections A, B, and E are correct to the best of my knowledge.

Property Owner's or Owner's Authorized Representative's Name _____

Address _____	City _____	State _____	ZIP Code _____
Signature _____	Date _____	Telephone _____	

Comments _____

Check here if attachments.

SECTION G – COMMUNITY INFORMATION (OPTIONAL)

The local official who is authorized by law or ordinance to administer the community's floodplain management ordinance can complete Sections A, B, C (or E), and G of this Elevation Certificate. Complete the applicable item(s) and sign below. Check the measurement used in Items G8–G10. In Puerto Rico only, enter meters.

- G1. The information in Section C was taken from other documentation that has been signed and sealed by a licensed surveyor, engineer, or architect who is authorized by law to certify elevation information. (Indicate the source and date of the elevation data in the Comments area below.)
- G2. A community official completed Section E for a building located in Zone A (without a FEMA-issued or community-issued BFE) or Zone AO.
- G3. The following information (Items G4–G10) is provided for community floodplain management purposes.

G4. Permit Number _____	G5. Date Permit Issued _____	G6. Date Certificate Of Compliance/Occupancy Issued _____
-------------------------	------------------------------	---

- G7. This permit has been issued for: New Construction Substantial Improvement
- G8. Elevation of as-built lowest floor (including basement) of the building: _____ feet meters Datum _____
- G9. BFE or (in Zone AO) depth of flooding at the building site: _____ feet meters Datum _____
- G10. Community's design flood elevation: _____ feet meters Datum _____

Local Official's Name _____	Title _____
Community Name _____	Telephone _____
Signature _____	Date _____

Comments _____

Insurance

Check here if attachments.

Building Photographs

See Instructions for Item A6.

IMPORTANT: In these spaces, copy the corresponding information from Section A.

FOR INSURANCE COMPANY USE

Building Street Address (including Apt., Unit, Suite, and/or Bldg. No.) or P.O. Route and Box No.
7435 E. LIGHTHOUSE LANE

Policy Number:

City PRESCOTT VALLEY

State AZ

ZIP Code 86315

Company NAIC Number:

If using the Elevation Certificate to obtain NFIP flood insurance, affix at least 2 building photographs below according to the instructions for Item A6. Identify all photographs with date taken; "Front View" and "Rear View"; and, if required, "Right Side View" and "Left Side View." When applicable, photographs must show the foundation with representative examples of the flood openings or vents, as indicated in Section A8. If submitting more photographs than will fit on this page, use the Continuation Page.



FRONT AND NORTH SIDE OF HOUSE AND GARAGE LOOKING SOUTHEAST FROM ROAD 4-14-2014



BACK AND SOUTH SIDE OF HOUSE AND GARAGE LOOKING NORTHWESTERLY 4-14-2014

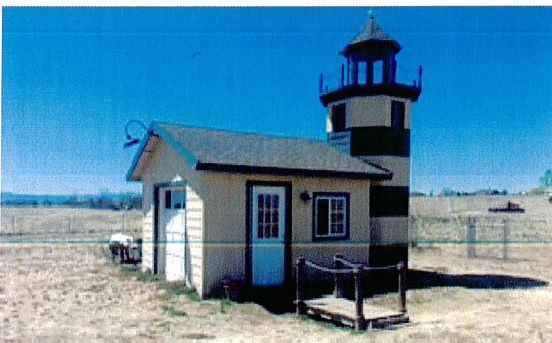

NORTH AND EAST SIDE SHED LOOKING SOUTH
4-14-2014



SOUTH AND WEST SIDE SHED LOOKING NORTH
4-14-2014

ELEVATION CERTIFICATE SKETCH

APN 103-01-195S

SEC. 11, T15N, R1W, G & SRB & M., YAVAPAI COUNTY, ARIZONA

DATE OF SURVEY

APRIL, 2014

DRAWING SCALE

1 IN = 60 FT



S89°56'23"W 328.27'

LIGHTHOUSE LANE

□
ELECTRIC PEDESTAL
ELEV= 4848.8'

1,211 SF
GARAGE
FF ELEV= 4846.8'

2,016 SF
MANUFACTURED HOME
FF ELEV= 4849.1'

□
176 SF
SHED
FF ELEV= 4846.3'

AC PAD EL=4846.6'

LAG=4846.0'
HAG=4846.4'

N89°56'35"E 328.23'

N00°08'42"W

330.33'

N00°08'19"W

330.38'

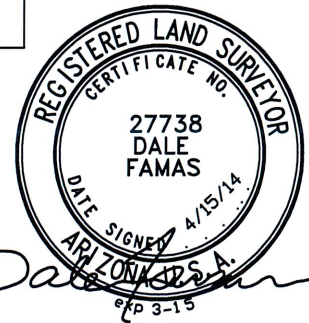

EMPIRE SURVEYING, Inc
P.O. BOX 67 PAULDEN AZ 86334
PHONE (928)-636-6992 FAX 636-6993

SURVEY FOR: HIXENBAUGH

DATE DRAWN: 4-15-14

DRAWN BY: DEF

FILE NO.: Y14056

DRAWING: 056Y14