

FEDERAL EMERGENCY MANAGEMENT AGENCY  
NATIONAL FLOOD INSURANCE PROGRAM

O.M.B. No. 3067-0077  
Expires July 31, 2002

ELEVATION CERTIFICATE

Important: Read the instructions on pages 1 - 5.

SECTION A - PROPERTY OWNER INFORMATION

BUILDING OWNER'S NAME		For Insurance Company Use:	
BUILDING STREET ADDRESS (Including Apt., Unit, Suite, and/or Bldg. No.) OR P.O. ROUTE AND BOX NO. <u>2680 TOLEMAC RD.</u>		Policy Number	
CITY <u>PRESCOTT</u>	STATE <u>AZ</u>	Company NAIC Number	
PROPERTY DESCRIPTION (Lot and Block Numbers, Tax Parcel Number, Legal Description, etc.) <u>LOT 6 KINGSWOOD HEIGHTS UNIT 1 - A.P.N. 115-02-084</u>		ZIP CODE	
BUILDING USE (e.g., Residential, Non-residential, Addition, Accessory, etc. Use comments section if necessary.) <u>RESIDENTIAL</u>			
LATITUDE/LONGITUDE (OPTIONAL) (##° - ##' - ###.###" or ###.#####°)	HORIZONTAL DATUM: <input type="checkbox"/> NAD 1927 <input type="checkbox"/> NAD 1983	SOURCE: <input type="checkbox"/> GPS (Type: _____) <input type="checkbox"/> USGS Quad Map <input type="checkbox"/> Other: _____	

SECTION B - FLOOD INSURANCE RATE MAP (FIRM) INFORMATION

B1. NFIP COMMUNITY NAME & COMMUNITY NUMBER <u>Yavapai County 040093</u>		B2. COUNTY NAME <u>YAVAPAI</u>		B3. STATE <u>AZ</u>	
B4. MAP AND PANEL NUMBER <u>PANEL 1020</u>	B5. SUFFIX <u>D</u>	B6. FIRM INDEX DATE <u>3-9-1999</u>	B7. FIRM PANEL EFFECTIVE/REVISED DATE <u>12-19-97</u>	B8. FLOOD ZONE(S) <u>A8, B, C</u>	B9. BASE FLOOD ELEVATION(S) (Zone AO, use depth of flooding) <u>5413.0'</u>

B10. Indicate the source of the Base Flood Elevation (BFE) data or base flood depth entered in B9.  
 FIS Profile  FIRM  Community Determined  Other (Describe: Stated on Final Subd. Plat)

B11. Indicate the elevation datum used for the BFE in B9:  NGVD 1929  NAVD 1988  Other (Describe: \_\_\_\_\_)

B12. Is the building located in a Coastal Barrier Resources System (CBRS) area or Otherwise Protected Area (OPA)?  Yes  No  
Designation Date: \_\_\_\_\_

SECTION C - BUILDING ELEVATION INFORMATION (SURVEY REQUIRED)

C1. Building elevations are based on:  Construction Drawings\*  Building Under Construction\*  Finished Construction  
\*A new Elevation Certificate will be required when construction of the building is complete.

C2. Building Diagram Number 8 (Select the building diagram most similar to the building for which this certificate is being completed - see pages 4 and 5. If no diagram accurately represents the building, provide a sketch or photograph.)

C3. Elevations - Zones A1-A30, AE, AH, A (with BFE), VE, V1-V30, V (with BFE), AR, AR/A, AR/AE, AR/A1-A30, AR/AH, AR/AO  
Complete Items C3a-i below according to the building diagram specified in Item C2. State the datum used. If the datum is different from the datum used for the BFE in Section B, convert the datum to that used for the BFE. Show field measurements and datum conversion calculation. Use the space provided or the Comments area of Section D or Section G, as appropriate, to document the datum conversion.  
Datum SAME Conversion/Comments \_\_\_\_\_

Elevation reference mark used RM 98 Does the elevation reference mark used appear on the FIRM?  Yes  No

<input type="checkbox"/> a) Top of bottom floor (including basement or enclosure)	<u>SEE NOTE</u> . . . . . ft.(m)
<input type="checkbox"/> b) Top of next higher floor	<u>5418</u> . . . . . 50 ft.(m)
<input type="checkbox"/> c) Bottom of lowest horizontal structural member (V zones only)	<u>SEE NOTE</u> . . . . . ft.(m)
<input type="checkbox"/> d) Attached garage (top of slab)	<u>SEE NOTE - 5418</u> . . . . . 15 ft.(m)
<input type="checkbox"/> e) Lowest elevation of machinery and/or equipment servicing the building	<u>SEE NOTE</u> . . . . . ft.(m)
<input type="checkbox"/> f) Lowest adjacent grade (LAG)	<u>5413</u> . . . . . 25 ft.(m)
<input type="checkbox"/> g) Highest adjacent grade (HAG)	<u>5418</u> . . . . . 00 ft.(m)
<input type="checkbox"/> h) No. of permanent openings (flood vents) within 1 ft. above adjacent grade	<u>SEE NOTE</u>
<input type="checkbox"/> i) Total area of all permanent openings (flood vents) in C3h	<u>SEE NOTE</u> sq. in. (sq. cm)

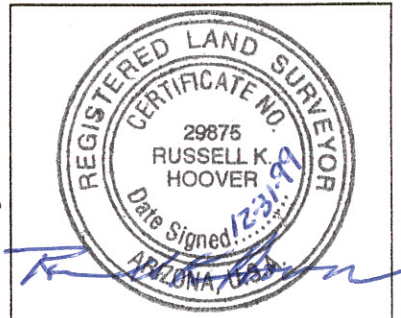

SECTION D - SURVEYOR, ENGINEER, OR ARCHITECT CERTIFICATION

This certification is to be signed and sealed by a land surveyor, engineer, or architect authorized by law to certify elevation information. I certify that the information in Sections A, B, and C on this certificate represents my best efforts to interpret the data available. I understand that any false statement may be punishable by fine or imprisonment under 18 U.S. Code, Section 1001.

CERTIFIER'S NAME <u>RUSSELL KIRK HOOVER</u>	LICENSE NUMBER <u>L.S. 29875</u>
TITLE <u>OWNER</u>	COMPANY NAME <u>RKH LAND SURVEYING</u>
ADDRESS <u>637 S. RD. 1 EAST</u>	CITY <u>CHINO VALLEY</u> STATE <u>AZ</u> ZIP CODE <u>86323</u>
SIGNATURE <u>Russell K. Hoover</u>	DATE <u>31-DEC-99</u> TELEPHONE <u>(520)636-7531</u>



IMPORTANT: In these spaces, copy the corresponding information from Section A.			For Insurance Company Use:
BUILDING STREET ADDRESS (Including Apt., Unit, Suite, and/or Bldg. No.) OR P.O. ROUTE AND BOX NO. 2680 TOLEMAC RD.			Policy Number
CITY PRESCOTT	STATE AZ.	ZIP CODE	Company NAIC Number

**SECTION D - SURVEYOR, ENGINEER, OR ARCHITECT CERTIFICATION (CONTINUED)**

Copy both sides of this Elevation Certificate for (1) community official, (2) insurance agent/company, and (3) building owner.

COMMENTS

SECTION "C" (ALL MEASUREMENTS BASED ON LEVEL 5436.71' ELEV (IN CIRCUIT RUN BY ME FROM "RM 98") FND X-IN CONC HEADWALL)

(A) THIS LOCATION NOT ACCURATELY ABLE TO BE MEASURED (ENCLOSED)

(C) N/A - SITE BUILT HOME WITH CONCRETE STEM WALLS

(D) GARAGE FLOOR SLOPES AWAY FROM HOUSE (5418.40' HIGH TO 5418.15' LOW)

(E), (H) & (I) NO KNOWN SERVICING MACHINERY OR FLOOD VENTS |  Check here if attachments

**SECTION E - BUILDING ELEVATION INFORMATION (SURVEY NOT REQUIRED) FOR ZONES AO and A (WITHOUT BFE)**

For Zones AO and A (without BFE), complete Items E1 through E3. If the Elevation Certificate is intended for use as supporting information for a LOMA or LOMR-F, Section C must be completed.

- E1. Building Diagram Number \_\_\_ (Select the building diagram most similar to the building for which this certificate is being completed - see pages 4 and 5. If no diagram accurately represents the building, provide a sketch or photograph.)
- E2. The top of the bottom floor (including basement or enclosure) of the building is  ft.(m)  in.(cm)  above or  below (check one) the highest adjacent grade.
- E3. For Zone AO only: If no flood depth number is available, is the top of the bottom floor elevated in accordance with the community's floodplain management ordinance?  Yes  No  Unknown. The local official must certify this information in Section G.

**SECTION F - PROPERTY OWNER (OR OWNER'S REPRESENTATIVE) CERTIFICATION**

The property owner or owner's authorized representative who completes Sections A, B, and E for Zone A (without a FEMA-issued or community-issued BFE) or Zone AO must sign here.

**REX VAN WORMER**

PROPERTY OWNER'S OR OWNER'S AUTHORIZED REPRESENTATIVE'S NAME

ADDRESS: P.O. BOX 12050

CITY: PRESCOTT STATE: AZ. ZIP CODE: 86304

SIGNATURE: DATE: TELEPHONE: (520) 778-6398 HM. (520) 708-9877 OFC.

COMMENTS

Check here if attachments

**SECTION G - COMMUNITY INFORMATION (OPTIONAL)**

The local official who is authorized by law or ordinance to administer the community's floodplain management ordinance can complete Sections A, B, C (or E), and G of this Elevation Certificate. Check the applicable box(es) and sign below.

- G1.  The information in Section C was taken from other documentation that has been signed and embossed by a licensed surveyor, engineer, or architect who is authorized by state or local law to certify elevation information. (Indicate the source and date of the elevation data in the Comments area below.)
- G2.  A community official completed Section E for a building located in Zone A (without a FEMA-issued or community-issued BFE) or Zone AO.
- G3.  The following information (Items G4-G9) is provided for community floodplain management purposes.

G4. PERMIT NUMBER	G5. DATE PERMIT ISSUED	G6. DATE CERTIFICATE OF COMPLIANCE/OCCUPANCY ISSUED

G7. This permit has been issued for:  New Construction  Substantial Improvement

G8. Elevation of as-built lowest floor (including basement) of the building is: \_\_\_\_\_ ft.(m) Datum: \_\_\_\_\_

G9. BFE or (in Zone AO) depth of flooding at the building site is: \_\_\_\_\_ ft.(m) Datum: \_\_\_\_\_

LOCAL OFFICIAL'S NAME	TITLE
COMMUNITY NAME	TELEPHONE
SIGNATURE	DATE
COMMENTS	

Check here if attachments