

ELEVATION CERTIFICATE

Important: Read the instructions on pages 1 - 7.

SECTION A - PROPERTY OWNER INFORMATION

For Insurance Company Use:

BUILDING OWNER'S NAME

J.J. FLETCHER

Policy Number

BUILDING STREET ADDRESS (Including Apt., Unit, Suite, and/or Bldg. No.) OR P.O. ROUTE AND BOX NO.

36500 RINCON RD.

Company NAIC Number

CITY

WICKENBURG

STATE

AZ

ZIP CODE

85350

PROPERTY DESCRIPTION (Lot and Block Number, Tax Parcel Number, Legal Description, etc.)

APN 201-04-018E Now L

BUILDING USE (e.g., Residential, Non-residential, Addition, Accessory, etc. Use Comments section if necessary.)

RESIDENTIAL

LATITUDE/LONGITUDE (OPTIONAL)

(##° - ##' - ###.###" or ##.#####)

HORIZONTAL DATUM:

NAD 1927 NAD 1983

SOURCE: GPS (Type):

USGS Quad Map Other:

SECTION B - FLOOD INSURANCE RATE MAP (FIRM) INFORMATION

B1. NFIP COMMUNITY NAME & COMMUNITY NUMBER

YAVAPAI COUNTY 040093

B2. COUNTY NAME

YAVAPAI

B3. STATE

AZ

B4. MAP AND PANEL NUMBER

040093 1870

B5. SUFFIX

B

B6. FIRM INDEX DATE

3-9-99

B7. FIRM PANEL EFFECTIVE/REVISED DATE

8-19-85

B8. FLOOD ZONE(S)

A7

B9. BASE FLOOD ELEVATION(S)
(Zone AO, use depth of flooding)

2149.8

B10. Indicate the source of the Base Flood Elevation (BFE) data or base flood depth entered in B9.

FIS Profile FIRM Community Determined Other (Describe):

B11. Indicate the elevation datum used for the BFE in B9: NGVD 1929 NAVD 1988 Other (Describe):

B12. Is the building located in a Coastal Barrier Resources System (CBRS) area or Otherwise Protected Area (OPA)? Yes No
Designation Date:

SECTION C - BUILDING ELEVATION INFORMATION (SURVEY REQUIRED)

C1. Building elevations are based on: Construction Drawings* Building Under Construction* Finished Construction

*A new Elevation Certificate will be required when construction of the building is complete.

C2. Building Diagram Number 1 (Select the building diagram most similar to the building for which this certificate is being completed - see pages 6 and 7. If no diagram accurately represents the building, provide a sketch or photograph.)

C3. Elevations - Zones A1-A30, AE, AH, A (with BFE), VE, V1-V30, V (with BFE), AR, AR/A, AR/AE, AR/A1-A30, AR/AH, AR/AO
Complete Items C3a-i below according to the building diagram specified in Item C2. State the datum used. If the datum is different from the datum used for the BFE in Section B, convert the datum to that used for the BFE. Show field measurements and datum conversion calculation. Use the space provided or the Comments area of Section D or Section G, as appropriate, to document the datum conversion.

Datum NGVD 1929 Conversion/Comments

Elevation reference mark used RM 100 Does the elevation reference mark used appear on the FIRM? Yes No

- a) Top of bottom floor (including basement or enclosure) 2151.64 ft.(m)
- b) Top of next higher floor 2160.0 ft.(m)
- c) Bottom of lowest horizontal structural member (V zones only) _____ ft.(m)
- d) Attached garage (top of slab) N/A ft.(m)
- e) Lowest elevation of machinery and/or equipment servicing the building N/A ft.(m)
- f) Lowest adjacent grade (LAG) 2146 ft.(m)
- g) Highest adjacent grade (HAG) 2147 ft.(m)
- h) No. of permanent openings (flood vents) within 1 ft. above adjacent grade 0
- i) Total area of all permanent openings (flood vents) in C3h 0 sq. in. (sq. cm)

License Number, Embossed Seal, Signature, and Date

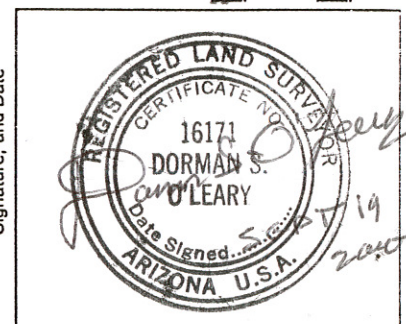

SECTION D - SURVEYOR, ENGINEER, OR ARCHITECT CERTIFICATION

This certification is to be signed and sealed by a land surveyor, engineer, or architect authorized by law to certify elevation information.

I certify that the information in Sections A, B, and C on this certificate represents my best efforts to interpret the data available.

I understand that any false statement may be punishable by fine or imprisonment under 18 U.S. Code, Section 1001.

CERTIFIER'S NAME

Dorman S. O'Leary

LICENSE NUMBER

same 16171

TITLE

Registered Land Surveyor

COMPANY NAME

ADDRESS

P. O. Box 1041

CITY

Wickenburg

STATE

AZ

ZIP CODE

85358

SIGNATURE

DATE

TELEPHONE

520-684-2287

IMPORTANT: In these spaces, copy the corresponding information from Section A.		For Insurance Company Use:
BUILDING STREET ADDRESS (Including Apt., Unit, Suite, and/or Bldg. No.) OR P.O. ROUTE AND BOX NO. 36500 Rincon Road		Policy Number.
CITY Wickenburg	STATE Arizona	ZIP CODE 85358
		Company NAIC Number.

SECTION D - SURVEYOR, ENGINEER, OR ARCHITECT CERTIFICATION (CONTINUED)

Copy both sides of this Elevation Certificate for (1) community official, (2) insurance agent/company, and (3) building owner.

COMMENTS

Check here if attachments

SECTION E - BUILDING ELEVATION INFORMATION (SURVEY NOT REQUIRED) FOR ZONE AO AND ZONE A (WITHOUT BFE)

For Zone AO and Zone A (without BFE), complete Items E1 through E4. If the Elevation Certificate is intended for use as supporting information for a LOMA or LOMR-F, Section C must be completed.

- E1. Building Diagram Number 1 (Select the building diagram most similar to the building for which this certificate is being completed - see pages 6 and 7. If no diagram accurately represents the building, provide a sketch or photograph.)
- E2. The top of the bottom floor (including basement or enclosure) of the building is ft.(m) in.(cm) above or below (check one) the highest adjacent grade.
- E3. For Building Diagrams 6-8 with openings (see page 7), the next higher floor or elevated floor (elevation b) of the building is ft.(m) in.(cm) above the highest adjacent grade.
- E4. For Zone AO only: If no flood depth number is available, is the top of the bottom floor elevated in accordance with the community's floodplain management ordinance? Yes No Unknown. The local official must certify this information in Section G.

SECTION F - PROPERTY OWNER (OR OWNER'S REPRESENTATIVE) CERTIFICATION

The property owner or owner's authorized representative who completes Sections A, B, and E for Zone A (without a FEMA-issued or community-issued BFE) or Zone AO must sign here.

PROPERTY OWNER'S OR OWNER'S AUTHORIZED REPRESENTATIVE'S NAME

ADDRESS CITY STATE ZIP CODE

SIGNATURE DATE TELEPHONE

COMMENTS

Check here if attachments

SECTION G - COMMUNITY INFORMATION (OPTIONAL)

The local official who is authorized by law or ordinance to administer the community's floodplain management ordinance can complete Sections A, B, C (or E), and G of this Elevation Certificate. Complete the applicable item(s) and sign below.

- G1. The information in Section C was taken from other documentation that has been signed and embossed by a licensed surveyor, engineer, or architect who is authorized by state or local law to certify elevation information. (Indicate the source and date of the elevation data in the Comments area below.)
- G2. A community official completed Section E for a building located in Zone A (without a FEMA-issued or community-issued BFE) or Zone AO.
- G3. The following information (Items G4-G9) is provided for community floodplain management purposes.

G4. PERMIT NUMBER <u>5-99-064</u>	G5. DATE PERMIT ISSUED <u>11/9/1999</u>	G6. DATE CERTIFICATE OF COMPLIANCE/OCCUPANCY ISSUED <u>9/19/2000</u>
--------------------------------------	--	---

G7. This permit has been issued for: New Construction Substantial Improvement

G8. Elevation of as-built lowest floor (including basement) of the building is:

21.54 ft.(m) Datum: NGVD 29
2.149 ft.(m) Datum: NGVD 27

G9. BFE or (in Zone AO) depth of flooding at the building site is:

LOCAL OFFICIAL'S NAME

Jeff Low

TITLE

Floodplain Unit Manager

COMMUNITY NAME

Yavapai County

TELEPHONE

(928) 771-3197

SIGNATURE

Jeff Low

DATE

7/2/08

COMMENTS

Stairwell back filled; AC unit above finish floor per site visit.

Check here if attachments