

# ELEVATION CERTIFICATE

OMB No. 1660-0008  
Expires February 28, 2009

Important: Read the instructions on pages 1-8.

## SECTION A - PROPERTY INFORMATION

A1. Building Owner's Name <b>MARK FRASIER</b>			For Insurance Company Use:		
A2. Building Street Address (including Apt., Unit, Suite, and/or Bldg. No.) or P.O. Route and Box No. <b>4701 W. ROBBIE LN.</b>			Policy Number		
City <b>POULDEN</b>			State <b>AZ</b>		Company NAIC Number
A3. Property Description (Lot and Block Numbers, Tax Parcel Number, Legal Description, etc.) <b>APN 303-05-107G</b>			ZIP Code <b>86334</b>		
A4. Building Use (e.g., Residential, Non-Residential, Addition, Accessory, etc.) <b>RESIDENTIAL</b>					
A5. Latitude/Longitude: Lat. <b>34°55'13"N</b> Long. <b>112°33'11"W</b> Horizontal Datum: <input type="checkbox"/> NAD 1927 <input checked="" type="checkbox"/> NAD 1983					
A6. Attach at least 2 photographs of the building if the Certificate is being used to obtain flood insurance.					
A7. Building Diagram Number <b>8</b>					
A8. For a building with a crawl space or enclosure(s), provide:			A9. For a building with an attached garage, provide:		
a) Square footage of crawl space or enclosure(s) <b>1930</b> sq ft			a) Square footage of attached garage <b>N/A</b> sq ft		
b) No. of permanent flood openings in the crawl space or enclosure(s) walls within 1.0 foot above adjacent grade <b>20</b>			b) No. of permanent flood openings in the attached garage walls within 1.0 foot above adjacent grade <b>N/A</b>		
c) Total net area of flood openings in A8.b <b>2460</b> sq in			c) Total net area of flood openings in A9.b <b>N/A</b> sq in		

## SECTION B - FLOOD INSURANCE RATE MAP (FIRM) INFORMATION

B1. NFIP Community Name & Community Number <b>YAVAPAI COUNTY? UNINCORP AREAS 00093</b>		B2. County Name <b>YAVAPAI</b>		B3. State <b>AZ</b>	
B4. Map/Panel Number <b>04025C0970</b>	B5. Suffix <b>F</b>	B6. FIRM Index Date <b>6.6.2001</b>	B7. FIRM Panel Effective/Revised Date <b>6.6.2001</b>	B8. Flood Zone(s) <b>AE</b>	B9. Base Flood Elevation(s) (Zone AO, use base flood depth) <b>4406.0</b>
B10. Indicate the source of the Base Flood Elevation (BFE) data or base flood depth entered in Item B9. <input type="checkbox"/> FIS Profile <input checked="" type="checkbox"/> FIRM <input type="checkbox"/> Community Determined <input type="checkbox"/> Other (Describe) _____					
B11. Indicate elevation datum used for BFE in Item B9: <input checked="" type="checkbox"/> NGVD 1929 <input type="checkbox"/> NAVD 1988 <input type="checkbox"/> Other (Describe) _____					
B12. Is the building located in a Coastal Barrier Resources System (CBRS) area or Otherwise Protected Area (OPA)? <input type="checkbox"/> Yes <input checked="" type="checkbox"/> No Designation Date _____ <input type="checkbox"/> CBRS <input type="checkbox"/> OPA					

## SECTION C - BUILDING ELEVATION INFORMATION (SURVEY REQUIRED)

C1. Building elevations are based on:  Construction Drawings\*  Building Under Construction\*  Finished Construction  
\*A new Elevation Certificate will be required when construction of the building is complete.

C2. Elevations – Zones A1-A30, AE, AH, A (with BFE), VE, V1-V30, V (with BFE), AR, AR/A, AR/AE, AR/A1-A30, AR/AH, AR/AO. Complete Items C2.a-g below according to the building diagram specified in Item A7.

Benchmark Utilized **BM-52** Vertical Datum **4408.36**  
Conversion/Comments **NONE**

Check the measurement used.

a) Top of bottom floor (including basement, crawl space, or enclosure floor)	<b>4405.7</b> <input checked="" type="checkbox"/> feet	<input type="checkbox"/> meters (Puerto Rico only)
b) Top of the next higher floor	<b>4408.9</b> <input checked="" type="checkbox"/> feet	<input type="checkbox"/> meters (Puerto Rico only)
c) Bottom of the lowest horizontal structural member (V Zones only)	<b>—</b> <input type="checkbox"/> feet	<input type="checkbox"/> meters (Puerto Rico only)
d) Attached garage (top of slab)	<b>NONE</b> <input type="checkbox"/> feet	<input type="checkbox"/> meters (Puerto Rico only)
e) Lowest elevation of machinery or equipment servicing the building (Describe type of equipment in Comments)	<b>4406.1</b> <input checked="" type="checkbox"/> feet	<input type="checkbox"/> meters (Puerto Rico only)
f) Lowest adjacent (finished) grade (LAG)	<b>4405.7</b> <input checked="" type="checkbox"/> feet	<input type="checkbox"/> meters (Puerto Rico only)
g) Highest adjacent (finished) grade (HAG)	<b>4405.7</b> <input checked="" type="checkbox"/> feet	<input type="checkbox"/> meters (Puerto Rico only)

## SECTION D - SURVEYOR, ENGINEER, OR ARCHITECT CERTIFICATION

This certification is to be signed and sealed by a land surveyor, engineer, or architect authorized by law to certify elevation information. I certify that the information on this Certificate represents my best efforts to interpret the data available. I understand that any false statement may be punishable by fine or imprisonment under 18 U.S. Code, Section 1001.

Check here if comments are provided on back of form.

Certifier's Name <b>G. MICHAEL HAYWOOD</b>		License Number <b>AZ 62 13941</b>	
Title <b>PRESIDENT</b>	Company Name <b>M HAYWOOD ASSOC. INC.</b>		
Address <b>P.O. Box 1001</b>	City <b>PRESCOTT</b>	State <b>AZ</b>	ZIP Code <b>86302</b>
Signature <i>[Signature]</i>	Date <b>7.17.06</b>	Telephone <b>928.778.5101</b>	

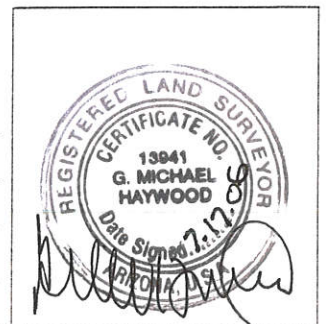

X

<b>IMPORTANT: In these spaces, copy the corresponding information from Section A.</b>			For Insurance Company Use:
Building Street Address (including Apt., Unit, Suite /or Bldg. No.) or P.O. Route and Box No. 4701 W. ROBBIE LN.			Policy Number
City PAULDEN	State AZ	ZIP Code 86334	Company NAIC Number

**SECTION D - SURVEYOR, ENGINEER, OR ARCHITECT CERTIFICATION (CONTINUED)**

Copy both sides of this Elevation Certificate for (1) community official, (2) insurance agent/company, and (3) building owner.

Comments  
 THE RESIDENCE HAS MASONRY WALLS ON THE NORTH & SOUTH SIDES. THE METAL SKIRTING ON THE EAST & WEST ENDS HAVE MULTIPLE PERFORATED STIRS W/ ONE LARGE OPENING.  
 THE LOWEST STRUCTURAL MEMBER @ 4407.7

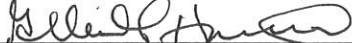
Signature  Date 7.17.06  Check here if attachments

**SECTION E - BUILDING ELEVATION INFORMATION (SURVEY NOT REQUIRED) FOR ZONE AO AND ZONE A (WITHOUT BFE)**

For Zones AO and A (without BFE), complete Items E1-E5. If the Certificate is intended to support a LOMA or LOMR-F request, complete Sections A, B, and C. For Items E1-E4, use natural grade, if available. Check the measurement used. In Puerto Rico only, enter meters.

- E1. Provide elevation information for the following and check the appropriate boxes to show whether the elevation is above or below the highest adjacent grade (HAG) and the lowest adjacent grade (LAG).
- a) Top of bottom floor (including basement, crawl space, or enclosure) is \_\_\_\_\_ feet  meters  above or  below the HAG.
- b) Top of bottom floor (including basement, crawl space, or enclosure) is \_\_\_\_\_ feet  meters  above or  below the LAG.
- E2. For Building Diagrams 6-8 with permanent flood openings provided in Section A Items 8 and/or 9 (see page 8 of Instructions), the next higher floor (elevation C2.b in the diagrams) of the building is \_\_\_\_\_ feet  meters  above or  below the HAG.
- E3. Attached garage (top of slab) is \_\_\_\_\_ feet  meters  above or  below the HAG.
- E4. Top of platform of machinery and/or equipment servicing the building is \_\_\_\_\_ feet  meters  above or  below the HAG.
- E5. Zone AO only: If no flood depth number is available, is the top of the bottom floor elevated in accordance with the community's floodplain management ordinance?  Yes  No  Unknown. The local official must certify this information in Section G.

**SECTION F - PROPERTY OWNER (OR OWNER'S REPRESENTATIVE) CERTIFICATION**

The property owner or owner's authorized representative who completes Sections A, B, and E for Zone A (without a FEMA-issued or community-issued BFE) or Zone AO must sign here. The statements in Sections A, B, and E are correct to the best of my knowledge.

Property Owner's or Owner's Authorized Representative's Name \_\_\_\_\_

Address _____	City _____	State _____	ZIP Code _____
Signature _____	Date _____	Telephone _____	
Comments _____			

Check here if attachments

**SECTION G - COMMUNITY INFORMATION (OPTIONAL)**

The local official who is authorized by law or ordinance to administer the community's floodplain management ordinance can complete Sections A, B, C (or E), and G of this Elevation Certificate. Complete the applicable item(s) and sign below. Check the measurement used in Items G8. and G9.

- G1.  The information in Section C was taken from other documentation that has been signed and sealed by a licensed surveyor, engineer, or architect who is authorized by law to certify elevation information. (Indicate the source and date of the elevation data in the Comments area below.)
- G2.  A community official completed Section E for a building located in Zone A (without a FEMA-issued or community-issued BFE) or Zone AO.
- G3.  The following information (Items G4.-G9.) is provided for community floodplain management purposes.

G4. Permit Number _____	G5. Date Permit Issued _____	G6. Date Certificate Of Compliance/Occupancy Issued _____
-------------------------	------------------------------	---

- G7. This permit has been issued for:  New Construction  Substantial Improvement
- G8. Elevation of as-built lowest floor (including basement) of the building: \_\_\_\_\_ feet  meters (PR) Datum \_\_\_\_\_
- G9. BFE or (in Zone AO) depth of flooding at the building site: \_\_\_\_\_ feet  meters (PR) Datum \_\_\_\_\_

Local Official's Name _____	Title _____
Community Name _____	Telephone _____
Signature _____	Date _____
Comments _____	

Check here if attachments

X

# Building Photographs

See Instructions for Item A6.

Building Street Address (including Apt., Unit, Suite, and/or Bldg. No.) or P.O. Route and Box No. 4701 W. ROBBIE LN.			For Insurance Company Use: Policy Number
City PRESCOTT	State AZ	ZIP Code 86334	Company NAIC Number

If using the Elevation Certificate to obtain NFIP flood insurance, affix at least two building photographs below according to the instructions for Item A6. Identify all photographs with: date taken; "Front View" and "Rear View"; and, if required, "Right Side View" and "Left Side View." If submitting more photographs than will fit on this page, use the Continuation Page, following.



NORTH SIDE  
OF RESIDENCE  
SHOWING MASONRY  
WALL.

SOUTH SIDE OF  
RESIDENCE  
SHOWING  
MASONRY WALL



# Building Photographs

Continuation Page

Building Street Address (including Apt., Unit, Suite, and/or Bldg. No.) or P.O. Route and Box No.			For Insurance Company Use:
4701 W. ROBBIE LN.			Policy Number
City	State	ZIP Code	Company NAIC Number
PAULTON	AZ	86334	

If submitting more photographs than will fit on the preceding page, affix the additional photographs below. Identify all photographs with: date taken; "Front View" and "Rear View"; and, if required, "Right Side View" and "Left Side View."



WEST END OF  
RESIDENCE W/ ONE  
LARGE OPENING  
AND PERFORATED  
METAL SKIRT

EAST END OF  
RESIDENCE W/  
PERFORATED  
SKIRT. HEAT  
PUMP ON CONC.  
SLAB BELOW  
B.F.E.

