

ELEVATION CERTIFICATE

Important: Read the instructions on pages 1-9.

OMB No. 1660-0008
 Expiration Date: July 31, 2015

SECTION A - PROPERTY INFORMATION

A1. Building Owner's Name GERALD PATTON		FOR INSURANCE COMPANY USE	
A2. Building Street Address (including Apt., Unit, Suite, and/or Bldg. No.) or P.O. Route and Box No. 4625 W. ROBBIE LANE		Policy Number:	
City PAULDEN	State AZ	Company NAIC Number:	
A3. Property Description (Lot and Block Numbers, Tax Parcel Number, Legal Description, etc.) APN 303-05-109C PORTION OF LOT 53 WINEGLASS ACRES UNIT 2, SEC.26, T18N, R3W G&SRB&M			
A4. Building Use (e.g., Residential, Non-Residential, Addition, Accessory, etc.) <u>RESIDENTIAL</u>			
A5. Latitude/Longitude: Lat. <u>34 55'12.69672"</u> Long. <u>112 33'03.32470"</u>		Horizontal Datum: <input type="checkbox"/> NAD 1927 <input checked="" type="checkbox"/> NAD 1983	
A6. Attach at least 2 photographs of the building if the Certificate is being used to obtain flood insurance.			
A7. Building Diagram Number <u>6</u>			
A8. For a building with a crawlspace or enclosure(s):		A9. For a building with an attached garage:	
a) Square footage of crawlspace or enclosure(s) <u>967</u> sq ft	a) Square footage of attached garage <u>NA</u> sq ft		
b) Number of permanent flood openings in the crawlspace or enclosure(s) within 1.0 foot above adjacent grade <u>10</u>	b) Number of permanent flood openings in the attached garage within 1.0 foot above adjacent grade <u>0</u>		
c) Total net area of flood openings in A8.b <u>1280</u> sq in	c) Total net area of flood openings in A9.b <u>0</u> sq in		
d) Engineered flood openings? <input type="checkbox"/> Yes <input checked="" type="checkbox"/> No	d) Engineered flood openings? <input type="checkbox"/> Yes <input checked="" type="checkbox"/> No		

SECTION B - FLOOD INSURANCE RATE MAP (FIRM) INFORMATION

B1. NFIP Community Name & Community Number YAVAPAI COUNTY 040093		B2. County Name YAVAPAI COUNTY UNINCORPORATED AREA		B3. State AZ	
B4. Map/Panel Number 04025C0970	B5. Suffix G	B6. FIRM Index Date 9-3-2010	B7. FIRM Panel Effective/Revised Date 9-3-2010	B8. Flood Zone(s) AE	B9. Base Flood Elevation(s) (Zone AO, use base flood depth) 4407.7'
B10. Indicate the source of the Base Flood Elevation (BFE) data or base flood depth entered in Item B9. <input checked="" type="checkbox"/> FIS Profile <input type="checkbox"/> FIRM <input type="checkbox"/> Community Determined <input type="checkbox"/> Other/Source: _____					
B11. Indicate elevation datum used for BFE in Item B9: <input type="checkbox"/> NGVD 1929 <input checked="" type="checkbox"/> NAVD 1988 <input type="checkbox"/> Other/Source: _____					
B12. Is the building located in a Coastal Barrier Resources System (CBRS) area or Otherwise Protected Area (OPA)? <input type="checkbox"/> Yes <input checked="" type="checkbox"/> No Designation Date: _____ <input type="checkbox"/> CBRS <input type="checkbox"/> OPA					

SECTION C - BUILDING ELEVATION INFORMATION (SURVEY REQUIRED)

C1. Building elevations are based on: Construction Drawings* Building Under Construction* Finished Construction
 *A new Elevation Certificate will be required when construction of the building is complete.

C2. Elevations - Zones A1-A30, AE, AH, A (with BFE), VE, V1-V30, V (with BFE), AR, AR/A, AR/AE, AR/A1-A30, AR/AH, AR/AO. Complete Items C2.a-h below according to the building diagram specified in Item A7. In Puerto Rico only, enter meters.
 Benchmark Utilized: RM50-3 Vertical Datum: 4381.2' NAVD88
 Indicate elevation datum used for the elevations in items a) through h) below. NGVD 1929 NAVD 1988 Other/Source: _____
 Datum used for building elevations must be the same as that used for the BFE.

Check the measurement used.

a) Top of bottom floor (including basement, crawlspace, or enclosure floor)	<u>4407.8</u>	<input checked="" type="checkbox"/> feet <input type="checkbox"/> meters
b) Top of the next higher floor	<u>4411.4</u>	<input checked="" type="checkbox"/> feet <input type="checkbox"/> meters
c) Bottom of the lowest horizontal structural member (V Zones only)	<u>NA</u>	<input type="checkbox"/> feet <input type="checkbox"/> meters
d) Attached garage (top of slab)	<u>NA</u>	<input type="checkbox"/> feet <input type="checkbox"/> meters
e) Lowest elevation of machinery or equipment servicing the building (Describe type of equipment and location in Comments)	<u>4410.9</u>	<input checked="" type="checkbox"/> feet <input type="checkbox"/> meters
f) Lowest adjacent (finished) grade next to building (LAG)	<u>4408.2</u>	<input checked="" type="checkbox"/> feet <input type="checkbox"/> meters
g) Highest adjacent (finished) grade next to building (HAG)	<u>4408.7</u>	<input checked="" type="checkbox"/> feet <input type="checkbox"/> meters
h) Lowest adjacent grade at lowest elevation of deck or stairs, including structural support	<u>NA</u>	<input type="checkbox"/> feet <input type="checkbox"/> meters

SECTION D - SURVEYOR, ENGINEER, OR ARCHITECT CERTIFICATION

This certification is to be signed and sealed by a land surveyor, engineer, or architect authorized by law to certify elevation information. I certify that the information on this Certificate represents my best efforts to interpret the data available. I understand that any false statement may be punishable by fine or imprisonment under 18 U.S. Code, Section 1001.

Check here if comments are provided on back of form. Were latitude and longitude in Section A provided by a licensed land surveyor? Yes No

Check here if attachments.

Certifier's Name DALE FAMAS		License Number LS 27738	
Title LAND SURVEYOR	Company Name EMPIRE SURVEYING		
Address PO BOX 67	City PAULDEN	State AZ	ZIP Code 86334
Signature <i>[Signature]</i>	Date 1-13-15	Telephone (928)-636-6992	



ELEVATION CERTIFICATE, page 2

IMPORTANT: In these spaces, copy the corresponding information from Section A.	FOR INSURANCE COMPANY USE
Building Street Address (including Apt., Unit, Suite, and/or Bldg. No.) or P.O. Route and Box No. 4625 W. ROBBIE LANE	Policy Number:
City PAULDEN State AZ ZIP Code 86334	Company NAIC Number:

SECTION D – SURVEYOR, ENGINEER, OR ARCHITECT CERTIFICATION (CONTINUED)

Copy both sides of this Elevation Certificate for (1) community official, (2) insurance agent/company, and (3) building owner.

Comments MANUFACTURED HOME WITH CINDERBLOCK SKIRTING. FF EL= 4411.4', SUB FLOOR EL= 4407.8', BOTTOM FRAME EL= 4410.4', ELECTRIC METER PEDESTAL EL= 4410.9', GAS WATER HEATER EL= 4411.4', EVAP COOLER ON ROOF. FRONT AND REAR STEPS ARE FREE STANDING
LAT/LON PER GPS

Signature Dale Jarama Date 1-13-15

SECTION E – BUILDING ELEVATION INFORMATION (SURVEY NOT REQUIRED) FOR ZONE AO AND ZONE A (WITHOUT BFE)

For Zones AO and A (without BFE), complete Items E1–E5. If the Certificate is intended to support a LOMA or LOMR-F request, complete Sections A, B, and C. For Items E1–E4, use natural grade, if available. Check the measurement used. In Puerto Rico only, enter meters.

- E1. Provide elevation information for the following and check the appropriate boxes to show whether the elevation is above or below the highest adjacent grade (HAG) and the lowest adjacent grade (LAG).
- a) Top of bottom floor (including basement, crawlspace, or enclosure) is _____ feet meters above or below the HAG.
 b) Top of bottom floor (including basement, crawlspace, or enclosure) is _____ feet meters above or below the LAG.
- E2. For Building Diagrams 6–9 with permanent flood openings provided in Section A Items 8 and/or 9 (see pages 8–9 of Instructions), the next higher floor (elevation C2.b in the diagrams) of the building is _____ feet meters above or below the HAG.
- E3. Attached garage (top of slab) is _____ feet meters above or below the HAG.
- E4. Top of platform of machinery and/or equipment servicing the building is _____ feet meters above or below the HAG.
- E5. Zone AO only: If no flood depth number is available, is the top of the bottom floor elevated in accordance with the community's floodplain management ordinance? Yes No Unknown. The local official must certify this information in Section G.

SECTION F – PROPERTY OWNER (OR OWNER'S REPRESENTATIVE) CERTIFICATION

The property owner or owner's authorized representative who completes Sections A, B, and E for Zone A (without a FEMA-issued or community-issued BFE) or Zone AO must sign here. The statements in Sections A, B, and E are correct to the best of my knowledge.

Property Owner's or Owner's Authorized Representative's Name _____

Address _____ City _____ State _____ ZIP Code _____

Signature _____ Date _____ Telephone _____

Comments _____

Check here if attachments.

SECTION G – COMMUNITY INFORMATION (OPTIONAL)

The local official who is authorized by law or ordinance to administer the community's floodplain management ordinance can complete Sections A, B, C (or E), and G of this Elevation Certificate. Complete the applicable item(s) and sign below. Check the measurement used in Items G8–G10. In Puerto Rico only, enter meters.

- G1. The information in Section C was taken from other documentation that has been signed and sealed by a licensed surveyor, engineer, or architect who is authorized by law to certify elevation information. (Indicate the source and date of the elevation data in the Comments area below.)
- G2. A community official completed Section E for a building located in Zone A (without a FEMA-issued or community-issued BFE) or Zone AO.
- G3. The following information (Items G4–G10) is provided for community floodplain management purposes.

G4. Permit Number _____	G5. Date Permit Issued _____	G6. Date Certificate Of Compliance/Occupancy Issued _____
-------------------------	------------------------------	---

- G7. This permit has been issued for: New Construction Substantial Improvement
- G8. Elevation of as-built lowest floor (including basement) of the building: _____ feet meters Datum _____
- G9. BFE or (in Zone AO) depth of flooding at the building site: _____ feet meters Datum _____
- G10. Community's design flood elevation: _____ feet meters Datum _____

Local Official's Name _____ Title _____

Community Name _____ Telephone _____

Signature _____ Date _____

Comments _____

For Insurance

Check here if attachments.

Building Photographs

See Instructions for Item A6.

IMPORTANT: In these spaces, copy the corresponding information from Section A.

FOR INSURANCE COMPANY USE

Building Street Address (including Apt., Unit, Suite, and/or Bldg. No.) or P.O. Route and Box No.
4625 W. ROBBIE LANE

Policy Number:

City PAULDEN

State AZ ZIP Code 86334

Company NAIC Number:

If using the Elevation Certificate to obtain NFIP flood insurance, affix at least 2 building photographs below according to the instructions for Item A6. Identify all photographs with date taken; "Front View" and "Rear View"; and, if required, "Right Side View" and "Left Side View." When applicable, photographs must show the foundation with representative examples of the flood openings or vents, as indicated in Section A8. If submitting more photographs than will fit on this page, use the Continuation Page.

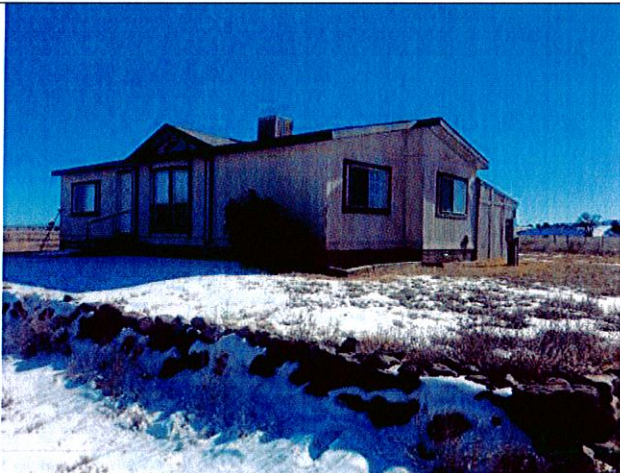

FRONT AND WEST END LOOKING SE FROM ROAD

1-7-2015

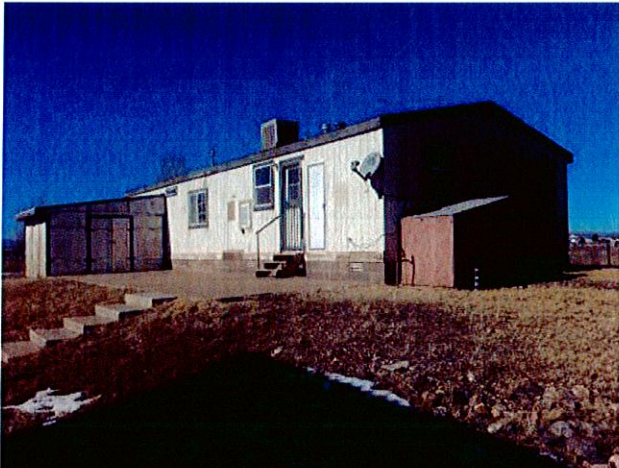

REAR AND EAST END LOOKING NW TOWARDS ROAD

1-7-2015



ELEVATION CERTIFICATE SKETCH

APN 303-05-109C

SEC. 26, T18N, R3W, G & SRB & M., YAVAPAI COUNTY, ARIZONA

DATE OF SURVEY

JANUARY 2015

DRAWING SCALE

1 IN = 40 FT

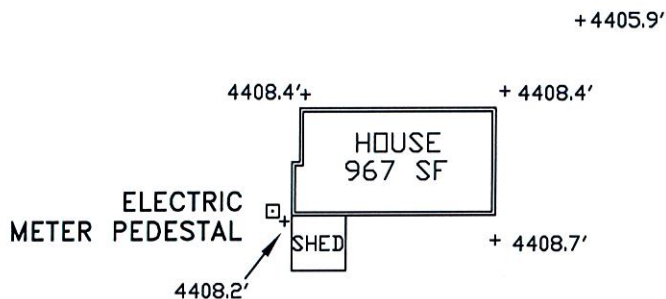

MANUFACTURED HOME
ON CINDERBLOCK SKIRTING
FF ELEV = 4411.4'
BOTTOM FRAME EL = 4410.4'
SUBFLOOR EL = 4407.8'
GAS WATER HEATER EL = 4411.4'
ELECTRIC METER PEDESTAL EL = 4410.9'
STORAGE SHED WITH WOOD FLOOR
ELEV = 4409.0'
HAG = 4408.7'
LAG = 4408.2'

DATUM PER RM50-3 ELEV = 4381.2' NAVD88

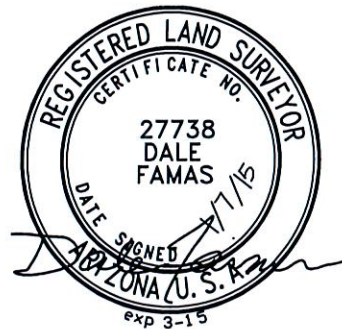

EMPIRE SURVEYING, Inc
P.O. BOX 67 PAULDEN AZ 86334
PHONE (928)-636-6992

SURVEY FOR: PATTON

DATE DRAWN: 1-7-15

FILE NO.: 15Y002

DRAWN BY: DEF

DRAWING: 002Y15

ELEVATION CERTIFICATE
FEDERAL EMERGENCY MANAGEMENT AGENCY
NATIONAL FLOOD INSURANCE PROGRAM

O.M.B. No. 3067-0077

Expires July 31, 1999

ATTENTION: Use of this certificate does not provide a waiver of the flood insurance purchase requirement. This form is used only to provide elevation information necessary to ensure compliance with applicable community floodplain management ordinances, to determine the proper insurance premium rate, and/or to support a request for a Letter of Map Amendment or Revision (LOMA or LOMR). You are not required to respond to this collection of information unless a valid OMB control number is displayed in the upper right corner of this form.

Instructions for completing this form can be found on the following pages.

SECTION A PROPERTY INFORMATION		FOR INSURANCE COMPANY USE
BUILDING OWNERS NAME Chad Sarrie		POLICY NUMBER
STREET ADDRESS (Including Apt., Unit, Suite and/or Bldg. Number) OR P.O. ROUTE AND BOX NUMBER P O Box 11287 - 4625 W. Robbie Lane		COMPANY NAIC NUMBER
OTHER DESCRIPTION (Lot and Block Numbers, etc.) Tax Parcel 303-05-109C		
CITY Paulden	STATE AZ	ZIP CODE 86334

SECTION B FLOOD INSURANCE RATE MAP (FIRM) INFORMATION

Provide the following from the proper FIRM (See Instructions):

1. COMMUNITY NUMBER	2. PANEL NUMBER	3. SUFFIX	4. DATE OF FIRM INDEX	5. FIRM ZONE	6. BASE FLOOD ELEVATION (in AO Zones, use depth)
040093	585	D	3/9/99	A3	4402.9

7. Indicate the elevation datum system used on the FIRM for Base Flood Elevations (BFE): NGVD '29 Other (describe on back)
8. For Zones A or V, where no BFE is provided on the FIRM, and the community has established a BFE for this building site, indicate the community's BFE: feet NGVD (or other FIRM datum-see Section B, Item 7).

SECTION C BUILDING ELEVATION INFORMATION

- Using the Elevation Certificate Instructions, indicate the diagram number from the diagrams found on Pages 5 and 6 that best describes the subject building's reference level 5.
- (a). FIRM Zones A1-A30, AE, AH, and A (with BFE). The top of the reference level floor from the selected diagram is at an elevation of 4406.0 feet NGVD (or other FIRM datum-see Section B, Item 7).
 (b). FIRM Zones V1-V30, VE, and V (with BFE). The bottom of the lowest horizontal structural member of the reference level from the selected diagram, is at an elevation of feet NGVD (or other FIRM datum-see Section B, Item 7).
 (c). FIRM Zone A (without BFE). The floor used as the reference level from the selected diagram is feet above or below (check one) the highest grade adjacent to the building.
 (d). FIRM Zone AO. The floor used as the reference level from the selected diagram is feet above or below (check one) the highest grade adjacent to the building. If no flood depth number is available, is the building's lowest floor (reference level) elevated in accordance with the community's floodplain management ordinance? Yes No Unknown
- Indicate the elevation datum system used in determining the above reference level elevations: NGVD '29 Other (describe under Comments on Page 2). (NOTE: If the elevation datum used in measuring the elevations is different than that used on the FIRM (see Section B, Item 7), then convert the elevations to the datum system used on the FIRM and show the conversion equation under Comments on Page 2.)
- Elevation reference mark used appears on FIRM: Yes No (See Instructions on Page 4)
- The reference level elevation is based on: actual construction construction drawings
 (NOTE:) Use of construction drawings is only valid if the building does not yet have the reference level floor in place, in which case this certificate will only be valid for the building during the course of construction. A post-construction Elevation Certificate will be required once construction is complete.)
- The elevation of the lowest grade immediately adjacent to the building is: 4 4 0 2 . 4 feet NGVD (or other FIRM datum-see Section B, Item 7).

SECTION D COMMUNITY INFORMATION

- If the community official responsible for verifying building elevations specifies that the reference level indicated in Section C. Item 1 is not the "lowest floor" as defined in the community's floodplain management ordinance, the elevation of the building's "lowest floor" as defined by the ordinance is: feet NGVD (or other FIRM datum-see Section B, Item 7).
- Date of the start of construction or substantial improvement 11/2/98.

SECTION E CERTIFICATION

This certification is to be signed by a land surveyor, engineer, or architect who is authorized by state or local law to certify elevation information when the elevation information for Zones A1-A30, AE, AH, A (with BFE), V1-V30, VE, and V (with BFE) is required. Community officials who are authorized by local law or ordinance to provide floodplain management information, may also sign the certification. In the case of Zones AO and A (without a FEMA or community issued BFE), a building official, a property owner, or an owner's representative may also sign the certification.

Reference level diagrams 6, 7 and 8 - Distinguishing Features-If the certifier is unable to certify to breakaway/non-breakaway wall, enclosure size, location of servicing equipment, area use, wall openings, or unfinished area Feature(s), then list the Feature(s) not included in the certification under Comments below. The diagram number, Section C, Item 1, must still be entered.

I certify that the information in Sections B and C on this certificate represents my best efforts to interpret the data available. I understand that any false statement may be punishable by fine or imprisonment under 18 U.S. Code, Section 1001.

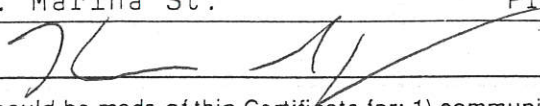
CERTIFIER'S NAME Kenneth E. Spedding		LICENSE NUMBER (or Affix Seal)	
TITLE District Director		COMPANY NAME Yavapai County Flood Control District	
ADDRESS 500 S. Marina St.		CITY Prescott	STATE AZ
SIGNATURE 		DATE 9/30/99	PHONE (520) 771-3197
Copies should be made of this Certificate for: 1) community official, 2) insurance agent/company, and 3) building owner.			

COMMENTS: _____

 Structure is a manufactured home. Elevation (2a) is to the bottom of the structural frame.

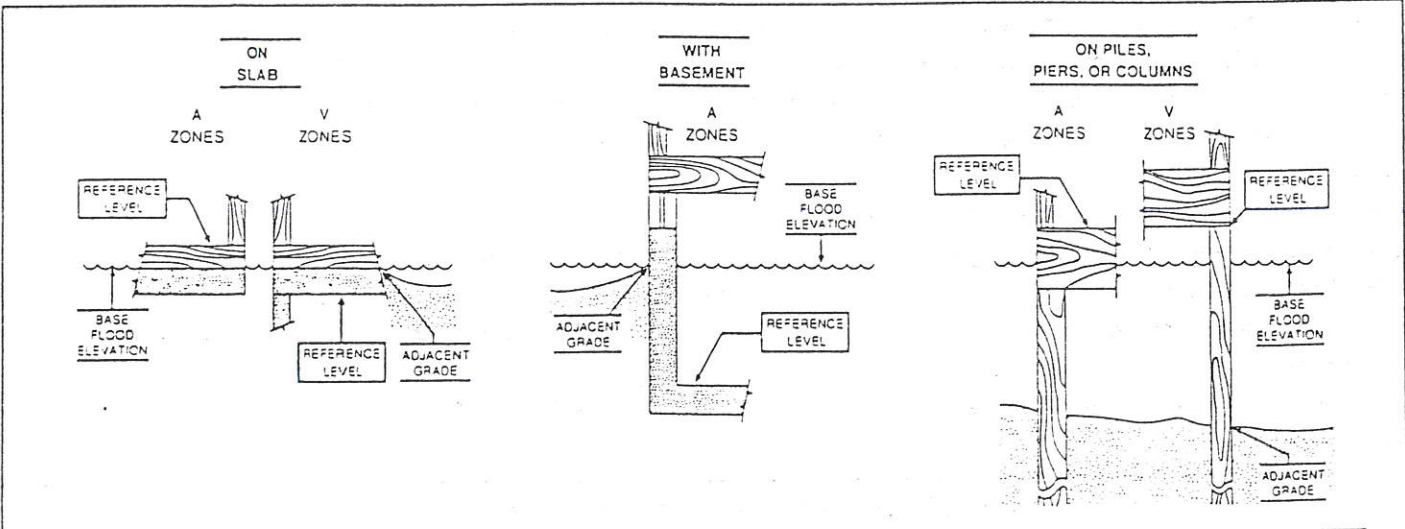

The diagrams above illustrate the points at which the elevations should be measured in A Zones and V Zones. Elevations for all A Zones should be measured at the top of the reference level floor. Elevations for all V Zones should be measured at the bottom of the lowest horizontal structural member.