

FEDERAL EMERGENCY MANAGEMENT AGENCY  
NATIONAL FLOOD INSURANCE PROGRAM

O.M.B. No. 3067-0077  
Expires December 31, 2005

ELEVATION CERTIFICATE

Important: Read the instructions on pages 1 - 7.

SECTION A - PROPERTY OWNER INFORMATION			For Insurance Company Use:	
BUILDING OWNER'S NAME Steve Grobart			Policy Number	
BUILDING STREET ADDRESS (Including Apt., Unit, Suite, and/or Bldg. No.) OR P.O. ROUTE AND BOX NO. 26095 N. Lola Ln.			Company NAIC Number	
CITY Paulden	STATE AZ	ZIP CODE 86334		
PROPERTY DESCRIPTION (Lot and Block Numbers, Tax Parcel Number, Legal Description, etc.) apn 303-05-117E Lot 47 Wineglass Acres 2 S23 T18N R3W				
BUILDING USE (e.g., Residential, Non-residential, Addition, Accessory, etc. Use a Comments area, if necessary.) RESIDENTIAL				
LATITUDE/LONGITUDE (OPTIONAL) (##° - ##' - ##"##" or ###.#####)		HORIZONTAL DATUM: <input type="checkbox"/> NAD 1927 <input type="checkbox"/> NAD 1983	SOURCE: <input type="checkbox"/> GPS (Type): _____ <input type="checkbox"/> USGS Quad Map <input type="checkbox"/> Other: _____	

SECTION B - FLOOD INSURANCE RATE MAP (FIRM) INFORMATION					
B1. NFIP COMMUNITY NAME & COMMUNITY NUMBER YAVAPAI COUNTY 040093		B2. COUNTY NAME YAVAPAI		B3. STATE AZ	
B4. MAP AND PANEL NUMBER 04025C0970	B5. SUFFIX F	B6. FIRM INDEX DATE 6-6-01	B7. FIRM PANEL EFFECTIVE/REVISED DATE 6-6-01	B8. FLOOD ZONE(S) AE	B9. BASE FLOOD ELEVATION(S) (Zone AO, use depth of flooding) 4404.6
B10. Indicate the source of the Base Flood Elevation (BFE) data or base flood depth entered in B9. <input checked="" type="checkbox"/> FIS Profile <input checked="" type="checkbox"/> FIRM <input type="checkbox"/> Community Determined <input type="checkbox"/> Other (Describe): _____					
B11. Indicate the elevation datum used for the BFE in B9: <input checked="" type="checkbox"/> NGVD 1929 <input type="checkbox"/> NAVD 1988 <input type="checkbox"/> Other (Describe): _____					
B12. Is the building located in a Coastal Barrier Resources System (CBRS) area or Otherwise Protected Area (OPA)? <input type="checkbox"/> Yes <input checked="" type="checkbox"/> No Designation Date _____					

SECTION C - BUILDING ELEVATION INFORMATION (SURVEY REQUIRED)	
C1. Building elevations are based on: <input type="checkbox"/> Construction Drawings* <input type="checkbox"/> Building Under Construction* <input checked="" type="checkbox"/> Finished Construction	
*A new Elevation Certificate will be required when construction of the building is complete.	
C2. Building Diagram Number <u>7</u> (Select the building diagram most similar to the building for which this certificate is being completed - see pages 6 and 7. If no diagram accurately represents the building, provide a sketch or photograph.)	
C3. Elevations - Zones A1-A30, AE, AH, A (with BFE), VE, V1-V30, V (with BFE), AR, AR/A, AR/AE, AR/A1-A30, AR/AH, AR/AO Complete Items C3.-a-i below according to the building diagram specified in Item C2. State the datum used. If the datum is different from the datum used for the BFE in Section B, convert the datum to that used for the BFE. Show field measurements and datum conversion calculation. Use the space provided or the Comments area of Section D or Section G, as appropriate, to document the datum conversion. Datum <u>29</u> Conversion/Comments _____	
Elevation reference mark used <u>RM50-3</u> Does the elevation reference mark used appear on the FIRM? <input checked="" type="checkbox"/> Yes <input type="checkbox"/> No	
o a) Top of bottom floor (including basement or enclosure)	<u>4404.4</u> ft.(m)
o b) Top of next higher floor	<u>NA.</u> ft.(m)
o c) Bottom of lowest horizontal structural member (V zones only)	<u>NA.</u> ft.(m)
o d) Attached garage (top of slab)	<u>NA.</u> ft.(m)
o e) Lowest elevation of machinery and/or equipment servicing the building (Describe in a Comments area)	<u>NA.</u> ft.(m)
o f) Lowest adjacent (finished) grade (LAG)	<u>4404.2</u> ft.(m)
o g) Highest adjacent (finished) grade (HAG)	<u>4404.6</u> ft.(m)
o h) No. of permanent openings (flood vents) within 1 ft. above adjacent grade <u>1</u>	
o i) Total area of all permanent openings (flood vents) in C3.h <u>468</u> sq. in. (sq. cm)	

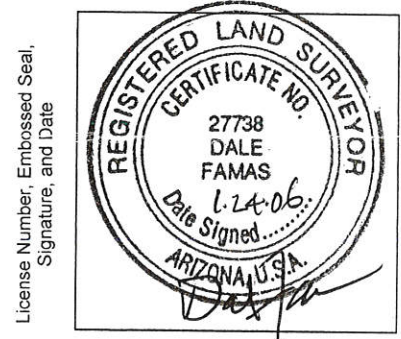

License Number, Embossed Seal, Signature, and Date

SECTION D - SURVEYOR, ENGINEER, OR ARCHITECT CERTIFICATION			
This certification is to be signed and sealed by a land surveyor, engineer, or architect authorized by law to certify elevation information. I certify that the information in Sections A, B, and C on this certificate represents my best efforts to interpret the data available. I understand that any false statement may be punishable by fine or imprisonment under 18 U.S. Code, Section 1001.			
CERTIFIER'S NAME DALE FAMAS		LICENSE NUMBER AZ RLS 27738	
TITLE LAND SURVEYOR	COMPANY NAME EMPIRE SURVEYING		
ADDRESS PO BOX 4357	CITY PRESCOTT	STATE AZ	ZIP CODE 86302
SIGNATURE <i>Dale Famas</i>	DATE 1-24-06	TELEPHONE 928-717-2844	

<b>IMPORTANT: In these spaces, copy the corresponding information from Section A.</b>			For Insurance Company Use:
BUILDING STREET ADDRESS (Including Apt., Unit, Suite, and/or No.) OR P.O. ROUTE AND BOX NO.			Policy Number
26095 N. Lola Ln.	STATE AZ	ZIP CODE 86334	Company NAIC Number
CITY Pauiden			



**SECTION D - SURVEYOR, ENGINEER, OR ARCHITECT CERTIFICATION (CONTINUED)**

Copy both sides of this Elevation Certificate for (1) community official, (2) insurance agent/company, and (3) building owner.

COMMENTS  
MHI-BEAM=4406.34' MANUFACTURED HOME WITH CINDERBLOCK SKIRTING

Check here if attachments

**SECTION E - BUILDING ELEVATION INFORMATION (SURVEY NOT REQUIRED) FOR ZONE AO AND ZONE A (WITHOUT BFE)**

For Zone AO and Zone A (without BFE), complete Items E1 through E4. If the Elevation Certificate is intended for use as supporting information for a LOMA or LOMR-F, Section C must be completed.

- E1. Building Diagram Number \_\_ (Select the building diagram most similar to the building for which this certificate is being completed – see pages 6 and 7. If no diagram accurately represents the building, provide a sketch or photograph.)
- E2. The top of the bottom floor (including basement or enclosure) of the building is \_\_ ft.(m) \_\_ in.(cm)  above or  below (check one) the highest adjacent grade. (Use natural grade, if available).
- E3. For Building Diagrams 6-8 with openings (see page 7), the next higher floor or elevated floor (elevation b) of the building is \_\_ ft.(m) \_\_ in.(cm) above the highest adjacent grade. Complete items C3.h and C3.i on front of form.
- E4. The top of the platform of machinery and/or equipment servicing the building is \_\_ ft.(m) \_\_ in.(cm)  above or  below (check one) the highest adjacent grade. (Use natural grade, if available).
- E5. For Zone AO only: If no flood depth number is available, is the top of the bottom floor elevated in accordance with the community's floodplain management ordinance?  
 Yes  No  Unknown. The local official must certify this information in Section G.

**SECTION F - PROPERTY OWNER (OR OWNER'S REPRESENTATIVE) CERTIFICATION**

The property owner or owner's authorized representative who completes Sections A, B, C (Items C3.h and C3.i only), and E for Zone A (without a FEMA-issued or community-issued BFE) or Zone AO must sign here. *The statements in Sections A, B, C, and E are correct to the best of my knowledge.*

PROPERTY OWNER'S OR OWNER'S AUTHORIZED REPRESENTATIVE'S NAME \_\_\_\_\_

ADDRESS _____	CITY _____	STATE _____	ZIP CODE _____
SIGNATURE _____	DATE _____	TELEPHONE _____	
COMMENTS _____			

Check here if attachments

**SECTION G - COMMUNITY INFORMATION (OPTIONAL)**

The local official who is authorized by law or ordinance to administer the community's floodplain management ordinance can complete Sections A, B, C (or E), and G of this Elevation Certificate. Complete the applicable item(s) and sign below.

- G1.  The information in Section C was taken from other documentation that has been signed and embossed by a licensed surveyor, engineer, or architect who is authorized by state or local law to certify elevation information. (Indicate the source and date of the elevation data in the Comments area below.)
- G2.  A community official completed Section E for a building located in Zone A (without a FEMA-issued or community-issued BFE) or Zone AO.
- G3.  The following information (Items G4-G9) is provided for community floodplain management purposes.

G4. PERMIT NUMBER _____	G5. DATE PERMIT ISSUED _____	G6. DATE CERTIFICATE OF COMPLIANCE/OCCUPANCY ISSUED _____
-------------------------	------------------------------	---

- G7. This permit has been issued for:  New Construction  Substantial Improvement
- G8. Elevation of as-built lowest floor (including basement) of the building is: \_\_\_\_\_ ft.(m) Datum: \_\_\_\_\_
- G9. BFE or (in Zone AO) depth of flooding at the building site is: \_\_\_\_\_ ft.(m) Datum: \_\_\_\_\_

LOCAL OFFICIAL'S NAME _____	TITLE _____
COMMUNITY NAME _____	TELEPHONE _____
SIGNATURE _____	DATE _____
COMMENTS _____	

Check here if attachments