

# ELEVATION CERTIFICATE

OMB No. 1660-0008  
Expires February 28, 2009

Important: Read the instructions on pages

<b>SECTION A - PROPERTY INFORMATION</b>		For Insurance Company Use:
A1. Building Owner's Name <b>Raymond Peterson</b>		Policy Number
A2. Building Street Address (including Apt., Unit, Suite, and/or Bldg. No.) or P.O. Route and Box No. <b>5125 Longhorn Road</b>		Company NAIC Number
City <b>Chino Valley</b> State <b>AZ</b> ZIP Code <b>86323</b>		

A3. Property Description (Lot and Block Numbers, Tax Parcel Number, Legal Description, etc.)  
**306-01-048A**

A4. Building Use (e.g., Residential, Non-Residential, Addition, Accessory, etc.) **Residential Site Built Home**

A5. Latitude/Longitude: Lat. \_\_\_\_\_ Long. \_\_\_\_\_ Horizontal Datum:  NAD 1927  NAD 1983

A6. Attach at least 2 photographs of the building if the Certificate is being used to obtain flood insurance.

A7. Building Diagram Number **6**

A8. For a building with a crawl space or enclosure(s), provide

a) Square footage of crawl space or enclosure(s)	<b>N/A</b> sq ft	A9. For a building with an attached garage, provide:
b) No. of permanent flood openings in the crawl space or enclosure(s) walls within 1.0 foot above adjacent grade	<b>N/A</b>	a) Square footage of attached garage
c) Total net area of flood openings in A8.b	<b>N/A</b> sq in	b) No. of permanent flood openings in the attached garage walls within 1.0 foot above adjacent grade
		c) Total net area of flood openings in A9.b

## SECTION B - FLOOD INSURANCE RATE MAP (FIRM) INFORMATION

B1. NFIP Community Name & Community Number <b>Yavapai County - 040093</b>		B2. County Name <b>Yavapai</b>		B3. State <b>Arizona</b>	
B4. Map/Panel Number <b>04025C1375</b>	B5. Suffix <b>F</b>	B6. FIRM Index Date <b>6/6/01</b>	B7. FIRM Panel Effective/Revised Date <b>6/6/01</b>	B8. Flood Zone(s) <b>A</b>	B9. Base Flood Elevation(s) (Zone AO, use base flood depth) <b>4727.9</b>

B10. Indicate the source of the Base Flood Elevation (BFE) data or base flood depth entered in Item B9.

FIS Profile  FIRM  Community Determined  Other (Describe) **Haystack Ranch Flood Study by Aspen Creek**

B11. Indicate elevation datum used for BFE in Item B9:  NGVD 1929  NAVD 1988  Other (Describe) \_\_\_\_\_

B12. Is the building located in a Coastal Barrier Resources System (CBRS) area or Otherwise Protected Area (OPA)?  Yes  No

Designation Date \_\_\_\_\_  CBRS  OPA

## SECTION C - BUILDING ELEVATION INFORMATION (SURVEY REQUIRED)

C1. Building elevations are based on:  Construction Drawings\*  Building Under Construction\*  Finished Construction

\*A new Elevation Certificate will be required when construction of the building is complete.

C2. Elevations - Zones A1-A30, AE, AH, A (with BFE), VE, V1-V30, V (with BFE), AR, AR/A, AR/AE, AR/A1-A30, AR/AH, AR/AO. Complete Items C2.a-g below according to the building diagram specified in Item A7.

Benchmark Utilized Vertical Datum **BM-4 = 4728.2**

Conversion/Comments \_\_\_\_\_

a) Top of bottom floor (including basement, crawl space, or enclosure floor).	<b>4736.0</b>	<input checked="" type="checkbox"/> feet	<input type="checkbox"/> meters (Puerto Rico only)
b) Top of the next higher floor	<b>4740.2</b>	<input checked="" type="checkbox"/> feet	<input type="checkbox"/> meters (Puerto Rico only)
c) Bottom of the lowest horizontal structural member (V Zones only)	<b>N/A</b>	<input type="checkbox"/> feet	<input type="checkbox"/> meters (Puerto Rico only)
d) Attached garage (top of slab)	<b>4738.1</b>	<input checked="" type="checkbox"/> feet	<input type="checkbox"/> meters (Puerto Rico only)
e) Lowest elevation of machinery or equipment servicing the building (Describe type of equipment in Comments)	<b>4737.6</b>	<input checked="" type="checkbox"/> feet	<input type="checkbox"/> meters (Puerto Rico only)
f) Lowest adjacent (finished) grade (LAG)	<b>4734.9</b>	<input checked="" type="checkbox"/> feet	<input type="checkbox"/> meters (Puerto Rico only)
g) Highest adjacent (finished) grade (HAG)	<b>4738.1</b>	<input checked="" type="checkbox"/> feet	<input type="checkbox"/> meters (Puerto Rico only)

## SECTION D - SURVEYOR, ENGINEER, OR ARCHITECT CERTIFICATION

This certification is to be signed and sealed by a land surveyor, engineer, or architect authorized by law to certify elevation information. I certify that the information on this Certificate represents my best efforts to interpret the data available. I understand that any false statement may be punishable by fine or imprisonment under 18 U.S. Code, Section 1001.

Check here if comments are provided on back of form.

**RODNEY L BLANK** License Number **26048**

**CONTRACT SURVEYING, INC** Company Name

**707 EL CAJON CARVO** Address City **PERSCOTT** State **AZ** ZIP Code **86301**

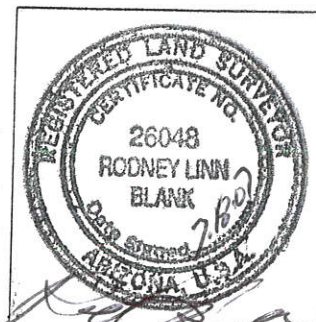



**IMPORTANT: In these spaces, copy the corresponding information from Section A.**

Building Street Address (including Apt., Unit, Suite, and/or Bldg. No.) or P.O. Route and Box No.

City State ZIP Code

For Insurance Company Use:

Policy Number

Company NAIC Number

**SECTION D - SURVEYOR, ENGINEER, OR ARCHITECT CERTIFICATION (CONTINUED)**

Copy both sides of this Elevation Certificate for (1) community official, (2) insurance agent/company, and (3) building owner.

Comments

Signature

Date

Check here if attachments

**SECTION E - BUILDING ELEVATION INFORMATION (SURVEY NOT REQUIRED) FOR ZONE AO AND ZONE A (WITHOUT BFE)**

For Zones AO and A (without BFE), complete Items E1-E5. If the Certificate is intended to support a LOMA or LOMR-F request, complete Sections A, B, and C. For Items E1-E4, use natural grade, if available. Check the measurement used. In Puerto Rico only, enter meters.

- E1. Provide elevation information for the following and check the appropriate boxes to show whether the elevation is above or below the highest adjacent grade (HAG) and the lowest adjacent grade (LAG).
  - a) Top of bottom floor (including basement, crawl space, or enclosure) is \_\_\_\_\_  feet  meters  above or  below the HAG.
  - b) Top of bottom floor (including basement, crawl space, or enclosure) is \_\_\_\_\_  feet  meters  above or  below the LAG.
- E2. For Building Diagrams 6-8 with permanent flood openings provided in Section A Items 8 and/or 9 (see page 8 of Instructions), the next higher floor (elevation C2.b in the diagrams) of the building is \_\_\_\_\_  feet  meters  above or  below the HAG.
- E3. Attached garage (top of slab) is \_\_\_\_\_  feet  meters  above or  below the HAG.
- E4. Top of platform of machinery and/or equipment servicing the building is \_\_\_\_\_  feet  meters  above or  below the HAG.
- E5. Zone AO only: If no flood depth number is available, is the top of the bottom floor elevated in accordance with the community's floodplain management ordinance?  Yes  No  Unknown. The local official must certify this information in Section G.

**SECTION F - PROPERTY OWNER (OR OWNER'S REPRESENTATIVE) CERTIFICATION**

The property owner or owner's authorized representative who completes Sections A, B, and E for Zone A (without a FEMA-issued or community-issued BFE) or Zone AO must sign here. *The statements in Sections A, B, and E are correct to the best of my knowledge.*

Property Owner's or Owner's Authorized Representative's Name

Address City State ZIP Code

Signature Date Telephone

Comments

Check here if attachments

**SECTION G - COMMUNITY INFORMATION (OPTIONAL)**

The local official who is authorized by law or ordinance to administer the community's floodplain management ordinance can complete Sections A, B, C (or E), and G of this Elevation Certificate. Complete the applicable item(s) and sign below. Check the measurement used in Items G8. and G9.

- G1.  The information in Section C was taken from other documentation that has been signed and sealed by a licensed surveyor, engineer, or architect who is authorized by law to certify elevation information. (Indicate the source and date of the elevation data in the Comments area below.)
- G2.  A community official completed Section E for a building located in Zone A (without a FEMA-issued or community-issued BFE) or Zone AO.
- G3.  The following information (Items G4.-G9.) is provided for community floodplain management purposes.

G4. Permit Number

G5. Date Permit Issued

G6. Date Certificate Of Compliance/Occupancy Issued

G7. This permit has been issued for:  New Construction  Substantial Improvement

G8. Elevation of as-built lowest floor (including basement) of the building: \_\_\_\_\_  feet  meters (PR) Datum \_\_\_\_\_

G9. BFE or (in Zone AO) depth of flooding at the building site: \_\_\_\_\_  feet  meters (PR) Datum \_\_\_\_\_

Local Official's Name Title

Community Name Telephone

Signature Date

Comments

Check here if attachments

# Building Photographs

Continuation Page

Building Street Address (including Apt., Unit, Suite, and/or Bldg. No.) or P.O. Route and Box No.			For Insurance Company Use: Policy Number
City	State	ZIP Code	Company NAIC Number

If submitting more photographs than will fit on the preceding page, affix the additional photographs below. Identify all photographs with: date taken; "Front View" and "Rear View"; and, if required, "Right Side View" and "Left Side View."





# Building Photographs

Continuation Page

Building Street Address (including Apt., Unit, Suite, and/or Bldg. No.) or P.O. Route and Box No.			For Insurance Company Use: Policy Number
City	State	ZIP Code	Company NAIC Number

If submitting more photographs than will fit on the preceding page, affix the additional photographs below. Identify all photographs with: date taken; "Front View" and "Rear View"; and, if required, "Right Side View" and "Left Side View."



# ELEVATION OF FLOODPLAIN PROPERTY

When Completed Return To: **YAVAPAI COUNTY DEVELOPMENT SERVICES - FLOODPLAIN UNIT**

500 S. Marina St., Prescott, AZ, 86303 (928) 771-3197 FAX (928) 771-3427 Office: Prescott X  
10 S. 6<sup>th</sup> St., Cottonwood, AZ 86326 (928) 639-8151 FAX (928) 639-8118 Cottonwood \_\_\_\_\_

DATE: 8-23-05

ASSESSOR'S PARCEL NUMBER 306-01-048A

SUBDIVISION NAME UNIT/PHASE AND LOT NUMBER HAYSTACK RANCHES, LOT #13

OWNER RAYMOND PETERSON 632-4093

SITE'S ADDRESS 5332 BREMONT WAY, PRESCOTT VALLEY, AZ 86314

BASE BENCHMARK: Number BM-4 Elevation 4728.2

PROPERTY BENCHMARK HAYSTACK RANCHES

DESCRIPTION OF PROPERTY BENCHMARK BM-4 ELEVATION 4728.2 BEING 1/2" REBAR WITH CAP.

GROUND ELEVATIONS AT BUILDING SITE 4737.0+/-

*(Please provide a minimum of three (3) elevation points, representative of the site)*

Sketch of Lot  
*(include location of property benchmark and building site elevations)*

Remarks \_\_\_\_\_

SEE ATTACHMENT



Signed \_\_\_\_\_  
CONTRACT SURVEYING, INC.

Company Name  
707 EL CAMINO CORVO

Address  
PRESCOTT, AZ 86301

Telephone 928-778-0636

FOR YAVAPAI COUNTY FLOOD CONTROL DISTRICT USE:

Date: \_\_\_\_\_

Base Flood Elevation \_\_\_\_\_ - 1.0' = Regulatory Elevation

\* ELEVATION DETERMINATIONS ARE BASED ON BEST AVAILABLE DATA WHEN CALCULATED ELEVATIONS ARE SUBJECT TO CHANGE WHEN NEW OR REVISED FLOOD STUDIES OR DATA IS SUPPLIED TO THE DISTRICT.