



Yavapai County Development Services Department

500 S. Marina Street; Prescott, AZ. 86303
Phone: (928) 771-3214 Fax: (928) 771-3432

10 S. 6th Street; Cottonwood, AZ. 86326
Phone: (928) 639-8151 Fax: (928) 639-8153

Addressing – Building Safety – Customer Service & Permitting – Environmental – Flood Control – Land Use – Planning & Design Review

April 15, 2005

Mr. Steven Graham, Technical Specialist III
Michael Baker Corporation
355 Union Boulevard, Suite 200
Lakewood, CO 80228

RE: LOMA Case 05-09-0504A
Lot 20B Chino Lakes, Yavapai County, Arizona

Dear Steven:

I have enclosed the following for your re-review of the case above:

1. Original LOMA Determination Letter from FEMA
2. Survey showing the location of the structure on Lot 20B stamped by Arizona Registered Land Surveyor (Please note this is to scale 1"=100').
3. Copy of our Elevation Certificate on File with County
4. FIRM Panel and Location of Property on Panel
5. County's Determination from FIS Profile for upstream Structure Location
6. County's GIS Printout of Structure in reference to Floodplain.

This is the determination we discussed earlier this week, where your office determined the base flood elevation based on the upstream location of the parcel and not the structure. The enclosures should help your office clearly determine where the structure location is on the parcel.

If you have any questions or need any additional information, please feel free to call me at (928) 442-5414.

Thanks for your assistance on this matter.

Sincerely,
YAVAPAI COUNTY FLOOD CONTROL DISTRICT

Jeff Low, CFM
Floodplain Unit Manager

CC: Grady Lefler (w/o Enclosures)
3874 N. Reed Road
Chino Valley, Arizona 86323

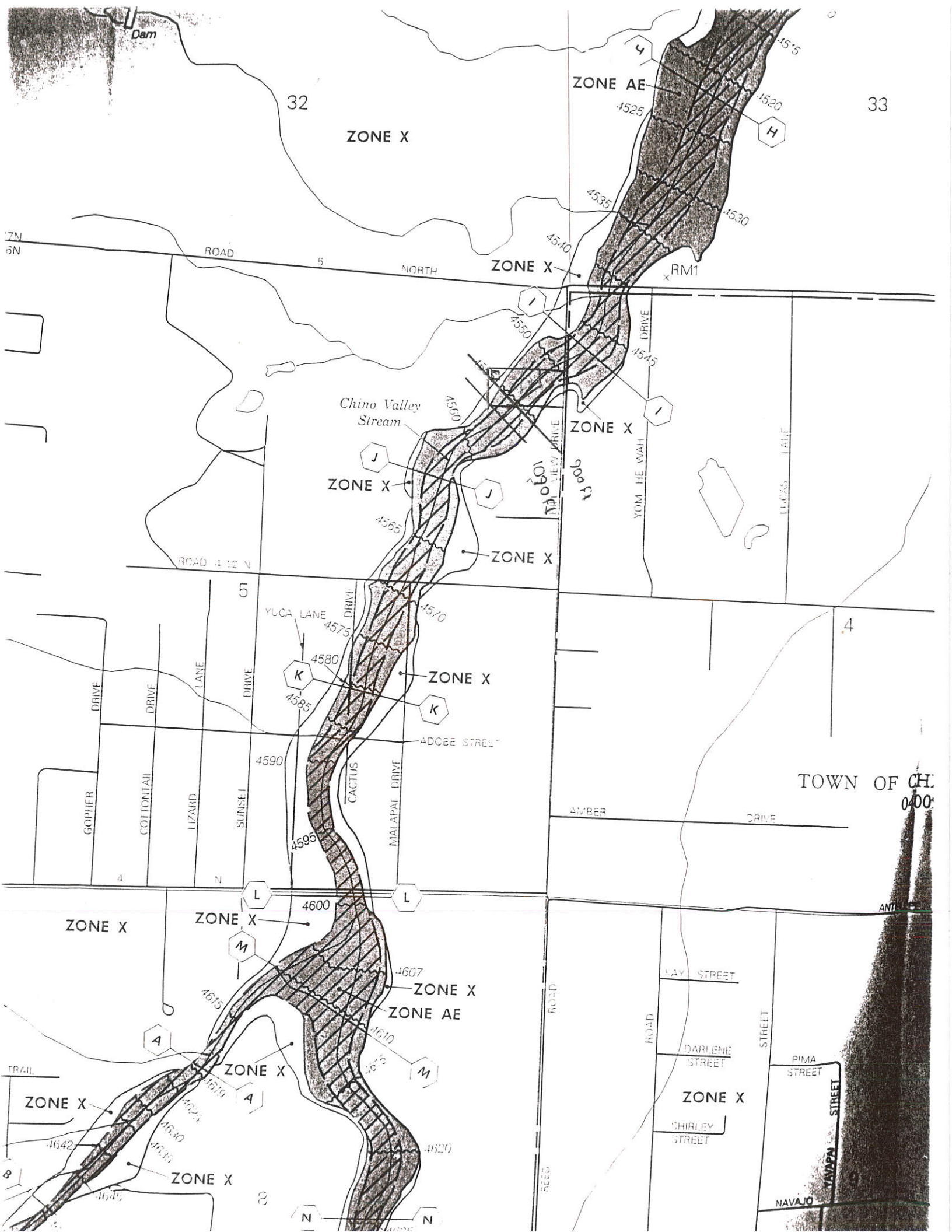

Dam

32

ZONE X

33

ZONE AE

4525

4520

4535

4530

ZONE X

RM1

4550

4545

Chino Valley Stream

4560

ZONE X

J

4565

MALAPAL VIEW DRIVE

600 FT

4575

YOM HE WAH DRIVE

LUCAS LANE

ROAD 4 1/2 N

ZONE X

4575

4580

4585

4590

4595

4600

4607

4610

4615

4619

4620

4625

4630

4635

4642

4645

4

TOWN OF CHINO VALLEY

AMBER DRIVE

DRIVE

ANTHONY

ZONE X

ZONE X

ZONE X

K

K

ADOCBE STREET

L

L

M

M

M

M

M

M

M

M

ZONE X

ZONE X

MAY STREET

DARLENE STREET

CHIRLEY STREET

PIMA STREET

NAVAJO STREET

YAVAPAI STREET

REED ROAD

ROAD

STREET

TRAIL

8

8

N

N

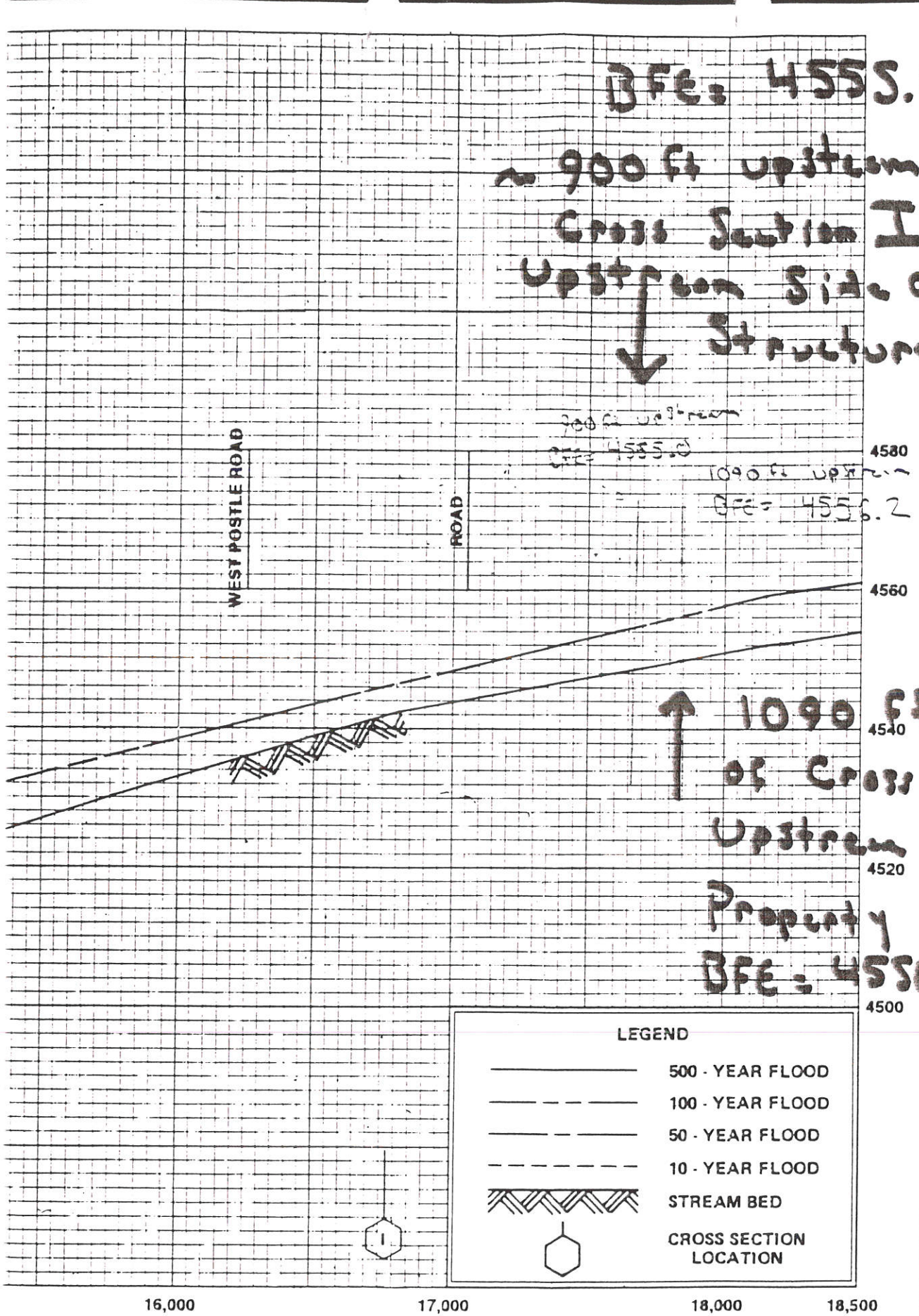

BFE: 4555.0 ft
 ~ 900 ft upstream of
 Cross Section I
 Upstream Side of
 Structure

↑ 1090 ft upstream
 of Cross Section II
 Upstream Side of
 Property
 BFE: 4555.2

LEGEND	
	500 - YEAR FLOOD
	100 - YEAR FLOOD
	50 - YEAR FLOOD
	10 - YEAR FLOOD
	STREAM BED
	CROSS SECTION LOCATION

FLOOD PROFILES
 CHINO VALLEY STREAM

FEDERAL EMERGENCY MANAGEMENT AGENCY
 YAVAPAI COUNTY
 AND INCORPORATED AREAS

DOWN THE CONFLUENCE WITH SANTA CRUZ WASH ALONG PROFILE BASELINE

where elevations of depths have been established
determine if flood insurance is available, contact an insurance agent or
the National Flood Insurance Program at (800) 638-6629

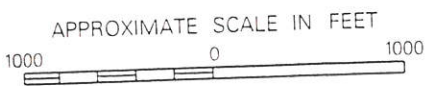

1340

NATIONAL FLOOD INSURANCE PROGRAM

FIRM
FLOOD INSURANCE RATE MAP
YAVAPAI COUNTY,
ARIZONA AND
INCORPORATED AREAS

PANEL 1340 OF 3925
(SEE MAP INDEX FOR PANELS NOT PRINTED)

<u>CONTAINS:</u> <u>COMMUNITY</u>	<u>NUMBER</u>	<u>PANEL</u>	<u>SUFFIX</u>
CHINO VALLEY TOWN OF	040094	1340	F
YAVAPAI COUNTY UNINCORPORATED AREAS	040093	1340	F

MAP NUMBER
04025C1340 F

EFFECTIVE DATE:
JUNE 6, 2001



Federal Emergency Management Agency



Federal Emergency Management Agency

Washington, D.C. 20472

LETTER OF MAP AMENDMENT DETERMINATION DOCUMENT (REMOVAL)

COMMUNITY AND MAP PANEL INFORMATION		LEGAL PROPERTY DESCRIPTION
COMMUNITY	YAVAPAI COUNTY, ARIZONA (Unincorporated Areas)	Lot 20B, Chino Lakes No.1, as described in the Quit-Claim Deed, recorded as Document No. 3740798 in Book 4166, Page 333, in the Office of the Recorder, Yavapai County, Arizona THIS LOMA SUPERSEDES LOMA-DEN 05-09-0504A EFF 4/1/2005
	COMMUNITY NO.: 040093	
AFFECTED MAP PANEL	NUMBER: 04025C1340F	
	NAME: YAVAPAI COUNTY, ARIZONA AND INCORPORATED AREAS	
	DATE: 6/6/2001	
FLOODING SOURCE: CHINO VALLEY STREAM		APPROXIMATE LATITUDE & LONGITUDE OF PROPERTY: 34.804, -112.483 SOURCE OF LAT & LONG: PRECISION MAPPING STREETS 7.0 DATUM: NAD 83

DETERMINATION

LOT	BLOCK/ SECTION	SUBDIVISION	STREET	OUTCOME WHAT IS REMOVED FROM THE SFHA	FLOOD ZONE	1% ANNUAL CHANCE FLOOD ELEVATION (NGVD 29)	LOWEST ADJACENT GRADE ELEVATION (NGVD 29)	LOWEST LOT ELEVATION (NGVD 29)
20B	—	Chino Lakes	3874 North Reed Road	Structure	X (shaded)	4554.8 feet	4556.2 feet	—

Special Flood Hazard Area (SFHA) - The SFHA is an area that would be inundated by the flood having a 1-percent chance of being equaled or exceeded in any given year (base flood).

ADDITIONAL CONSIDERATIONS (Please refer to the appropriate section on Attachment 1 for the additional considerations listed below.)

PORTIONS REMAIN IN THE SFHA
SUPERSEDES PREVIOUS DETERMINATION

This document provides the Federal Emergency Management Agency's determination regarding a request for a Letter of Map Amendment for the property described above. Using the information submitted and the effective National Flood Insurance Program (NFIP) map, we have determined that the structure(s) on the property(ies) is/are not located in the SFHA, an area inundated by the flood having a 1-percent chance of being equaled or exceeded in any given year (base flood). This document amends the effective NFIP map to remove the subject property from the SFHA located on the effective NFIP map; therefore, the Federal mandatory flood insurance requirement does not apply. However, the lender has the option to continue the flood insurance requirement to protect its financial risk on the loan. A Preferred Risk Policy (PRP) is available for buildings located outside the SFHA. Information about the PRP and how one can apply is enclosed.

This determination is based on the flood data presently available. The enclosed documents provide additional information regarding this determination. If you have any questions about this document, please contact the FEMA Map Assistance Center toll free at (877) 336-2627 (877-FEMA MAP) or by letter addressed to the Federal Emergency Management Agency, 3601 Eisenhower Avenue, Suite 130, Alexandria, VA 22304-6439.

Doug Bellomo, P.E., Chief
Hazard Identification Section, Mitigation Division
Emergency Preparedness and Response Directorate

Version 1.3.3

1056349.1LOMA-SL093460914



Federal Emergency Management Agency
Washington, D.C. 20472

**LETTER OF MAP AMENDMENT
DETERMINATION DOCUMENT (REMOVAL)**
ATTACHMENT 1 (ADDITIONAL CONSIDERATIONS)

PORTIONS OF THE PROPERTY REMAIN IN THE SFHA (This Additional Consideration applies to the preceding 1 Property.)

Portions of this property, but not the subject of the Determination/Comment document, may remain in the Special Flood Hazard Area. Therefore, any future construction or substantial improvement on the property remains subject to Federal, State/Commonwealth, and local regulations for floodplain management.

SUPERSEDES OUR PREVIOUS DETERMINATION (This additional consideration applies to all properties in the LOMA DETERMINATION DOCUMENT (REMOVAL))

This Determination Document supersedes our previous determination dated 4/1/2005, for the subject property.

This attachment provides additional information regarding this request. If you have any questions about this attachment, please contact the FEMA Map Assistance Center toll free at (877) 336-2627 (877-FEMA MAP) or by letter addressed to the Federal Emergency Management Agency, 3601 Eisenhower Avenue, Suite 130, Alexandria, VA 22304-6439.

A handwritten signature in black ink, appearing to read "Doug Bellomo".

Doug Bellomo, P.E., Chief
Hazard Identification Section, Mitigation Division
Emergency Preparedness and Response Directorate Version 1.3.3

1056349.1LOMA-SL093460914



Federal Emergency Management Agency
Washington, D.C. 20472

**LETTER OF MAP AMENDMENT
DETERMINATION DOCUMENT (NON-REMOVAL)**

COMMUNITY AND MAP PANEL INFORMATION		LEGAL PROPERTY DESCRIPTION
COMMUNITY	YAVAPAI COUNTY, ARIZONA (Unincorporated Areas)	Lot 20B, Chino Lakes No. 1, as described in the Quit-Claim Deed, recorded as Document No. 3740798 in Book 4166, Page 333, in the Office of the Recorder, Yavapai County, Arizona SUPERSEDED BY LOMA 05-09-0914A EFF 4/28/2005 STRUCTURE REMOVED FROM THE SFHA
	COMMUNITY NO.: 040093	
AFFECTED MAP PANEL	NUMBER: 04025C1340F	
	NAME: YAVAPAI COUNTY, ARIZONA AND INCORPORATED AREAS	
	DATE: 6/6/2001	
FLOODING SOURCE: CHINO VALLEY STREAM		APPROXIMATE LATITUDE & LONGITUDE OF PROPERTY: 34.801, -112.486 SOURCE OF LAT & LONG: PRECISION MAPPING STREETS 7.0 DATUM: NAD 83

DETERMINATION

LOT	BLOCK/ SECTION	SUBDIVISION	STREET	OUTCOME WHAT IS NOT REMOVED FROM THE SFHA	FLOOD ZONE	1% ANNUAL CHANCE FLOOD ELEVATION (NGVD 29)	LOWEST ADJACENT GRADE ELEVATION (NGVD 29)	LOWEST LOT ELEVATION (NGVD 29)
20B	—	Chino Lakes	3874 North Reed Road	Structure	AE	4556.8 feet	4556.2 feet	—

Special Flood Hazard Area (SFHA) - The SFHA is an area that would be inundated by the flood having a 1-percent chance of being equaled or exceeded in any given year (base flood).

This document provides the Federal Emergency Management Agency's determination regarding a request for a Letter of Map Amendment for the property described above. Using the information submitted and the effective National Flood Insurance Program map, we have determined that the structure(s) on the property(ies) is/are located in the SFHA, an area inundated by the flood having a 1-percent chance of being equaled or exceeded in any given year (base flood). Therefore, flood insurance is required for the property described above. The lowest adjacent grade elevation to a structure must be at or above the Base Flood Elevation for a structure to be outside of the SFHA.

This determination is based on the flood data presently available. The enclosed documents provide additional information regarding this determination and information regarding your options for obtaining a Letter of Map Amendment. If you have any questions about this document, please contact the FEMA Map Assistance Center toll free at (877) 336-2627 (877-FEMA MAP) or by letter addressed to the Federal Emergency Management Agency, 3601 Eisenhower Avenue, Suite 600, Alexandria, VA 22304-6439.

Doug Bellomo, P.E., CFM, Chief
Hazard Identification Section, Mitigation Division
Emergency Preparedness and Response Directorate Version 1.3.3

1029299.1LOMA-SL097520504