



Federal Emergency Management Agency

Washington, D.C. 20472

JUN 26 2000

The Honorable Chip Davis
Chairman, Board of Supervisors
1015 Fair Street, Room 310
Prescott, AZ 86301

Case No.: 00-09-648A
Community: Yavapai County, AZ
Community No.: 040093

Dear Mr. Davis:

This is in reference to a request that the Federal Emergency Management Agency (FEMA) determine if property is located within an identified Special Flood Hazard Area, the area that would be inundated by the flood having a 1-percent chance of being equaled or exceeded in any given year (base flood), on the effective National Flood Insurance Program (NFIP) map. Using the information submitted and the effective NFIP map, our determination is shown on the attached Letter of Map Revision based on Fill (LOMR-F) Determination Document. This determination document provides additional information regarding the effective NFIP map, the legal description of the property, and our determination.

Additional documents are enclosed which provide information regarding the subject property and LOMR-Fs. Please see the List of Enclosures below to determine which documents are enclosed. If you have any questions about this letter or any of the enclosures, please contact the FEMA Map Assistance Center toll free at 1-877-336-2627 (FEMA MAP) or by letter addressed to the FEMA LOMA DEPOT, 3601 Eisenhower Avenue, Suite 600, Alexandria, VA 22304-6439.

Sincerely,

Matthew B. Miller, P.E., Chief
Hazards Study Branch
Mitigation Directorate

List of Enclosures

- LOMR-F Determination Letter; Pages 1, 2, & 3

cc: Community Map Repository
State NFIP Coordinator
Regional Director R9-MT

Mr. Kenneth Spedding; District Director, Yavapai County

Mr. Anthony Burd; Ambre, Inc.



Federal Emergency Management Agency

Washington, D.C. 20472

LETTER OF MAP REVISION BASED ON FILL DETERMINATION DOCUMENT (REMOVAL)

COMMUNITY AND MAP PANEL INFORMATION		LEGAL PROPERTY DESCRIPTION
COMMUNITY	Yavapai County, Arizona	Lots 84 through 109, 142, 143, and 144, Las Piedras Unit Two, as shown on the Plat recorded as Instrument No. 3195447 in Book 39, Pages 49, 50, and 51, in the Office of the Recorder, Yavapai County, Arizona
	COMMUNITY NO: 040093	
MAP PANEL AFFECTED	NUMBER: 0880 B	
	NAME: Yavapai County, Arizona	
	DATE: August 19, 1985	
FLOODING SOURCE: Jacks Canyon		APPROXIMATE LATITUDE & LONGITUDE: 34.57, -112.44 SOURCE OF LATITUDE & LONGITUDE: MAPBLAST

DETERMINATION

LOT	BLOCK/SECTION	SUBDIVISION	STREET ADDRESS	OUTCOME WHAT IS REMOVED FROM THE SFHA	NEW FLOOD ZONE	1% ANNUAL CHANCE FLOOD ELEVATION (NGVD)	LOWEST ADJACENT GRADE ELEVATION (NGVD)	LOWEST FLOOR ELEVATION (NGVD)	LOWEST LOT ELEVATION (NGVD)
84	N/A	Las Piedras	N/A	Property	C	4010.8 feet	N/A	N/A	4016.7 feet
85	N/A	Las Piedras	N/A	Property	C	4011.2 feet	N/A	N/A	4015.0 feet

Special Flood Hazard Area (SFHA) – The SFHA is an area that would be inundated by the flood having a 1-percent chance of being equaled or exceeded in any given year (base flood).

ADDITIONAL CONSIDERATIONS (if the appropriate box is checked, please refer to the appropriate section on Attachment 1)

- | | |
|--|--|
| <input type="checkbox"/> 1. PROPERTY DESCRIPTION (CONTINUED) | <input checked="" type="checkbox"/> 6. STUDY UNDERWAY |
| <input checked="" type="checkbox"/> 2. DETERMINATION TABLE (CONTINUED) | <input checked="" type="checkbox"/> 7. FILL RECOMMENDATION |
| <input type="checkbox"/> 3. PORTIONS REMAIN IN THE FLOODWAY | <input type="checkbox"/> 8. PORTIONS REMAIN IN THE SFHA |
| <input type="checkbox"/> 4. INADVERTENT INCLUSION IN THE FLOODWAY | |
| <input type="checkbox"/> 5. ZONE V OR ZONE A | |

This document provides the Federal Emergency Management Agency's determination regarding a request for a Letter of Map Revision based on Fill for the property described above. Using the information submitted and the effective National Flood Insurance Program (NFIP) map, we determined the properties are not located in the SFHA, an area inundated by the flood having a 1-percent chance of being equaled or exceeded in any given year (base flood). This document revises the effective NFIP map to remove the properties from the SFHA; therefore, the federal mandatory flood insurance requirement does not apply. However, the lender has the option to continue the flood insurance requirement to protect its financial risk on the loan. A Preferred Risk Policy (PRP) is available for buildings located outside the SFHA. Information about the PRP and how one can apply is enclosed.

This determination is based on the flood data presently available. The enclosed documents provide additional information regarding this determination. If you have any questions about this document, please contact the FEMA Map Assistance Center toll free at 1-877-336-2627 (FEMA MAP) or by letter addressed to the FEMA LOMA DEPOT, 3601 Eisenhower Avenue, Suite 600, Alexandria, VA 22304-6439.

Matthew B. Miller

Matthew B. Miller, P.E., Chief
Hazards Study Branch
Mitigation Directorate

RECEIVED

Version 1.0

2418005CBM07091620648

JUL 09 2000

B.O.S.
Yavapai County

JUN 26 2000



Federal Emergency Management Agency

Washington, D.C. 20472

LETTER OF MAP REVISION BASED ON FILL DETERMINATION DOCUMENT (REMOVAL) ATTACHMENT 1 (ADDITIONAL CONSIDERATIONS)

2. DETERMINATION DOCUMENT TABLE (CONTINUED)

LOT	BLOCK/ SECTION	SUBDIVISION	STREET ADDRESS	OUTCOME WHAT IS REMOVED FROM THE SFHA	NEW FLOOD ZONE	1% ANNUAL CHANCE FLOOD ELEVATION (NGVD)	LOWEST ADJACENT GRADE ELEVATION (NGVD)	LOWEST FLOOR ELEVATION (NGVD)	LOWEST LOT ELEVATION (NGVD)
86	N/A	Las Piedras	N/A	Property	C	4011.6 feet	N/A	N/A	4015.0 feet
87	N/A	Las Piedras	N/A	Property	C	4012.0 feet	N/A	N/A	4015.0 feet
88	N/A	Las Piedras	N/A	Property	C	4012.5 feet	N/A	N/A	4016.9 feet
89	N/A	Las Piedras	N/A	Property	C	4013.0 feet	N/A	N/A	4017.9 feet
90	N/A	Las Piedras	N/A	Property	C	4013.5 feet	N/A	N/A	4017.2 feet
91	N/A	Las Piedras	N/A	Property	C	4014.0 feet	N/A	N/A	4019.0 feet
92	N/A	Las Piedras	N/A	Property	C	4014.6 feet	N/A	N/A	4019.0 feet
93	N/A	Las Piedras	N/A	Property	C	4015.4 feet	N/A	N/A	4019.0 feet
94	N/A	Las Piedras	N/A	Property	C	4016.2 feet	N/A	N/A	4019.1 feet
95	N/A	Las Piedras	N/A	Property	C	4017.1 feet	N/A	N/A	4021.9 feet
96	N/A	Las Piedras	N/A	Property	C	4018.0 feet	N/A	N/A	4022.9 feet
97	N/A	Las Piedras	N/A	Property	C	4020.5 feet	N/A	N/A	4022.6 feet
98	N/A	Las Piedras	N/A	Property	C	4021.9 feet	N/A	N/A	4024.1 feet
99	N/A	Las Piedras	N/A	Property	C	4022.5 feet	N/A	N/A	4024.0 feet
100	N/A	Las Piedras	N/A	Property	C	4023.2 feet	N/A	N/A	4024.8 feet
101	N/A	Las Piedras	N/A	Property	C	4024.0 feet	N/A	N/A	4026.0 feet
102	N/A	Las Piedras	N/A	Property	C	4025.0 feet	N/A	N/A	4026.3 feet
103	N/A	Las Piedras	N/A	Property	C	4026.1 feet	N/A	N/A	4027.3 feet
104	N/A	Las Piedras	N/A	Property	C	4027.1 feet	N/A	N/A	4028.0 feet
105	N/A	Las Piedras	N/A	Property	C	4027.7 feet	N/A	N/A	4029.4 feet
106	N/A	Las Piedras	N/A	Property	C	4028.3 feet	N/A	N/A	4030.4 feet
107	N/A	Las Piedras	N/A	Property	C	4029.0 feet	N/A	N/A	4030.3 feet
108	N/A	Las Piedras	N/A	Property	C	4029.6 feet	N/A	N/A	4034.0 feet
109	N/A	Las Piedras	N/A	Property	C	4030.2 feet	N/A	N/A	4035.0 feet
142	N/A	Las Piedras	N/A	Property	C	4015.0 feet	N/A	N/A	4019.5 feet
143	N/A	Las Piedras	N/A	Property	C	4015.6 feet	N/A	N/A	4020.0 feet
144	N/A	Las Piedras	N/A	Property	C	4016.2 feet	N/A	N/A	4021.3 feet

This attachment provides additional information regarding this request. If you have any questions about this attachment, please contact the Federal Emergency Management Agency Map Assistance Center toll free at 1-877-336-2627 (FEMA MAP) or by letter addressed to the FEMA LOMA DEPOT, 3601 Eisenhower Avenue, Suite 600, Alexandria, VA 22304-6439.

Matthew B. Miller

Matthew B. Miller, P.E., Chief
Hazards Study Branch
Mitigation Directorate



Federal Emergency Management Agency

Washington, D.C. 20472

LETTER OF MAP REVISION BASED ON FILL DETERMINATION DOCUMENT (REMOVAL) ATTACHMENT 1 (ADDITIONAL CONSIDERATIONS)

6. STUDY UNDERWAY

This determination is based on the flood data presently available. However, the Federal Emergency Management Agency is currently revising the National Flood Insurance Program (NFIP) map for Yavapai County, Arizona and Incorporated Areas. New flood data could be generated that may affect this property. When the new NFIP map is issued it will supersede this determination. The Federal requirement for the purchase of flood insurance will then be based on the new effective NFIP map.

7. FILL RECOMMENDATION

Although the criteria for removal of the subject area based on fill have been met for this request, Subparagraph 65.5(a)(4) of the National Flood Insurance Program regulations stipulates that if a structure is involved in a request for a Letter of Map Revision based on Fill, the Federal Emergency Management Agency's determination is based on comparisons of the lowest floor (including basement/crawl space) and the lowest adjacent grade elevations with the base flood elevation. If the entire structure is at or above the elevation of the base flood, the structure may be excluded from the Special Flood Hazard Area.

This attachment provides additional information regarding this request. If you have any questions about this attachment, please contact the Federal Emergency Management Agency Map Assistance Center toll free at 1-877-336-2627 (FEMA MAP) or by letter addressed to the FEMA LOMA DEPOT, 3601 Eisenhower Avenue, Suite 600, Alexandria, VA 22304-6439.

Matthew B. Miller

Matthew B. Miller, P.E., Chief
Hazards Study Branch
Mitigation Directorate



Federal Emergency Management Agency

Washington, D.C. 20472

August 3, 2010

The Honorable Chip Davis
Chairman, Board of Supervisors
Yavapai County
1015 Fair Street
Prescott, AZ 86305-1852

Case No: 07-09-1473V
Community: Yavapai County, Unincorporated
Areas, Arizona

Community No.: 040093

Effective Date: September 04, 2010

LOMC-VALID

Dear Chairman Davis:

This letter revalidates the determinations for properties and/or structures in the referenced community as described in the Letters of Map Change (LOMCs) previously issued by the Department of Homeland Security's Federal Emergency Management Agency (FEMA) on the dates listed on the enclosed table. As of the effective date shown above, these LOMCs will revise the effective National Flood Insurance Program (NFIP) map dated September 03, 2010 for the referenced community, and will remain in effect until superseded by a revision to the NFIP map panel on which the property is located. The FEMA case number, property identifier, NFIP map panel number, and current flood insurance zone for the revalidated LOMCs are listed on the enclosed table.

Because these LOMCs will not be printed or distributed to primary map users, such as local insurance agents and mortgage lenders, your community will serve as a repository for this new data. We encourage you to disseminate the information reflected by this letter throughout your community so that interested persons, such as property owners, local insurance agents, and mortgage lenders, may benefit from the information.

For information relating to LOMCs not listed on the enclosed table or to obtain copies of previously issued LOMR-Fs and LOMAs, if needed, please contact our FEMA Map Information eXchange (FMIX), toll free, at 1-877-FEMA-MAP (1-877-336-2627).

Sincerely,

Kevin C. Long, Acting Chief
Engineering Management Branch
Mitigation Directorate

Enclosure

cc: Community Map Repository
Mr. Charles A. Cave, Project Manager Yavapai County Flood Control District
Mr. Brian Cosson, CFM, NFIP State Coordinator
LOMC Subscription Service Subscribers
Mr. Edward Curtis, P.E., CFM, Senior Engineer, FEMA Region IX

REVALIDATED LETTERS OF MAP CHANGE FOR YAVAPAI COUNTY, AZ
Case No: 07-09-1473V **Community No.: 040093**

September 04, 2010

<u>Case No.</u>	<u>Date Issued</u>	<u>Identifier</u>	<u>Map Panel No.</u>	<u>Zone</u>
199107280FLA	07/16/1991	PORTION OF SECTION 24, T17N, R5E, G.&S.R.B.&M.	04025C1435G	X
95-09-139A	12/28/1994	WILDWOOD ESTATES, LOT 31-- 3 GLEN OAKS	04025C2035G	X
96-09-204A	04/15/1996	1335-1365 BATES ROAD -- PORTION OF SECTION 12, T15N, R3E, G.&S.R.B.&M.	04025C1780G	X
97-09-1121A 407-14-606A	12/11/1997	675 SOUTH SHEEPSHEAD CROSSING - - PORTION OF SECTION 4, T15N, R4E, G.&S.R.B.&M.	04025C1785G	X
98-09-085A	12/11/1997	PRESCOTT COUNTRY CLUB UNIT 2, TRACT A, PARCEL 3 -- 11990 TURQUOISE CIRCLE	04025C2095G	X
98-09-1062A	09/25/1998	11135 DORA LANE -- PORTION OF SECTIONS 3 & 10, T15N, R3W, G.&S.R.B.&M.	04025C1660G	X
98-09-1028A	11/06/1998	PENNY ACRES, LOT 3 -- 3731 CAROL LANE	04025C1780G	X
99-09-467A	03/26/1999	LAS PIEDRAS UNIT ONE, LOTS 51-53, & 63-65	04025C1445G	X
99-09-523A	04/29/1999	SWINGING BRIDGE ESTATES, LOT 4 -- 115 COYOTE LANE	04025C1785G	X
00-09-229A	02/16/2000	605 NORTH BLACKHAWK DRIVE -- PORTION OF SECTION 35, T16N, R4E, G.&S.R.B.&M.	04025C1785G	X
00-09-648A	06/26/2000	LAS PIEDRAS UNIT 2, LOTS 84-109, 142-144	04025C1445G	X
00-09-654A	07/24/2000	KINGSWOOD HEIGHTS UNIT 1, LOT 3 -- 2580 TOLEMAR ROAD	04025C2035G	X
01-09-502A	05/02/2001	520 NORTH ARRIBA -- PORTION OF SECTION 35, T16N, R3E, G.&S.R.B.&M.	04025C1757G	X
02-09-114A	12/31/2001	CORDES LAKES UNIT 5, LOT 1488 -- 20041 EAST FREMONT DRIVE	04025C2890G	X
02-09-173A	02/20/2002	10201 RAFTER LANE -- PORTION OF SECTION 10, T15N, R4E, G.&S.R.B.&M.	04025C1785G	X
01-09-1162A	03/15/2002	VERDE PALISADES, BLOCK B, LOT 3 - - 1288 PALISADE DRIVE	04025C1759G	X



REVALIDATED LETTERS OF MAP CHANGE FOR YAVAPAI COUNTY, AZ
Case No: 07-09-1473V **Community No.: 040093**

September 04, 2010

Case No.	Date Issued	Identifier	Map Panel No.	Zone
02-09-237A	03/29/2002	732 FOREST SERVICE ROAD -- PORTION OF SECTION 14, T13N, R3E, G.&S.R.B.&M.	04025C2175G	X
02-09-766A	05/01/2002	2295 EAST ASPEN STREET -- PORTION OF SECTION 35, T16N, R3E, G.&S.R.B.&M.	04025C1757G	X
02-09-921A	06/12/2002	MONTEZUMA PARK UNIT 6, LOT 119 - - 3440 YUMA DRIVE	04025C1820G	X
02-09-1108A	09/18/2002	VERDE PALISADES, BLOCK B, LOT 4 - - 1275 PALISADE DRIVE	04025C1759G	X
02-09-1129A	10/09/2002	CANYON MESA COUNTRY CLUB, PHASE III, LOTS 1-2, 16-20	04025C1445G	X
03-09-0050A	11/12/2002	HIGHLAND ESTATES II, UNIT 2, LOT 65 -- 45 HIGHLAND DRIVE SOUTH	04025C1445G	X
03-09-0147A	12/02/2002	KINGSWOOD HEIGHTS UNIT 1, LOT 2 -- 2540 TOLEMAC WAY	04025C2035G	X
03-09-0130A	12/18/2002	200 WEST MULCAIRE DRIVE -- PORTION OF SECTION 33, T16N, R4E, G.&S.R.B.&M.	04025C1785G	X
03-09-0174A	12/26/2002	POQUITO VALLEY, LOT 30 -- 10195 NORTH POQUITO VALLEY ROAD	04025C1725G	X
04-09-0228A	01/21/2004	13125 WALTERS ROAD -- PORTION OF SECTION 32, T14N, R4W, G.&S.R.B.&M.	04025C2015G	X
03-09-1684A	02/06/2004	KINGSWOOD HEIGHTS UNIT 1, LOT 11 -- 2840 NORTH TOLEMAK ROAD	04025C2035G	X
04-09-0527A	05/28/2004	2605 WEST ROAD 3 NORTH -- PORTION OF SECTION 17, T16N, R2W, G.&S.R.B.&M.	04025C1315G	X
05-09-0644A	04/01/2005	MONTEZUMA PARK UNIT 6, LOT 119 - - 3440 YUMA DRIVE	04025C1820G	X
05-09-0553A	04/18/2005	KINGSWOOD HEIGHTS UNIT 1, LOT 4 -- 2600 NORTH TOLEMAC ROAD	04025C2035G	X
05-09-0914A	04/28/2005	CHINO LAKES, LOT 20B -- 3874 NORTH REED ROAD	04025C1315G	X
06-09-0168A	12/19/2005	8450 EAST MORNING STAR RANCH ROAD	04025C1725G	X
06-09-0291A	02/02/2006	HAYSTACK RANCHES, LOT 2B -- 5130 EAST HAYSTACK ROAD	04025C1320G	X
06-09-0291A	02/02/2006	HAYSTACK RANCHES, LOT 2B -- 5130 EAST HAYSTACK ROAD	04025C1350G	X

REVALIDATED LETTERS OF MAP CHANGE FOR YAVAPAI COUNTY, AZ
Case No: 07-09-1473V **Community No.: 040093**

September 04, 2010

Case No.	Date Issued	Identifier	Map Panel No.	Zone
06-09-0049A	02/28/2006	MONTEZUMA HAVEN, LOT 104 -- 4365 EAST AZTEC ROAD	04025C1820G	X
06-09-BA60A	08/02/2006	3525 WEST ROAD 2 NORTH	04025C1295G	X
07-09-0039A	11/07/2006	19605 EAST FREMONT DRIVE -- LOT 2273, CORDES LAKES UNIT 6	04025C2880G	X
07-09-0200A	11/21/2006	HAYSTACK RANCHES SECOND REPLAT, A PORTION OF LOT 2B --5350 EAST HAYSTACK RANCH ROAD	04025C1320G	X
07-09-0200A	11/21/2006	HAYSTACK RANCHES SECOND REPLAT, A PORTION OF LOT 2B --5350 EAST HAYSTACK RANCH ROAD	04025C1350G	X
07-09-0673A	02/20/2007	LOT 86, INSCRIPTION CANYON RANCH, UNIT 1 -- 13878 NORTH SIGNAL HILL ROAD	04025C1675G	X
07-09-0878A	03/20/2007	1318 SOUTH PARADISE DRIVE	04025C1759G	X
07-09-0406A	03/27/2007	CANYON MESA COUNTRY CLUB PHASE 1, UNIT 19 -- 44 RED RIVER ROAD (AZ)	04025C1445G	X
07-09-0726A	04/03/2007	PINE VALLEY Amended, LOT 195 -- 3070 VALLEY VISTA DRIVE	04025C1465G	X
07-09-0892A	04/19/2007	HI-LO RANCH -- 400 LOY LANE (AZ)	04025C1430G	X
07-09-1336A	07/19/2007	2525 CANTA LIBRE ROAD -- PORTION OF SECTION 17, T16N, R2W	04025C1315G	X
08-09-0147A	11/13/2007	1139 SOUTH FULLER LANE -- PORTION OF SECTION 3, T15N, R4E, G.&.S.R.B.M.	04025C1785G	X
07-09-1934A	12/18/2007	SECTIONS 3&10, T15N, R3W, G&SRB&M -- 5455 WEST STAZENSKI ROAD	04025C1660G	X
08-09-0095A	12/31/2007	PARCEL A, LOT 14, HAYSTACK RANCHES -- 5455 EAST HAYSTACK ROAD	04025C1350G	X
08-09-0573A	03/20/2008	2570 NORTH KOOLRIDGE WAY -- Sec 8, T16N, R22W, G.S.R.B.M.	04025C1315G	X
08-09-0743A	04/17/2008	PORTION OF SECTION 3, T15N, R3W, G.S.R.B.M.	04025C1660G	X
08-09-0849A	04/22/2008	PARCEL C, LOT 14, HAYSTACK RANCHES -- 5485 EAST HAYSTACK ROAD	04025C1350G	X

REVALIDATED LETTERS OF MAP CHANGE FOR YAVAPAI COUNTY, AZ
Case No: 07-09-1473V **Community No.: 040093**
September 04, 2010

Case No.	Date Issued	Identifier	Map Panel No.	Zone
08-09-0789A	04/24/2008	PORTION OF SECTIONS 3&10, T15N, R3W, GSRM -- 5275 WEST STAZENSKI ROAD	04025C1660G	X
08-09-1057A	07/15/2008	PORTION OF LOTS 249, 272, 273, 275, IDYLVILD TRACT -- 2221 VIEW DRIVE	04025C2045G	X
08-09-1316A	07/15/2008	CORDES LAKES, UNIT 5, LOT 1424 -- 20496 AZTEC TRAIL	04025C2890G	X
08-09-1386A	08/05/2008	33290 SOUTH HAWASI TRAIL -- PORTION OF SECTION 35, T9N, R3E, G.&.S.R.B.&.M.	04025C3610G	X
08-09-1879A	10/30/2008	641 WEST MARICOPA DRIVE -- LOT 1, BLOCK N, PLAT F, HASSAYAMPA MOUNTAIN CLUB, --	04025C2063G	X
09-09-1042A	03/26/2009	PORTION OF SECTION 9, T16N, R1W, G.&.S.R.B.&.M.	04025C1345G	X
09-09-1042A	03/26/2009	PORTION OF SECTION 9, T16N, R1W, G.&.S.R.B.&.M.	04025C1375G	X
09-09-1001A	04/21/2009	1900 WEST BIG CHINO ROAD -- PORTION OF SECTION 29, T18N, R2W, G.&.S.R.B.&.M.	04025C0970G	X
09-09-0842A	05/14/2009	2700 NORTH STARRY NIGHT WAY -- PORTION OF SECTION 8, T16N, R2W, G.&.S.R.B.&.M.	04025C1340G	X
09-09-1281A	05/19/2009	24100 TROY LANE -- SECTION 31, TOWNSHIP 18 NORTH, RANGE 2 WEST	04025C0970G	X
09-09-1009A	06/23/2009	MONTEZUMA PARK, UNIT 6, LOT 60 -- 3635 EAST MONTEZUMA AVENUE	04025C1820G	X
09-09-1679A	06/30/2009	COYOTE CREST 4TH, PARCEL 2 -- 8550 NORTH SERENITY DRIVE	04025C1725G	X
09-09-1516A	07/07/2009	2680 TOLEMAC WAY -- LOT 6, KINGSWOOD HEIGHTS UNIT 1	04025C2035G	X
09-09-2318A	08/27/2009	40 Juniper Street; Lot 45; Block 12; Unit 1; Pine Creek	04025C1445G	X
09-09-1539A	08/31/2009	LOT 22, CANYON MESA COUNTRY CLUB, UNIT 1, -- 64 RED RIVER ROAD	04025C1445G	X
10-09-1052A	02/11/2010	5475 WEST STAZENSKI DRIVE -- Sec 3 and 10, T15N, R3W, Gila and Salt River Base and Meridian	04025C1660G	X

REVALIDATED LETTERS OF MAP CHANGE FOR YAVAPAI COUNTY, AZ
Case No: 07-09-1473V **Community No.: 040093**

September 04, 2010

Case No.	Date Issued	Identifier	Map Panel No.	Zone
10-09-1052A	02/11/2010	5475 WEST STAZENSKI DRIVE -- Sec 3 and 10, T15N, R3W, Gila and Salt River Base and Meridian	04025C1675G	X
10-09-1174A	03/03/2010	(70-RS) 17655 WEST MODEL CREEK ROAD -- A PORTION OF SECTION 22, TOWNSHIP 11 NORTH, RANGE 5 WEST	04025C2745G	X

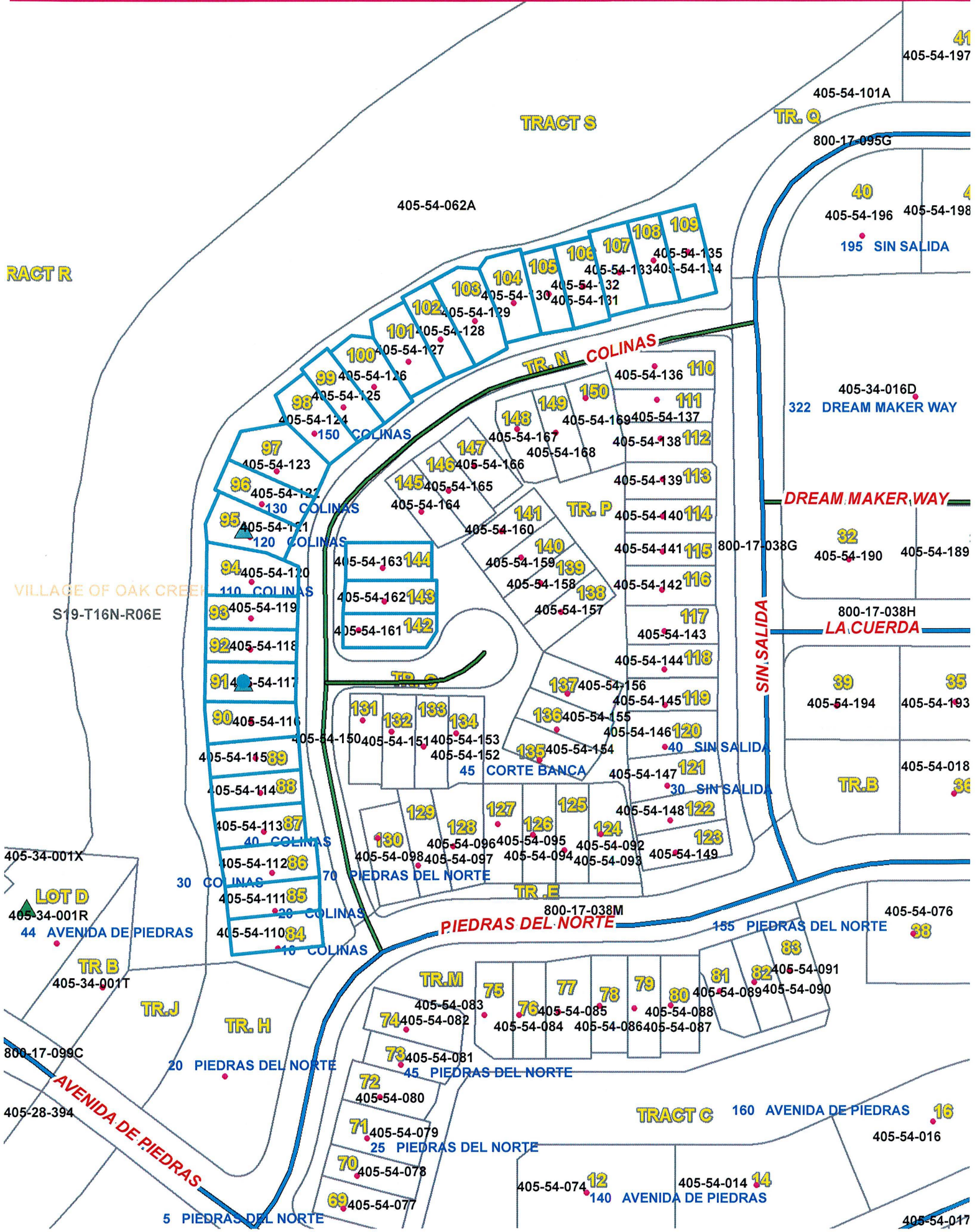

VILLAGE OF OAK CREEK
S19-T16N-R06E

LOT D
405-34-001R
44 AVENIDA DE PIEDRAS

800-17-099C
405-28-394
AVENIDA DE PIEDRAS
5 PIEDRAS DEL NORTE

800-17-038G
800-17-038H
LA CUERDA

800-17-038M
155 PIEDRAS DEL NORTE
38

TRACT C 160 AVENIDA DE PIEDRAS 16
405-54-016

405-54-074 12
140 AVENIDA DE PIEDRAS