

ELEVATION CERTIFICATE

Important: Read the instructions on pages 1-7.

SECTION A - PROPERTY OWNER INFORMATION		For Insurance Company Use:	
BUILDING OWNER'S NAME HAVEN HOMES		Policy Number	
BUILDING STREET ADDRESS (including Apt., Unit, Suite, and/or Bldg. No.) OR P.O. ROUTE AND BOX NO.		Company NAIC Number	
CITY SEDONA	STATE AZ	ZIP CODE	
PROPERTY DESCRIPTION (Lot and Block Numbers, Tax Parcel Number, Legal Description, etc.) 405-56-110 LOT #109			
BUILDING USE (e.g., Residential, Non-residential, Addition, Accessory, etc. Use a Comments area, if necessary.) Residential			
LATITUDE/LONGITUDE (OPTIONAL) (#°-##'-###" or ###.###")	HORIZONTAL DATUM: <input type="checkbox"/> NAD 1927 <input checked="" type="checkbox"/> NAD 1983	SOURCE: <input checked="" type="checkbox"/> GPS (Type): TRIMBLE <input type="checkbox"/> USGS Quad Map <input type="checkbox"/> Other	

SECTION B - FLOOD INSURANCE RATE MAP (FIRM) INFORMATION

B1. FIRM COMMUNITY NAME & COMMUNITY NUMBER YAVAPAI COUNTY 040093		B2. COUNTY NAME YAVAPAI	B3. STATE AZ
B4. MAP AND PANEL NUMBER 04025C1470	B5. SUFFIX F	B6. FIRM INDEX DATE June 6, 2001	B7. FIRM PANEL EFFECTIVE/REVISED DATE June 6, 2001
B8. FLOOD ZONE(S) 4x		B9. BASE FLOOD ELEVATION(S) (Zone A0, use depth of flooding) 4092.50	

B10. Indicate the source of the Base Flood Elevation (BFE) data or base flood depth entered in B9.
 FIS Profile FIRM Community Determined Other (Describe): **Engineering Study For FIRECLIFF**

B11. Indicate the elevation datum used for the BFE in B9: NGVD 1929 NAVD 1988 Other (Describe):

B12. Is the building located in a Coastal Barrier Resources System (CBRS) area or Otherwise Protected Area (OPA)? Yes No Designation Date

SECTION C - BUILDING ELEVATION INFORMATION (SURVEY REQUIRED)

C1. Building elevations are based on: Construction Drawings* Building Under Construction* Finished Construction
 *A new Elevation Certificate will be required when construction of the building is complete.

C2. Building Diagram Number (Select the building diagram most similar to the building for which this certificate is being completed - see pages 6 and 7. If no diagram accurately represents the building, provide a sketch or photograph.)

C3. Elevations - Zones A1-A30, AE, AH, A (with BFE), VE, V1-V30, V (with BFE), AR, ARIA, AR/AE, ARIA1-A30, ARIA/H, AR/AO
 Complete items C3-a-i below according to the building diagram specified in item C2. State the datum used. If the datum is different from the datum used for the BFE in Section B, convert the datum to that used for the BFE. Show field measurements and datum conversion calculation. Use the space provided or the Comments area of Section D or Section G, as appropriate, to document the datum conversion.
 Datum _____ Conversion/Comments _____

Elevation reference mark used: Does the elevation reference mark used appear on the FIRM? Yes No

- o a) Top of bottom floor (including basement or enclosure) **4092.75 ft (m)**
- o b) Top of next higher floor **N/A ft (m)**
- o c) Bottom of lowest horizontal structural member (V zones only) **N/A ft (m)**
- o d) Attached garage (top of slab) **N/A ft (m)**
- o e) Lowest elevation of machinery and/or equipment servicing the building (Describe in a Comments area)
- o f) Lowest adjacent (finished) grade (LAG) **4092.50 ft (m)**
- o g) Highest adjacent (finished) grade (HAG) **4092.50 ft (m)**
- o h) No. of permanent openings (flood vents) within 1 ft. above adjacent grade
- o i) Total area of all permanent openings (flood vents) in C3.h _____ sq. in. (sq. cm)

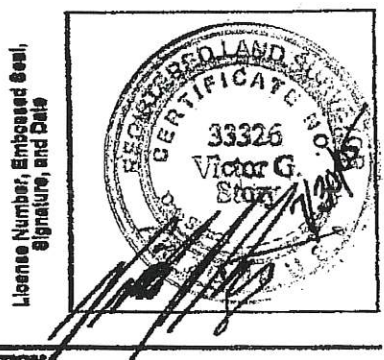

SECTION D - SURVEYOR, ENGINEER, OR ARCHITECT CERTIFICATION

This certification is to be signed and sealed by a land surveyor, engineer, or architect authorized by law to certify elevation information.
 I certify that the information in Sections A, B, and C on this certificate represents my best efforts to interpret the data available.
 I understand that any false statement may be punishable by fine or imprisonment under 18 U.S. Code, Section 1001.

CERTIFIER'S NAME VICTOR G STORY	LICENSE NUMBER 33326
TITLE LAND SURVEYOR	COMPANY NAME PACIFIC GREENS INC
ADDRESS 10348 E BECKER LANE	CITY SCOTTSDALE
SIGNATURE	STATE AZ
	ZIP CODE 85260
	TELEPHONE 480-905-8743

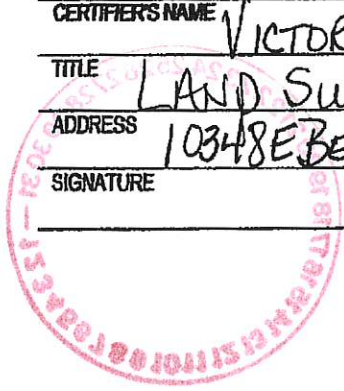

*OK
5/1/11*