

SECTION A – PROPERTY INFORMATION

FOR INSURANCE COMPANY USE
 Policy Number:
 Community NAIC Number:

A1. Building Owner's Name **MCCRACKEN, GERALD L.**
 A2. Building Street Address (including Apt., Unit, Suite, and/or Bldg. No.) or P.O. Route and Box No.
3690 E EL PASO DRIVE
 City **COTTONWOOD** State **AZ** ZIP Code **86326**

A3. Property Description (Lot and Block Numbers, Tax Parcel Number, Legal Description, etc.)
 TPN: 406-47-227, LOT 2070, VERDE VILLAGE UNIT 5, DEED BOOK 2581, PAGE 205, YCR

A4. Building Use (e.g., Residential, Non-Residential, Addition, Accessory, etc.) **RESIDENTIAL**
 A5. Latitude/Longitude: Lat. **34°42'33.3"N** Long. **111°59'11.5"W** Horizontal Datum: NAD 1927 NAD 1983
 A6. Attach at least 2 photographs of the building if the Certificate is being used to obtain flood insurance.
 A7. Building Diagram Number **5**
 A8. For a building with a crawlspace or enclosure(s):
 a) Square footage of crawlspace or enclosure(s) **1548** sq ft
 b) Number of permanent flood openings in the crawlspace or enclosure(s) within 1.0 foot above adjacent grade **0**
 c) Total net area of flood openings in A8.b **0** sq in
 d) Engineered flood openings? Yes No
 A9. For a building with an attached garage:
 a) Square footage of attached garage **420** sq ft
 b) Number of permanent flood openings in the attached garage within 1.0 foot above adjacent grade **0**
 c) Total net area of flood openings in A9.b **0** sq in
 d) Engineered flood openings? Yes No

SECTION B – FLOOD INSURANCE RATE MAP (FIRM) INFORMATION

B1. NFIP Community Name & Community Number YAVAPAI CO. UNINCORPORATED 040093		B2. County Name YAVAPAI COUNTY		B3. State AZ	
B4. Map/Panel Number 04025C1778	B5. Suffix H	B6. FIRM Index Date 10/16/2015	B7. FIRM Panel Effective/Revised Date 10/16/2015	B8. Flood Zone(s) AE	B9. Base Flood Elevation(s) (Zone AO, use base flood depth) 3256.8

B10. Indicate the source of the Base Flood Elevation (BFE) data or base flood depth entered in Item B9.
 FIS Profile FIRM Community Determined Other/Source: _____
 B11. Indicate elevation datum used for BFE in Item B9: NGVD 1929 NAVD 1988 Other/Source: _____
 B12. Is the building located in a Coastal Barrier Resources System (CBRS) area or Otherwise Protected Area (OPA)? Yes No
 Designation Date: _____ CBRS OPA

SECTION C – BUILDING ELEVATION INFORMATION (SURVEY REQUIRED)

C1. Building elevations are based on: Construction Drawings* Building Under Construction* Finished Construction
 *A new Elevation Certificate will be required when construction of the building is complete.
 C2. Elevations – Zones A1–A30, AE, AH, A (with BFE), VE, V1–V30, V (with BFE), AR, AR/A, AR/AE, AR/A1–A30, AR/AH, AR/AO. Complete Items C2.a–h below according to the building diagram specified in Item A7. In Puerto Rico only, enter meters.
 Benchmark Utilized: **RM 270 OLD FIRM CONVERTED** Vertical Datum: **NAD88**
 Indicate elevation datum used for the elevations in items a) through h) below. NGVD 1929 NAVD 1988 Other/Source: _____
 Datum used for building elevations must be the same as that used for the BFE.
 Check the measurement used.

a) Top of bottom floor (including basement, crawlspace, or enclosure floor)	<u>3252.3</u>	<input checked="" type="checkbox"/> feet	<input type="checkbox"/> meters
b) Top of the next higher floor	<u>3255.4</u>	<input checked="" type="checkbox"/> feet	<input type="checkbox"/> meters
c) Bottom of the lowest horizontal structural member (V Zones only)	<u>N/A</u>	<input type="checkbox"/> feet	<input type="checkbox"/> meters
d) Attached garage (top of slab)	<u>3252.3</u>	<input checked="" type="checkbox"/> feet	<input type="checkbox"/> meters
e) Lowest elevation of machinery or equipment servicing the building (Describe type of equipment and location in Comments)	<u>3255.4</u>	<input checked="" type="checkbox"/> feet	<input type="checkbox"/> meters
f) Lowest adjacent (finished) grade next to building (LAG)	<u>3250.6</u>	<input checked="" type="checkbox"/> feet	<input type="checkbox"/> meters
g) Highest adjacent (finished) grade next to building (HAG)	<u>3251.5</u>	<input checked="" type="checkbox"/> feet	<input type="checkbox"/> meters
h) Lowest adjacent grade at lowest elevation of deck or stairs, including structural support	<u>3250.5</u>	<input checked="" type="checkbox"/> feet	<input type="checkbox"/> meters

SECTION D – SURVEYOR, ENGINEER, OR ARCHITECT CERTIFICATION

This certification is to be signed and sealed by a land surveyor, engineer, or architect authorized by law to certify elevation information. I certify that the information on this Certificate represents my best efforts to interpret the data available. I understand that any false statement may be punishable by fine or imprisonment under 18 U.S. Code, Section 1001.
 Check here if comments are provided on back of form. Were latitude and longitude in Section A provided by a licensed land surveyor? Yes No
 Check here if attachments.

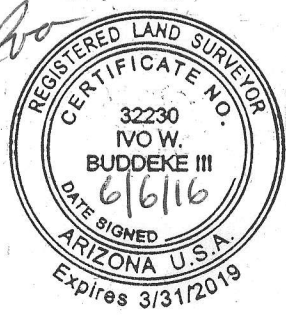

Certifier's Name **IVO W. BUDDEKE III** License Number **32230**
 Title **OWNER** Company Name **RIMROCK LAND SURVEYS**
 Address **5280 BENTLEY DRIVE** City **RIMROCK** State **AZ** ZIP Code **86335**
 Signature *Ivo W. Buddeke III* Date **rev 6/6/2016** Telephone **928-567-1414**

Building Photographs

See Instructions for Item A6.

IMPORTANT: In these spaces, copy the corresponding information from Section A.

FOR INSURANCE COMPANY USE

Building Street Address (including Apt., Unit, Suite, and/or Bldg. No.) or P.O. Route and Box No.
3690 E EL PASO DRIVE

Policy Number:

City COTTONWOOD

State AZ

ZIP Code 86326

Company NAIC Number:

If using the Elevation Certificate to obtain NFIP flood insurance, affix at least 2 building photographs below according to the instructions for Item A6. Identify all photographs with date taken; "Front View" and "Rear View"; and, if required, "Right Side View" and "Left Side View." When applicable, photographs must show the foundation with representative examples of the flood openings or vents, as indicated in Section A8. If submitting more photographs than will fit on this page, use the Continuation Page.



SE FACE



NORTH FACE

Building Photographs

Continuation Page

IMPORTANT: In these spaces, copy the corresponding information from Section A.

FOR INSURANCE COMPANY USE

Building Street Address (including Apt., Unit, Suite, and/or Bldg. No.) or P.O. Route and Box No.
3690 E EL PASO DRIVE

Policy Number:

City COTTONWOOD

State AZ

ZIP Code 86326

Company NAIC Number:

If submitting more photographs than will fit on the preceding page, affix the additional photographs below. Identify all photographs with: date taken; "Front View" and "Rear View"; and, if required, "Right Side View" and "Left Side View." When applicable, photographs must show the foundation with representative examples of the flood openings or vents, as indicated in Section A8.



NE FACE



NW FACE



EAST FACE

ELEVATION CERTIFICATE

FEDERAL EMERGENCY MANAGEMENT AGENCY NATIONAL FLOOD INSURANCE PROGRAM

O.M.B. No 3067-0077
Expires May 31, 1993

ATTENTION: Use of this certificate does not provide a waiver of the flood insurance purchase requirement. This form is used only to provide elevation information necessary to ensure compliance with applicable community floodplain management ordinances, to determine the proper insurance premium rate, and/or to support a request for a Letter of Map Amendment or Revision (LOMA or LOMR). Instructions for completing this form can be found on the following pages.

SECTION A PROPERTY INFORMATION	FOR INSURANCE COMPANY USE
BUILDING OWNER'S NAME <u>Becky McCracken</u>	POLICY NUMBER
STREET ADDRESS (Including Apt., Unit, Suite and/or Bldg. Number) OR P.O. ROUTE AND BOX NUMBER <u>130 Castle Rock Rd</u>	COMPANY NAIC NUMBER
OTHER DESCRIPTION (Lot and Block Numbers, etc.) <u>Tax Parcel 406-47-227 Lot 20 Verd Village</u>	
CITY <u>Sedona</u>	STATE <u>AZ</u>
	ZIP CODE <u>86336</u>

SECTION B FLOOD INSURANCE RATE MAP (FIRM) INFORMATION

Provide the following from the proper FIRM (See Instructions):

1. COMMUNITY NUMBER	2. PANEL NUMBER	3. SUFFIX	4. DATE OF FIRM INDEX	5. FIRM ZONE	6. BASE FLOOD ELEVATION (in AO Zones, use depth)
<u>040093</u>	<u>865</u>	<u>B</u>	<u>8/19/85</u>	<u>A12</u>	<u>3251.2</u>

7. Indicate the elevation datum system used on the FIRM for Base Flood Elevations (BFE): NGVD '29 Other (describe on back)
8. For Zones A or V, where no BFE is provided on the FIRM, and the community has established a BFE for this building site, indicate the community's BFE: feet NGVD (or other FIRM datum—see Section B, Item 7).

SECTION C BUILDING ELEVATION INFORMATION

- Using the Elevation Certificate Instructions, indicate the diagram number from the diagrams found on Pages 5 and 6 that best describes the subject building's reference level 7.
- FIRM Zones A1-A30, AE, AH, and A (with BFE). The top of the reference level floor from the selected diagram is at an elevation of 13252.4 feet NGVD (or other FIRM datum—see Section B, Item 7).
 - FIRM Zones V1-V30, VE, and V (with BFE). The bottom of the lowest horizontal structural member of the reference level from the selected diagram, is at an elevation of feet NGVD (or other FIRM datum—see Section B, Item 7).
 - FIRM Zone A (without BFE). The floor used as the reference level from the selected diagram is feet above or below (check one) the highest grade adjacent to the building.
 - FIRM Zone AO. The floor used as the reference level from the selected diagram is feet above or below (check one) the highest grade adjacent to the building. If no flood depth number is available, is the building's lowest floor (reference level) elevated in accordance with the community's floodplain management ordinance? Yes No Unknown
- Indicate the elevation datum system used in determining the above reference level elevations: NGVD '29 Other (describe under Comments on Page 2). (NOTE: If the elevation datum used in measuring the elevations is different than that used on the FIRM [see Section B, Item 7], then convert the elevations to the datum system used on the FIRM and show the conversion equation under Comments on Page 2.)
- Elevation reference mark used appears on FIRM: Yes No (See Instructions on Page 4)
- The reference level elevation is based on: actual construction construction drawings
(NOTE: Use of construction drawings is only valid if the building does not yet have the reference level floor in place, in which case this certificate will only be valid for the building during the course of construction. A post-construction Elevation Certificate will be required once construction is complete.)
- The elevation of the lowest grade immediately adjacent to the building is: feet NGVD (or other FIRM datum—see Section B, Item 7).

SECTION D COMMUNITY INFORMATION

- If the community official responsible for verifying building elevations specifies that the reference level indicated in Section C, Item 1 is not the "lowest floor" as defined in the community's floodplain management ordinance, the elevation of the building's "lowest floor" as defined by the ordinance is: feet NGVD (or other FIRM datum—see Section B, Item 7).
- Date of the start of construction or substantial improvement 6-3-92.

SECTION E CERTIFICATION

This certification is to be signed by a land surveyor, engineer, or architect who is authorized by state or local law to certify elevation information when the elevation information for Zones A1-A30, AE, AH, A (with BFE), V1-V30, VE, and V (with BFE) is required. Community officials who are authorized by local law or ordinance to provide floodplain management information, may also sign the certification. In the case of Zones AO and A (without a FEMA or community issued BFE), a building official, a property owner, or an owner's representative may also sign the certification.

Reference level diagrams 6, 7 and 8 - Distinguishing Features-If the certifier is unable to certify to breakaway/non-breakaway wall, enclosure size, location of servicing equipment, area use, wall openings, or unfinished area Feature(s), then list the Feature(s) not included in the certification under Comments below. The diagram number, Section C, Item 1, must still be entered.

I certify that the information in Sections B and C on this certificate represents my best efforts to interpret the data available. I understand that any false statement may be punishable by fine or imprisonment under 18 U.S. Code, Section 1001.

16921

CERTIFIER'S NAME James Wise, P.E. LICENSE NUMBER (or Affix Seal) 16921

TITLE Floodplain Administrator/Director of Public Works COMPANY NAME _____

ADDRESS 255 E. Gurley St. CITY Prescott STATE AZ ZIP 86301

SIGNATURE James R. Wise DATE 9/13/93 PHONE (602) 771-3196

Copies should be made of this Certificate for: 1) community official, 2) insurance agent/company, and 3) building owner.

COMMENTS: Reference level top of stem wall, not lowest floor

