

FEDERAL EMERGENCY MANAGEMENT AGENCY
 NATIONAL FLOOD INSURANCE PROGRAM
ELEVATION CERTIFICATE

O.M.B. No. 3067-0077
 Expires July 31, 2002

Important: Read the instructions on pages 1 - 7.

SECTION A - PROPERTY OWNER INFORMATION		For Insurance Company Use:
BUILDING OWNER'S NAME STEVE & MARILYN MAIER		Policy Number
BUILDING STREET ADDRESS (Including Apt., Unit, Suite, and/or Bldg. No.) OR P.O. ROUTE AND BOX NO. 3756 EL PASO DR		Company NAIC Number
CITY COTTONWOOD	STATE AZ	ZIP CODE 86326
PROPERTY DESCRIPTION (Lot and Block Numbers, Tax Parcel Number, Legal Description, etc.) LOTS 2072 & 2073 VERDE VILLAGE # 5 406-47-229A		
BUILDING USE (e.g., Residential, Non-residential, Addition, Accessory, etc. Use a Comments area, if necessary.) RESIDENTIAL (GARAGE/STUDIO)		
LATITUDE/LONGITUDE (OPTIONAL) HORIZONTAL DATUM: SOURCE: <input type="checkbox"/> GPS (Type): (##° - ##' - ###.###" or ###.#####") <input type="checkbox"/> NAD 1927 <input type="checkbox"/> NAD 1983 <input type="checkbox"/> USGS Quad Map <input type="checkbox"/> Other: _____		

SECTION B - FLOOD INSURANCE RATE MAP (FIRM) INFORMATION

B1. NFIP COMMUNITY NAME & COMMUNITY NUMBER YAVAPAI COUNTY 040093		B2. COUNTY NAME YAVAPAI	B3. STATE AZ
B4. MAP AND PANEL NUMBER 04025C1805	B5. SUFFIX F	B6. FIRM INDEX DATE JUNE 6 2001	B7. FIRM PANEL EFFECTIVE/REVISED DATE JUNE 6 2001
B8. FLOOD ZONE(S) AE		B9. BASE FLOOD ELEVATION(S) (Zone AO, use depth of flooding) 3251.6	

B10. Indicate the source of the Base Flood Elevation (BFE) data or base flood depth entered in B9.
 FIS Profile FIRM Community Determined Other (Describe): _____

B11. Indicate the elevation datum used for the BFE in B9: NGVD 1929 NAVD 1988 Other (Describe): _____

B12. Is the building located in a Coastal Barrier Resources System (CBRS) area or Otherwise Protected Area (OPA)? Yes No
 Designation Date: _____

SECTION C - BUILDING ELEVATION INFORMATION (SURVEY REQUIRED)

C1. Building elevations are based on: Construction Drawings* Building Under Construction* Finished Construction
 *A new Elevation Certificate will be required when construction of the building is complete.

C2. Building Diagram Number 1 (Select the building diagram most similar to the building for which this certificate is being completed - see pages 6 and 7. If no diagram accurately represents the building, provide a sketch or photograph.)

C3. Elevations - Zones A1-A30, AE, AH, A (with BFE), VE, V1-V30, V (with BFE), AR, AR/A, AR/AE, AR/A1-A30, AR/AH, AR/AO
 Complete items C3.a-i below according to the building diagram specified in Item C2. State the datum used. If the datum is different from the datum used for the BFE in Section B, convert the datum to that used for the BFE. Show field measurements and datum conversion calculation. Use the space provided or the Comments area of Section D or Section G, as appropriate, to document the datum conversion.

Datum NGVD 1929 Conversion/Comments _____
 Elevation reference mark used RM 270 Does the elevation reference mark used appear on the FIRM? Yes No

<input type="checkbox"/> a) Top of bottom floor (including basement or enclosure)	<u>3248</u>	<u>13</u>	ft.(m)
<input type="checkbox"/> b) Top of next higher floor	<u>3257</u>	<u>67</u>	ft.(m)
<input type="checkbox"/> c) Bottom of lowest horizontal structural member (V zones only)	<u>3256</u>	<u>7</u>	ft.(m)
<input type="checkbox"/> d) Attached garage (top of slab)	_____	_____	ft.(m)
<input type="checkbox"/> e) Lowest elevation of machinery and/or equipment servicing the building (Describe in a Comments area.)	<u>3248</u>	<u>0</u>	ft.(m)
<input type="checkbox"/> f) Lowest adjacent (finished) grade (LAG)	<u>3248</u>	<u>0</u>	ft.(m)
<input type="checkbox"/> g) Highest adjacent (finished) grade (HAG)	<u>3248</u>	<u>1</u>	ft.(m)
<input type="checkbox"/> h) No. of permanent openings (flood vents) within 1 ft. above adjacent grade	<u>6</u>		
<input type="checkbox"/> i) Total area of all permanent openings (flood vents) in C3.h	<u>768</u> sq. in. (sq. cm)		

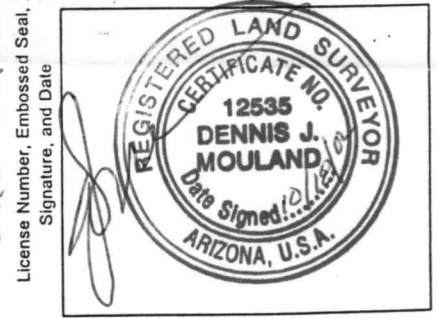

SECTION D - SURVEYOR, ENGINEER, OR ARCHITECT CERTIFICATION

This certification is to be signed and sealed by a land surveyor, engineer, or architect authorized by law to certify elevation information.
 I certify that the information in Sections A, B, and C on this certificate represents my best efforts to interpret the data available.
 I understand that any false statement may be punishable by fine or imprisonment under 18 U.S. Code, Section 1001.

CERTIFIER'S NAME **DENNIS J. MOULAND** LICENSE NUMBER **LS 12535**

TITLE **LAND SURVEYOR** COMPANY NAME **CADASTRAL**

ADDRESS **PO BOX 2938** CITY **COTTONWOOD** STATE **AZ** ZIP CODE **86326**

SIGNATURE *[Signature]* DATE **10/18/02** TELEPHONE **928-649-5911**

IMPORTANT: In these spaces, copy the corresponding information from Section A.			For Insurance Company Use:
BUILDING STREET ADDRESS (Including Apt., Unit, Suite, and/or Bldg. No.) OR P.O. ROUTE AND BOX NO.			Policy Number
CITY	STATE	ZIP CODE	Company NAIC Number

SECTION D - SURVEYOR, ENGINEER, OR ARCHITECT CERTIFICATION (CONTINUED)

Copy both sides of this Elevation Certificate for (1) community official, (2) insurance agent/company, and (3) building owner.

COMMENTS

Check here if attachments

SECTION E - BUILDING ELEVATION INFORMATION (SURVEY NOT REQUIRED) FOR ZONE AO AND ZONE A (WITHOUT BFE)

For Zone AO and Zone A (without BFE), complete Items E1. through E4. If the Elevation Certificate is intended for use as supporting information for a LOMA or LOMR-F, Section C must be completed.

- E1. Building Diagram Number _____ (Select the building diagram most similar to the building for which this certificate is being completed – see pages 6 and 7. If no diagram accurately represents the building, provide a sketch or photograph.)
- E2. The top of the bottom floor (including basement or enclosure) of the building is _____ ft.(m) _____ in.(cm) _____ above or _____ below (check one) the highest adjacent grade. (Use natural grade, if available.)
- E3. For Building Diagrams 6-8 with openings (see page 7), the next higher floor or elevated floor (elevation b) of the building is _____ ft.(m) _____ in.(cm) above the highest adjacent grade. Complete Items C3.h and C3.i on front of form.
- E4. For Zone AO only: If no flood depth number is available, is the top of the bottom floor elevated in accordance with the community's floodplain management ordinance? Yes No Unknown. The local official must certify this information in Section G.

SECTION F - PROPERTY OWNER (OR OWNER'S REPRESENTATIVE) CERTIFICATION

The property owner or owner's authorized representative who completes Sections A, B, C (Items C3.h and C3.i only), and E for Zone A (without a FEMA-issued or community-issued BFE) or Zone AO must sign here. *The statements in Sections A, B, C, and E are correct to the best of my knowledge.*

PROPERTY OWNER'S OR OWNER'S AUTHORIZED REPRESENTATIVE'S NAME

ADDRESS: 3756 EL PASO CITY: PLAZA STATE: TX ZIP CODE: 76001
 SIGNATURE: [Signature] DATE: Oct 26 TELEPHONE: _____
 COMMENTS: _____

Check here if attachments

SECTION G - COMMUNITY INFORMATION (OPTIONAL)

The local official who is authorized by law or ordinance to administer the community's floodplain management ordinance can complete Sections A, B, C (or E), and G of this Elevation Certificate. Complete the applicable item(s) and sign below.

- G1. The information in Section C was taken from other documentation that has been signed and embossed by a licensed surveyor, engineer, or architect who is authorized by state or local law to certify elevation information. (Indicate the source and date of the elevation data in the Comments area below.)
- G2. A community official completed Section E for a building located in Zone A (without a FEMA-issued or community-issued BFE) or Zone AO.
- G3. The following information (Items G4-G9) is provided for community floodplain management purposes.

G4. PERMIT NUMBER	G5. DATE PERMIT ISSUED	G6. DATE CERTIFICATE OF COMPLIANCE/OCCUPANCY ISSUED
-------------------	------------------------	---

G7. This permit has been issued for: New Construction Substantial Improvement

G8. Elevation of as-built lowest floor (including basement) of the building is: _____ ft.(m) Datum: _____

G9. BFE or (in Zone AO) depth of flooding at the building site is: _____ ft.(m) Datum: _____

LOCAL OFFICIAL'S NAME _____ TITLE _____

COMMUNITY NAME _____ TELEPHONE _____

SIGNATURE _____ DATE _____

COMMENTS _____

Check here if attachments

ELEVATION CERTIFICATE

FEDERAL EMERGENCY MANAGEMENT AGENCY NATIONAL FLOOD INSURANCE PROGRAM

O.M.B. No 3067-0077
Expires May 31, 1993

ATTENTION: Use of this certificate does not provide a waiver of the flood insurance purchase requirement. This form is used only to provide elevation information necessary to ensure compliance with applicable community floodplain management ordinances, to determine the proper insurance premium rate, and/or to support a request for a Letter of Map Amendment or Revision (LOMA or LOMR). Instructions for completing this form can be found on the following pages.

SECTION A PROPERTY INFORMATION	FOR INSURANCE COMPANY USE
BUILDING OWNER'S NAME <u>Stephen Maier</u>	CY NUMBER
STREET ADDRESS (Including Apt., Unit, Suite and/or Bldg. Number) OR P.O. ROUTE AND BOX NUMBER <u>3756 El Paso Dr. East / 510 Humphreys / Flag 86001</u>	COMPANY NAIC NUMBER
OTHER DESCRIPTION (Lot and Block Numbers, etc.) <u>Tax Parcel 406-47-230 / 2073ht Verde Village #5</u>	
CITY <u>Cottonwood</u>	STATE <u>AZ</u>
	ZIP CODE <u>86326</u>

SECTION B FLOOD INSURANCE RATE MAP (FIRM) INFORMATION

Provide the following from the proper FIRM (See Instructions):

1. COMMUNITY NUMBER	2. PANEL NUMBER	3. SUFFIX	4. DATE OF FIRM INDEX	5. FIRM ZONE	6. BASE FLOOD ELEVATION (in AO Zones, use depth)
<u>040093</u>	<u>865</u>	<u>B</u>	<u>8/19/85</u>	<u>A12</u>	<u>3250.3</u>

7. Indicate the elevation datum system used on the FIRM for Base Flood Elevations (BFE): NGVD '29 Other (describe on back)
8. For Zones A or V, where no BFE is provided on the FIRM, and the community has established a BFE for this building site, indicate the community's BFE: feet NGVD (or other FIRM datum—see Section B, Item 7).

SECTION C BUILDING ELEVATION INFORMATION

1. Using the Elevation Certificate Instructions, indicate the diagram number from the diagrams found on Pages 5 and 6 that best describes the subject building's reference level _____.
- 2(a). FIRM Zones A1-A30, AE, AH, and A (with BFE). The top of the reference level floor from the selected diagram is at an elevation of 13251.3 feet NGVD (or other FIRM datum—see Section B, Item 7).
- (b). FIRM Zones V1-V30, VE, and V (with BFE). The bottom of the lowest horizontal structural member of the reference level from the selected diagram, is at an elevation of feet NGVD (or other FIRM datum—see Section B, Item 7).
- (c). FIRM Zone A (without BFE). The floor used as the reference level from the selected diagram is feet above or below (check one) the highest grade adjacent to the building.
- (d). FIRM Zone AO. The floor used as the reference level from the selected diagram is feet above or below (check one) the highest grade adjacent to the building. If no flood depth number is available, is the building's lowest floor (reference level) elevated in accordance with the community's floodplain management ordinance? Yes No Unknown
3. Indicate the elevation datum system used in determining the above reference level elevations: NGVD '29 Other (describe under Comments on Page 2). (NOTE: If the elevation datum used in measuring the elevations is different than that used on the FIRM [see Section B, Item 7], then convert the elevations to the datum system used on the FIRM and show the conversion equation under Comments on Page 2.)
4. Elevation reference mark used appears on FIRM: Yes No (See Instructions on Page 4)
5. The reference level elevation is based on: actual construction construction drawings
(NOTE: Use of construction drawings is only valid if the building does not yet have the reference level floor in place, in which case this certificate will only be valid for the building during the course of construction. A post-construction Elevation Certificate will be required once construction is complete.)
6. The elevation of the lowest grade immediately adjacent to the building is: 13247.2 feet NGVD (or other FIRM datum—see Section B, Item 7).

SECTION D COMMUNITY INFORMATION

1. If the community official responsible for verifying building elevations specifies that the reference level indicated in Section C, Item 1 is not the "lowest floor" as defined in the community's floodplain management ordinance, the elevation of the building's "lowest floor" as defined by the ordinance is: feet NGVD (or other FIRM datum—see Section B, Item 7).
2. Date of the start of construction or substantial improvement 4-9-87.

SECTION E CERTIFICATION

This certification is to be signed by a land surveyor, engineer, or architect who is authorized by state or local law to certify elevation information when the elevation information for Zones A1–A30, AE, AH, A (with BFE), V1–V30, VE, and V (with BFE) is required. Community officials who are authorized by local law or ordinance to provide floodplain management information, may also sign the certification. In the case of Zones AO and A (without a FEMA or community issued BFE), a building official, a property owner, or an owner's representative may also sign the certification.

Reference level diagrams 6, 7 and 8 - Distinguishing Features—If the certifier is unable to certify to breakaway/non-breakaway wall, enclosure size, location of servicing equipment, area use, wall openings, or unfinished area Feature(s), then list the Feature(s) not included in the certification under Comments below. The diagram number, Section C, Item 1, must still be entered.

I certify that the information in Sections B and C on this certificate represents my best efforts to interpret the data available. I understand that any false statement may be punishable by fine or imprisonment under 18 U.S. Code, Section 1001.

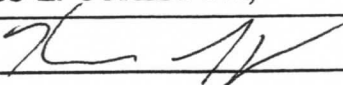
CERTIFIER'S NAME KENNETH E. SPEDDING	LICENSE NUMBER (or Affix Seal)
TITLE DISTRICT DIRECTOR	COMPANY NAME YAVAPAI COUNTY FLOOD CONTROL DISTRICT
ADDRESS 255 E. GURLEY ST.,	CITY PRESCOTT
	STATE AZ ZIP 86301
SIGNATURE 	DATE 3/8/95 PHONE (602) 771-3196

Copies should be made of this Certificate for: 1) community official, 2) insurance agent/company, and 3) building owner.

COMMENTS: _____

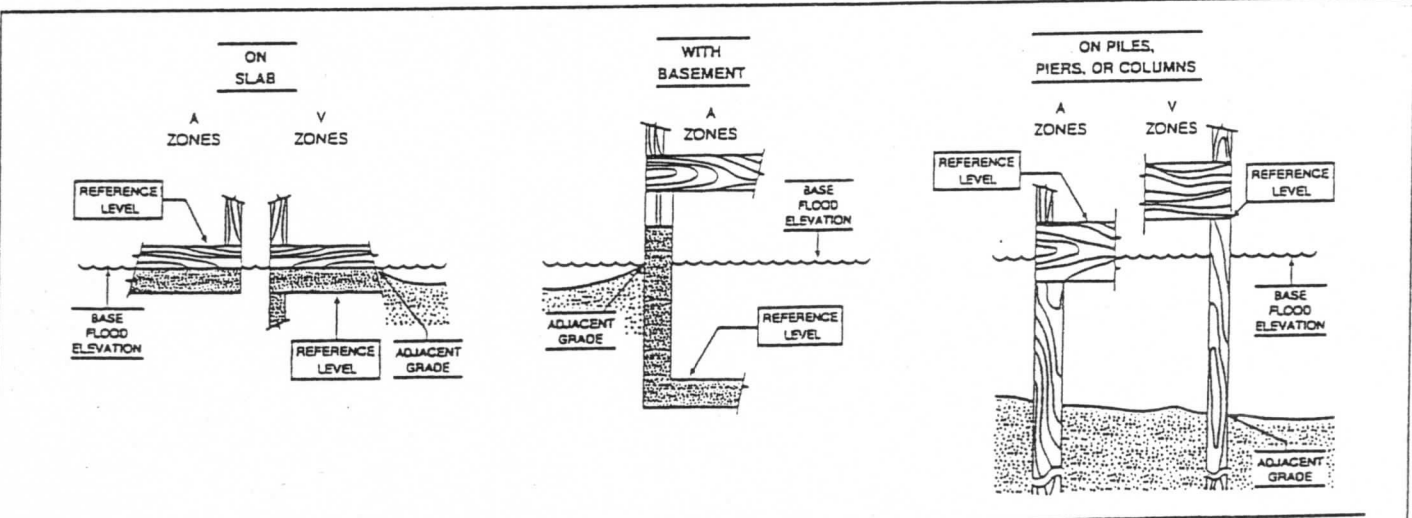

The diagrams above illustrate the points at which the elevations should be measured in A Zones and V Zones. Elevations for all A Zones should be measured at the top of the reference level floor. Elevations for all V Zones should be measured at the bottom of the lowest horizontal structural member.