

ELEVATION CERTIFICATE

OMB No. 1660-0008
Expires February 28, 2009

Important: Read the instructions on pages 1-8.

SECTION A - PROPERTY INFORMATION		For Insurance Company Use:
A1. Building Owner's Name Gordon & Diana Van Moorlehem		Policy Number
A2. Building Street Address (including Apt., Unit, Suite, and/or Bldg. No.) or P.O. Route and Box No. 5053 E. Comanche Dr.		Company NAIC Number
City Cottonwood	State AZ	ZIP Code 86326
A3. Property Description (Lot and Block Numbers, Tax Parcel Number, Legal Description, etc.) 406-47-461C		
A4. Building Use (e.g., Residential, Non-Residential, Addition, Accessory, etc.) Residential		
A5. Latitude/Longitude: Lat. 344205.9 Long. 1115819.12		Horizontal Datum: <input type="checkbox"/> NAD 1927 <input checked="" type="checkbox"/> NAD 1983
A6. Attach at least 2 photographs of the building if the Certificate is being used to obtain flood insurance.		
A7. Building Diagram Number 1		
A8. For a building with a crawl space or enclosure(s), provide:		A9. For a building with an attached garage, provide:
a) Square footage of crawl space or enclosure(s) N/A sq ft	a) Square footage of attached garage 480 sq ft	b) No. of permanent flood openings in the attached garage walls within 1.0 foot above adjacent grade _____
b) No. of permanent flood openings in the crawl space or enclosure(s) walls within 1.0 foot above adjacent grade 0	c) Total net area of flood openings in A9.b _____ sq in	
c) Total net area of flood openings in A8.b 0 sq in		

SECTION B - FLOOD INSURANCE RATE MAP (FIRM) INFORMATION

B1. NFIP Community Name & Community Number Yavapai County 040093		B2. County Name Yavapai		B3. State AZ	
B4. Map/Panel Number 04025C1805	B5. Suffix F	B6. FIRM Index Date June 6, 2001	B7. FIRM Panel Effective/Revised Date June 6, 2001	B8. Flood Zone(s) AE	B9. Base Flood Elevation(s) (Zone AO, use base flood depth) 3244.4 <i>SEE COMMENTS</i>
B10. Indicate the source of the Base Flood Elevation (BFE) data or base flood depth entered in Item B9. <input checked="" type="checkbox"/> FIS Profile <input type="checkbox"/> FIRM <input type="checkbox"/> Community Determined <input type="checkbox"/> Other (Describe) _____					
B11. Indicate elevation datum used for BFE in Item B9: <input checked="" type="checkbox"/> NGVD 1929 <input type="checkbox"/> NAVD 1988 <input type="checkbox"/> Other (Describe) _____					
B12. Is the building located in a Coastal Barrier Resources System (CBRS) area or Otherwise Protected Area (OPA)? <input type="checkbox"/> Yes <input checked="" type="checkbox"/> No Designation Date _____ <input type="checkbox"/> CBRS <input type="checkbox"/> OPA					

SECTION C - BUILDING ELEVATION INFORMATION (SURVEY REQUIRED)

C1. Building elevations are based on: Construction Drawings* Building Under Construction* Finished Construction
 *A new Elevation Certificate will be required when construction of the building is complete.

C2. Elevations - Zones A1-A30, AE, AH, A (with BFE), VE, V1-V30, V (with BFE), AR, AR/A, AR/AE, AR/A1-A30, AR/AH, AR/AO. Complete Items C2.a-g below according to the building diagram specified in Item A7.

Benchmark Utilized **RM 18-2 270** Vertical Datum **3250.16** **1929**

Conversion/Comments _____

	Check the measurement used.
a) Top of bottom floor (including basement, crawl space, or enclosure floor)	3237.12 <input checked="" type="checkbox"/> feet <input type="checkbox"/> meters (Puerto Rico only)
b) Top of the next higher floor	3246.40 <input checked="" type="checkbox"/> feet <input type="checkbox"/> meters (Puerto Rico only)
c) Bottom of the lowest horizontal structural member (V Zones only)	N/A <input type="checkbox"/> feet <input type="checkbox"/> meters (Puerto Rico only)
d) Attached garage (top of slab)	3237.05 <input checked="" type="checkbox"/> feet <input type="checkbox"/> meters (Puerto Rico only)
e) Lowest elevation of machinery or equipment servicing the building (Describe type of equipment in Comments)	3246.40 <input checked="" type="checkbox"/> feet <input type="checkbox"/> meters (Puerto Rico only)
f) Lowest adjacent (finished) grade (LAG) <i>SEE COMMENTS</i>	3236.33 <input checked="" type="checkbox"/> feet <input type="checkbox"/> meters (Puerto Rico only)
g) Highest adjacent (finished) grade (HAG)	3236.83 <input checked="" type="checkbox"/> feet <input type="checkbox"/> meters (Puerto Rico only)

SECTION D - SURVEYOR, ENGINEER, OR ARCHITECT CERTIFICATION

This certification is to be signed and sealed by a land surveyor, engineer, or architect authorized by law to certify elevation information. I certify that the information on this Certificate represents my best efforts to interpret the data available. I understand that any false statement may be punishable by fine or imprisonment under 18 U.S. Code, Section 1001.

Check here if comments are provided on back of form.

Certifier's Name Dugan McDonald		License Number RLS 26925	
Title President	Company Name Heritage Land Survey & Mapping, Inc.		
Address P.O. Box 3270	City Camp Verde	State AZ	ZIP Code 86322
Signature <i>[Signature]</i>	Date 07-02-08	Telephone 928-567-9170	

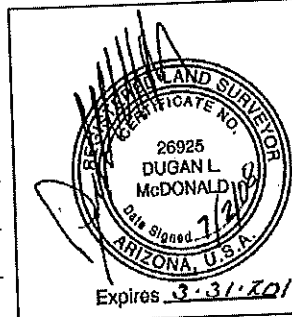

IMPORTANT: In these spaces, copy the corresponding information from Section A. Building Street Address (including Apt., Unit, Suite, and/or Bldg. No.) or P.O. Route and Box No.	For Insurance Company Use:	
	Policy Number	Company NAIC Number
City	State	ZIP Code

SECTION D - SURVEYOR, ENGINEER, OR ARCHITECT CERTIFICATION (CONTINUED)

Copy both sides of this Elevation Certificate for (1) community official, (2) insurance agent/company, and (3) building owner.

Comments: The lowest elevation of machinery and/or equipment serving the home is a hot water heater. The top of the next higher floor is a 2nd story at 3246.40

Signature: [Signature] Date: 07-02-08 Check here if attachments

SECTION E - BUILDING ELEVATION INFORMATION (SURVEY NOT REQUIRED) FOR ZONE AO AND ZONE A (WITHOUT BFE)

For Zones AO and A (without BFE), complete Items E1-E5. If the Certificate is intended to support a LOMA or LOMR-F request, complete Sections A, B, and C. For Items E1-E4, use natural grade, if available. Check the measurement used. In Puerto Rico only, enter meters.

- E1. Provide elevation information for the following and check the appropriate boxes to show whether the elevation is above or below the highest adjacent grade (HAG) and the lowest adjacent grade (LAG).
 - a) Top of bottom floor (including basement, crawl space, or enclosure) is _____ feet meters above or below the HAG.
 - b) Top of bottom floor (including basement, crawl space, or enclosure) is _____ feet meters above or below the LAG.
- E2. For Building Diagrams 6-8 with permanent flood openings provided in Section A Items 8 and/or 9 (see page 8 of instructions), the next higher floor (elevation C2.b in the diagrams) of the building is _____ feet meters above or below the HAG.
- E3. Attached garage (top of slab) is _____ feet meters above or below the HAG.
- E4. Top of platform of machinery and/or equipment servicing the building is _____ feet meters above or below the HAG.
- E5. Zone AO only: If no flood depth number is available, is the top of the bottom floor elevated in accordance with the community's floodplain management ordinance? Yes No Unknown. The local official must certify this information in Section G.

SECTION F - PROPERTY OWNER (OR OWNER'S REPRESENTATIVE) CERTIFICATION

The property owner or owner's authorized representative who completes Sections A, B, and E for Zone A (without a FEMA-issued or community-issued BFE) or Zone AO must sign here. *The statements in Sections A, B, and E are correct to the best of my knowledge.*

Property Owner's or Owner's Authorized Representative's Name _____

Address _____ City _____ State _____ ZIP Code _____

Signature _____ Date _____ Telephone _____

Comments _____ Check here if attachment

SECTION G - COMMUNITY INFORMATION (OPTIONAL)

The local official who is authorized by law or ordinance to administer the community's floodplain management ordinance can complete Sections A, B, C (or E), and G of this Elevation Certificate. Complete the applicable item(s) and sign below. Check the measurement used in Items G8. and G9.

- G1. The information in Section C was taken from other documentation that has been signed and sealed by a licensed surveyor, engineer, or architect who is authorized by law to certify elevation information. (Indicate the source and date of the elevation data in the Comments area below.)
- G2. A community official completed Section E for a building located in Zone A (without a FEMA-issued or community-issued BFE) or Zone AO.
- G3. The following information (Items G4.-G9.) is provided for community floodplain management purposes.

G4. Permit Number _____	G5. Date Permit Issued _____	G6. Date Certificate Of Compliance/Occupancy Issued _____
-------------------------	------------------------------	---

G7. This permit has been issued for: New Construction Substantial Improvement

G8. Elevation of as-built lowest floor (including basement) of the building: _____ feet meters (PR) Datum _____

G9. BFE or (in Zone AO) depth of flooding at the building site: _____ feet meters (PR) Datum _____

Local Official's Name: VICKIE RODDEN, CFM Title: HYDROLOGIST

Community Name: YAVAPAI COUNTY Telephone: 928-771-3197

Signature: [Signature] Date: 1-4-2017

Comments: THIS PARCEL/STRUCTURE IS IMPACTED BY VERDE RIVER REMAPPING, EFF. 10/16/17 MAP 0402561778H, WITH A REVISED BFE (B.9.) OF 3251.2 (NAVD 1988).

NOTE CONVERSION OF 2.4' OF ALL ELEVATIONS ON ELEVATION CERTIFICATE FROM NGVD 1929 TO NAVD 1988. Check here if attachment

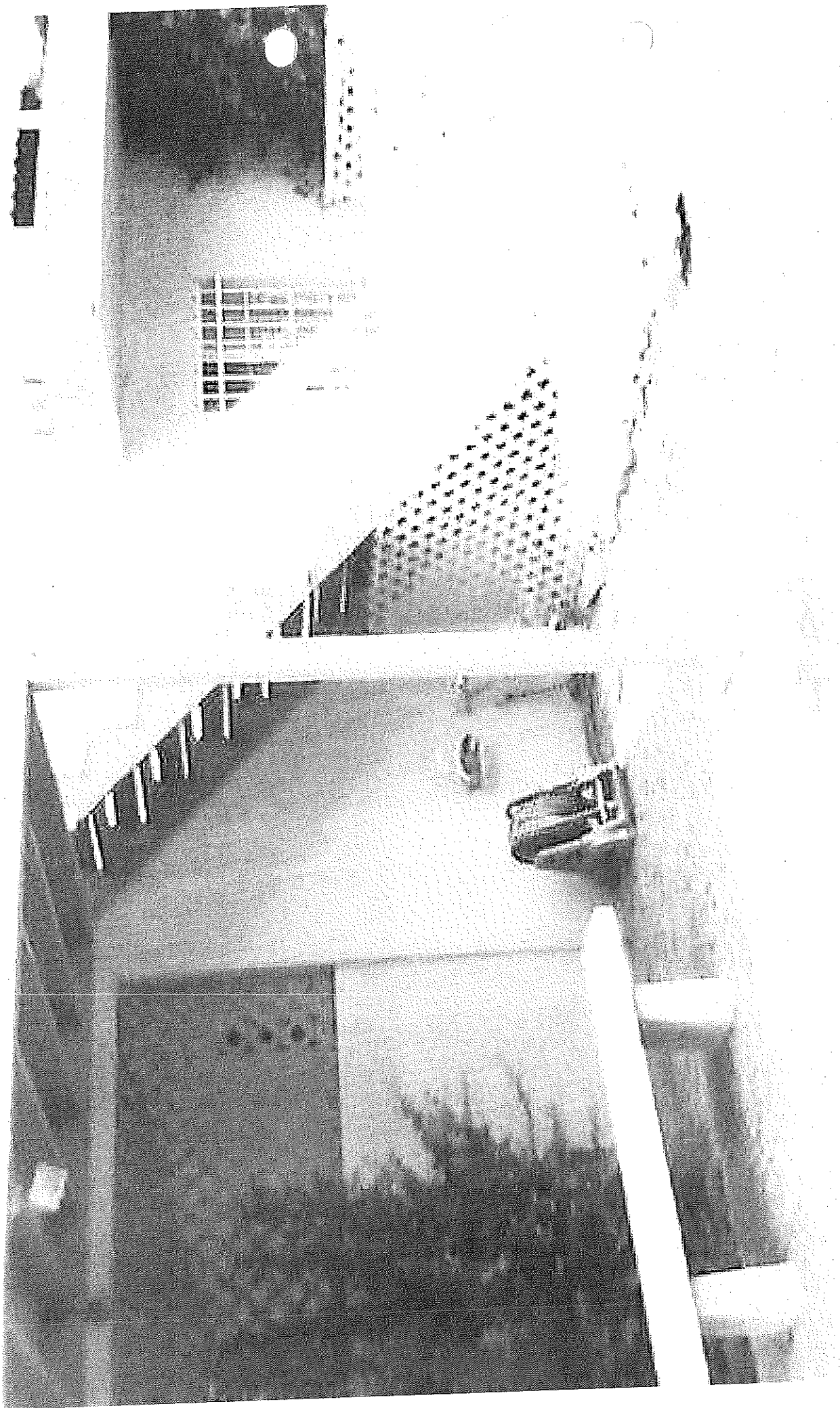

3244A

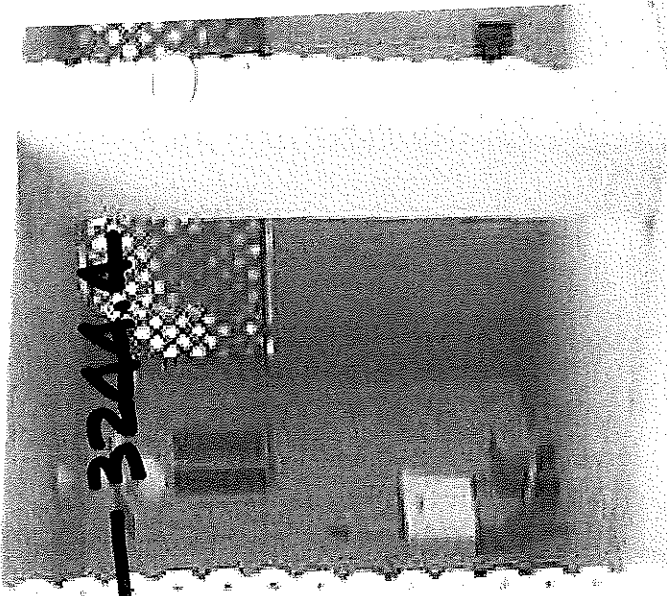

APPROX BFF →
LINE

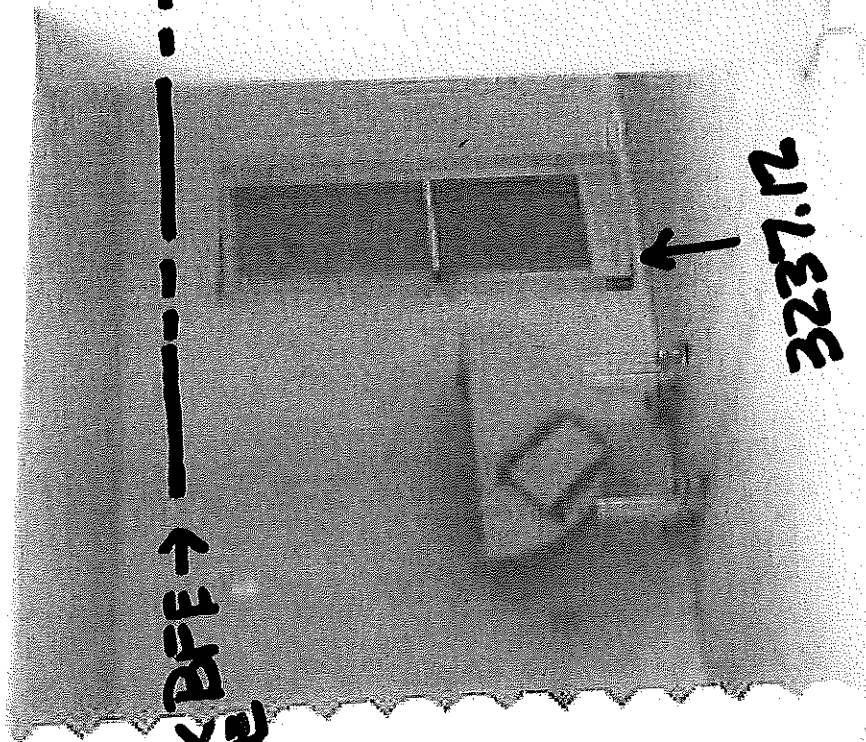

3237.12

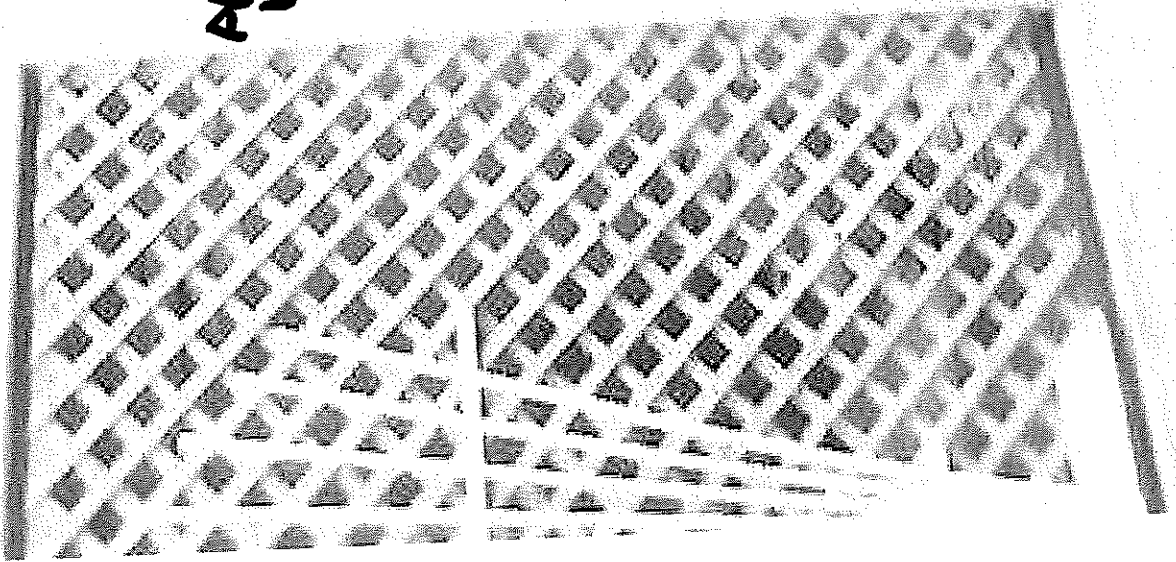







PLC DATE 4 JUNE 2008 406-47-461C



U.S. DEPARTMENT OF HOMELAND SECURITY
Federal Emergency Management Agency
National Flood Insurance Program

ELEVATION CERTIFICATE

OMB No. 1660-0008
Expires February 28, 2009

Important: Read the instructions on pages 1-8.

SECTION A - PROPERTY INFORMATION		For Insurance Company Use:	
A1. Building Owner's Name Gordon & Diana Van Moorlehem		Policy Number	
A2. Building Street Address (including Apt., Unit, Suite, and/or Bldg. No.) or P.O. Route and Box No. 5053 E. Comanche Dr.		Company NAIC Number	
City Camp Verde	State AZ	ZIP Code 86322	
A3. Property Description (Lot and Block Numbers, Tax Parcel Number, Legal Description, etc.) 406-47-461C			
A4. Building Use (e.g., Residential, Non-Residential, Addition, Accessory, etc.) Residential			
A5. Latitude/Longitude: Lat. 344205.9 Long. 1115819.2		Horizontal Datum: <input type="checkbox"/> NAD 1927 <input checked="" type="checkbox"/> NAD 1983	
A6. Attach at least 2 photographs of the building if the Certificate is being used to obtain flood insurance.			
A7. Building Diagram Number 1			
A8. For a building with a crawl space or enclosure(s), provide:		A9. For a building with an attached garage, provide:	
a) Square footage of crawl space or enclosure(s) 480 sq ft	a) Square footage of attached garage N/A sq ft		
b) No. of permanent flood openings in the crawl space or enclosure(s) walls within 1.0 foot above adjacent grade 0	b) No. of permanent flood openings in the attached garage walls within 1.0 foot above adjacent grade _____		
c) Total net area of flood openings in A8.b 0 sq ft	c) Total net area of flood openings in A9.b _____ sq ft		

SECTION B - FLOOD INSURANCE RATE MAP (FIRM) INFORMATION

B1. NFIP Community Name & Community Number YAVAPAI COUNTY 040093		B2. County Name YAVAPAI		B3. State AZ	
B4. Map/Panel Number 04025C1805	B5. Suffix F	B6. FIRM Index Date JUNE 6 2001	B7. FIRM Panel Effective/Revised Date JUNE 6 2001	B8. Flood Zone(s) AE	B9. Base Flood Elevation(s) (Zone AO, use base flood depth) 3244.4
B10. Indicate the source of the Base Flood Elevation (BFE) data or base flood depth entered in Item B9. <input checked="" type="checkbox"/> FIS Profile <input type="checkbox"/> FIRM <input type="checkbox"/> Community Determined <input type="checkbox"/> Other (Describe) _____					
B11. Indicate elevation datum used for BFE in Item B9: <input checked="" type="checkbox"/> NGVD 1929 <input type="checkbox"/> NAVD 1988 <input type="checkbox"/> Other (Describe) _____					
B12. Is the building located in a Coastal Barrier Resources System (CBRS) area or Otherwise Protected Area (OPA)? Designation Date _____ <input type="checkbox"/> CBRS <input type="checkbox"/> OPA <input type="checkbox"/> Yes <input checked="" type="checkbox"/> No					

SECTION C - BUILDING ELEVATION INFORMATION (SURVEY REQUIRED)

C1. Building elevations are based on: Construction Drawings* Building Under Construction* Finished Construction
*A new Elevation Certificate will be required when construction of the building is complete.

C2. Elevations - Zones A1-A30, AE, AH, A (with BFE), VE, V1-V30, V (with BFE), AR, AR/A, AR/AE, AR/A1-A30, AR/AH, AR/AO. Complete items C2.a-g below according to the building diagram specified in Item A7.

Benchmark Utilized **RM 18-2** Vertical Datum **3250.16**

Conversion/Comments _____

Check the measurement used.

a) Top of bottom floor (including basement, crawl space, or enclosure floor) 3237.12 <input checked="" type="checkbox"/> feet	<input type="checkbox"/> meters (Puerto Rico only)
b) Top of the next higher floor 3238.37 <input checked="" type="checkbox"/> feet	<input type="checkbox"/> meters (Puerto Rico only)
c) Bottom of the lowest horizontal structural member (V Zones only) N/A <input type="checkbox"/> feet	<input type="checkbox"/> meters (Puerto Rico only)
d) Attached garage (top of slab) 3237.05 <input checked="" type="checkbox"/> feet	<input type="checkbox"/> meters (Puerto Rico only)
e) Lowest elevation of machinery or equipment servicing the building (Describe type of equipment in Comments) 3237.12 <input checked="" type="checkbox"/> feet	<input type="checkbox"/> meters (Puerto Rico only)
f) Lowest adjacent (finished) grade (LAG) 3236.33 <input checked="" type="checkbox"/> feet	<input type="checkbox"/> meters (Puerto Rico only)
g) Highest adjacent (finished) grade (HAG) 3236.83 <input checked="" type="checkbox"/> feet	<input type="checkbox"/> meters (Puerto Rico only)

SECTION D - SURVEYOR, ENGINEER, OR ARCHITECT CERTIFICATION

This certification is to be signed and sealed by a land surveyor, engineer, or architect authorized by law to certify elevation information. I certify that the information on this Certificate represents my best efforts to interpret the data available. I understand that any false statement may be punishable by fine or imprisonment under 18 U.S. Code, Section 1001.

Check here if comments are provided on back of form.

Certifier's Name Dugan McDonald		License Number RLS 26925	
Title President	Company Name Heritage Land Survey & Mapping, Inc.		
Address P.O. Box 3270	City Camp Verde	State AZ	ZIP Code 86322
Signature <i>[Signature]</i>	Date 06-04-08	Telephone 928-567-9170	

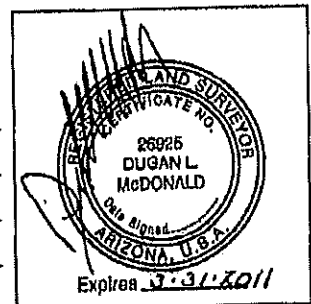

IMPORTANT: In these spaces, copy the corresponding information from Section A.			For Insurance Company Use:	
Building Street Address (including Apt., Unit, Suite, and/or Bldg. No.) or P.O. Route and Box No.			Policy Number	
City	State	ZIP Code	Company NAIC Number	

SECTION D - SURVEYOR, ENGINEER, OR ARCHITECT CERTIFICATION (CONTINUED)

Copy both sides of this Elevation Certificate for (1) community official, (2) insurance agent/company, and (3) building owner.

Comments The lowest elevation of machinery and/or equipment serving the home is a hot water heater. The top of the next higher floor is a 2nd story at 3246.40.

Signature _____ Date _____ Check here if attachments

SECTION E - BUILDING ELEVATION INFORMATION (SURVEY NOT REQUIRED) FOR ZONE AO AND ZONE A (WITHOUT BFE)

For Zones AO and A (without BFE), complete Items E1-E5. If the Certificate is intended to support a LOMA or LOMR-F request, complete Sections A, B, and C. For Items E1-E4, use natural grade, if available. Check the measurement used. In Puerto Rico only, enter meters.

- E1. Provide elevation information for the following and check the appropriate boxes to show whether the elevation is above or below the highest adjacent grade (HAG) and the lowest adjacent grade (LAG).
 - a) Top of bottom floor (including basement, crawl space, or enclosure) is _____ feet meters above or below the HAG.
 - b) Top of bottom floor (including basement, crawl space, or enclosure) is _____ feet meters above or below the LAG.
- E2. For Building Diagrams 6-8 with permanent flood openings provided in Section A Items 8 and/or 9 (see page 8 of Instructions), the next higher floor (elevation C2.b in the diagrams) of the building is _____ feet meters above or below the HAG.
- E3. Attached garage (top of slab) is _____ feet meters above or below the HAG.
- E4. Top of platform of machinery and/or equipment servicing the building is _____ feet meters above or below the HAG.
- E5. Zone AO only: If no flood depth number is available, is the top of the bottom floor elevated in accordance with the community's floodplain management ordinance? Yes No Unknown. The local official must certify this information in Section G.

SECTION F - PROPERTY OWNER (OR OWNER'S REPRESENTATIVE) CERTIFICATION

The property owner or owner's authorized representative who completes Sections A, B, and E for Zone A (without a FEMA-issued or community-issued BFE) or Zone AO must sign here. *The statements in Sections A, B, and E are correct to the best of my knowledge.*

Property Owner's or Owner's Authorized Representative's Name _____

Address _____ City _____ State _____ ZIP Code _____

Signature _____ Date _____ Telephone _____

Comments _____

Check here if attachments

SECTION G - COMMUNITY INFORMATION (OPTIONAL)

The local official who is authorized by law or ordinance to administer the community's floodplain management ordinance can complete Sections A, B, C (or E), and G of this Elevation Certificate. Complete the applicable item(s) and sign below. Check the measurement used in Items G8. and G9.

- G1. The information in Section C was taken from other documentation that has been signed and sealed by a licensed surveyor, engineer, or architect who is authorized by law to certify elevation information. (Indicate the source and date of the elevation data in the Comments area below.)
- G2. A community official completed Section E for a building located in Zone A (without a FEMA-issued or community-issued BFE) or Zone AO.
- G3. The following information (Items G4.-G9.) is provided for community floodplain management purposes.

G4. Permit Number	G5. Date Permit Issued	G6. Date Certificate Of Compliance/Occupancy Issued
-------------------	------------------------	---

- G7. This permit has been issued for: New Construction Substantial Improvement
- G8. Elevation of as-built lowest floor (including basement) of the building: _____ feet meters (PR) Datum _____
- G9. BFE or (in Zone AO) depth of flooding at the building site: _____ feet meters (PR) Datum _____

Local Official's Name _____ Title _____

Community Name _____ Telephone _____

Signature _____ Date _____

Comments _____

Check here if attachments

ELEVATION CERTIFICATE

FEDERAL EMERGENCY MANAGEMENT AGENCY NATIONAL FLOOD INSURANCE PROGRAM

ATTENTION: Use of this certificate does not provide a waiver of the flood insurance purchase requirement. This form is used only to provide elevation information necessary to ensure compliance with applicable community floodplain management ordinances, to determine the proper insurance premium rate, and/or to support a request for a Letter of Map Amendment or Revision (LOMA or LOMR). Instructions for completing this form can be found on the following pages.

SECTION A PROPERTY INFORMATION	FOR INSURANCE COMPANY USE
BUILDING OWNER'S NAME <u>Joe Summerlin</u>	POLICY NUMBER
STREET ADDRESS (Including Apt., Unit, Suite and/or Bldg. Number) OR P.O. ROUTE AND BOX NUMBER <u>5053 Comanche Dr Now 406-47-461C</u>	COMPANY NAIC NUMBER
OTHER DESCRIPTION (Lot and Block Numbers, etc.) <u>Tax Parcel HDB-47-462 / Lot 2305 Verde Village #5</u>	
CITY <u>Cottonwood</u>	STATE <u>AZ</u>
	ZIP CODE <u>86326</u>

SECTION B FLOOD INSURANCE RATE MAP (FIRM) INFORMATION

Provide the following from the proper FIRM (See Instructions):

1. COMMUNITY NUMBER <u>040093</u>	2. PANEL NUMBER <u>865</u>	3. SUFFIX <u>B</u>	4. DATE OF FIRM INDEX <u>8/19/85</u>	5. FIRM ZONE <u>A12</u>	6. BASE FLOOD ELEVATION (in AO Zones, use depth) <u>3244.4</u>
--------------------------------------	-------------------------------	-----------------------	---	----------------------------	--

7. Indicate the elevation datum system used on the FIRM for Base Flood Elevations (BFE): NGVD '29 Other (describe on back)
8. For Zones A or V, where no BFE is provided on the FIRM, and the community has established a BFE for this building site, indicate the community's BFE: feet NGVD (or other FIRM datum—see Section B, Item 7).

SECTION C BUILDING ELEVATION INFORMATION

1. Using the Elevation Certificate Instructions, indicate the diagram number from the diagrams found on Pages 5 and 6 that best describes the subject building's reference level _____.
- 2(a). FIRM Zones A1-A30, AE, AH, and A (with BFE). The top of the reference level floor from the selected diagram is at an elevation of B2415 feet NGVD (or other FIRM datum—see Section B, Item 7).
- (b). FIRM Zones V1-V30, VE, and V (with BFE). The bottom of the lowest horizontal structural member of the reference level from the selected diagram, is at an elevation of feet NGVD (or other FIRM datum—see Section B, Item 7).
- (c). FIRM Zone A (without BFE). The floor used as the reference level from the selected diagram is feet above or below (check one) the highest grade adjacent to the building.
- (d). FIRM Zone AO. The floor used as the reference level from the selected diagram is feet above or below (check one) the highest grade adjacent to the building. If no flood depth number is available, is the building's lowest floor (reference level) elevated in accordance with the community's floodplain management ordinance? Yes No Unknown
3. Indicate the elevation datum system used in determining the above reference level elevations: NGVD '29 Other (describe under Comments on Page 2). (NOTE: If the elevation datum used in measuring the elevations is different than that used on the FIRM [see Section B, Item 7], then convert the elevations to the datum system used on the FIRM and show the conversion equation under Comments on Page 2.)
4. Elevation reference mark used appears on FIRM: Yes No (See Instructions on Page 4)
5. The reference level elevation is based on: actual construction construction drawings
(NOTE: Use of construction drawings is only valid if the building does not yet have the reference level floor in place, in which case this certificate will only be valid for the building during the course of construction. A post-construction Elevation Certificate will be required once construction is complete.)
6. The elevation of the lowest grade immediately adjacent to the building is: B2316 feet NGVD (or other FIRM datum—see Section B, Item 7).

SECTION D COMMUNITY INFORMATION

1. If the community official responsible for verifying building elevations specifies that the reference level indicated in Section C, Item 1 is not the "lowest floor" as defined in the community's floodplain management ordinance, the elevation of the building's "lowest floor" as defined by the ordinance is: feet NGVD (or other FIRM datum—see Section B, Item 7).
2. Date of the start of construction or substantial improvement 10-27-89.

SECTION E CERTIFICATION

This certification is to be signed by a land surveyor, engineer, or architect who is authorized by state or local law to certify elevation information when the elevation information for Zones A1-A30, AE, AH, A (with BFE), V1-V30, VE, and V (with BFE) is required. Community officials who are authorized by local law or ordinance to provide floodplain management information, may also sign the certification. In the case of Zones AO and A (without a FEMA or community issued BFE), a building official, a property owner, or an owner's representative may also sign the certification.

Reference level diagrams 6, 7 and 8 - Distinguishing Features—If the certifier is unable to certify to breakaway/non-breakaway wall, enclosure size, location of servicing equipment, area use, wall openings, or unfinished area Feature(s), then list the Feature(s) not included in the certification under Comments below. The diagram number, Section C, Item 1, must still be entered.

I certify that the information in Sections B and C on this certificate represents my best efforts to interpret the data available. I understand that any false statement may be punishable by fine or imprisonment under 18 U.S. Code, Section 1001.

CERTIFIER'S NAME KENNETH E. SPEDDING	LICENSE NUMBER (or Affix Seal)
TITLE DISTRICT DIRECTOR	COMPANY NAME YAVAPAI COUNTY FLOOD CONTROL DISTRICT
ADDRESS 255 E. GURLEY ST.,	CITY PRESCOTT STATE AZ ZIP 86301
SIGNATURE	DATE 3/14/95 PHONE (602) 771-3196

Copies should be made of this Certificate for: 1) community official, 2) insurance agent/company, and 3) building owner.

COMMENTS: _____

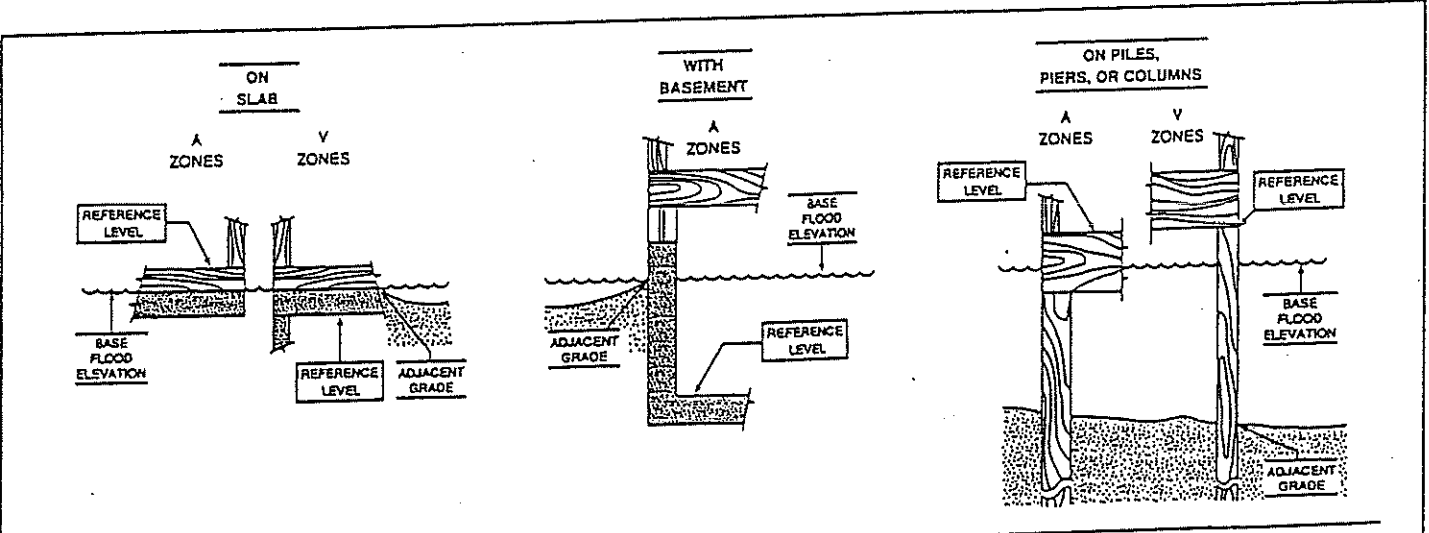

The diagrams above illustrate the points at which the elevations should be measured in A Zones and V Zones. Elevations for all A Zones should be measured at the top of the reference level floor. Elevations for all V Zones should be measured at the bottom of the lowest horizontal structural member.