

FEDERAL EMERGENCY MANAGEMENT AGENCY  
NATIONAL FLOOD INSURANCE PROGRAM

O.M.B. No. 3067-0077  
Expires December 31, 2005

**ELEVATION CERTIFICATE**

**Important: Read the instructions on pages 1 - 7.**

<b>SECTION A - PROPERTY OWNER INFORMATION</b>			For Insurance Company Use:
BUILDING OWNER'S NAME Rodrigo Sanchez		Policy Number	
BUILDING STREET ADDRESS (Including Apt., Unit, Suite, and/or Bldg. No.) OR P.O. ROUTE AND BOX NO. 3772 Broken Saddle 86326		Company NAIC Number	
CITY Cottonwood	STATE Az	ZIP CODE 86326	
PROPERTY DESCRIPTION (Lot and Block Numbers, Tax Parcel Number, Legal Description, etc.) Lot 2329 Verde Village Unit 5, 406-47-486, Book 3990 Pg. 634 Yavapai County Recorders Office			
BUILDING USE (e.g., Residential, Non-residential, Addition, Accessory, etc. Use a Comments area, if necessary.) Residential			
LATITUDE/LONGITUDE (OPTIONAL) ( ##° - ##' - ##"##" or ##.####°)	HORIZONTAL DATUM: <input type="checkbox"/> NAD 1927 <input type="checkbox"/> NAD 1983	SOURCE: <input type="checkbox"/> GPS (Type): _____ <input type="checkbox"/> USGS Quad Map <input type="checkbox"/> Other: _____	

<b>SECTION B - FLOOD INSURANCE RATE MAP (FIRM) INFORMATION</b>					
B1. NFIP COMMUNITY NAME & COMMUNITY NUMBER Yavapai Count 040093		B2. COUNTY NAME Yavapai		B3. STATE Arizona	
B4. MAP AND PANEL NUMBER 04025C 1805	B5. SUFFIX F	B6. FIRM INDEX DATE 06-06-01	B7. FIRM PANEL EFFECTIVE/REVISED DATE 06-06-2001	B8. FLOOD ZONE(S) AE	B9. BASE FLOOD ELEVATION(S) (Zone AO, use depth of flooding) 3246.1
B10. Indicate the source of the Base Flood Elevation (BFE) data or base flood depth entered in B9. <input checked="" type="checkbox"/> FIS Profile <input type="checkbox"/> FIRM <input type="checkbox"/> Community Determined <input type="checkbox"/> Other (Describe): _____					
B11. Indicate the elevation datum used for the BFE in B9: <input checked="" type="checkbox"/> NGVD 1929 <input type="checkbox"/> NAVD 1988 <input type="checkbox"/> Other (Describe): _____					
B12. Is the building located in a Coastal Barrier Resources System (CBRS) area or Otherwise Protected Area (OPA)? <input type="checkbox"/> Yes <input checked="" type="checkbox"/> No Designation Date _____					

<b>SECTION C - BUILDING ELEVATION INFORMATION (SURVEY REQUIRED)</b>	
C1. Building elevations are based on: <input type="checkbox"/> Construction Drawings* <input type="checkbox"/> Building Under Construction* <input checked="" type="checkbox"/> Finished Construction *A new Elevation Certificate will be required when construction of the building is complete.	
C2. Building Diagram Number <u>1</u> (Select the building diagram most similar to the building for which this certificate is being completed - see pages 6 and 7. If no diagram accurately represents the building, provide a sketch or photograph.)	
C3. Elevations - Zones A1-A30, AE, AH, A (with BFE), VE, V1-V30, V (with BFE), AR, AR/A, AR/AE, AR/A1-A30, AR/AH, AR/AO Complete Items C3.-a-i below according to the building diagram specified in Item C2. State the datum used. If the datum is different from the datum used for the BFE in Section B, convert the datum to that used for the BFE. Show field measurements and datum conversion calculation. Use the space provided or the Comments area of Section D or Section G, as appropriate, to document the datum conversion. Datum <u>NGVD 1929</u> Conversion/Comments _____ Elevation reference mark used <u>RM-270</u> Does the elevation reference mark used appear on the FIRM? <input checked="" type="checkbox"/> Yes <input type="checkbox"/> No	
o a) Top of bottom floor (including basement or enclosure)	<u>3247. 81</u> ft.(m)
o b) Top of next higher floor	_____ ft.(m)
o c) Bottom of lowest horizontal structural member (V zones only)	_____ ft.(m)
o d) Attached garage (top of slab)	<u>3247. 68</u> ft.(m)
o e) Lowest elevation of machinery and/or equipment servicing the building (Describe in a Comments area)	_____ ft.(m)
o f) Lowest adjacent (finished) grade (LAG)	<u>3247. 3</u> ft.(m)
o g) Highest adjacent (finished) grade (HAG)	<u>3247. 6</u> ft.(m)
o h) No. of permanent openings (flood vents) within 1 ft. above adjacent grade <u>0</u>	
o i) Total area of all permanent openings (flood vents) in C3.h _____ sq. in. (sq. cm)	

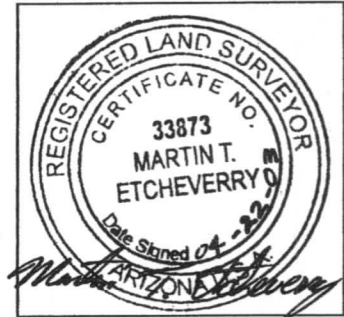

License Number, Embossed Seal, Signature, and Date

<b>SECTION D - SURVEYOR, ENGINEER, OR ARCHITECT CERTIFICATION</b>			
This certification is to be signed and sealed by a land surveyor, engineer, or architect authorized by law to certify elevation information. I certify that the information in Sections A, B, and C on this certificate represents my best efforts to interpret the data available. I understand that any false statement may be punishable by fine or imprisonment under 18 U.S. Code, Section 1001.			
CERTIFIER'S NAME Martin T. Etcheverry		LICENSE NUMBER 33873	
TITLE R.L.S.	COMPANY NAME Landmark Engineering & Surveying, Inc.		
ADDRESS 830 S. Main St. Suite 1i	CITY Cottonwood	STATE Az	ZIP CODE 86326
SIGNATURE <i>Martin T. Etcheverry</i>	DATE <u>04-22-2003</u>	TELEPHONE (928)634-0309	

<b>IMPORTANT: In these spaces, copy the corresponding information from Section A.</b>			For Insurance Company Use:
BUILDING STREET ADDRESS (Including Apt., Unit, Suite, a Bldg. No.) OR P.O. ROUTE AND BOX NO. 3772 Broken Saddle 86326			Policy Number
CITY Cottonwood	STATE Az	ZIP CODE 86326	Company NAIC Number

**SECTION D - SURVEYOR, ENGINEER, OR ARCHITECT CERTIFICATION (CONTINUED)**

Copy both sides of this Elevation Certificate for (1) community official, (2) insurance agent/company, and (3) building owner.

**COMMENTS**

Natural grade appears to have been built up gently sloping away from the building in all directions. There was no landscaping at the time the elevations were measured. The garage floor where it connects to the house is 0.1 lower than the finished floor.

The garage floor slopes away from the house and is 0.25 lower than the finish floor at the garage door opening. The Elevation

Noted on this document for the garage (Top of slab) C3-d is the interior garage floor at the high point near the inside door.  Check here if attachments

**SECTION E - BUILDING ELEVATION INFORMATION (SURVEY NOT REQUIRED) FOR ZONE AO AND ZONE A (WITHOUT BFE)**

For Zone AO and Zone A (without BFE), complete Items E1 through E4. If the Elevation Certificate is intended for use as supporting information for a LOMA or LOMR-F, Section C must be completed.

- E1. Building Diagram Number \_\_ (Select the building diagram most similar to the building for which this certificate is being completed – see pages 6 and 7. If no diagram accurately represents the building, provide a sketch or photograph.)
- E2. The top of the bottom floor (including basement or enclosure) of the building is \_\_ ft.(m) \_\_ in.(cm)  above or  below (check one) the highest adjacent grade. (Use natural grade, if available).
- E3. For Building Diagrams 6-8 with openings (see page 7), the next higher floor or elevated floor (elevation b) of the building is \_\_ ft.(m) \_\_ in.(cm) above the highest adjacent grade. Complete items C3.h and C3.i on front of form.
- E4. The top of the platform of machinery and/or equipment servicing the building is \_\_ ft.(m) \_\_ in.(cm)  above or  below (check one) the highest adjacent grade. (Use natural grade, if available).
- E5. For Zone AO only: If no flood depth number is available, is the top of the bottom floor elevated in accordance with the community's floodplain management ordinance?  
 Yes  No  Unknown. The local official must certify this information in Section G.

**SECTION F - PROPERTY OWNER (OR OWNER'S REPRESENTATIVE) CERTIFICATION**

The property owner or owner's authorized representative who completes Sections A, B, C (Items C3.h and C3.i only), and E for Zone A (without a FEMA-issued or community-issued BFE) or Zone AO must sign here. *The statements in Sections A, B, C, and E are correct to the best of my knowledge.*

PROPERTY OWNER'S OR OWNER'S AUTHORIZED REPRESENTATIVE'S NAME

ADDRESS	CITY	STATE	ZIP CODE
SIGNATURE	DATE	TELEPHONE	

COMMENTS

Check here if attachments

**SECTION G - COMMUNITY INFORMATION (OPTIONAL)**

The local official who is authorized by law or ordinance to administer the community's floodplain management ordinance can complete Sections A, B, C (or E), and G of this Elevation Certificate. Complete the applicable item(s) and sign below.

- G1.  The information in Section C was taken from other documentation that has been signed and embossed by a licensed surveyor, engineer, or architect who is authorized by state or local law to certify elevation information. (Indicate the source and date of the elevation data in the Comments area below.)
- G2.  A community official completed Section E for a building located in Zone A (without a FEMA-issued or community-issued BFE) or Zone AO.
- G3.  The following information (Items G4-G9) is provided for community floodplain management purposes.

G4. PERMIT NUMBER	G5. DATE PERMIT ISSUED	G6. DATE CERTIFICATE OF COMPLIANCE/OCCUPANCY ISSUED
-------------------	------------------------	---

G7. This permit has been issued for:  New Construction  Substantial Improvement

G8. Elevation of as-built lowest floor (including basement) of the building is: \_\_\_\_\_ ft.(m) Datum: \_\_\_\_\_

G9. BFE or (in Zone AO) depth of flooding at the building site is: \_\_\_\_\_ ft.(m) Datum: \_\_\_\_\_

LOCAL OFFICIAL'S NAME \_\_\_\_\_ TITLE \_\_\_\_\_

COMMUNITY NAME \_\_\_\_\_ TELEPHONE \_\_\_\_\_

SIGNATURE \_\_\_\_\_ DATE \_\_\_\_\_

COMMENTS

Check here if attachments