

JDS ASSOCIATES, L.L.C.
LAND SURVEYING

P.O. Box 3240 Camp Verde, AZ 86322
Telephone (928) 567-8543 Fax (928) 567-9014
jdsassoc@msn.com

June 24, 2008

April Troxell
J - T Ranch
PO Box 187
Cornville AZ 86325

Re: FLOODPLAIN ELEVATIONS
APN 407-29-021
Portions of Section 26 T16N-R4E

Ms. Troxell;

With regards to the elevations of the existing dwellings on your property, please be aware that due to a lack of accessibility to required fixtures on one of the dwellings and the uncooperative responses we received from you, we officially terminated our agreement to perform surveying services for you on June 10, 2008, during our phone conversation. I also explained that we would not be charging you for any work performed.

Although we had invested considerable field and office time towards completing the job, any information shared between JDS Associates and Yavapai County Flood Control District was preliminary in nature and was not considered as finalized. That being said, any documents furnished to Yavapai County Flood Control District regarding this matter **ARE NULL AND VOID.**

We suggest another surveying firm may be able to help you in this matter.

Respectfully submitted,



Jody A. Stone, RLS
JDS Associates, LLC

Cc: Yavapai County Flood Control District

ELEVATION CERTIFICATE

OMB No. 1660-0008
Expires February 28, 2009

Important: Read the instructions on pages 1-8.

SECTION A - PROPERTY INFORMATION

| | | |
|--|--|---|
| A1. Building Owner's Name <u>W H TROXELL TRUST</u> | | For Insurance Company Use: Policy Number |
| A2. Building Street Address (including Apt., Unit, Suite, and/or Bldg. No.) or P.O. Route and Box No. <u>1145 N WILLOW POINT ROAD</u> | | Company NAIC Number |
| City <u>CORNVILLE</u> State <u>AZ</u> ZIP Code <u>86325</u> | | |
| A3. Property Description (Lot and Block Numbers, Tax Parcel Number, Legal Description, etc.) <u>E1/2 SW1/4 NW1/4 SE1/4 SECTION 26 T16N-R4E RECORDED AT BOOK 3626 OFFICIAL RECORDS PAGE 280 YAVAPAI COUNTY RECORDS</u> | | |
| A4. Building Use (e.g., Residential, Non-Residential, Addition, Accessory, etc.) <u>RESIDENTIAL</u> | | |
| A5. Latitude/Longitude: Lat. <u>34°45'05.18"N</u> Long. <u>111°53'35.08"W</u> | | Horizontal Datum: <input type="checkbox"/> NAD 1927 <input checked="" type="checkbox"/> NAD 1983 |
| A6. Attach at least 2 photographs of the building if the Certificate is being used to obtain flood insurance. | | |
| A7. Building Diagram Number <u>2</u> | | |
| A8. For a building with a crawl space or enclosure(s), provide | | A9. For a building with an attached garage, provide: |
| a) Square footage of crawl space or enclosure(s) <u>N/A</u> sq ft | | a) Square footage of attached garage <u>588.0</u> sq ft |
| b) No. of permanent flood openings in the crawl space or enclosure(s) walls within 1.0 foot above adjacent grade <u>N/A</u> | | b) No. of permanent flood openings in the attached garage walls within 1.0 foot above adjacent grade <u>N/A</u> |
| c) Total net area of flood openings in A8.b <u>N/A</u> sq in | | c) Total net area of flood openings in A9.b <u>N/A</u> sq in |

SECTION B - FLOOD INSURANCE RATE MAP (FIRM) INFORMATION

| | | | | | |
|--|------------------------|--|--|--------------------------------|---|
| B1. NFIP Community Name & Community Number <u>040093</u> | | B2. County Name <u>YAVAPAI COUNTY</u> | | B3. State <u>AZ</u> | |
| B4. Map/Panel Number <u>04025C1445</u> | B5. Suffix <u>F</u> | B6. FIRM Index Date <u>6/6/2001</u> | B7. FIRM Panel Effective/Revised Date <u>6/6/2001</u> | B8. Flood Zone(s) <u>AE</u> | B9. Base Flood Elevation(s) (Zone AO, use base flood depth) |
| B10. Indicate the source of the Base Flood Elevation (BFE) data or base flood depth entered in Item B9. <input type="checkbox"/> FIS Profile <input checked="" type="checkbox"/> FIRM <input type="checkbox"/> Community Determined <input type="checkbox"/> Other (Describe) _____ | | | | | |
| B11. Indicate elevation datum used for BFE in Item B9: <input type="checkbox"/> NGVD 1929 <input checked="" type="checkbox"/> NAVD 1988 <input type="checkbox"/> Other (Describe) _____ | | | | | |
| B12. Is the building located in a Coastal Barrier Resources System (CBRS) area or Otherwise Protected Area (OPA)? <input type="checkbox"/> Yes <input checked="" type="checkbox"/> No Designation Date _____ <input type="checkbox"/> CBRS <input type="checkbox"/> OPA | | | | | |

SECTION C - BUILDING ELEVATION INFORMATION (SURVEY REQUIRED)

C1. Building elevations are based on: Construction Drawings* Building Under Construction* Finished Construction
*A new Elevation Certificate will be required when construction of the building is complete.

C2. Elevations - Zones A1-A30, AE, AH, A (with BFE), VE, V1-V30, V (with BFE), AR, AR/A, AR/AE, AR/A1-A30, AR/AH, AR/AO. Complete Items C2.a-g below according to the building diagram specified in Item A7.
Benchmark Utilized RM 83 Vertical Datum NGVD 29
Conversion/Comments +2.71

Check the measurement used.

| | | |
|---|----------------|---|
| a) Top of bottom floor (including basement, crawl space, or enclosure floor), | <u>3421.98</u> | <input checked="" type="checkbox"/> feet <input type="checkbox"/> meters (Puerto Rico only) |
| b) Top of the next higher floor | <u>3430.95</u> | <input checked="" type="checkbox"/> feet <input type="checkbox"/> meters (Puerto Rico only) |
| c) Bottom of the lowest horizontal structural member (V Zones only) | <u>N/A</u> | <input type="checkbox"/> feet <input type="checkbox"/> meters (Puerto Rico only) |
| d) Attached garage (top of slab) | <u>3429.54</u> | <input checked="" type="checkbox"/> feet <input type="checkbox"/> meters (Puerto Rico only) |
| e) Lowest elevation of machinery or equipment servicing the building (Describe type of equipment in Comments) | <u>3425.7</u> | <input checked="" type="checkbox"/> feet <input type="checkbox"/> meters (Puerto Rico only) |
| f) Lowest adjacent (finished) grade (LAG) | <u>3426.2</u> | <input checked="" type="checkbox"/> feet <input type="checkbox"/> meters (Puerto Rico only) |
| g) Highest adjacent (finished) grade (HAG) | <u>3429.2</u> | <input checked="" type="checkbox"/> feet <input type="checkbox"/> meters (Puerto Rico only) |

SECTION D - SURVEYOR, ENGINEER, OR ARCHITECT CERTIFICATION

This certification is to be signed and sealed by a land surveyor, engineer, or architect authorized by law to certify elevation information. I certify that the information on this Certificate represents my best efforts to interpret the data available. I understand that any false statement may be punishable by fine or imprisonment under 18 U.S. Code, Section 1001.

Check here if comments are provided on back of form.

| | |
|--|--|
| Certifier's Name <u>JODY ALLEN STONE RLS</u> | License Number <u>37401</u> |
| Title <u>VICE PRESIDENT</u> | Company Name <u>JDS ASSOCIATES, L.L.C.</u> |
| Address <u>PO BOX 3240</u> | City <u>CAMP VERDE</u> State <u>AZ</u> ZIP Code <u>86322</u> |
| Signature _____ | Date <u>6/10/2008</u> Telephone <u>928-567-8543</u> |

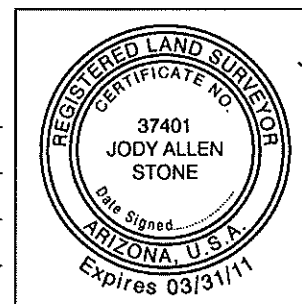

| | |
|---|----------------------------|
| IMPORTANT: In these spaces, copy the corresponding information from Section A. | For Insurance Company Use: |
| Building Street Address (including Apt., Unit, Suite, and/or Bldg. No.) or P.O. Route and Box No. 1145 N WILLOW POINT ROAD | Policy Number |
| City CORNVILLE State AZ ZIP Code 86325 | Company NAIC Number |

SECTION D - SURVEYOR, ENGINEER, OR ARCHITECT CERTIFICATION (CONTINUED)

Copy both sides of this Elevation Certificate for (1) community official, (2) insurance agent/company, and (3) building owner.

Comments e) BOTTOM OF LOWEST ELECTRICAL OUTLET IN BASEMENT.
3 RESIDENTIAL STRUCTURES ON THE SUBJECT PROPERTY. THIS FORM REFERENCES DWELLING A (SEE ATTACHED).

| | | |
|-----------|----------------|---|
| Signature | Date 6/10/2008 | <input checked="" type="checkbox"/> Check here if attachments |
|-----------|----------------|---|

SECTION E - BUILDING ELEVATION INFORMATION (SURVEY NOT REQUIRED) FOR ZONE AO AND ZONE A (WITHOUT BFE)

For Zones AO and A (without BFE), complete Items E1-E5. If the Certificate is intended to support a LOMA or LOMR-F request, complete Sections A, B, and C. For Items E1-E4, use natural grade, if available. Check the measurement used. In Puerto Rico only, enter meters.

- E1. Provide elevation information for the following and check the appropriate boxes to show whether the elevation is above or below the highest adjacent grade (HAG) and the lowest adjacent grade (LAG).
a) Top of bottom floor (including basement, crawl space, or enclosure) is _____ feet meters above or below the HAG.
b) Top of bottom floor (including basement, crawl space, or enclosure) is _____ feet meters above or below the LAG.
- E2. For Building Diagrams 6-8 with permanent flood openings provided in Section A Items 8 and/or 9 (see page 8 of Instructions), the next higher floor (elevation C2.b in the diagrams) of the building is _____ feet meters above or below the HAG.
- E3. Attached garage (top of slab) is _____ feet meters above or below the HAG.
- E4. Top of platform of machinery and/or equipment servicing the building is _____ feet meters above or below the HAG.
- E5. Zone AO only: If no flood depth number is available, is the top of the bottom floor elevated in accordance with the community's floodplain management ordinance? Yes No Unknown. The local official must certify this information in Section G.

SECTION F - PROPERTY OWNER (OR OWNER'S REPRESENTATIVE) CERTIFICATION

The property owner or owner's authorized representative who completes Sections A, B, and E for Zone A (without a FEMA-issued or community-issued BFE) or Zone AO must sign here. *The statements in Sections A, B, and E are correct to the best of my knowledge.*

| | | | |
|--|------|-----------|----------|
| Property Owner's or Owner's Authorized Representative's Name | | | |
| Address | City | State | ZIP Code |
| Signature | Date | Telephone | |
| Comments | | | |

Check here if attachments

SECTION G - COMMUNITY INFORMATION (OPTIONAL)

The local official who is authorized by law or ordinance to administer the community's floodplain management ordinance can complete Sections A, B, C (or E), and G of this Elevation Certificate. Complete the applicable item(s) and sign below. Check the measurement used in Items G8. and G9.

- G1. The information in Section C was taken from other documentation that has been signed and sealed by a licensed surveyor, engineer, or architect who is authorized by law to certify elevation information. (Indicate the source and date of the elevation data in the Comments area below.)
- G2. A community official completed Section E for a building located in Zone A (without a FEMA-issued or community-issued BFE) or Zone AO.
- G3. The following information (Items G4.-G9.) is provided for community floodplain management purposes.

| | | |
|-------------------|------------------------|---|
| G4. Permit Number | G5. Date Permit Issued | G6. Date Certificate Of Compliance/Occupancy Issued |
|-------------------|------------------------|---|

- G7. This permit has been issued for: New Construction Substantial Improvement
- G8. Elevation of as-built lowest floor (including basement) of the building: _____ feet meters (PR) Datum _____
- G9. BFE or (in Zone AO) depth of flooding at the building site: _____ feet meters (PR) Datum _____

| | |
|-----------------------|-----------|
| Local Official's Name | Title |
| Community Name | Telephone |
| Signature | Date |
| Comments | |

Check here if attachments

Building Photographs

See Instructions for Item A6.

| | |
|---|---|
| Building Street Address (including Apt., Unit, Suite, and/or Bldg. No.) or P.O. Route and Box No. 1145 N WILLOW POINT ROAD | For Insurance Company Use: Policy Number |
| City CORNVILLE State AZ ZIP Code 86325 | Company NAIC Number |
| If using the Elevation Certificate to obtain NFIP flood insurance, affix at least two building photographs below according to the instructions for Item A6. Identify all photographs with: date taken; "Front View" and "Rear View"; and, if required, "Right Side View" and "Left Side View." If submitting more photographs than will fit on this page, use the Continuation Page, following. | |

DWELLING A
LEFT SIDE FRONT VIEW
PHOTO TAKEN 6/2/2008



Building Photographs

Continuation Page

| | |
|--|---|
| Building Street Address (including Apt., Unit, Suite, and/or Bldg. No.) or P.O. Route and Box No. 1145 N WILLOW POINT ROAD | For Insurance Company Use: Policy Number |
| City CORNVILLE State AZ ZIP Code 86325 | Company NAIC Number |
| If submitting more photographs than will fit on the preceding page, affix the additional photographs below. Identify all photographs with: date taken; "Front View" and "Rear View"; and, if required, "Right Side View" and "Left Side View." | |

DWELLING A
RIGHT SIDE FRONT VIEW
PHOTO TAKEN 6/2/2008



Building Photographs

Continuation Page

| | |
|--|---|
| Building Street Address (including Apt., Unit, Suite, and/or Bldg. No.) or P.O. Route and Box No. 1145 N WILLOW POINT ROAD | For Insurance Company Use: Policy Number |
| City CORNVILLE State AZ ZIP Code 86325 | Company NAIC Number |
| If submitting more photographs than will fit on the preceding page, affix the additional photographs below. Identify all photographs with: date taken; "Front View" and "Rear View"; and, if required, "Right Side View" and "Left Side View." | |

DWELLING A
REAR VIEW
PHOTO TAKEN 6/2/2008

