

NOTES TO USERS

This map is for use in administering the National Flood Insurance Program. It does not necessarily identify the areas subject to flooding, particularly from local drainage, or of any kind. This information is intended only for use in determining whether a property is located in a Special Flood Hazard Area.

To obtain more detailed information in areas where Base Flood Elevations are shown, consult the Flood Profile and Floodway Data and/or Summary of Elevation Data sheets contained within the Flood Insurance Policy (FIP) report that accompanies this FIRM. Users should be aware that the FIP report is the FIRM's representation of the actual data. These data are intended for use in determining whether a property is located in a Special Flood Hazard Area. Flood profiles and floodway data should be used in the determination of flood insurance information. Accordingly, flood elevation data presented in the FIP report should be related to information with the FIRM for purposes of construction and/or floodplain management.

Coastal Base Flood Elevations shown on this map apply only to the portion of the United States that is subject to coastal flooding. Users of this FIRM should be aware that coastal flood elevations are also provided in the Summary of Elevation Data sheets in the Flood Insurance Policy report for use in determining whether a property is located in a Special Flood Hazard Area. Flood profiles and floodway data should be used in the determination of flood insurance information. Accordingly, flood elevation data presented in the FIP report should be related to information with the FIRM for purposes of construction and/or floodplain management when they are higher than the elevations shown on this FIRM.

Boundaries of the floodway were compiled at cross sections and interpolated between cross sections. The floodway was based on hydraulic considerations with regard to the National Flood Insurance Program. Floodway boundaries and other pertinent floodway data are provided in the Flood Insurance Policy report for use in determining whether a property is located in a Special Flood Hazard Area. Flood profiles and floodway data should be used in the determination of flood insurance information. Accordingly, flood elevation data presented in the FIP report should be related to information with the FIRM for purposes of construction and/or floodplain management when they are higher than the elevations shown on this FIRM.

The projection used in the preparation of this map was Universal Transverse Mercator, Zone 12. The datum used was the North American Datum of 1983. All elevations are in feet above mean sea level. For information regarding conversion between the National Flood Insurance Program's datum and other datums, users should refer to the National Geodetic Survey website at <http://www.ngs.noaa.gov> or contact the National Geodetic Survey at the following address:

National Geodetic Survey
2030 Wilson Road
Springfield, VA 22151
2025 National Geodetic Survey
2030 Wilson Road
Springfield, VA 22151
2025
2025
2025

To obtain current elevation, description, and/or location information for benchmarks shown on this map, please contact the National Geodetic Survey at the following address:

National Geodetic Survey
2030 Wilson Road
Springfield, VA 22151
2025
2025
2025

Base map information shown on this FIRM was provided by Yavapai County. This map, produced in 2005, was provided in digital format at a scale of 1:10,000.

This map, which was created and printed using digital cartographic techniques from those shown on the previous FIRM for this jurisdiction. The Floodway and Floodway Data sheets in the Flood Insurance Policy report may have been updated to reflect the most current information available. The Flood Profile and Floodway Data sheets in the Flood Insurance Policy report (which contain elevation data) may reflect elevation changes that differ from what is shown on this map.

Geographic details shown on this map are based on the best data available at the time of publication. Because changes due to construction or development may have occurred since the time this map was published, users should contact appropriate community officials to verify current property locations.

Please refer to the explanatory notes that appear on the cover map of the county showing the layout of map panels, community map resolution, additional, and a listing of communities within the National Flood Insurance Program for each community as well as a listing of the panels on which each community is located.

Contact the FEMA Map Service Center at 1-800-358-6618 for information on available products associated with the FIRM. Available products may include preliminary report letters of Map Change, a Flood Insurance Study report, and/or digital versions of this map. The FEMA Map Service Center can also be reached by fax at 1-800-358-6618 or by e-mail at fema@fema.dhs.gov.

If you have questions about this map or questions concerning the National Flood Insurance Program in general, please call 1-877-FEMA-MAP (1-877-369-3677) or visit the FEMA website (www.fema.gov).

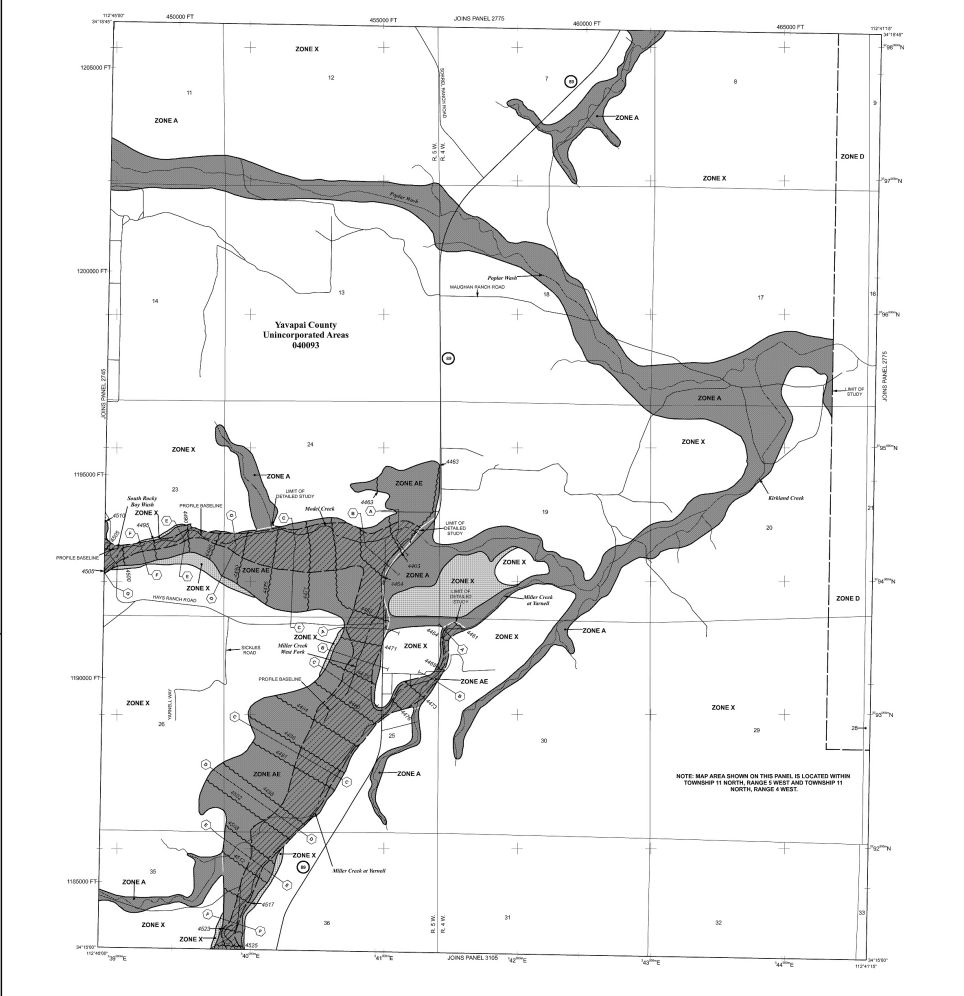

LEGEND

- SPECIAL FLOOD HAZARD AREAS SUBJECT TO INUNDATION BY THE 1% ANNUAL CHANCE FLOOD**
- ZONE A** - Special Flood Hazard Area (SFHA) subject to inundation by the 1% annual chance flood.
 - ZONE AE** - Special Flood Hazard Area (SFHA) subject to inundation by the 1% annual chance flood, with a base flood elevation (BFE) shown.
 - ZONE X** - Special Flood Hazard Area (SFHA) subject to inundation by the 1% annual chance flood, with a base flood elevation (BFE) shown.
 - ZONE D** - Special Flood Hazard Area (SFHA) subject to inundation by the 1% annual chance flood, with a base flood elevation (BFE) shown.
- FLOODWAY AREAS IN ZONE AE**
- Zone AE Floodway** - Floodway area associated with Zone AE.
 - Zone X Floodway** - Floodway area associated with Zone X.
 - Zone D Floodway** - Floodway area associated with Zone D.
- OTHER FLOOD AREAS**
- Zone X** - Other flood areas.
 - Zone AE** - Other flood areas.
 - Zone D** - Other flood areas.
- OTHER AREAS**
- Zone X** - Other areas.
 - Zone AE** - Other areas.
 - Zone D** - Other areas.
- BOUNDARIES AND OTHER FEATURES**
- Boundary** - Boundary line.
 - Zone Boundary** - Zone boundary line.
 - Other Boundary** - Other boundary line.
 - Other Feature** - Other feature.
- MAP INFORMATION**
- Scale** - 1:100,000
 - Projection** - UTM, Zone 12
 - Datum** - NAD 83
 - Units** - Feet

NATIONAL FLOOD INSURANCE PROGRAM

PANEL 2765G

FIRM FLOOD INSURANCE RATE MAP

YAVAPAI COUNTY, ARIZONA AND INCORPORATED AREAS

PANEL 2765 OF 2900

COMMUNITY YAVAPAI COUNTY

DATE 2010

MAP NUMBER 44025C2765G

MAP REVISED SEPTEMBER 3, 2010

Federal Emergency Management Agency