

NOTES TO USERS

This map is for use in administering the National Flood Insurance Program. It shows the Special Flood Hazard Areas (SFHA) subject to inundation by the 1% Annual Chance Flood. The community was prepared by the Federal Emergency Management Agency (FEMA) for the National Flood Insurance Program. To obtain more detailed information in areas where Base Flood Elevations (BFE) are shown, please refer to the Flood Profile and Floodway Data and/or Floodway Elevation Tables (FET) located within the Flood Insurance Study (FIS) report that accompanies this FIRM. Users should be aware that BFEs shown on the FIS report represent the best available information. These BFEs are intended for informational purposes only and should not be used as the sole basis of flood insurance information. Accordingly, flood elevation data presented in the FIS report should be obtained in conjunction with the FIS for purposes of construction and/or floodplain management.

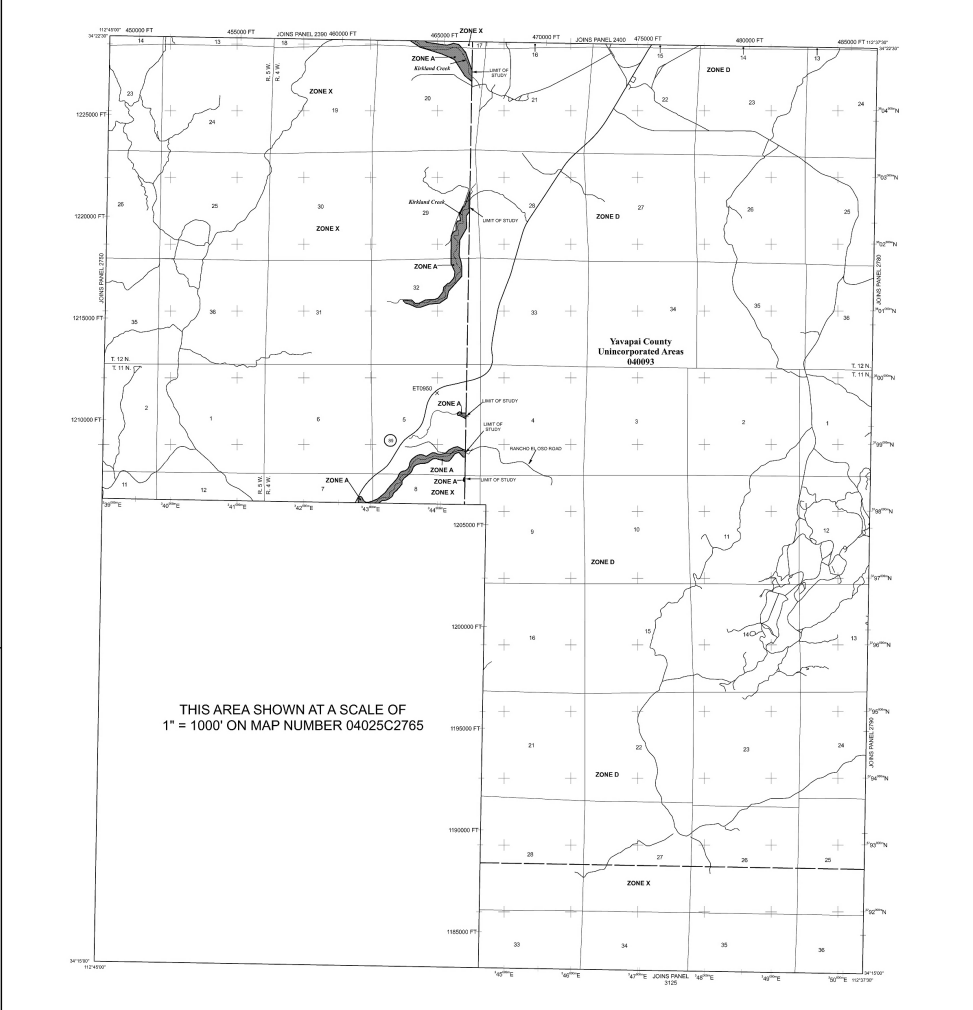

THIS AREA SHOWN AT A SCALE OF 1" = 1000' ON MAP NUMBER 0402SC2765

LEGEND

- SPECIAL FLOOD HAZARD AREAS SUBJECT TO INUNDATION BY THE 1% ANNUAL CHANCE FLOOD
ZONE X
ZONE D
ZONE A
ZONE B
ZONE C
ZONE E
ZONE F
ZONE G
ZONE H
ZONE I
ZONE J
ZONE K
ZONE L
ZONE M
ZONE N
ZONE O
ZONE P
ZONE Q
ZONE R
ZONE S
ZONE T
ZONE U
ZONE V
ZONE W
ZONE X
ZONE Y
ZONE Z

NATIONAL FLOOD INSURANCE PROGRAM
FIRM
FLOOD INSURANCE RATE MAP
YAVAPAI COUNTY, ARIZONA
AND INCORPORATED AREAS
PANEL 2775 OF 3900
MAP NUMBER 0402SC2775G
MAP REVISED SEPTEMBER 3, 2010
Federal Emergency Management Agency