

**NOTES TO USERS**

This map is for use in administering the National Flood Insurance Program. It does not necessarily identify areas subject to flooding, particularly from local drainage sources, or areas of flood risk. This information is intended solely for use by the Federal Emergency Management Agency (FEMA) and its authorized representatives. It is not intended for use by any other agency, individual, or business.

To obtain more detailed information in areas where **Base Flood Elevations** are shown, contact the Flood Profile and Floodway Data and/or Summary of Damaged Structures (as relevant) with the Flood Insurance Rate Study report for the community. This FEMA study should be made available to the community upon request. The Flood Profile and Floodway Data and/or Summary of Damaged Structures should be used to determine the base flood elevation for each structure. Flood elevations shown on this map should be used for construction and/or floodplain management purposes when they are higher than the elevations shown on the FEMA study.

**Coastal Base Flood Elevations** shown on this map apply to structures of 1,000 square feet or more. The FEMA study should be used to determine the base flood elevation for structures less than 1,000 square feet. Flood elevations shown on this map should be used for construction and/or floodplain management purposes when they are higher than the elevations shown on the FEMA study.

Boundaries of the Floodway are shown on this map. Floodway boundaries are shown with light gray lines. Floodway boundaries are shown with light gray lines. Floodway boundaries are shown with light gray lines.

Certain areas not in Special Flood Hazard Areas may be protected by flood control structures. Refer to Section 2 of the Flood Insurance Study report for information on flood control structures for this community.

The projection used in the preparation of this map was Universal Transverse Mercator, NAD 83. The datum used was the North American Vertical Datum of 1988. The datum used was the North American Vertical Datum of 1988. The datum used was the North American Vertical Datum of 1988.

Flood elevations on this map are referenced to the North American Vertical Datum of 1988. These flood elevations must be compared to structure and ground elevations referenced to the same vertical datum. For information regarding conversion between the National Flood Insurance Program datum and other vertical datums, refer to the National Flood Insurance Program website at [www.fema.gov/nfip](http://www.fema.gov/nfip) or contact the National Geographic Survey at 1-800-368-6868.

**FEMA Information Services**  
 FEMA, NWS  
 National Geographic Survey  
 FEMA, NWS  
 FEMA, NWS  
 FEMA, NWS

To obtain current elevation, description, and location information for **beach nourishment** shown on this map, please contact the Information Services Branch of the National Geographic Survey at (811) 715-2324, or visit its website at [www.ngs.gov](http://www.ngs.gov).

**Base map information** shown on this map was provided by Yavapai County. This map was produced in 2005. The map was produced in 2005. The map was produced in 2005.

This map, which shows natural and man-made features, does not constitute a warranty of any kind. The map is provided for informational purposes only. The map is provided for informational purposes only. The map is provided for informational purposes only.

Geographic data shown on this map are based on the best data available at the time of publication. Because changes due to construction or development may have occurred after the map was published, map users should contact appropriate community officials to verify current geographic locations.

Please refer to the appropriate **Map Index** for an overview map of the county showing the layout of map panels. Community map boundaries, and a listing of communities within National Flood Insurance Program zones for each community as well as a listing of the panels on which each community is located.

Contact the **FEMA Map Service Center** at 1-800-368-6868 for information on available products associated with this FEMA study. Available products may include preliminary report letters of Map Change, a Flood Insurance Study report, and digital versions of this map. The FEMA Map Service Center can also be reached by fax at 1-800-368-6868 or by e-mail at [fema@fema.gov](mailto:fema@fema.gov).

If you have questions about this map or questions concerning the National Flood Insurance Program in general, please call 1-877-FEMA-MAP (1-877-368-6868) or visit the FEMA website at [www.fema.gov](http://www.fema.gov).

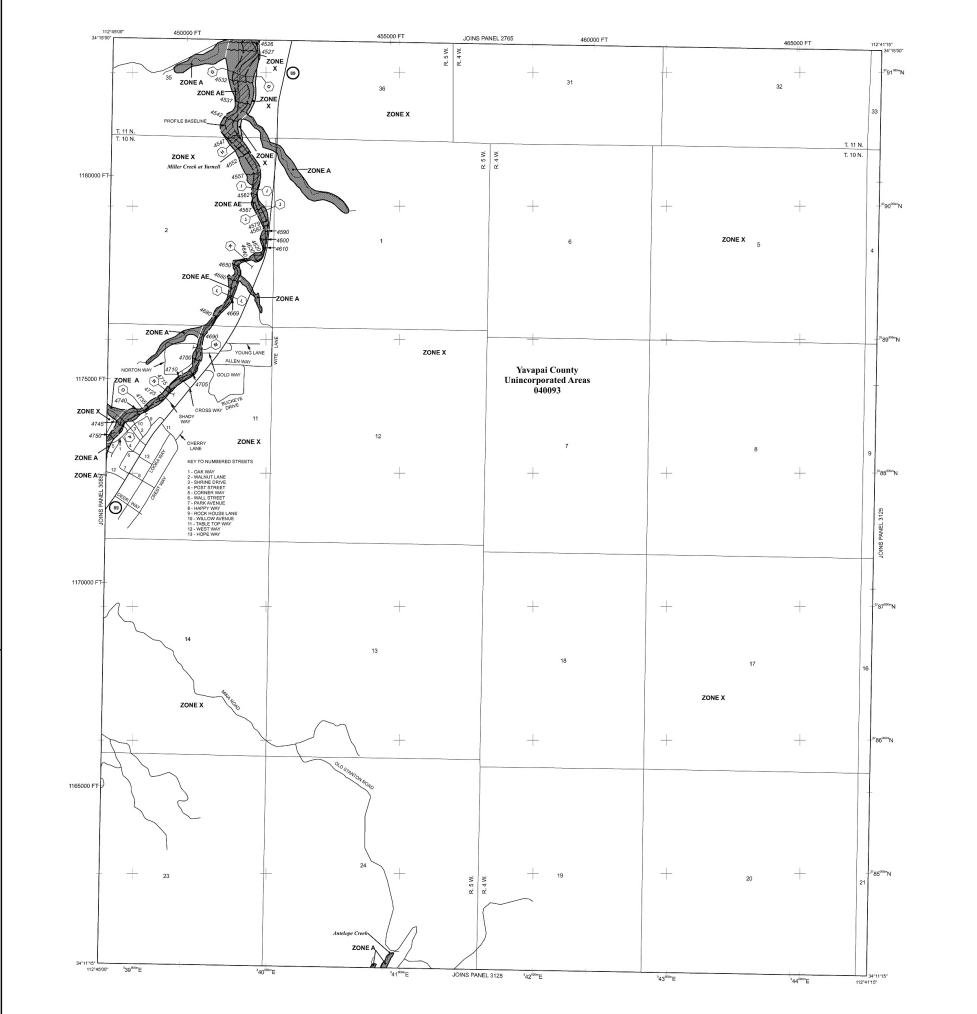

**LEGEND**

**SPECIAL FLOOD HAZARD AREAS SUBJECT TO INUNDATION BY THE 1% ANNUAL CHANCE FLOOD**

**ZONE A**  
 Base Flood Elevation determined  
 Flood depths of 1 to 3 feet (small areas of ponding); Base Flood Elevation determined

**ZONE X**  
 Special Flood Hazard Areas (SFHA) subject to ponding from the 1% annual chance flood; Flood depths of 1 to 3 feet (small areas of ponding); Base Flood Elevation determined

**OTHER FLOOD AREAS**

**OTHER AREAS**

**FLOODWAY AREAS IN ZONE A**

**OTHER FLOOD AREAS**

**OTHER AREAS**

**BOUNDARIES**

**MAP INFORMATION**

**EFFECTIVE DATES OF REVISIONS TO THIS PANEL**

**MAP SCALE 1" = 1000'**

**MAP NUMBER 04025C3105G**

**MAP REVISED SEPTEMBER 3, 2010**

**Federal Emergency Management Agency**

**NFIP**

**PANEL 3105G**

**FIRM**

**FLOOD INSURANCE RATE MAP**

**YAVAPAI COUNTY, ARIZONA AND INCORPORATED AREAS**

**PANEL 3105 OF 3900**

**COMMUNITY**

**YAVAPAI COUNTY**

**MAP NUMBER 04025C3105G**

**MAP REVISED SEPTEMBER 3, 2010**

**Federal Emergency Management Agency**