

NOTES TO USERS

This map is for use in administering the National Flood Insurance Program. It does not constitute a warranty of any kind, nor does it constitute a representation of the Federal Government or of any State. The Government and its agents and employees are not liable for damages or losses of any kind resulting from the use of this map.

To obtain more detailed information in areas where **Base Flood Elevations** are shown, contact the Flood Insurance Study (FIS) report that contains the Flood Profile and Floodway Data and/or the Survey of Shaded Elevations (SSE) report where the Flood Insurance Study (FIS) report that contains the Flood Profile and Floodway Data and/or the Survey of Shaded Elevations (SSE) report should be obtained in conjunction with the FIS for purposes of construction and/or floodplain management.

Coastal Base Flood Elevations shown on this map are the result of an analysis of U.S. Army Corps of Engineers (USACE) data. Users of this FIS should be aware that the USACE data are also available in the Survey of Shaded Elevations (SSE) report in the Flood Insurance Study report for this jurisdiction. Elevations shown in the Survey of Shaded Elevations (SSE) report should be used for construction and/or floodplain management purposes when they are higher than the elevations shown on this FIS.

Boundaries of the **Floodways** were compiled at cross sections and interpolated between cross sections. The boundaries were based on hydrologic considerations with regard to the National Flood Insurance Program. Floodway widths and other pertinent floodway data are provided in the Flood Insurance Study report for this jurisdiction.

Certain areas not in Special Flood Hazard Areas may be protected by **Flood Control Structures**. Refer to Section 2 "Flood Protection Measures" of the Flood Insurance Study report for information on flood control structures for this jurisdiction.

The **projection** used in the preparation of this map was Universal Transverse Mercator, Zone 12. The **horizontal datum** was NAD 83. Contour elevations shown in meters, represent projection of LTM areas used in the production of FISs for adjacent jurisdictions. They may not represent elevations in real human service jurisdiction boundaries. These elevations do not affect the accuracy of this FIS.

Flood elevations on this map are referenced to the North American Vertical Datum of 1988. These flood elevations must be compared to structure and ground elevations referenced to the same vertical datum. For information regarding conversion between the National Geodetic Vertical Datum of 1988 and the North American Vertical Datum of 1988, see the National Geodetic Survey website at <http://www.ngs.noaa.gov/GIA/html/gia.html> or contact the National Geodetic Survey at the following address:

NGS Information Services
 NGA1, RM 5121
 National Geodetic Survey
 265 Pelee Island Road
 2124 Service Building
 2025 York Road
 York, PA 16122

To obtain current elevation, description, and/or location information for **beams** shown on this map, please contact the Information Services Branch of the National Geodetic Survey at (813) 733-2824, or visit its website at <http://www.ngs.noaa.gov/GIA/html/gia.html>.

Base map information shown on this FIS was provided by Yavapai County. This map, produced in 2005, was provided in digital format at a scale of 1:10,000.

This map, which was created and revised, shows changed qualifications from those shown on the previous FIS for this jurisdiction. The Floodway and Floodway Data were transferred from the previous FIS to this FIS. The Flood Profile and Floodway Data were transferred from the previous FIS to this FIS. The Flood Profile and Floodway Data were transferred from the previous FIS to this FIS. The Flood Profile and Floodway Data were transferred from the previous FIS to this FIS.

Geographic details shown on this map are based on the best data available at the time of publication. Because changes due to construction or de-annexation may have occurred since this map was published, map users should contact appropriate community officials to verify current corporate line locations.

Please refer to the explanatory annex **Map Index** for an outline map of the county showing the layout of map panels covering this jurisdiction. Additional information and a listing of contributing data sources for this Flood Insurance Study are provided for each community as well as a listing of the panels on which each community is located.

Contact the **FEMA Map Service Center** at 1-800-368-6818 for information on available products associated with this FIS. Available products may include preliminary report letters of Map Change, a Flood Insurance Study report, and/or digital versions of this map. The FEMA Map Service Center may also be reached by fax at 1-800-368-6818 or by e-mail at fema@fema.dhs.gov.

If you have **questions about this map** or questions concerning the National Flood Insurance Program in general, please call 1-877-FEMA-MAP (1-877-368-2627) or visit the FEMA website (<http://www.fema.gov>).

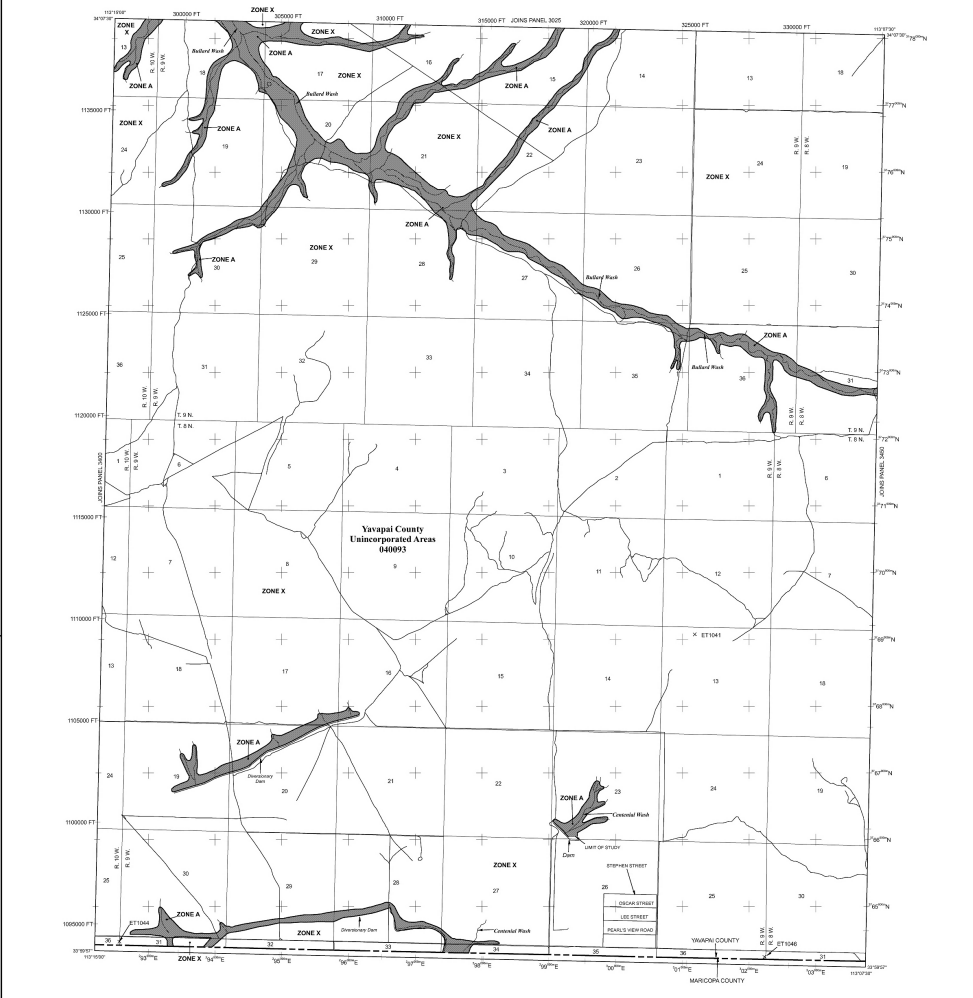

LEGEND

SPECIAL FLOOD HAZARD AREAS SUBJECT TO INUNDATION BY THE 1% ANNUAL CHANCE FLOOD

ZONE X
 Zone X Flood Hazard Area
 Zone X Flood Hazard Area

ZONE A
 Zone A Flood Hazard Area
 Zone A Flood Hazard Area

FLOODWAY AREAS IN ZONE X

OTHER FLOOD AREAS

OTHER AREAS

OTHER PROTECTED AREAS (OPA)

MAP REPRODUCTION
 Refer to Map Reproduction Map Index

EFFECTIVE DATE OF FIRM PANELS TO THIS PANEL

EFFECTIVE DATE OF COUNTY-WIDE FIRM PANELS WITH THIS MAP

EFFECTIVE DATE OF FIRM PANELS TO THIS PANEL

MAP SCALE 1" = 2000'

MAP NUMBER 04025C425G

MAP REVISED SEPTEMBER 3, 2010

Federal Emergency Management Agency

NFIP

PANEL 3425G

FIRM

FLOOD INSURANCE RATE MAP

YAVAPAI COUNTY, ARIZONA AND UNINCORPORATED AREAS

PANEL 3425 OF 3900

(SEE MAP INDEX FOR FIRM PANEL LAYOUT)

CENTERS

COUNTY

STATE

DATE

MAP NUMBER 04025C425G

MAP REVISED SEPTEMBER 3, 2010

Federal Emergency Management Agency