

NOTES TO USERS

This map is for use in administering the National Flood Insurance Program. It does not constitute a warranty of any kind, particularly with respect to flood insurance or other services. The community may independently obtain information for purposes related to additional flood insurance information.

To obtain more detailed information in areas where **Base Flood Elevations** are shown, please contact the Flood Insurance Study (FIS) report that encompasses the Flood Profile and Floodway Data (FPD) Survey of Shaded Elevations (SE) located within the Flood Insurance Study (FIS) report that encompasses the FEMA County should be aware that the FIS shown on the FIS report may not be identical to the FIS shown on the FIS report. The FIS shown on the FIS report should be used in the FIS report. The FIS shown on the FIS report should be used in the FIS report.

Coastal Base Flood Elevations shown on this map apply to the portion of the community that is located in the coastal zone. The FIS shown on the FIS report should be used in the FIS report. The FIS shown on the FIS report should be used in the FIS report.

Boundaries of the Floodway were compiled at cross sections and interpolated between cross sections. The boundaries are based on hydraulic calculations, width and other pertinent floodway data are provided in the Flood Insurance Study report for the jurisdiction.

Certain areas not in Special Flood Hazard Areas may be protected by Flood Insurance Study Report Section 2 "Flood Protection Measure" of the Flood Insurance Study report for information on flood control activities for this jurisdiction.

The projection used in the preparation of this map was Universal Transverse Mercator (UTM) Zone 13. The datum used was the North American Datum of 1983. The datum used in the preparation of this map was the North American Datum of 1983. The datum used in the preparation of this map was the North American Datum of 1983.

Flood elevations on this map are referenced to the North American Vertical Datum of 1988. These flood elevations must be compared to structures and ground elevations referenced to the same vertical datum. For information regarding conversion between the National Flood Insurance Study (NFIS) datum and the datum used in the preparation of this map, please contact the National Flood Insurance Study (NFIS) report for the jurisdiction.

For more information on this map, please contact the Flood Insurance Study (FIS) report for the jurisdiction. For more information on this map, please contact the Flood Insurance Study (FIS) report for the jurisdiction.

For more information on this map, please contact the Flood Insurance Study (FIS) report for the jurisdiction. For more information on this map, please contact the Flood Insurance Study (FIS) report for the jurisdiction.

For more information on this map, please contact the Flood Insurance Study (FIS) report for the jurisdiction. For more information on this map, please contact the Flood Insurance Study (FIS) report for the jurisdiction.

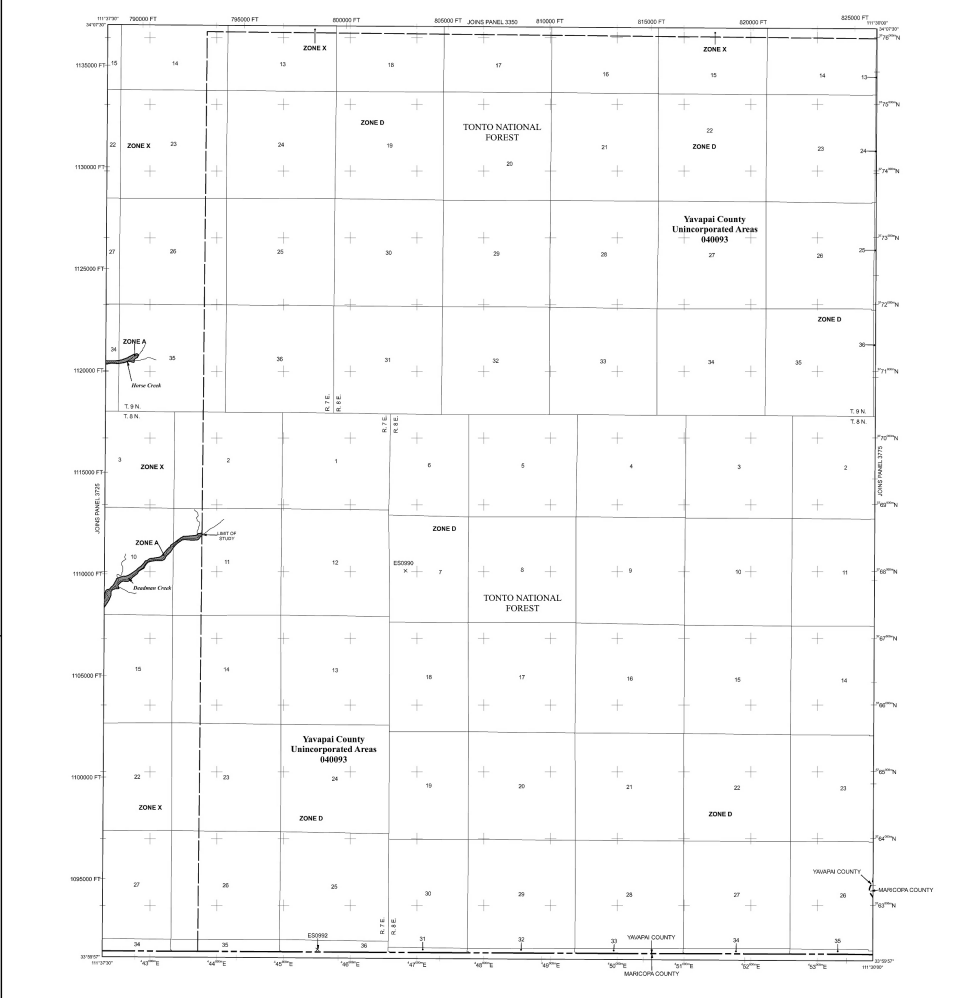

LEGEND

SPECIAL FLOOD HAZARD AREAS SUBJECT TO INSURANCE BY THE NATIONAL FLOOD INSURANCE PROGRAM

ZONE X
Zone X Flood Hazard Area

ZONE D
Zone D Flood Hazard Area

ZONE A
Zone A Flood Hazard Area

OTHER FLOOD AREAS

OTHER AREAS

BOUNDARIES

OTHER FEATURES

MAP INFORMATION

EFFECTIVE DATES OF REGULATIONS TO THIS PANEL

MAP SCALE 1" = 2000'

PANEL 3750G

FIRM FLOOD INSURANCE RATE MAP

YAVAPAI COUNTY, ARIZONA AND UNINCORPORATED AREAS

PANEL 3750 OF 3900

MAP NUMBER 44023C3750G

MAP REVISED SEPTEMBER 3, 2010

Federal Emergency Management Agency

NATIONAL FLOOD INSURANCE PROGRAM

YAVAPAI COUNTY, ARIZONA AND UNINCORPORATED AREAS

PANEL 3750 OF 3900

MAP NUMBER 44023C3750G

MAP REVISED SEPTEMBER 3, 2010

Federal Emergency Management Agency