

NOTES TO USERS

This map is for use in administering the National Flood Insurance Program. It does not necessarily identify the areas subject to flooding, particularly from local flooding, or areas of special concern. This information is intended only for use in determining whether additional flood insurance is warranted.

To obtain more detailed information in areas where **Base Flood Elevations** are shown, consult the Flood Profile and Floodway Data and/or Summary of Shaded Elevations, which are available from the Flood Insurance Rate Study (FIRM) report for the community. The FIRM Users Guide should be used to determine the correct use of the Flood Profile and Floodway Data and/or Summary of Shaded Elevations. The FIRM Users Guide should be used to determine the correct use of the Flood Profile and Floodway Data and/or Summary of Shaded Elevations. The FIRM Users Guide should be used to determine the correct use of the Flood Profile and Floodway Data and/or Summary of Shaded Elevations.

Coastal Base Flood Elevations shown on this map apply to the portion of the community that is subject to coastal flooding. These elevations are based on the National Flood Insurance Program's Coastal Flood Hazard Study. The FIRM Users Guide should be used to determine the correct use of the Coastal Base Flood Elevations. The FIRM Users Guide should be used to determine the correct use of the Coastal Base Flood Elevations.

Boundaries of the **Floodway** were compiled at cross sections and interpolated between cross sections. The Floodway was based on hydraulic calculations with input from the National Flood Insurance Program. Floodway widths and other pertinent floodway data are provided in the Flood Insurance Study report for the community.

Certain areas not in Special Flood Hazard Areas may be protected by **Flood Protection Structures**. Refer to Section 2.3 "Flood Protection Structures" of the Flood Insurance Study report for information on flood control structures for this community.

The **projection** used in the preparation of this map was Universal Transverse Mercator (UTM) Zone 12. The **vertical datum** was the 1988 datum. Elevation differences in meters, reported in parentheses on UTM axes used in the production of this map, represent differences in elevation. Elevation differences in feet, reported in parentheses, represent differences in elevation. Elevation differences in feet, reported in parentheses, represent differences in elevation.

Flood elevations on this map are referenced to the North American Vertical Datum of 1988. These flood elevations must be compared to spot elevations and ground elevations referenced to the same vertical datum. For information regarding conversion between the National Flood Insurance Program's 1988 datum and other vertical datums, refer to the National Flood Insurance Program's Flood Insurance Study report for the community. The FIRM Users Guide should be used to determine the correct use of the Flood Elevations. The FIRM Users Guide should be used to determine the correct use of the Flood Elevations.

FIRM Information Services
 FEMA (404) 728-5121
 National Geographic Survey
 2125 L Street, NW
 Washington, DC 20037
 (202) 755-1234

To obtain current elevation, description, and/or location information for **bench marks** shown on this map, please contact the Information Services Branch of the National Geographic Survey at (202) 755-1234, or visit its website at <http://www.ngs.noaa.gov>.

Base map information shown on this map was provided by Yavapai County. This map, produced in 2003, was provided in digital format at a scale of 1:12,500.

The map, which were created and georeferenced, shows **contour elevations** from those shown on the previous FIRM for this jurisdiction. The Floodway and Floodway Data were derived from the previous FIRM. The Floodway and Floodway Data were derived from the previous FIRM. The Floodway and Floodway Data were derived from the previous FIRM.

Geographic details shown on this map are based on the best data available at the time of publication. Because changes due to annexation or de-annexation may have occurred since the map was published, map users should contact appropriate community officials to verify current corporate line locations.

Please refer to the explanatory **panel map** for an overview map of the county, showing the layout of map panels, community map regulatory jurisdiction, and a listing of communities within National Flood Insurance Program zones for each community as well as a listing of the panels on which each community is located.

Contact the **FIRM Map Service Center** at 1-800-358-6618 for information on available products associated with the FIRM. Available products may include preliminary report letters of Map Change, a Flood Insurance Study report, and/or digital versions of this map. The FIRM Map Service Center can also be reached by fax at (800) 358-6618 or by e-mail at firmservice@fema.gov.

If you have **questions about this map** or questions concerning the National Flood Insurance Program in general, please call 1-877-FIRM-MAP (1-877-336-3627) or visit the FIRM website at <http://www.firm.gov>.

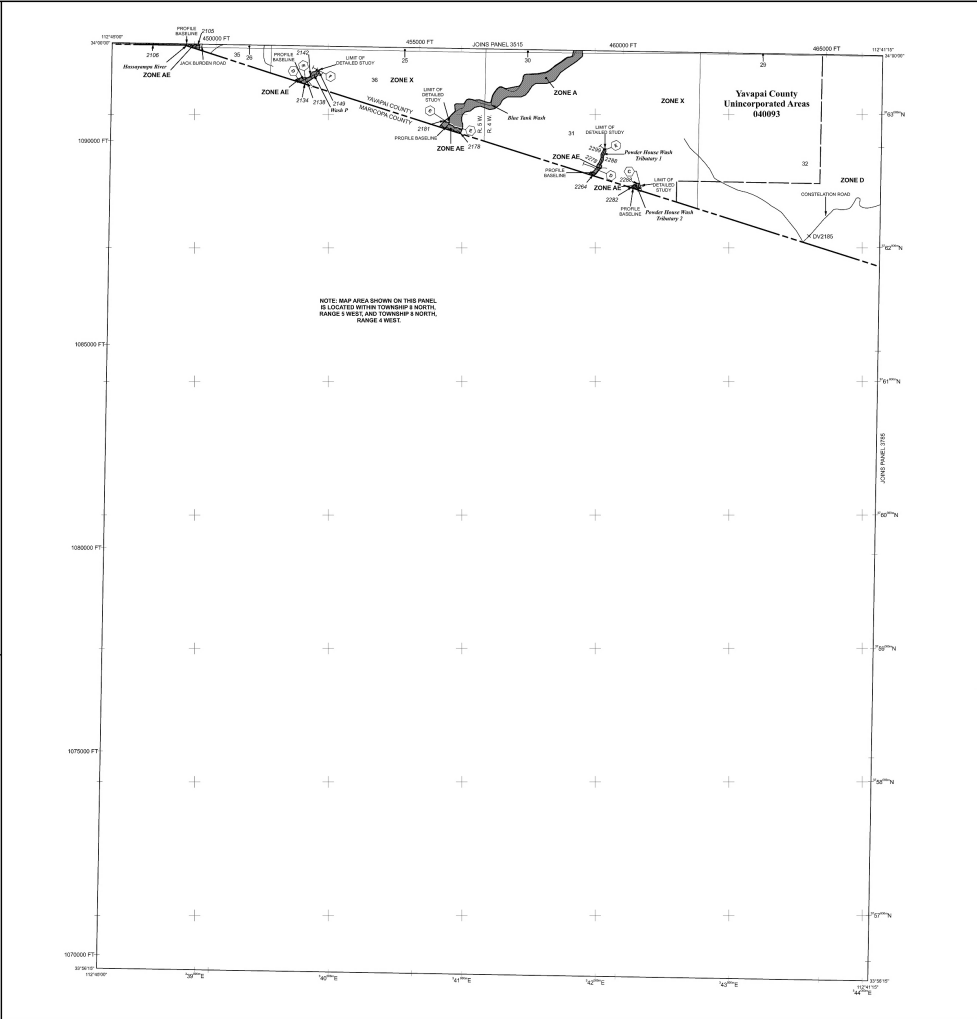

LEGEND

SPECIAL FLOOD HAZARD AREAS SUBJECT TO INUNDATION BY THE 1% ANNUAL CHANCE FLOOD

ZONE A
 Zone A
 Zone A

ZONE AE
 Zone AE
 Zone AE

ZONE X
 Zone X
 Zone X

ZONE D
 Zone D
 Zone D

FLOODWAY AREAS IN ZONE AE
 Floodway Areas in Zone AE
 Floodway Areas in Zone AE

OTHER FLOOD AREAS
 Other Flood Areas
 Other Flood Areas

OTHER AREAS
 Other Areas
 Other Areas

BOUNDARIES
 Boundaries
 Boundaries

POINTS OF INTEREST
 Points of Interest
 Points of Interest

SCALE
 Scale
 Scale

MAP NUMBER
 04025C3780G

MAP REVISION
 SEPTEMBER 3, 2010

Federal Emergency Management Agency

NATIONAL FLOOD INSURANCE PROGRAM

PANEL 3780G

FIRM

FLOOD INSURANCE RATE MAP

YAVAPAI COUNTY, ARIZONA AND INCORPORATED AREAS

PANEL 3780 OF 3900

USE MAP PANELS FOR FIRM PANEL LAYOUT

COMMUNITY 040993

DATE 09/03/10

MAP NUMBER 04025C3780G

MAP REVISION SEPTEMBER 3, 2010

Federal Emergency Management Agency