

NOTES TO USERS

This map is for use in administering the National Flood Insurance Program. It does not necessarily depict the actual location of flooding, particularly from local storm drainage or runoff. This information is provided for informational purposes only and is not intended to be used for any other purpose.

To obtain more detailed information in areas where Base Flood Elevations are shown, please refer to the Flood Insurance Rate Study (FIRM) for the area. The Flood Profile and Floodway Data and/or Summary of Damaged Structures data contained within the Flood Insurance Rate Study (FIRM) report the actual elevations. This FIRM data should be used to determine the actual elevation of flood waters. Flood profiles should be used to determine the actual location of flood waters. Flood profiles should be used to determine the actual location of flood waters. Flood profiles should be used to determine the actual location of flood waters.

Coastal Base Flood Elevations: Coasts are the only application of Coastal Base Flood Elevations (CBFE) shown on this map. CBFEs are based on the National Oceanic and Atmospheric Administration's (NOAA) Coastal High Water (CHW) data. CBFEs are shown in the Flood Insurance Rate Study report for the jurisdiction. Elevations shown in the Summary of Damaged Structures data should be used for construction and floodplain management purposes when they are higher than the elevations shown on this FIRM.

Boundaries of the Floodways were compiled at cross sections and interpolated between cross sections. The Floodways are based on hydraulic calculations with input from the National Flood Insurance Program. Floodway widths and other pertinent Floodway data are provided in the Flood Insurance Rate Study report for the jurisdiction.

Certain areas not in Special Flood Hazard Areas may be protected by flood insurance. Refer to Section 2.1 "Flood Protection Measure" of the Flood Insurance Rate Study report for information on flood control structures for this jurisdiction.

The projection used in the preparation of this map was Universal Transverse Mercator (UTM) Zone 12. The datum used was the North American Datum of 1983. All elevations are in feet above mean sea level. For information regarding conversion between the National Oceanic and Atmospheric Administration datum and the datum used in this map, please refer to the National Oceanic and Atmospheric Administration's datum conversion information available at http://www.noaa.gov/datum_conversion.

Flood elevations on this map are referenced to the North American Vertical Datum of 1983. These flood elevations must be compared to structures and ground elevations referenced to the same vertical datum. For information regarding conversion between the National Oceanic and Atmospheric Administration datum and the datum used in this map, please refer to the National Oceanic and Atmospheric Administration's datum conversion information available at http://www.noaa.gov/datum_conversion.

NOI Information Services: NOAA, NWS, National Geographic Survey, and other agencies provide information on the National Flood Insurance Program. For more information, please contact the National Flood Insurance Program at 1-800-358-6118.

To obtain current elevation, description, and location information for beach areas shown on this map, please contact the Information Services Branch of the National Oceanic and Atmospheric Administration at 1-800-358-6118.

Base map information: The base map was provided by Yavapai County. This map, produced in 2005, was provided in digital format at a scale of 1:10,000.

This map, which shows natural and man-made features, does not constitute a warranty of any kind. The National Flood Insurance Program and the National Oceanic and Atmospheric Administration do not warrant the accuracy or completeness of the information shown on this map. The National Flood Insurance Program and the National Oceanic and Atmospheric Administration do not warrant the accuracy or completeness of the information shown on this map.

Geographic data shown on this map are based on the best data available at the time of publication. Because changes due to construction or de-construction may have occurred since the data were collected, map users should contact appropriate community officials to verify current geographic locations.

Please refer to the explanatory panel Map 1465G for an overview map of the county showing the layout of map panels, community map regulatory addresses, and a listing of communities within National Flood Insurance Program zones for each community as well as a listing of the panels on which each community is located.

Contact the FEMA Map Service Center at 1-800-358-6118 for information on available products associated with the FIRM. Available products may include preliminary Flood Insurance Rate Study (FIRM) data, Flood Insurance Rate Study report, and digital versions of the map. The FEMA Map Service Center area is available for use at <http://www.fema.gov> or by calling 1-800-358-6118.

If you have questions about this map or questions concerning the National Flood Insurance Program, please call 1-877-FEMA-MAP (1-877-368-2627) or visit the FEMA website at <http://www.fema.gov>.

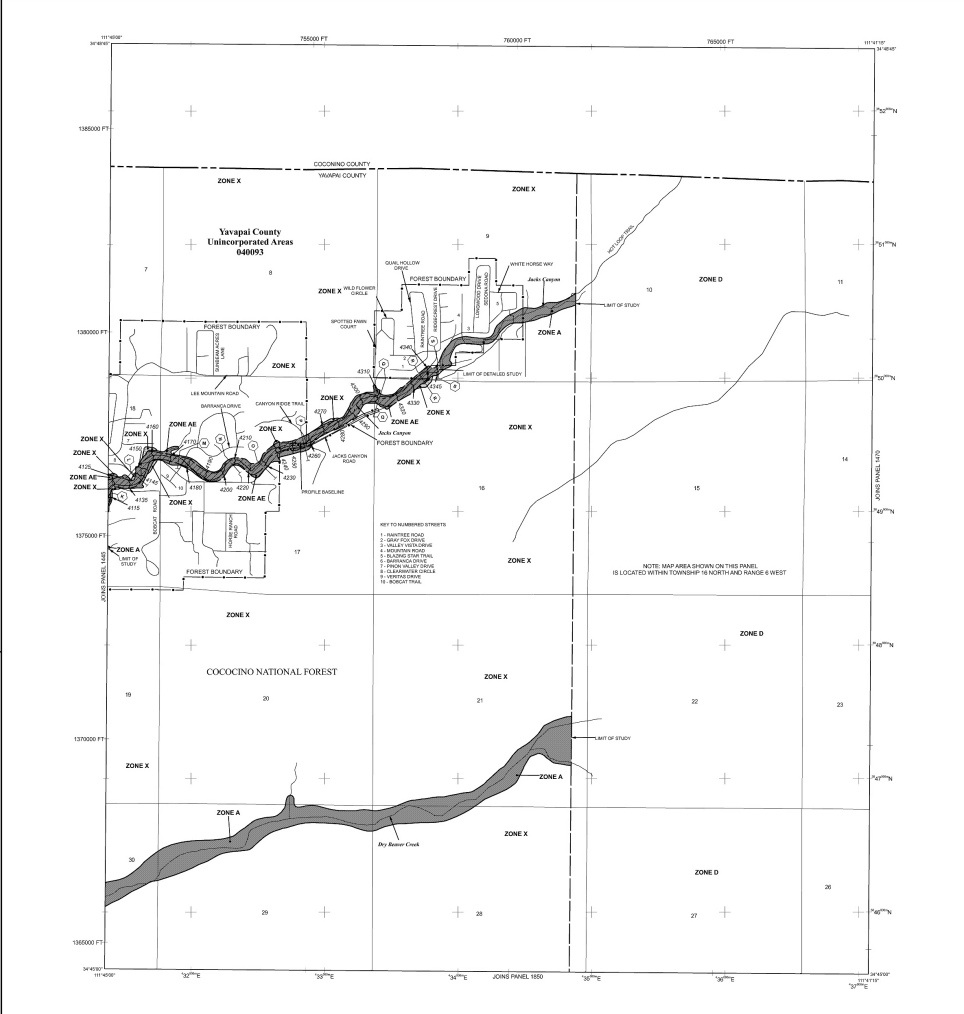

LEGEND

SPECIAL FLOOD HAZARD AREAS SUBJECT TO INUNDATION BY THE 1% ANNUAL CHANCE FLOOD

- ZONE X:** Special Flood Hazard Area subject to inundation by the 1% annual chance flood.
- ZONE AE:** Special Flood Hazard Area subject to inundation by the 1% annual chance flood with a base flood depth of 1 to 3 feet (small areas of ponding). Base Flood Elevation (BFE) shown.
- ZONE A:** Special Flood Hazard Area subject to inundation by the 1% annual chance flood with a base flood depth of 1 to 3 feet (small areas of ponding). Base Flood Elevation (BFE) shown.
- ZONE D:** Special Flood Hazard Area subject to inundation by the 1% annual chance flood with a base flood depth of 1 to 3 feet (small areas of ponding). Base Flood Elevation (BFE) shown.
- ZONE AE:** Special Flood Hazard Area subject to inundation by the 1% annual chance flood with a base flood depth of 1 to 3 feet (small areas of ponding). Base Flood Elevation (BFE) shown.
- ZONE A:** Special Flood Hazard Area subject to inundation by the 1% annual chance flood with a base flood depth of 1 to 3 feet (small areas of ponding). Base Flood Elevation (BFE) shown.
- ZONE D:** Special Flood Hazard Area subject to inundation by the 1% annual chance flood with a base flood depth of 1 to 3 feet (small areas of ponding). Base Flood Elevation (BFE) shown.

FLOODWAY AREAS IN ZONE AE

- Zone AE Floodway:** Floodway shown in Zone AE.
- Zone AE Floodway:** Floodway shown in Zone AE.

OTHER FLOOD AREAS

- Zone X:** Floodway shown in Zone X.
- Zone AE:** Floodway shown in Zone AE.
- Zone A:** Floodway shown in Zone A.
- Zone D:** Floodway shown in Zone D.

OTHER AREAS

- Zone X:** Floodway shown in Zone X.
- Zone AE:** Floodway shown in Zone AE.
- Zone A:** Floodway shown in Zone A.
- Zone D:** Floodway shown in Zone D.

COASTAL BASE FLOOD ELEVATIONS (CBFE)

- Zone X:** Floodway shown in Zone X.
- Zone AE:** Floodway shown in Zone AE.
- Zone A:** Floodway shown in Zone A.
- Zone D:** Floodway shown in Zone D.

OTHER FLOOD AREAS (OFA)

- Zone X:** Floodway shown in Zone X.
- Zone AE:** Floodway shown in Zone AE.
- Zone A:** Floodway shown in Zone A.
- Zone D:** Floodway shown in Zone D.

MAP REGULATORY

- Zone X:** Floodway shown in Zone X.
- Zone AE:** Floodway shown in Zone AE.
- Zone A:** Floodway shown in Zone A.
- Zone D:** Floodway shown in Zone D.

EFFECTIVE DATES OF REVISIONS TO THIS PANEL

- Zone X:** Floodway shown in Zone X.
- Zone AE:** Floodway shown in Zone AE.
- Zone A:** Floodway shown in Zone A.
- Zone D:** Floodway shown in Zone D.

MAP SCALE 1" = 1000'

MAP NUMBER 04025C1465G

MAP REVISED SEPTEMBER 3, 2010

Federal Emergency Management Agency

NATIONAL FLOOD INSURANCE PROGRAM

PANEL 1465G

FIRM FLOOD INSURANCE RATE MAP

YAVAPAI COUNTY, ARIZONA AND INCORPORATED AREAS

PANEL 1465 OF 2000

USE MAP SCALE FOR FIRM PANEL LAYOUT

COMMUNITY SUBURB DANIEL BAPTIST

UNINCORPORATED

MAP NUMBER 04025C1465G

MAP REVISED SEPTEMBER 3, 2010

Federal Emergency Management Agency