

NOTES TO USERS

This map is for use in administering the National Flood Insurance Program. It does not constitute a warranty of any kind, and it is not intended to be used for purposes other than those intended by the Federal Emergency Management Agency.

To obtain more detailed information in areas where **Base Flood Elevations** are shown, please refer to the Flood Insurance Study (FIS) report that accompanied the Flood Profile and Floodway Data Survey of Saltwater Elevations (SLE) conducted in the Flood Insurance Study (FIS) report that accompanied the FIS. Users should be aware that FIS is shown on the FIS report and that the FIS report should be used in the same manner as the FIS report. Flood insurance policies should be based on the data shown in the FIS report. Flood insurance policies should be based on the data shown in the FIS report.

Coastal Base Flood Elevations shown on this map are based on the National Flood Insurance Program (NFIP) Coastal Base Flood Elevation (CBFBE) data. Users of this FIS should be aware that CBFBE data are provided in the Survey of Saltwater Elevations (SLE) in the Flood Insurance Study report for the jurisdiction. Elevations shown in the Survey of Saltwater Elevations (SLE) should be used for construction and floodplain management purposes when they are higher than the elevations shown on this FIS.

Boundaries of the Floodway are shown as cross sections and interpolated between cross sections. The Floodway boundaries are based on hydraulic calculations with input of information of the National Flood Insurance Program. Floodway widths and other pertinent Floodway data are provided in the Flood Insurance Study report for the jurisdiction.

Certain areas not in Special Flood Hazard Areas may be protected by flood control structures. Refer to Section 2.3 "Flood Protection Measures" of the Flood Insurance Study report for information on flood control structures for this jurisdiction.

The projection used in the preparation of this map was Universal Transverse Mercator (UTM) Zone 12. The datum used was the North American Datum of 1983. In areas where ground elevations are shown, the datum used is the datum of the ground elevation. In areas where ground elevations are not shown, the datum used is the datum of the ground elevation. In areas where ground elevations are not shown, the datum used is the datum of the ground elevation.

Flood elevations on this map are referenced to the North American Vertical Datum of 1988. These flood elevations must be compared to structure and ground elevations referenced to the same vertical datum. For information regarding conversion between the National Flood Insurance Program datum of 1988 and the datum of the ground elevation, refer to the National Geographic Survey website at www.ngs.noaa.gov or contact the National Geographic Survey at the following address:

NGS Information Services
 NGA, NGS-1
 National Geographic Survey
 1215 17th Street, NW
 Silver Spring, MD 20910-3282
 (301) 771-3282

To obtain current elevation, description, and location information for **beams** shown on this map, please contact the Information Services Branch of the National Geographic Survey at (301) 771-3282, or visit its website at www.ngs.noaa.gov.

Base map information shown on this FIS was provided by Yavapai County. This map, produced in 2005, was provided in digital format at a scale of 1:10,000.

This map, which was created and printed, shows changed configurations from those shown on the previous FIS for this jurisdiction. The Floodway and Floodway boundaries shown on this map may have been adjusted to reflect the National Flood Insurance Program (NFIP) data. The Flood Profile and Floodway Data Survey of Saltwater Elevations (SLE) report that accompanied the FIS may reflect revised information that differ from what is shown on this map.

Geographic details shown on this map are based on the best data available at the time of publication. Because changes due to construction or de-construction may have occurred since the map was published, map users should contact appropriate community officials to verify current corporate lot locations.

Please refer to the regulatory period **Map Dates** for an overview map of the county showing the period of map coverage, map regulatory additions, and a listing of communities with current National Flood Insurance Program dates for each community as well as a listing of the panels on which each community is located.

Contact the **FEMA Map Service Center** at 1-800-368-6618 for information on available products associated with the FIS. Available products may include regulatory period maps of Map Change, a Flood Insurance Study report, and digital versions of this map. The FEMA Map Service Center can be reached by fax at (800)368-6618 or by e-mail at fema@fema.dhs.gov.

If you have questions about this map or questions concerning the National Flood Insurance Program in general, please call 1-877-FEMA-MAP (1-877-368-6618) or visit the FEMA website at www.fema.gov.

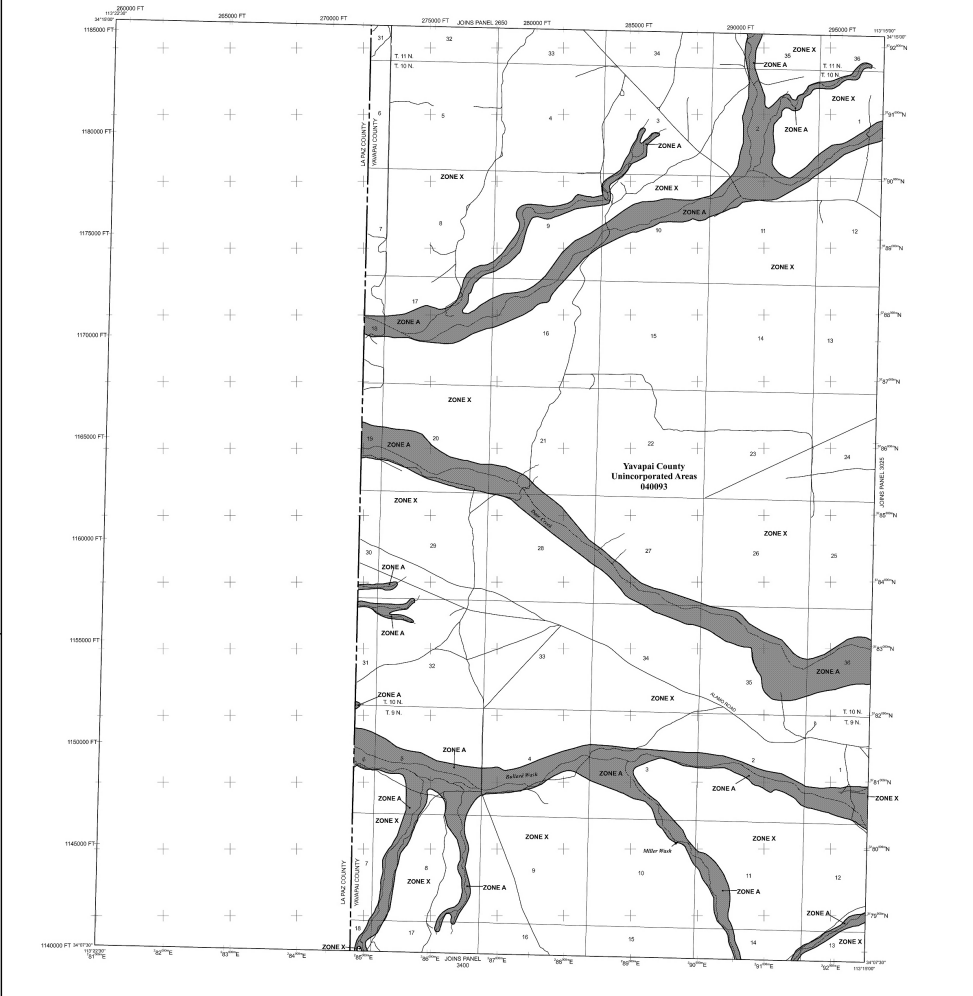

LEGEND

- SPECIAL FLOOD HAZARD AREAS SUBJECT TO INUNDATION BY THE 1% ANNUAL CHANCE FLOOD
- ZONE A
Special Flood Hazard Areas Subject to Inundation by the 1% Annual Chance Flood
- ZONE X
Special Flood Hazard Areas Subject to Inundation by the 1% Annual Chance Flood
- FLOODWAY AREAS IN ZONE A
- OTHER FLOOD AREAS
- OTHER AREAS
- COASTAL BARRIER RESOURCES SYSTEM (CBRS) AREAS
- OTHERWISE PROTECTED AREAS (OPA)
- FLOODWAY BOUNDARY
- ZONE BOUNDARY
- OPA and OPA BOUNDARY
- BOUNDARY OF SPECIAL FLOOD HAZARD AREA OF DIFFERENT BASE FLOOD ELEVATION
- BASE FLOOD ELEVATION IN FEET
- BASE FLOOD ELEVATION IN METERS
- GEOGRAPHIC COORDINATES
- 100-YEAR FLOOD ELEVATION
- 500-YEAR FLOOD ELEVATION
- 100-YEAR FLOOD ELEVATION IN FEET
- 500-YEAR FLOOD ELEVATION IN METERS
- 100-YEAR FLOOD ELEVATION IN FEET
- 500-YEAR FLOOD ELEVATION IN METERS
- 100-YEAR FLOOD ELEVATION IN FEET
- 500-YEAR FLOOD ELEVATION IN METERS

NATIONAL FLOOD INSURANCE PROGRAM

PANEL 3000G

FIRM FLOOD INSURANCE RATE MAP

YAVAPAI COUNTY, ARIZONA AND UNINCORPORATED AREAS

PANEL 2006 OF 3900

(SEE MAP DATES FOR FIRM PANEL LAYOUT)

CRITICAL **DANGER** **HAZARD** **SEVERE**

MAP NUMBER 44025C3000G

MAP REVISED SEPTEMBER 3, 2010

Federal Emergency Management Agency